



Connectors > RF & Coax Connectors > RF Adapters > In-Series Adapters



RF Connector Type: **BNC**
Body Angle: **Straight**
RF Connector Center Contact Material: **Brass**
RF Connector Center Contact Plating Material: **Gold**
Impedance: **50 Ω**

Features

Product Type Features

Grade	Professional
Isolated Ground	No
RF Connector Type	BNC
Connector System	Cable-to-Cable
Sealable	No
Connector & Contact Terminates To	Wire & Cable

Configuration Features

Number of Positions	1
---------------------	---

Electrical Characteristics

Impedance	50 Ω
-----------	------

Signal Characteristics

Frequency	4 GHz
-----------	-------

Body Features

Body Insulation	With
Body Material	Brass
Body Plating Material	Nickel
Body Angle	Straight

Contact Features

RF Connector Center Contact Material	Brass
--------------------------------------	-------



RF Connector Center Contact Plating Material	Gold
Mechanical Attachment	
Connector Mounting Type	Bulkhead
Usage Conditions	
Operating Temperature Range	-65 – 165 °C[-85 – 329 °F]
Operation/Application	
Circuit Application	Power & Signal
Packaging Features	
Packaging Method	Tray
Packaging Quantity	50
Other	
Military Style Number	UG-914/U

Product Compliance

For compliance documentation, visit the product page on TE.com>

EU RoHS Directive 2011/65/EU	Not Yet Reviewed
EU ELV Directive 2000/53/EC	Compliant with Exemptions
China RoHS 2 Directive MIIT Order No 32, 2016	Restricted Materials Above Threshold
EU REACH Regulation (EC) No. 1907/2006	Current ECHA Candidate List: JAN 2020 (205) Candidate List Declared Against: JUN 2016 (169) Does not contain REACH SVHC
EU REACH Regulation (EC) No. 1907/2006	Current ECHA Candidate List: JAN 2020 (205) Candidate List Declared Against: JUN 2016 (169)
Halogen Content	Low Bromine/Chlorine - Br and Cl < 900 ppm per homogenous material. Also BFR /CFR/PVC Free
Solder Process Capability	Not applicable for solder process capability

Product Compliance Disclaimer

This information is provided based on reasonable inquiry of our suppliers and represents our current actual knowledge based on the information they provided. This information is subject to change. The part numbers that TE has identified as EU RoHS compliant have a maximum concentration of 0.1% by weight in homogenous materials for lead, hexavalent chromium, mercury, PBB, PBDE, DBP, BBP, DEHP, DIBP, and 0.01% for cadmium, or qualify for an exemption to these limits as defined in the Annexes of Directive 2011/65/EU (RoHS2). Finished electrical and electronic equipment products will be CE marked as required by Directive 2011/65/EU. Components may not be CE marked. Additionally, the part



numbers that TE has identified as EU ELV compliant have a maximum concentration of 0.1% by weight in homogenous materials for lead, hexavalent chromium, and mercury, and 0.01% for cadmium, or qualify for an exemption to these limits as defined in the Annexes of Directive 2000/53/EC (ELV). Regarding the REACH Regulations, TE's information on SVHC in articles for this part number is still based on the European Chemical Agency (ECHA) 'Guidance on requirements for substances in articles'(Version: 2, April 2011), applying the 0.1% weight on weight concentration threshold at the finished product level. TE is aware of the European Court of Justice ruling of September 10th, 2015 also known as O5A (Once An Article Always An Article) stating that, in case of 'complex object', the threshold for a SVHC must be applied to both the product as a whole and simultaneously to each of the articles forming part of its composition. TE has evaluated this ruling based on the new ECHA "Guidance on requirements for substances in articles" (June 2017, version 4.0) and will be updating its statements accordingly.

Also in the Series | **Alcoswitch ADP**



Card Edge Connector Housings(4)

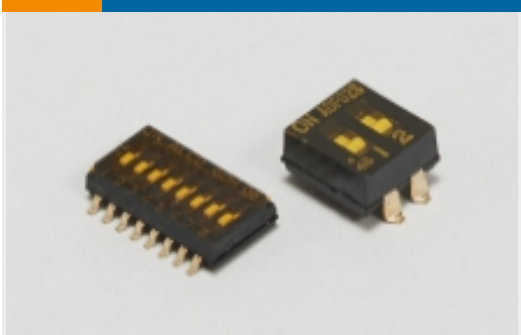

DIP & SIP Switches(4)



In-Series Adapters(14)



RJ45 Connectors(1)

Customers Also Bought



TE Model / Part #1-5353583-1
Std USB Type A, R/A, SMT, Offset, Panel

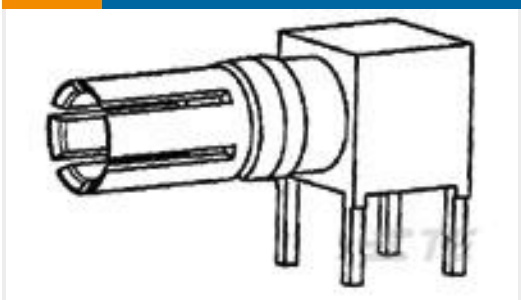

TE Model / Part #2-1393589-9
C42334A 347A194=HS-BUCHSE



TE Model / Part #1617120-6
J1MSW-5XP = M39016/10-017P

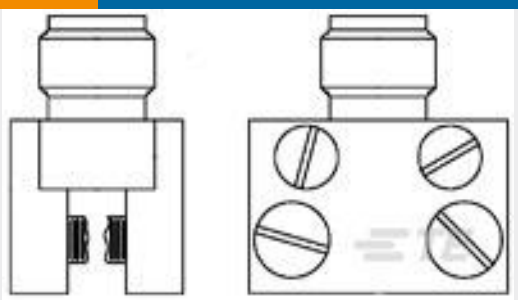

TE Model / Part #1053478-1
SMA Stripline Launcher 2070 8002 92

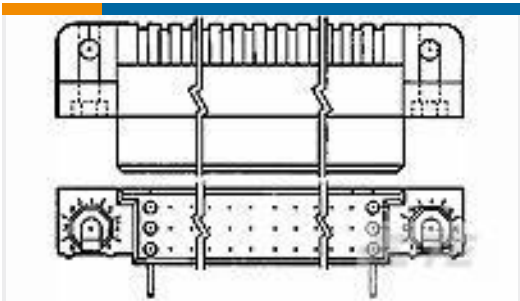

TE Model / Part #532431-3
HDI RECP ASSY 3 ROW 96 POS

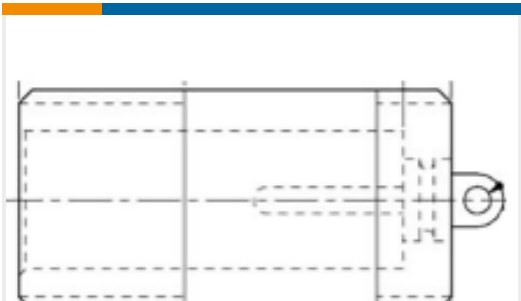

TE Model / Part #868092-1
LGH-1 RECEPTACLE

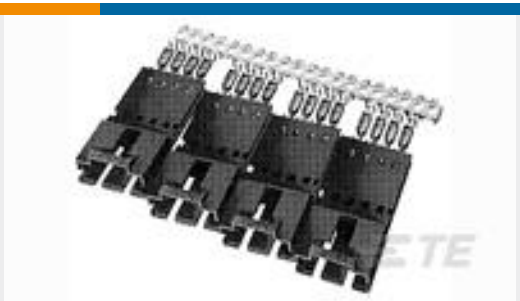

TE Model / Part #103945-9
2X10 MTE SHRD PIN SR LTCH .100

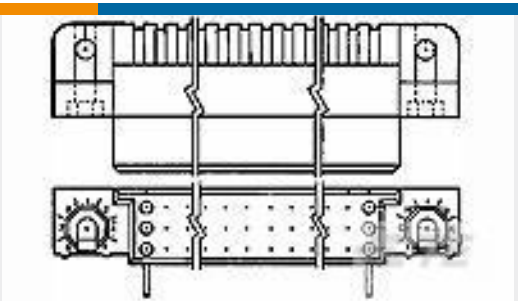

TE Model / Part #533914-5
HDI RECP ASSY 3 ROW 165 POS



TE Model / Part #534267-7
40 MODIV VRT DR OE 100/125

