

SLEEVE DIA5 SHUR PLUG NAT

✓ ACTIVE

SHUR-PLUG | SHUR-PLUG 180

TE Part # 170887-1

TE Internal #: 170887-1

[View on TE.com >](#)



Terminals & Splices > Terminal Housings, Insulation Sleeves & Blocks > Crimp Terminal Housings



Terminal & Splice Type: **Receptacle**

Housing Type: **Receptacle Housing**

Number of Positions: **1**

Terminal Orientation: **Straight**

Housing Color: **Natural**

Features

Product Type Features

Product Type	Insulation Sleeve
Terminates To	Wire & Cable
Housing Type	Receptacle Housing
Sealable	No
Insulated	No

Configuration Features

Number of Positions	1
---------------------	---

Body Features

Housing Color	Natural
Mating Retention	Without
Mating Alignment	Without

Contact Features

Terminal & Splice Type	Receptacle
Terminal Orientation	Straight

Mechanical Attachment

SLEEVE DIA5 SHUR PLUG NAT

TE Part # 170887-1  
TE Internal #: 170887-1



Mating Alignment Type	None
-----------------------	------

Housing Features

Housing Material	Soft Vinyl Chloride
------------------	---------------------

Dimensions

Wire Insulation Diameter (Max)	13.3 mm²
Length	13 mm[.51 in]
Accepts Wire Insulation Diameter Range	2.5 – 4 mm

Usage Conditions

Operating Temperature Range	-40 – 105 °C[-40 – 221 °F]
-----------------------------	----------------------------

Operation/Application

For Use With	5 Dia. Series
--------------	---------------

Packaging Features

Packaging Quantity	1000
Packaging Method	Bag/Carton

Product Compliance

For compliance documentation, visit the product page on TE.com>

EU RoHS Directive 2011/65/EU	Compliant
EU ELV Directive 2000/53/EC	Compliant
China RoHS 2 Directive MIIT Order No 32, 2016	No Restricted Materials Above Threshold
EU REACH Regulation (EC) No. 1907/2006	Current ECHA Candidate List: JAN 2019 (197) Candidate List Declared Against: JAN 2019 (197)
Halogen Content	Not Low Halogen - contains Br or Cl > 900 ppm.
Solder Process Capability	Not applicable for solder process capability

Product Compliance Disclaimer

This information is provided based on reasonable inquiry of our suppliers and represents our current actual knowledge based on the information they provided. This information is subject to change. The part numbers that TE has identified as EU RoHS compliant have a maximum concentration of 0.1% by weight in homogenous materials for lead, hexavalent chromium, mercury, PBB, PBDE, DBP, BBP, DEHP, DIBP, and 0.01% for cadmium, or qualify for an exemption to these limits as defined in the Annexes of Directive 2011/65/EU (RoHS2). Finished electrical and electronic equipment products will be CE marked as required by Directive 2011/65/EU. Components may not be CE marked. Additionally, the part numbers that TE has identified as EU ELV compliant have a maximum concentration of 0.1% by weight in homogenous materials for lead, hexavalent chromium, and mercury, and 0.01% for cadmium, or qualify for an exemption to these limits as defined in the Annexes of Directive 2000/53/EC (ELV). Regarding the REACH Regulations, TE’s information on SVHC in articles for this part number is still based on the European Chemical Agency (ECHA) ‘Guidance on requirements for



substances in articles’(Version: 2, April 2011), applying the 0.1% weight on weight concentration threshold at the finished product level. TE is aware of the European Court of Justice ruling of September 10th, 2015 also known as O5A (Once An Article Always An Article) stating that, in case of ‘complex object’, the threshold for a SVHC must be applied to both the product as a whole and simultaneously to each of the articles forming part of its composition. TE has evaluated this ruling based on the new ECHA “Guidance on requirements for substances in articles” (June 2017, version 4.0) and will be updating its statements accordingly.

Also in the Series | SHUR-PLUG 180



Crimp Terminal Housings  
(6)



Crimp Wire Pins, Tabs & Ferrules(41)



Special Purpose Terminals  
(1)

Customers Also Bought



TE Part #170887-3  
IS SHUR PLG 5 DIA NAT



TE Part #170889-3  
SLEEVE DIA5 SHUR PLUG NAT

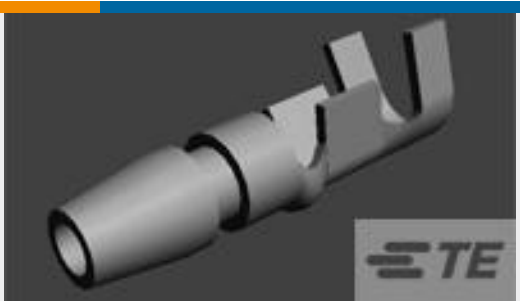

TE Part #170020-2  
SHUR PLUG 20-14 MM2 TPBR

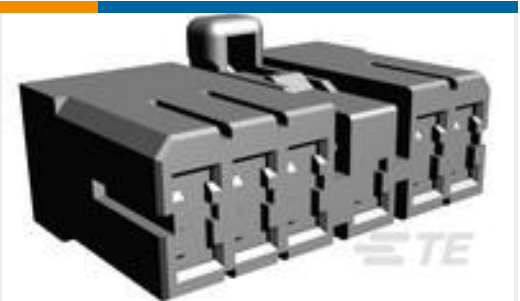

TE Part #172497-1  
MIC MARK-2 PLUG HSG 11P

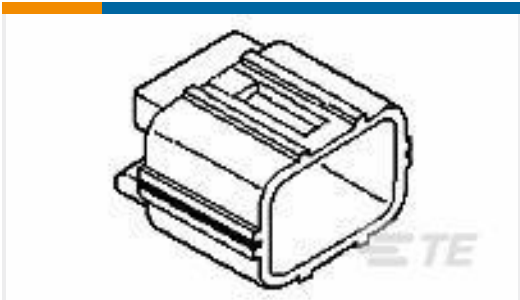

TE Part #1-174360-1  
E-J MK-2 CAP HSG 3P NATURAL



TE Part #170021-2  
SHUR PLUG RECEPTACLE 20-16 AWG TPBR



TE Part #170823-2  
SLEEVE 250 NAT

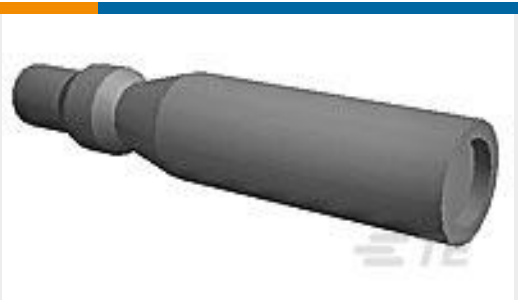

TE Part #170889-1  
SLEEVE DIA5 SHUR PLUG NAT

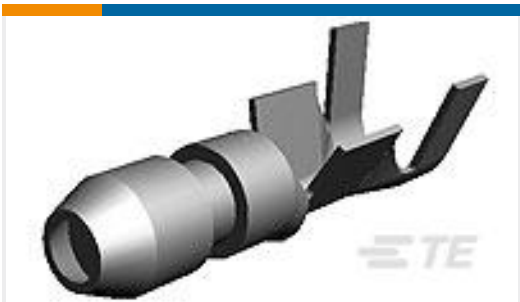

TE Part #170002-4  
SHUR PLUG 20-14 AWG 0.5 X 11.44 TPBR

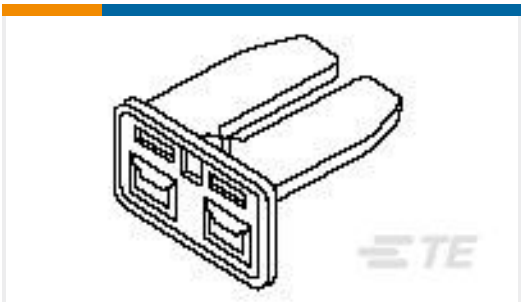

TE Part #1-174353-1  
070 E-J MK2 PLATE 2P

Documents

Product Drawings



SLEEVE DIA5 SHUR PLUG NAT

English

CAD Files

3D PDF

3D

Customer View Model

ENG\_CVM\_CVM\_170887-1\_D.2d\_dxf.zip

English

Customer View Model

ENG\_CVM\_CVM\_170887-1\_D.3d\_igs.zip

English

Customer View Model

ENG\_CVM\_CVM\_170887-1\_D.3d\_stp.zip

English

Product Environmental Compliance

TE Material Declaration

English