



RIBBON CABLE CONNECTORS



✓ Active

↓ **PRODUCT DRAWING**
English

↓ **3D PDF**

TE CONNECTIVITY (TE)

IDC LOW PRO HDR 34P VERT SHT L

AMP-LATCH | [Low Profile Headers](#)

3-1761608-1

TE Internal Number: 3-1761608-1

Always EU RoHS/ELV Compliant

Centerline **2.54 mm [.1 in]**

PCB Mount Retention **Without**

PCB Mounting Orientation **Vertical**

Termination Method to PC Board **Through Hole**

Shrouded **Yes**

Product Drawings

[HEADER ASSEMBLY, SHORT EJECT LATCH, VERTICAL, LOW PROFILE, IDC](#)

PDF
English

CAD Files

[3D PDF](#)

PDF
3D

[Customer View Model](#)

3D_IGS.ZIP
English

[Customer View Model](#)

3D_STP.ZIP
English

[Customer View Model](#)

2D_DXF.ZIP
English

Product Specifications

Product Specification

[AMP-LATCH And IDC Header Connectors, .100 X .100 Inch Grid](#)

PDF
English

Please review product documents or [contact us](#) for the latest agency approval information. Please Note: Use the Product Drawing for all design activity.

Product Type Features

PCB Mounting Orientation **Vertical**

Shrouded **Yes**

Row-to-Row Spacing **2.54 mm [.1 in]**

Connector Style **Plug**

Profile **Low**

	Applies To	Printed Circuit Board
	Product Type	Connector
	Board Standoff	Without
	Connector Type	Header
	Connector System	Wire-to-Board
	Ejection Latches	With
<hr/>		
Configuration Features	Number of Positions	34
	Number of Rows	2
<hr/>		
Electrical Characteristics	Operating Voltage (VAC)	250
	Insulation Resistance (MΩ)	1000 – 5000
<hr/>		
Body Features	Post Size	.64 mm [.025 in]
	Header Type	Pin Header
	Daisy Chain	With
<hr/>		
Contact Features	Contact Mating Area Plating Material	Gold Flash over Palladium Nickel
	Contact Mating Area Plating Thickness	.762 μm [30 μin]
	Contact Shape	Square
	Contact Transmits (Typical)	Signal (Data)
	Solder Tail Contact Plating Material	Tin over Nickel
	Contact Current Rating (A)	1
	Contact Base Material	Phosphor Bronze
	Contact Type	Pin
	Contact Termination Area Plating Material	Tin
	Contact Termination Area Plating Thickness	2.54 μm [100 μin]
<hr/>		
Termination Features	Termination Method to PC Board	Through Hole
	Termination Post Length	2.6 mm [.102 in]
<hr/>		
Mechanical Attachment	PCB Mount Retention	Without
	Mating Alignment Type	Center
	Mating Connector Lock	Without
	Mating Alignment	With
	Polarization	With

Panel Mount Retention	Without
Mating Retention	With
PCB Mount Alignment	Without

Housing Features	Centerline	2.54 mm [.1 in]
	Housing Color	Blue
	Housing Style	4-Sided
	Housing Entry Style	Top
	Housing Material	PBT

Dimensions	Height	9.19 mm [.36 in]
	Length	50.8 mm [2 in]
	Shrouded End Dimension	3.76 mm [.148 in]

Usage Conditions	Temperature Rating	High
	Operating Temperature Range (°C)	-65 – 105

Operation/Application	For Use With	AMP-Latch Receptacle
-----------------------	--------------	-----------------------------



Industry Standards	UL Flammability Rating	UL 94V-0
--------------------	------------------------	-----------------

Packaging Features	Packaging Method	Tube
	Packaging Quantity	10

Product Compliance [Statement of Compliance PDF](#)

[VIEW ALL PRODUCT COMPLIANCE](#)

CUSTOMERS ALSO BOUGHT

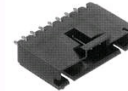
<p>SURFACE MOUNT RESISTORS</p>  <p>3520 220K 5% 3520220KJT</p> <p>Save to List</p>	<p>RJ11 CONNECTORS</p>  <p>MJ, R/A, 6P/2C, PNL STOPS, TRAY 5520250-1</p> <p>Save to List</p>	<p>WIRE-TO-BOARD CONNECTOR HOUSINGS</p>  <p>06 MODIV HSG COMP SR .100 POL 102241-4</p> <p>Save to List</p>	<p>WIRE-TO-BOARD HEADERS & RECEPTACLES</p>  <p>04 MTE HDR SRST LATCH .100CL 5-103735-3</p> <p>Save to List</p>
---	---	---	---

Products - 5 Results

View All

Compare 0/10

Relation Type

RELATIONSHIP

Mating Products

Used to identify Mating Parts

See All Mating Products

PRODUCT - MATING PRODUCTS



Connectors - Ribbon Cable Connectors
AMP-LATCH | AMP-LATCH - NOVO

34 NOVO MIL 15DP, LEAD FREE - 1658620-8

TE INTERNAL NUMBER: 1658620-8

Active

Always EU RoHS/ELV Compliant

Centerline 2.54 mm

PCB Mount Retention **Without**

PCB Mounting Orientation

Vertical

Termination Method to PC Board

Through Hole - Solder

Termination Method to

Wire/Cable **Insulation**

Displacement Crimp (IDC)



RELATIONSHIP

Mating Products

Used to identify Mating Parts

See All Mating Products

PRODUCT - MATING PRODUCTS



Connectors - Ribbon Cable Connectors
AMP-LATCH | AMP-LATCH - NOVO

34 NOVO MIL/CTR 30DP, LEAD FREE - 1658622-8

TE INTERNAL NUMBER: 1658622-8
ALIAS ID: AMP-0-1658622-8, CV3195-000

Active

Always EU RoHS/ELV Compliant

Centerline 2.54 mm

PCB Mount Retention **Without**

PCB Mounting Orientation

Vertical

Termination Method to PC Board

Through Hole - Solder

Termination Method to

Wire/Cable **Insulation**

Displacement Crimp (IDC)



RELATIONSHIP

Mating Products

Used to identify Mating Parts

See All Mating Products

PRODUCT - MATING PRODUCTS

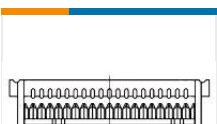

Connectors - Ribbon Cable Connectors
AMP-LATCH - NOVO

609-3430LF FEM SOCKET,

Always EU RoHS/ELV Compliant

Number of Positions **34**



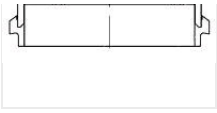

LEAD FREE - 1-1658526-8

TE INTERNAL NUMBER: 1-1658526-8

Connector Style **Receptacle**

✓ Active