



# Product Change Notification

Current Date: 02-Sep-2016

## TE Connectivity

**Product Change Notification:** E-16-011740

**PCN Date:** 31-AUG-16

**Customer:** TTI Inc(0000139702)

**Location:** WORLDWIDE

**Agreement:** Agreement Unknown

TE would like to inform you of the following change(s) to the listed TE Connectivity Product. In case of any further questions about this change(s), please contact your TE Connectivity Sales Engineer. Affected part, drawing and/or specification numbers are listed on the attached sheet(s).

**General Product Description:**

SINGLE WIRE SEAL FOR 2,5mm CONTACT SYSTEM

**Description of Changes**

ADDED ALTERNATIVE SHAPE ON DRAWING

**Other attachments:**

[PREVIEW OF MODIFICATION](#)

**Reason for Changes:**

Document Clarification. NO FFF CHANGE: ONLY DRAWING ADAPTION TO CURRENT SITUATION, THAT SHOWS A POSSIBLE ALTERNATIVE INNER HOLE INGRESS DIAMETER

**Estimated Dates:**

**Last Order Date** (Obsolete Parts Only):

**First Date To Ship** (Changed Parts Only):

**Last Ship Date** (Obsolete Parts Only):

**Last Date for Mixed Shipments:** (Changed Parts Only):

No Mixed Shipments
--------------------

The documents listed below are being modified. Related parts that are not explicitly listed on this PCN are not being modified or discontinued as per the PCN. The Last Order Date, Last Ship Date, First Date to Ship Changed Parts and last date for Mixed Shipments apply only to parts explicitly listed on this PCN.

**Note: This PCN contains only document changes, these changes do not affect the form, fit or function of the parts referenced.**

**Customer Drawing(s) Being Modified:**

Drawing Number	Related Part Number	Customer Part Number	Current Revision	New Revision
<a href="#">828920</a>	828920-1	TYC828920-1	M8	

**Customer:** TTI Inc.( 1305175 )

**Location:** Maisach-Gernlinden

**Agreement Number:** TTI001

The documents listed below are being modified. Related parts that are not explicitly listed on this PCN are not being modified or discontinued as per the PCN. The Last Order Date, Last Ship Date, First Date to Ship Changed Parts and last date for Mixed Shipments apply only to parts explicitly listed on this PCN.

**Customer Drawing(s) Being Modified:**

Drawing Number	Related Part Number	Customer Part Number	Current Revision	New Revision
<a href="#">828920</a>	828920-1	TYC828920-1	M8	

**Customer:** TTI Inc( 168830 )

**Location:** Fort Worth

**Agreement Number:** Agreement Unknown

The documents listed below are being modified. Related parts that are not explicitly listed on this PCN are not being modified or discontinued as per the PCN. The Last Order Date, Last Ship Date, First Date to Ship Changed Parts and last date for Mixed Shipments apply only to parts explicitly listed on this PCN.

**Customer Drawing(s) Being Modified:**

Drawing Number	Related Part Number	Customer Part Number	Current Revision	New Revision
----------------	---------------------	----------------------	------------------	--------------

<a href="#">828920</a>	828920-1		M8	
------------------------	----------	--	----	--

**Customer:** TTI Inc( 1281288 )

**Location:** Fort Worth

**Agreement Number:** Agreement Unknown

The documents listed below are being modified. Related parts that are not explicitly listed on this PCN are not being modified or discontinued as per the PCN. The Last Order Date, Last Ship Date, First Date to Ship Changed Parts and last date for Mixed Shipments apply only to parts explicitly listed on this PCN.

**Customer Drawing(s) Being Modified:**

<b>Drawing Number</b>	<b>Related Part Number</b>	<b>Customer Part Number</b>	<b>Current Revision</b>	<b>New Revision</b>
<a href="#">828920</a>	828920-1		M8	

## C-828920 REV. M8 (ACTUAL REVISION)

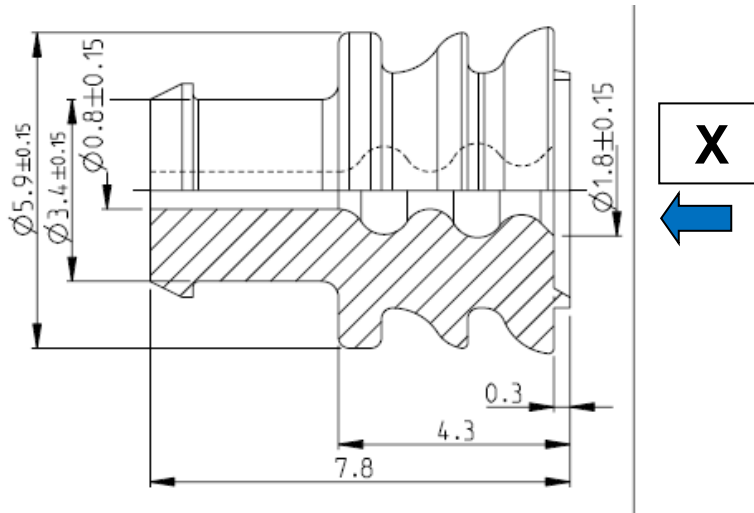

### VIEW FROM "X"

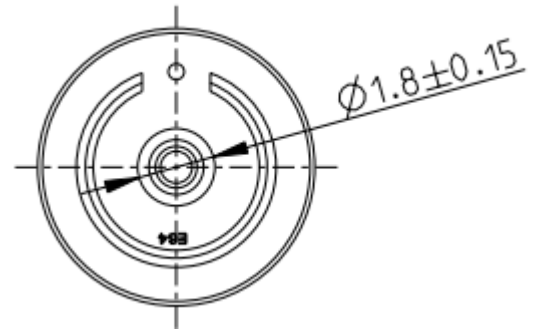

## C-828920 REV. M9 (FUTURE REVISION)

**ADDED ALTERNATIVE (TO EXISTING  $\varnothing 1.8\text{mm}$ )  
INNER HOLE INGRESS DIAMETER DIMENSION.**

**THIS IS AN ALREADY EXISTING SITUATION ON  
ACTUAL MOULDS THAT HAS ONLY BEEN  
REGULARIZED ON DRAWING.**

ALTERNATIVE DESIGN ADMITTED:

