



Product Change Notification

Current Date: 03-Nov-2020

TE Connectivity

Product Change Notification: E-20-004812

PCN Date: 03-NOV-20

Customer: TTI, Inc. (1305175)

Location: Maisach-gernlinden

Agreement: TTI001

TE would like to inform you of the following change(s) to the listed TE Connectivity Product. In case of any further questions about this change(s), please contact your TE Connectivity Sales Engineer. Affected part, drawing and/or specification numbers are listed on the attached sheet(s).

General Product Description:
SFP PLUS CONNECTOR

Description of Changes
There have been no changes to the existing parts, the drawings have been modified to show a new product offering and print dimensions clarify.
Other attachments:
[1888247C](#)

Reason for Changes:	
New Product. ADD NEW PART NUMBER 1888247-7	
Estimated Dates:	
Last Order Date (Obsolete Parts Only):	First Date To Ship (Changed Parts Only):
Last Ship Date (Obsolete Parts Only):	Last Date for Mixed Shipments: (Changed Parts Only):
	No Mixed Shipments

The documents listed below are being modified. Related parts that are not explicitly listed on this PCN are not being modified or discontinued as per the PCN. The Last Order Date, Last Ship Date, First Date to Ship Changed Parts and last date for Mixed Shipments apply only to parts explicitly listed on this PCN.

Note: This PCN contains only document changes, these changes do not affect the form, fit or function of the parts referenced.

Customer Drawing(s) Being Modified:

Drawing Number	Related Part Number	Customer Part Number	Current Revision	New Revision
1888247	1888247-1	TYC1888247-1	N	

LOC	DIST	REVISIONS			
ES	00	#	DATE	BY	APPV
		L	16DEC2015	PP	SH
		M	20JUN2017	JW	SH
		N	24JUN2019	IT	SH
		NI	10JUN2020	IT	SH

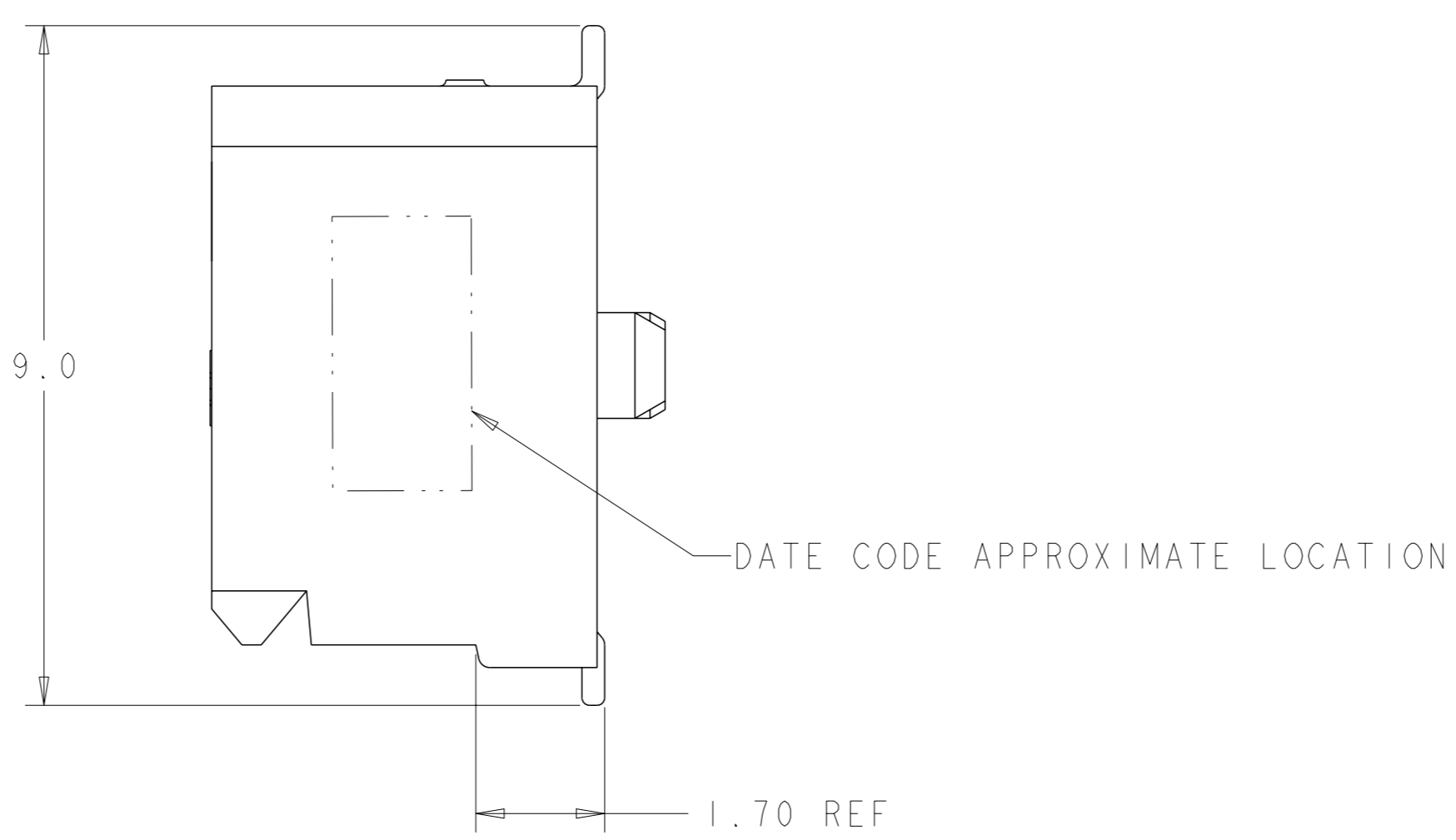
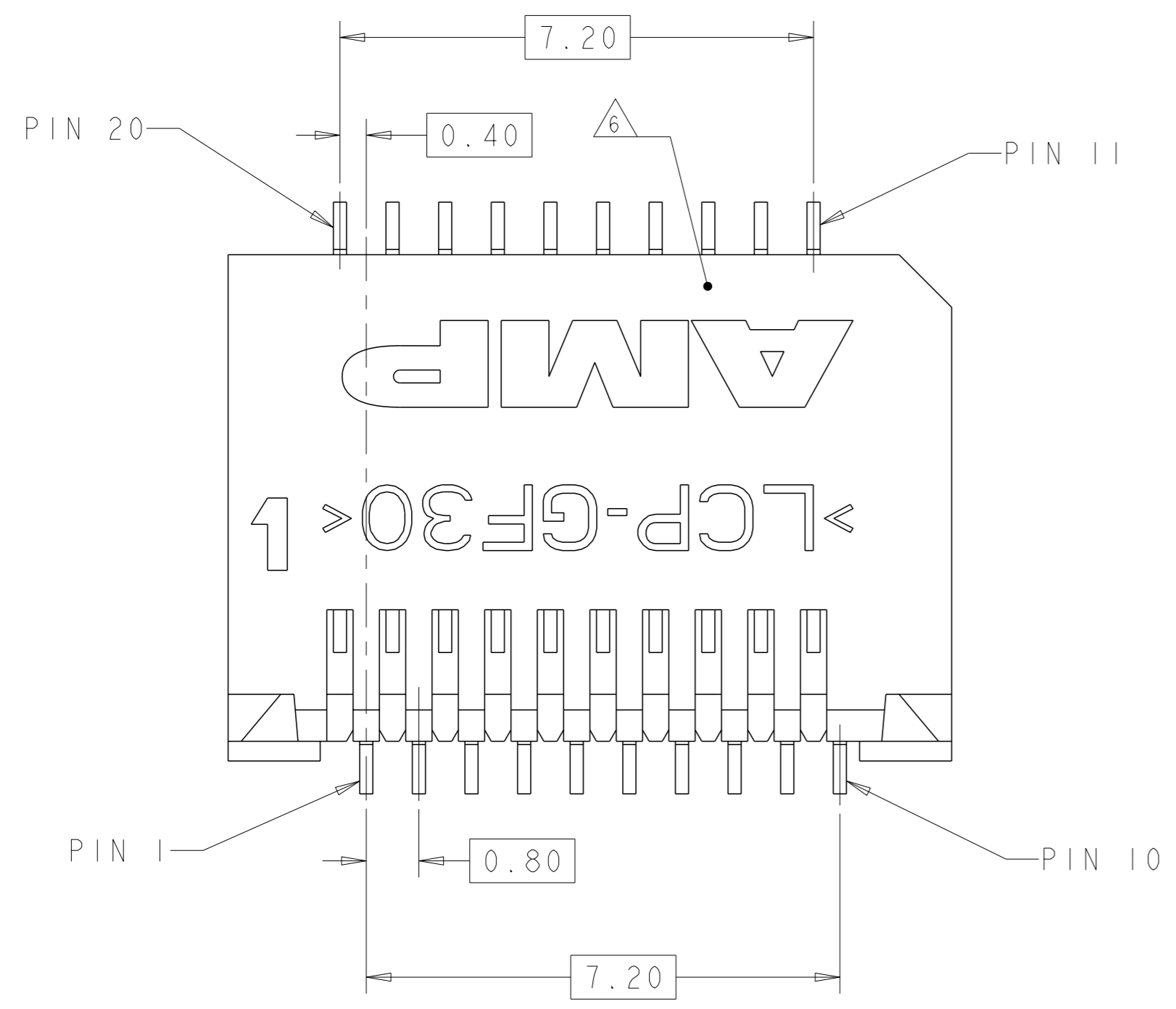

- 1. MATERIAL:
HOUSING: HIGH TEMPERATURE LCP, UL 94V-0 RATED, BLACK
CONTACTS: PHOSPHOR BRONZE.
- 2. FINISH:
CONTACTS: 0.00076 MIN GOLD ON CONTACT AREA, 0.00013 MIN GOLD ON SOLDER AREA. ALL OVER 0.00127 MIN NICKEL UNDERPLATE ON ENTIRE CONTACT. LUBRICANT ON GOLD PLATE CONTACT AREAS.
- 3. PACKAGED 480 PIECES PER REEL.
- 4. DATUMS AND BASIC DIMENSIONS TO BE ESTABLISHED BY CUSTOMER, SEE DRAWING 1367034 FOR LAYOUT WHEN USED WITH 1367034-1 BOTTOM CAGE (STANDARD SFP APPLICATION).
- 5. FINISH:
CONTACTS: 0.00038 MIN GOLD ON CONTACT AREA, 0.00013 MIN GOLD ON SOLDER AREA. ALL OVER 0.00127 MIN NICKEL UNDERPLATE ON ENTIRE CONTACT. LUBRICANT ON GOLD PLATE CONTACT AREAS.
- 6. PULL GROOVES PERMITTED ON THESE SURFACES AT MOLDING ENGINEERING DISCRETION
- 7. FOR ESD PROTECTION TAPE AND REEL PACKAGE ONLY. MATERIALS (COVER TAPE, EMBOSS TAPE, REEL, INNER LABEL ON REEL) USED WITH AN EPA AREA MUST PRIMARILY BE ELECTROSTATIC CONDUCTIVE OR ELECTROSTATIC DISSIPATIVE. NO MATERIAL SHOULD BE CHARGED UP TO MORE THAN 100 VOLTS.
- 8. TEMPERATURE RATING: -55°C TO 105°C
- 9. CUSTOMIZED PART NUMBER.

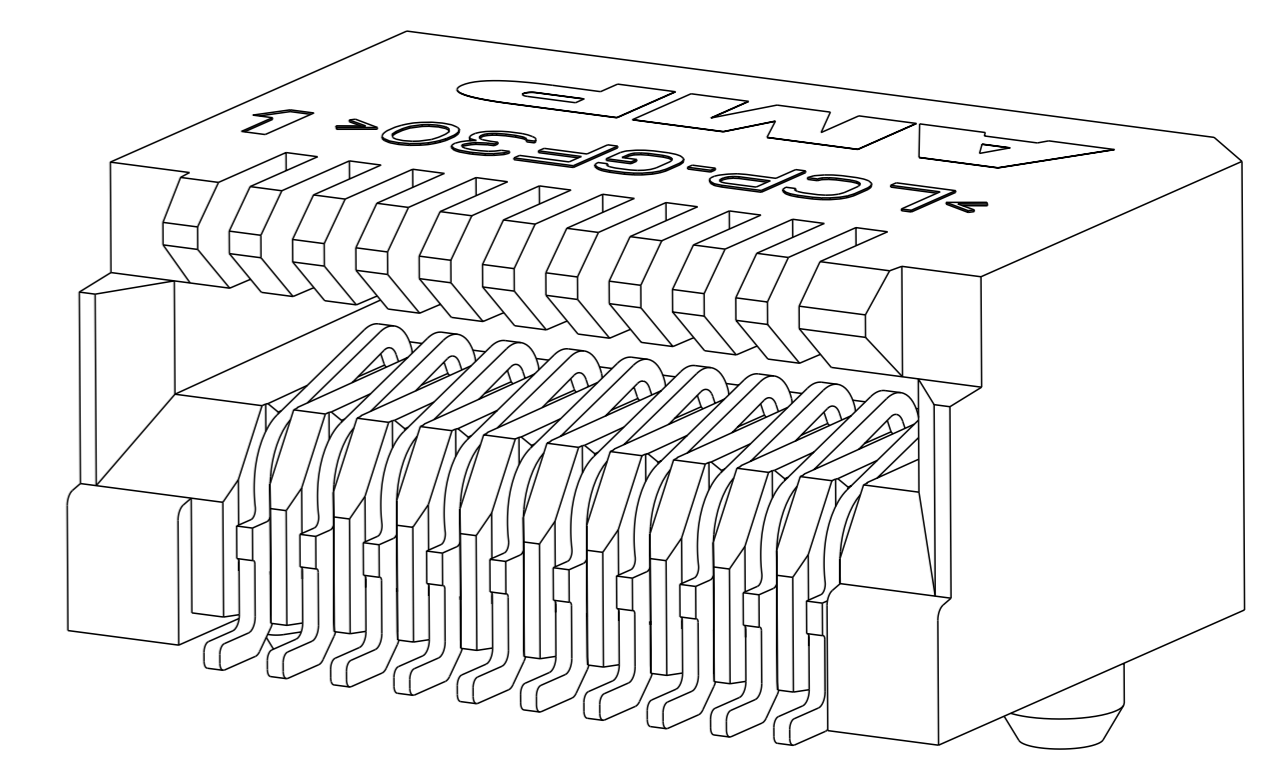
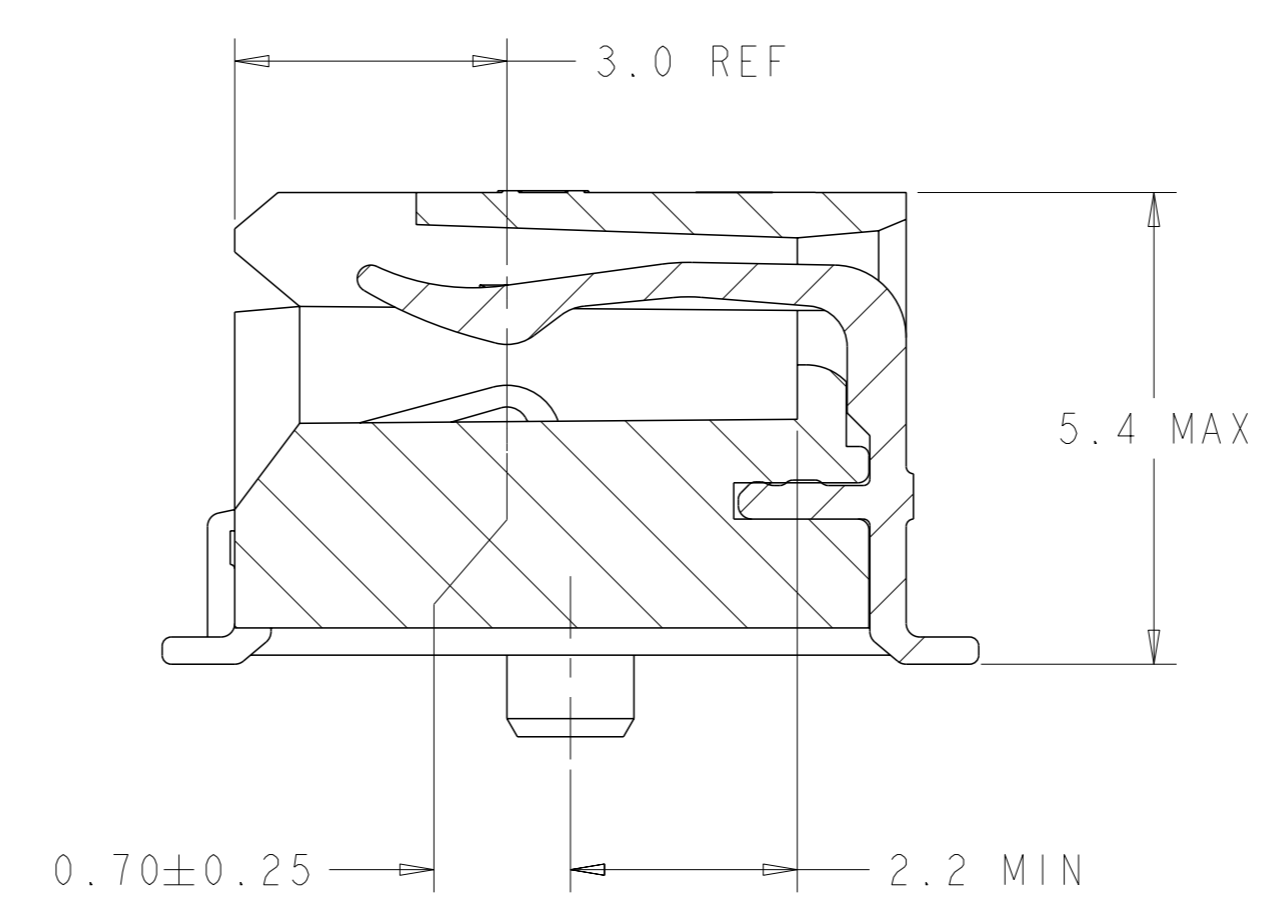
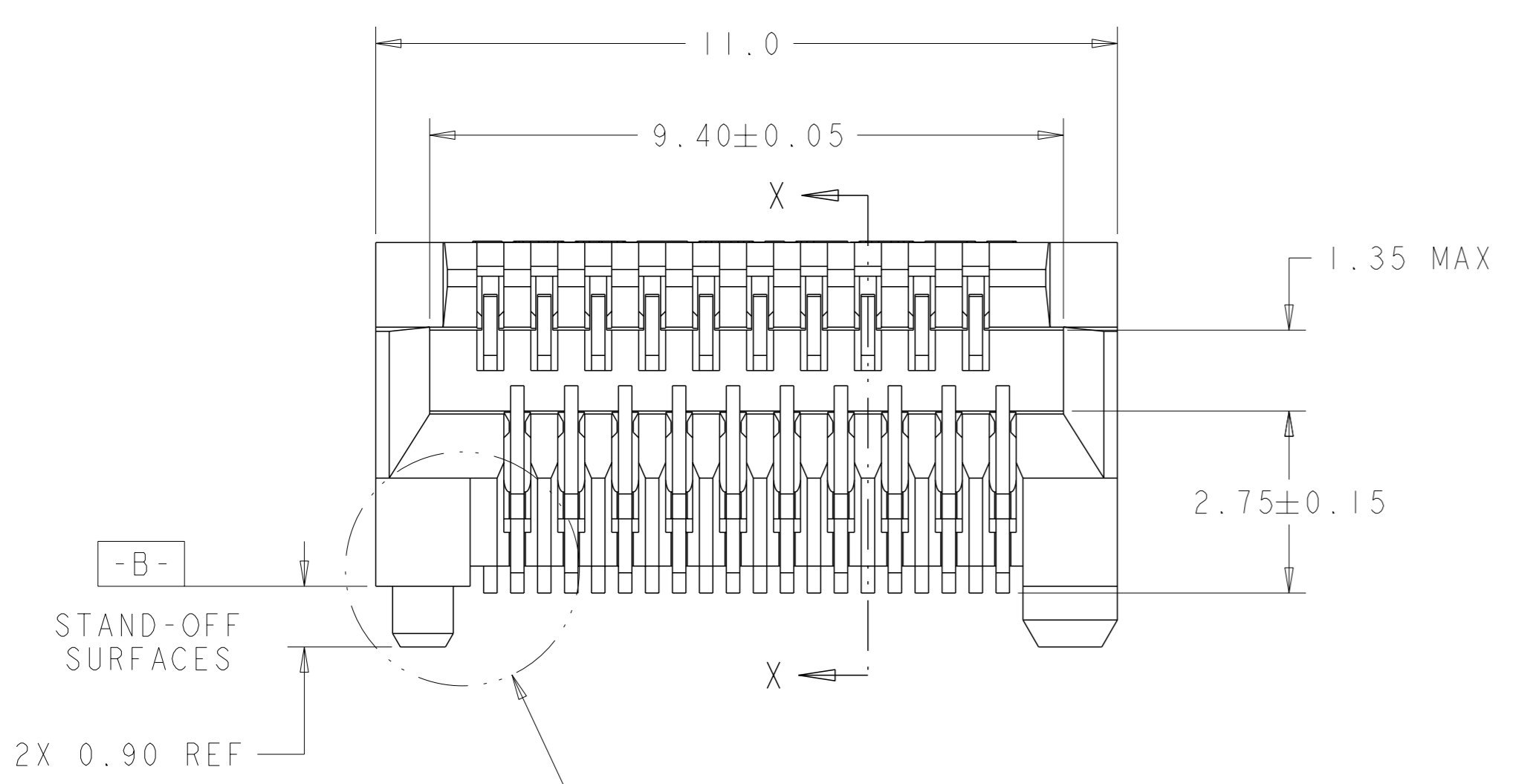

1888247-1,2,3,4,5,7 AS SHOWN

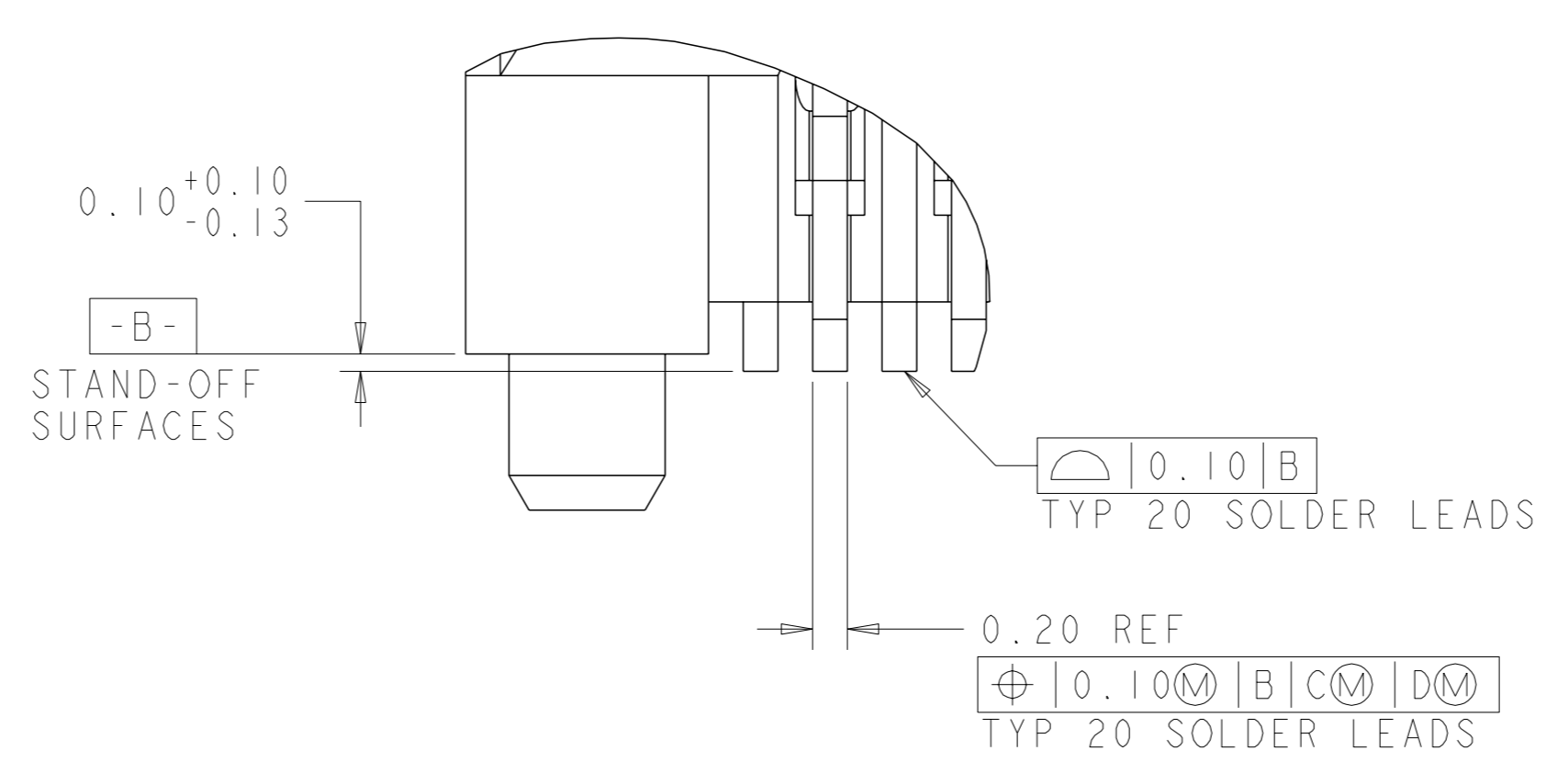
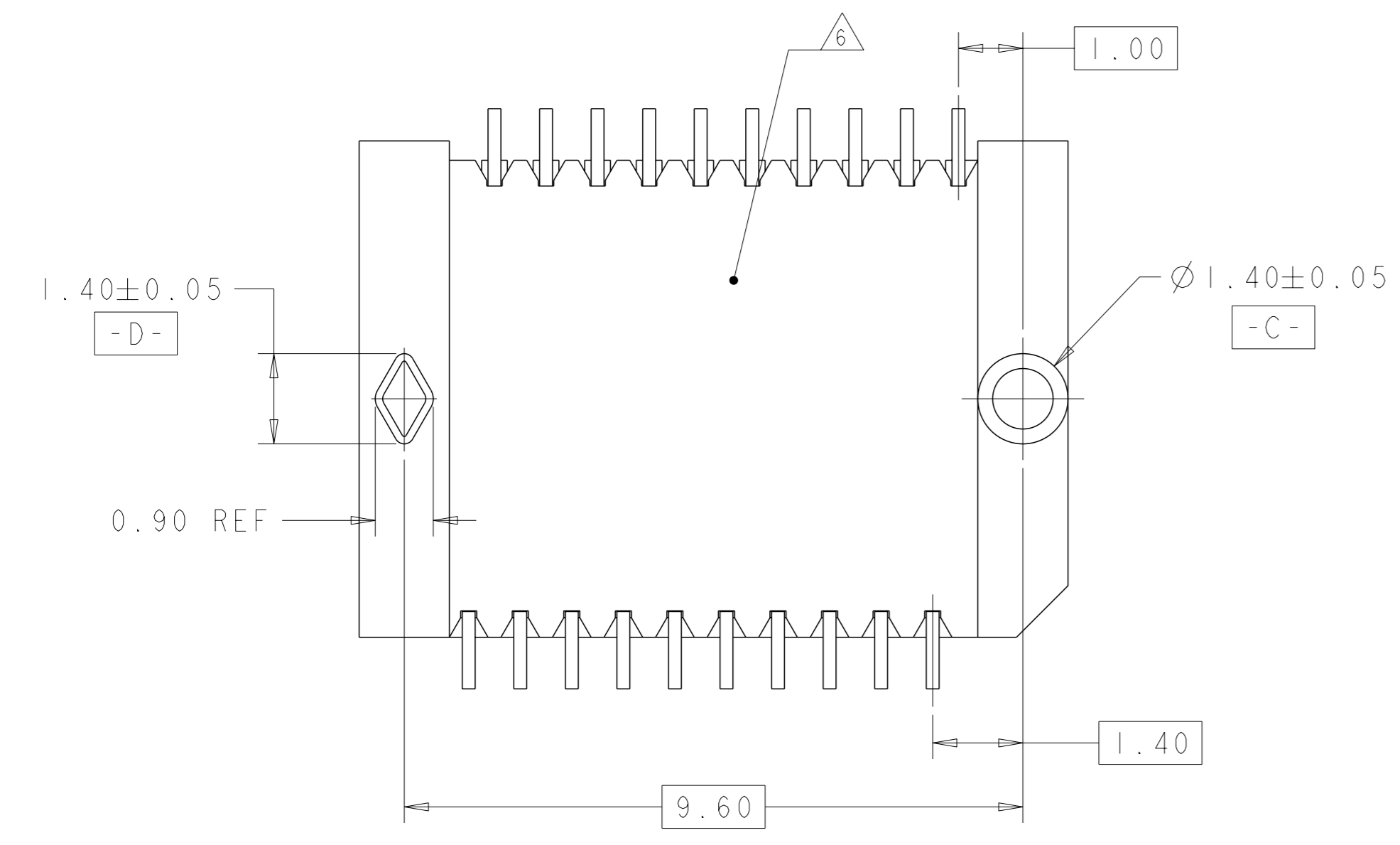

DETAIL H
SCALE 25:1

9	NO	2	1888247-7
7	NO	2	1888247-5
	YES	5	1888247-4
	YES	2	1888247-3
	NO	5	1888247-2
	NO	2	1888247-1
	DATE CODE	FINISH	PART NUMBER

THIS DRAWING IS A CONTROLLED DOCUMENT.

DIMENSIONS:	TOLERANCES UNLESS OTHERWISE SPECIFIED:	OWN: B. MCMASTER 14FEB06	CHK: S. SHUEY 14FEB06	APV: S. SHUEY 14FEB06	NAME: PT CONNECTOR ASSEMBLY, 20 POS, RIGHT ANGLE, 0.8mm PITCH, SFP+
mm	0 PLC ± 1 PLC ±0.20 2 PLC ±0.10 3 PLC ± 4 PLC ± ANGLES ±	SIZE: 108-1949	PRODUCT SPEC: 114-13017	APPLICATION SPEC: 114-13017	RESTRICTED TO: -
MATERIAL:	FINISH:	WEIGHT:	CAGE CODE: A100779	DRAWING NO: C=1888247	SCALE: 12:1
			CUSTOMER DRAWING	SHEET 1 OF 4	REV: 1

STE TE Connectivity

LOC	DIST	REVISIONS					
ES	00	P	LYR	DESCRIPTION	DATE	OWN	APVD
		-		SEE SHEET 1	-	-	-

1888247-6 AS SHOWN
 PRINT PART NUMBER AND DATE CODE ON TOP
 ALL OTHERS SAME AS 1888247-2

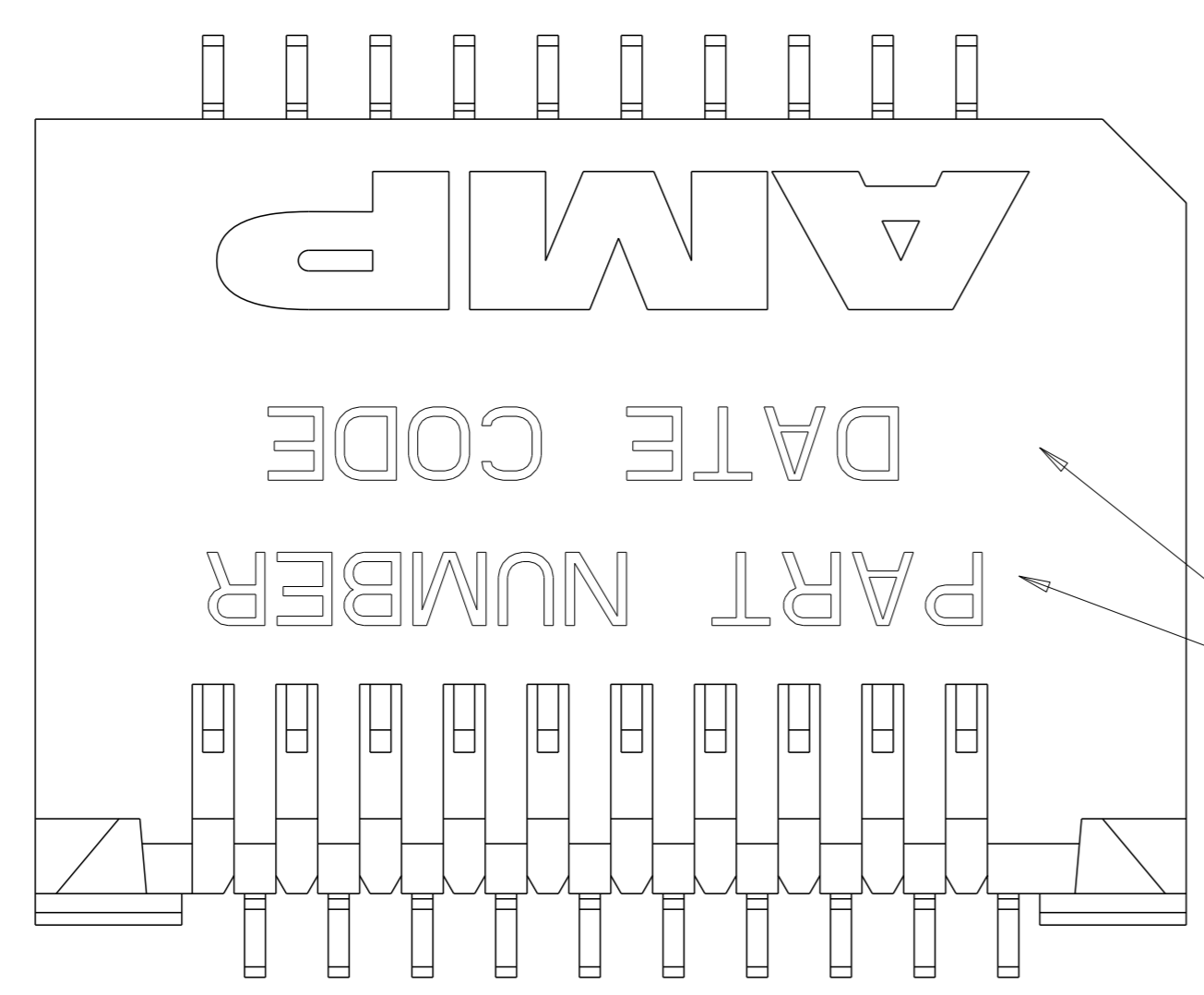

PART NUMBER AND DATE CODE
 APPROXIMATE LOCATION

SCALE 15:1

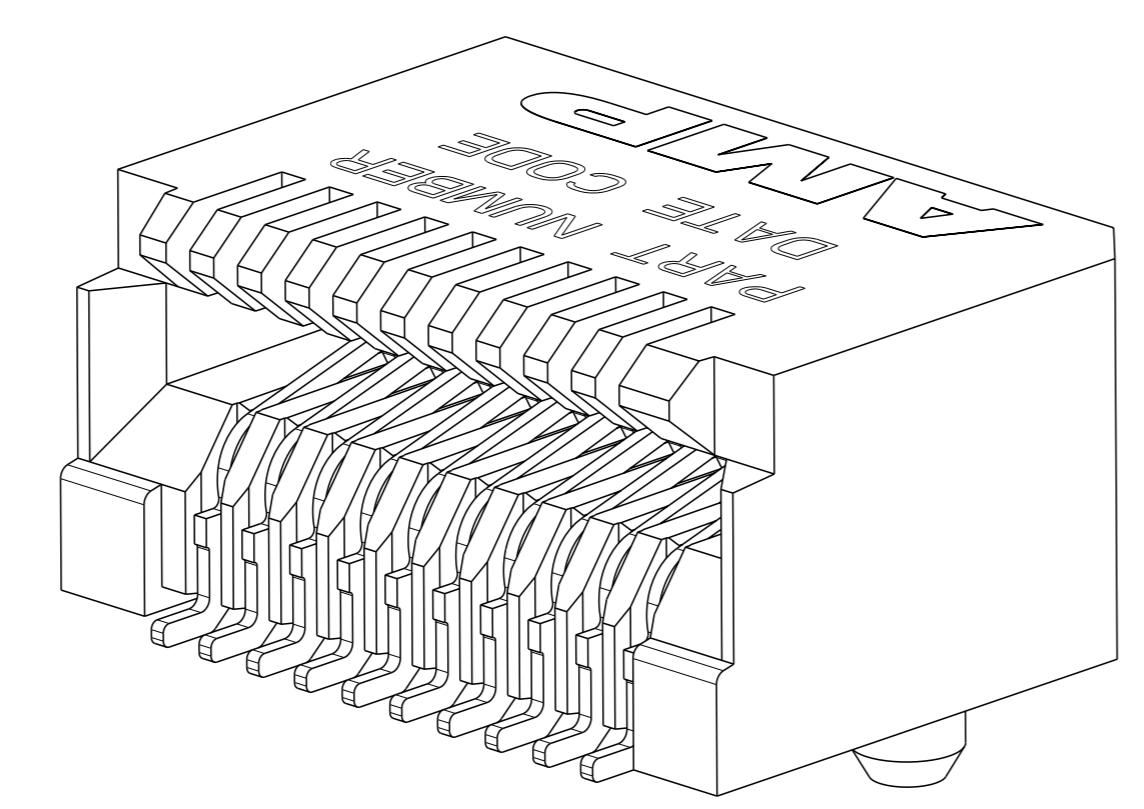
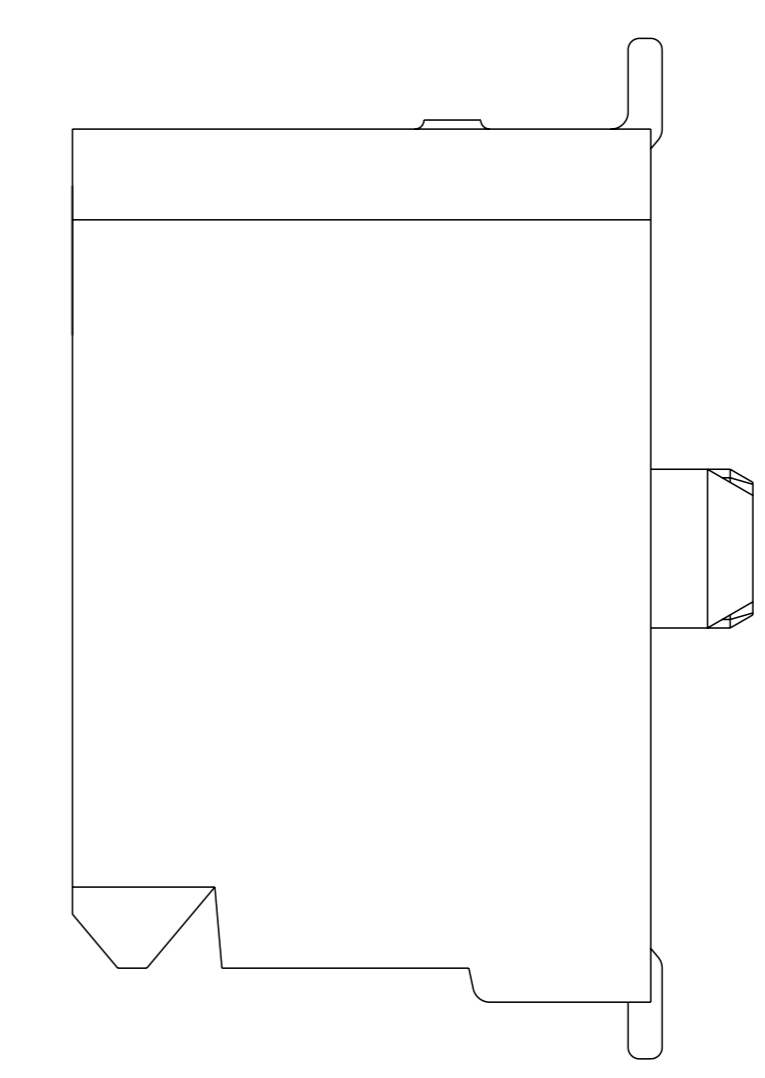

1888247-6 AS SHOWN

YES	YES	△	1888247-6
PART NUMBER	DATE CODE	FINISH	PART NUMBER

THIS DRAWING IS A CONTROLLED DOCUMENT.		OWN B. MCMASTER	14FEB06	TE Connectivity NAME PT CONNECTOR ASSEMBLY, 20 POS. RIGHT ANGLE, 0.8mm PITCH, SFP+			
DIMENSIONS:		CHK S. SHUEY	14FEB06				
TOLERANCES UNLESS OTHERWISE SPECIFIED:		APVD S. SHUEY	14FEB06				
mm		PRODUCT SPEC	108-1949				
0 PLC	±	APPLICATION SPEC	114-13017	SIZE	CAGE CODE	DRAWING NO	RESTRICTED TO
1 PLC	±0.10	WEIGHT	-	A1	00779	1888247	-
2 PLC	±	MATERIAL	-	CUSTOMER DRAWING			
3 PLC	±	FINISH	-	SCALE	12:1	SHEET	2 OF 4
4 PLC	±						
ANGLES	±						

LOC	DIST	REVISIONS			
ES	00	REV	DATE	OWN	APVD
		1	SEE SHEET 1		

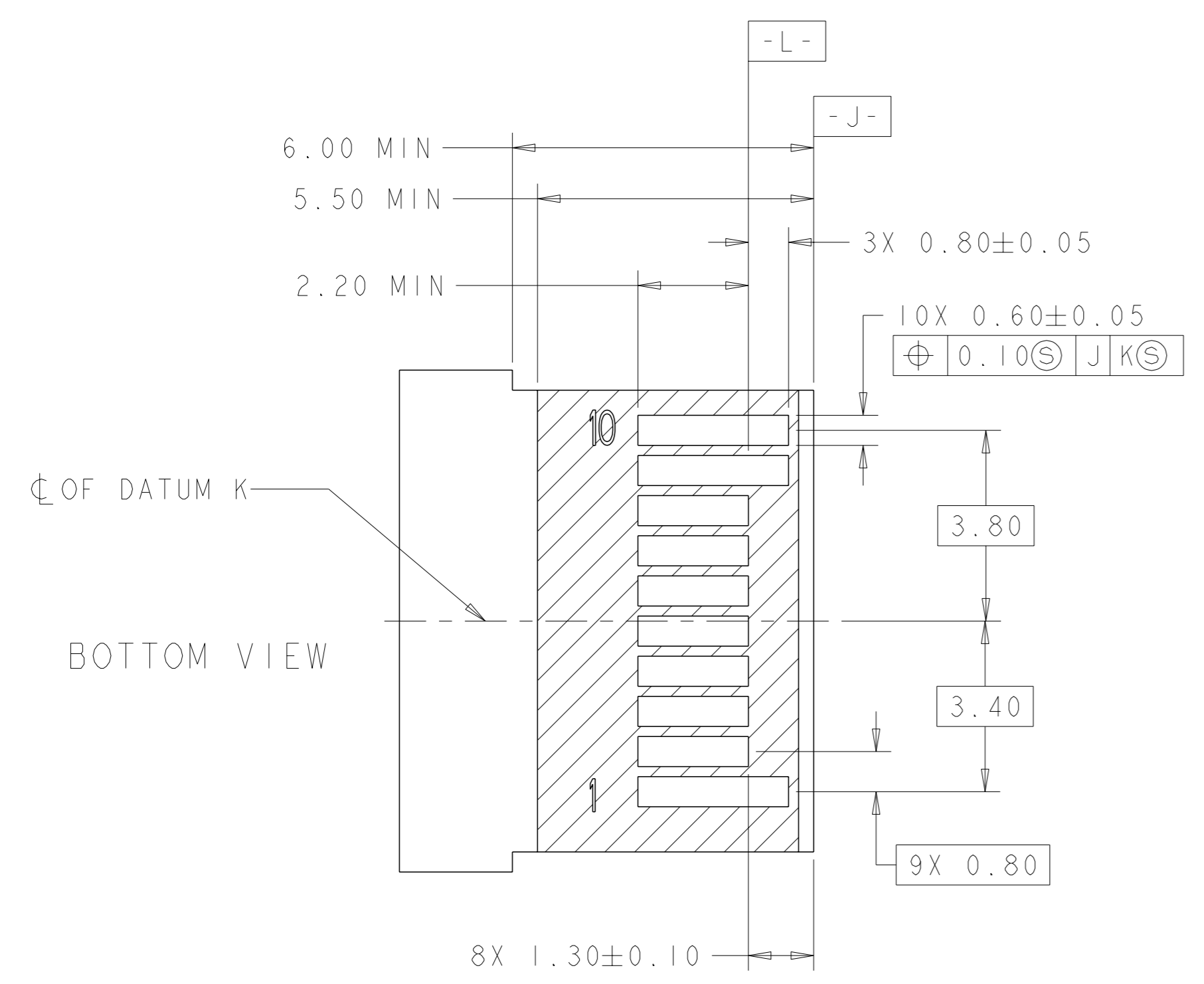
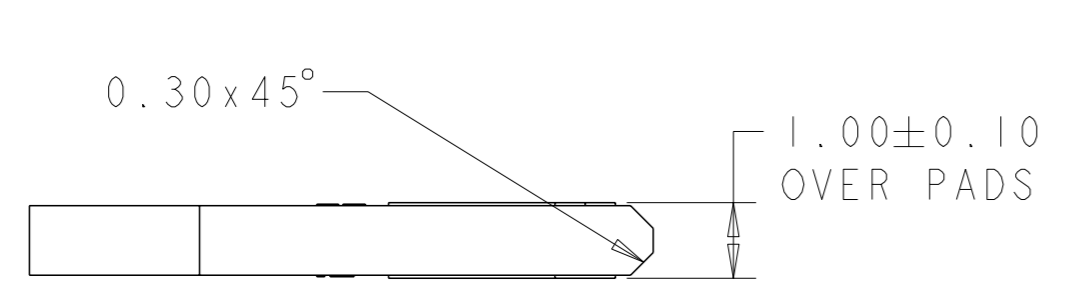
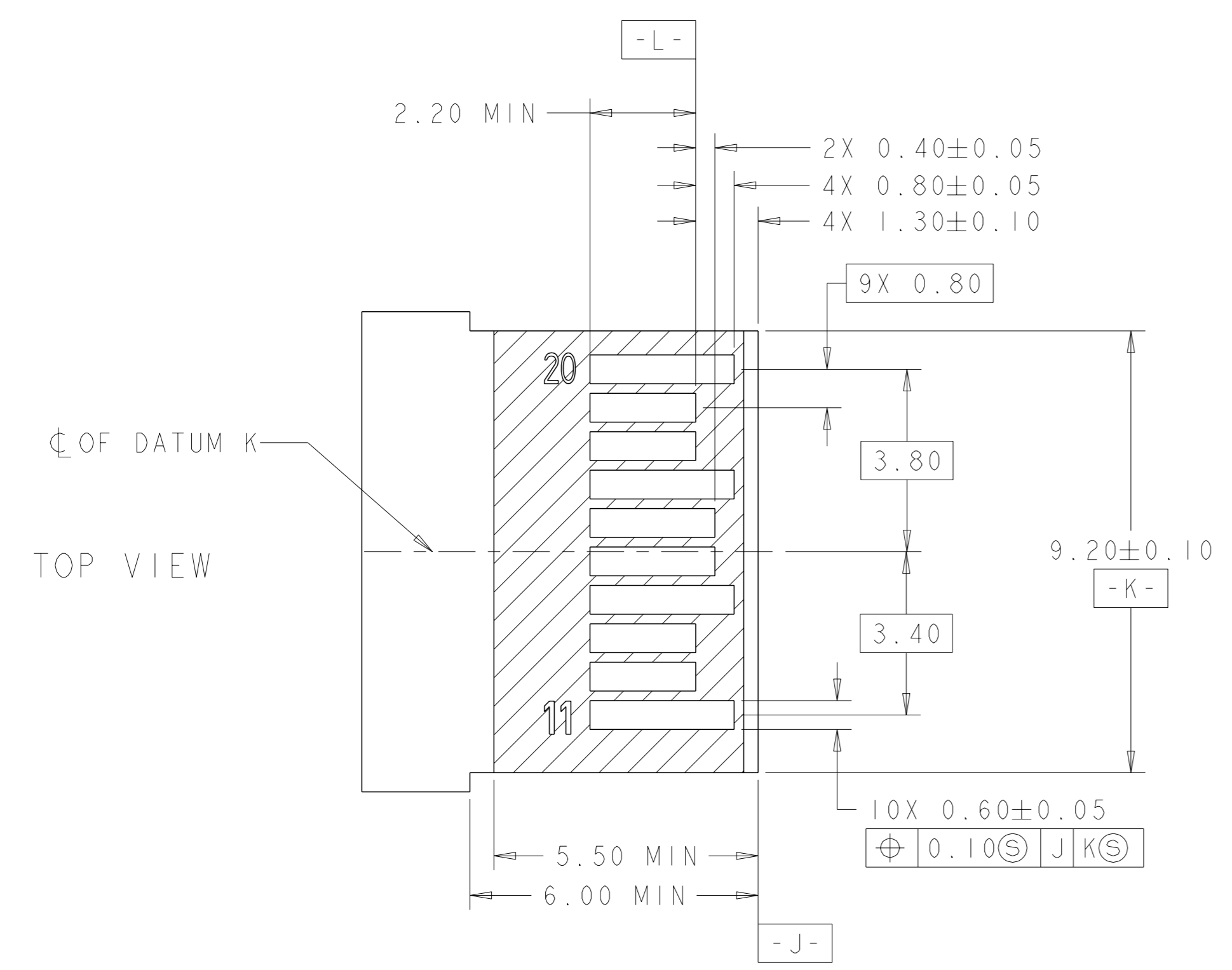

RECOMMENDED LAYOUT DETAIL
MATING TRANSCEIVER PCB
SCALE 10:1

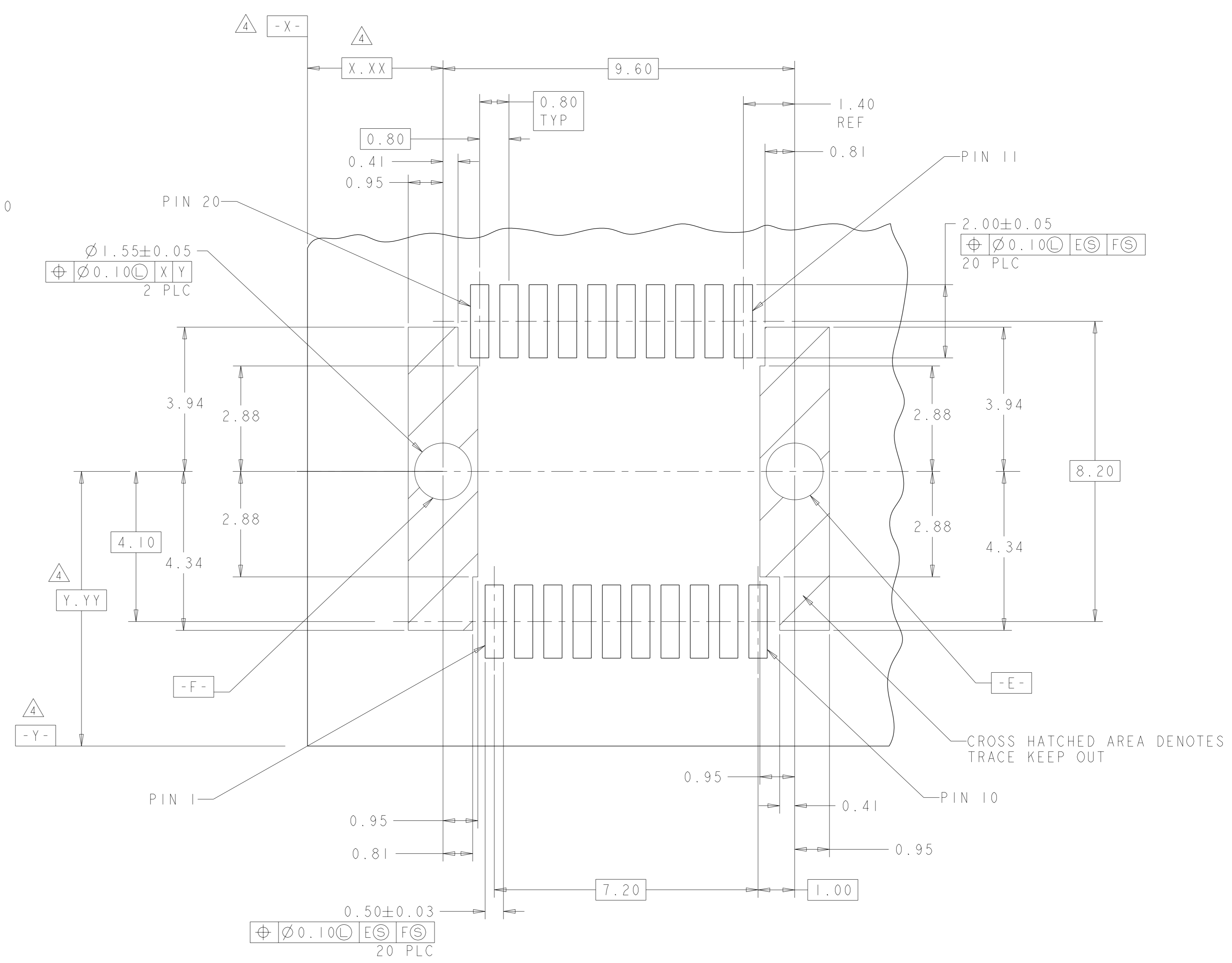

RECOMMENDED PCB LAYOUT DETAIL
CONNECTOR MOUNTING SIDE
SCALE 14:1

THIS DRAWING IS A CONTROLLED DOCUMENT.		OWN: B. MCMASTER 14FEB06	TE Connectivity
DIMENSIONS: mm		CHK: S. SHUEY 14FEB06	
TOLERANCES UNLESS OTHERWISE SPECIFIED:		APVD: S. SHUEY 14FEB06	NAME: PT CONNECTOR ASSEMBLY, 20 POS, RIGHT ANGLE, 0.8mm PITCH, SFP+
0 PLC ±	1 PLC ±0.10	PRODUCT SPEC	108-1949
2 PLC ±	3 PLC ±	APPLICATION SPEC	114-13017
4 PLC ±	ANGLES ±	FINISH	WEIGHT
MATERIAL			SIZE: A1
			CAGE CODE: 100779
			DRAWING NO: 1888247
			RESTRICTED TO: -
			SCALE: 12:1
			SHEET: 3 OF 4
			REV: N1

LOC	DIST	REVISIONS			
ES	00	REV	DATE	OWN	APVD
		-		-	-
		SEE SHEET 1			

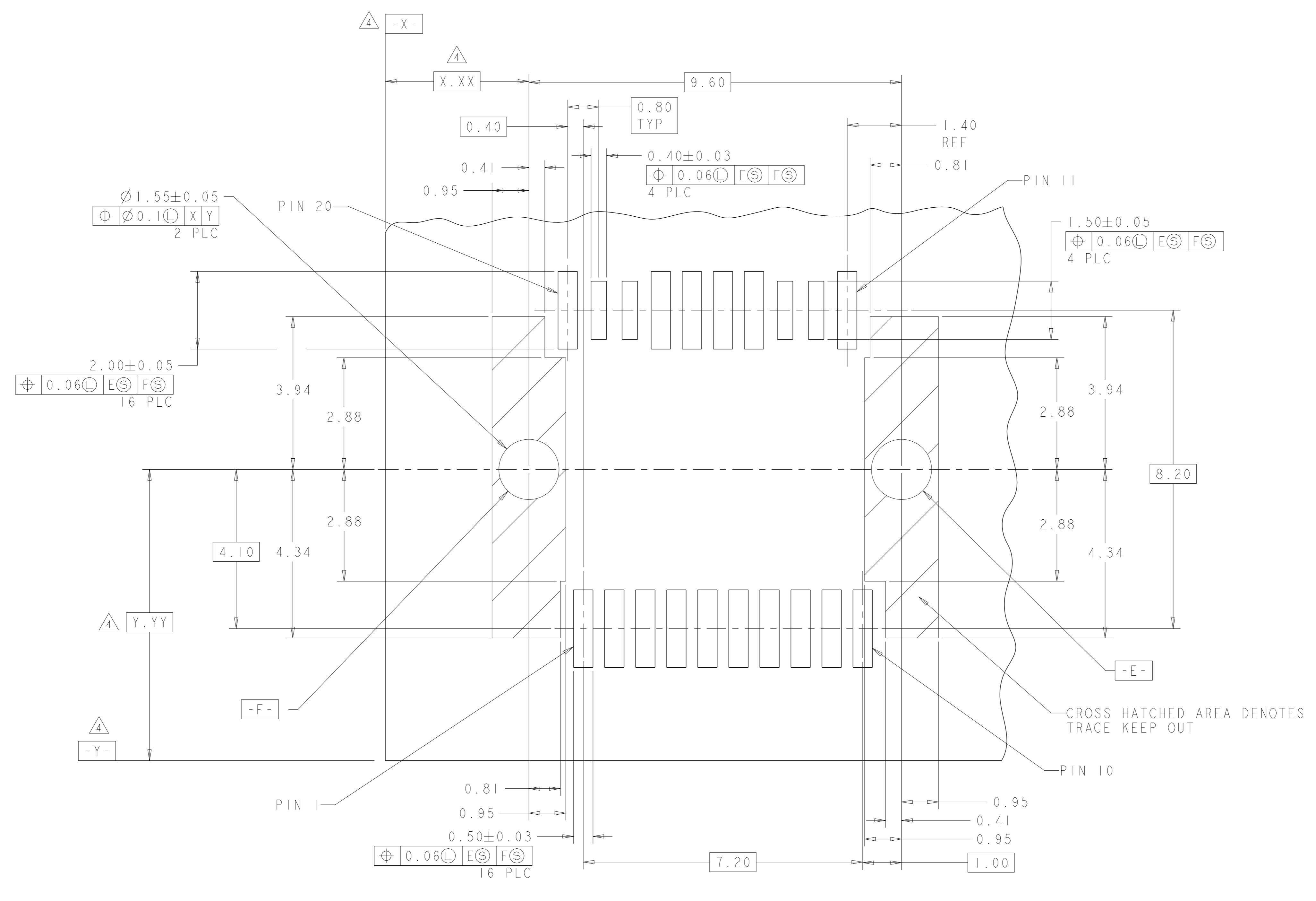

OPTIONAL LAYOUT FOR IMPROVED SIGNAL INTEGRITY, MOUNTING SIDE
 SCALE 16:1

THIS DRAWING IS A CONTROLLED DOCUMENT.		OWN B. MCMASTER CHK S. SHUEY APVD S. SHUEY	14FEB06 14FEB06 14FEB06	TE Connectivity NAME PT CONNECTOR ASSEMBLY, 20 POS. RIGHT ANGLE, 0.8mm PITCH, SFP+
DIMENSIONS:	TOLERANCES UNLESS OTHERWISE SPECIFIED:	PRODUCT SPEC	108-1949	
mm	0 PLC ± 1 PLC ± 2 PLC ±0.10 3 PLC ± 4 PLC ±	APPLICATION SPEC	114-13017	
MATERIAL	FINISH	WEIGHT	114-13017	RESTRICTED TO
CUSTOMER DRAWING		SCALE 12:1	SHEET 4 OF 4	REV N1