

The products listed in this catalog are only a few of the thousands of variations that TUSONIX produces. For custom component design, please contact the factory direct.

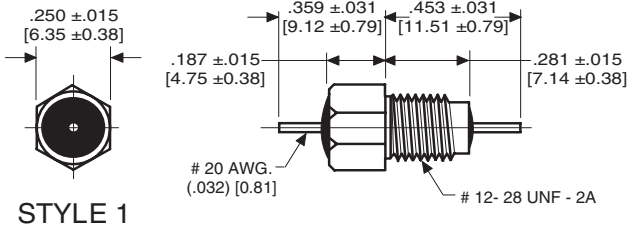

#8-36 UNF-2A and #12-28 UNF-2A Pi & C Filters and Feed-Thru Capacitors



STYLE 1

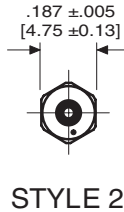

STYLE 2

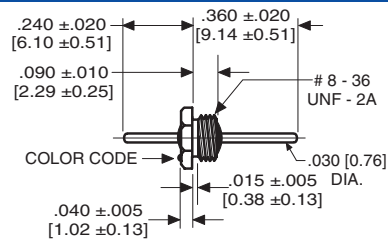

inches
[mm]

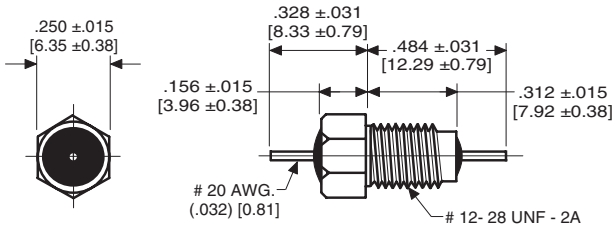

STYLE 3

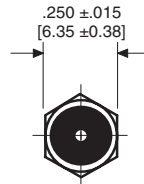

STYLE 4

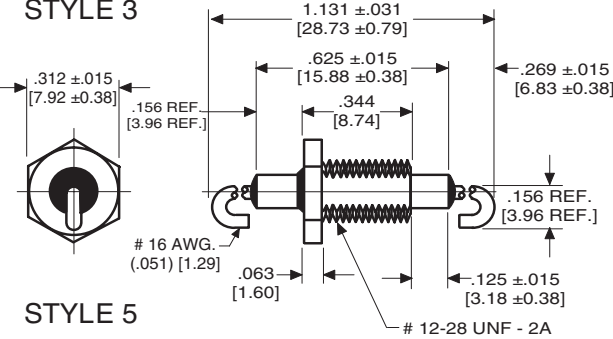
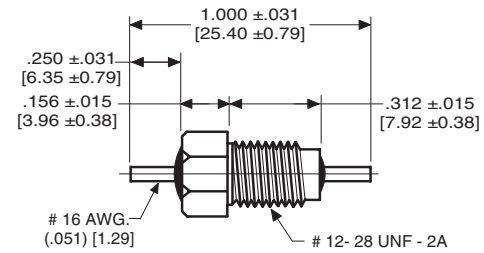

STYLE 5

Series Number	Temperature Range	WVDC	MAX. CAP. Nominal (pF)
2499	Z5, Y5, X5	500	10,000
	X7	250	10,000
357	Z5, Y5, X5	500	10,000
	X7	250	10,000

Notes:	
◆	Turret Lead
●	Typical Insertion Loss
▽	No Hex Nut Included

Please see Temperature Characteristics and EIA Codes on Page 25.

TUSONIX Part Number	MIL-PRF-15733 Number	Style	Notes	Circuit	Working Voltage (dc)		Capacitance (pF)	Capacitance Tolerance	Current (A)	Minimum No-Load Insertion Loss (dB) at 25°C per MIL-Std-220							
					85°C	125°C				1MHz	10MHz	100MHz	1GHz	10GHz			
C Configuration																	
4401-005	--	2	▽	C	70	50	10,000	GMV	10	4	21	35	50	60			
4401-006	--	2	▽	C	70	50	15,000	GMV	10	7	20	35	55	60			
4401-010	--	2	▽	C	70	50	27,000	GMV	10	10	28	42	65	65			
4401-011	--	2	▽	C	50	50	50,000	GMV	10	15	35	45	70	--			
4401-003	--	2	▽	C	150	100	2700	GMV	10	--	10	25	40	50			
4401-004	--	2	▽	C	150	100	5000	GMV	10	--	15	30	45	55			
4401-680	--	2	▽	C	300	200	5	MAX	10	--	--	--	--	--			
4401-008	--	2	▽	C	300	200	10	GMV	10	--	--	--	5	20			
4401-009	--	2	▽	C	300	200	25	GMV	10	--	--	--	10	25			
4401-000	--	2	▽	C	300	200	100	GMV	10	--	--	3	20	28			
4401-001	--	2	▽	C	300	200	500	GMV	10	--	--	15	35	40			
4401-007	--	2	▽	C	300	200	1000	GMV	10	--	5	20	35	45			
4401-002	--	2	▽	C	300	200	1200	GMV	10	--	5	20	35	45			
Pi Configuration																	
4202-053	--	3	--	Pi	200	100	5000	GMV	10	--	20	65	70	70			
4202-054	--	3	◆	Pi	200	100	5000	GMV	10	--	20	65	70	70			
4204-050	--	1	--	Pi	200	100	5000	GMV	10	--	20	65	70	70			
4204-051	--	1	◆	Pi	200	100	5000	GMV	10	--	20	65	70	70			
4202-020	--	3	--	Pi	350	200	1500	GMV	10	--	5	45	70	70			
4202-021	--	3	◆	Pi	350	200	1500	GMV	10	--	5	45	70	70			
4204-000	--	1	--	Pi	350	200	1500	GMV	10	--	5	45	70	70			
4204-001	--	1	◆	Pi	350	200	1500	GMV	10	--	5	45	70	70			
4204-500	/61-0001	1	--	Pi	--	200dc 140ac	1500	GMV	10ac	--	--	45	70	70			
4204-501	/43-0001	1	◆	Pi	--	200dc 140ac	1500	GMV	10ac	--	--	--	45	45			
C Configuration																	
2499-003-X5U0-102P	--	4	●	C	500	250	1000	+100-0%	20	--	3	20	35	40			
2499-003-X5W0-502P	--	4	●	C	500	250	5000	+100-0%	20	--	15	30	45	50			
2499-003-X5W0-103Z	--	4	●	C	500	250	10,000	+80-20%	20	--	20	35	50	55			
357-001-X5W0-103Z	--	5	●	C	500	250	10,000	+80-20%	20	--	20	35	50	55			