



9mm Snap-In Insulated Shaft Potentiometer
9mm 嵌入式塑膠軸旋轉電位器

R-0901G



Part Number

R-0901G - B 50K , L- 20 KC / H:6.5

↓ Taper ↓ Resistance Value ↓ Shaft Type
 線性 阻值 軸型
 ↓
 Shaft Length
 軸長

Dimensions 規格尺寸

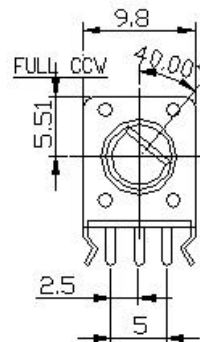
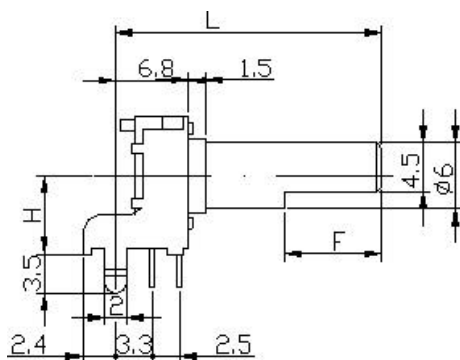

shaft shown in full c.c.w. position

P.C.B LAYOUT

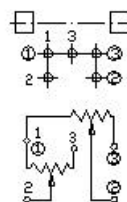
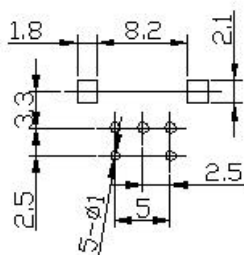

H	6.5	10	12.5
---	-----	----	------

Shaft Type 軸型

KQ TYPE:

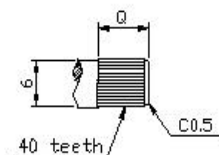

KT TYPE:

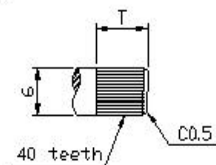

F TYPE:

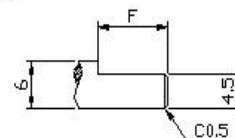

L	15KQ	20KQ	25KQ	30KQ	35KQ
Q	6	7	7	7	7

L	9KT	15KT	20KT	25KT	30KT
T	-	6	7		

L	15F	20F	25F	30F
F	6	7	12	12



9mm Snap-In Insulated Shaft Potentiometer
9mm 嵌入式塑膠軸旋轉電位器

Electrical Characteristics 電氣特性

All Resistance 總阻值	5K ~ 250K Ω				
All Resistance Tolerance 總阻值誤差	$\pm 30\%$				
Resistance Taper 線性	A. B. C. D. W Taper				
Resistance Taper Characteristics 阻值變化特性範圍	A50%	B50%	C50%	D50%	W50%
	15-25%	40-60%	75-85%	2-15%	45-55%
Rated Power 定格電力	0.03 W				
Residual Resistance 殘留阻值	R \leq 250K 0.1%				
	250K > R > 10K 20 Max.				
	10K \leq R 20 Max.				
Gang error 聯動誤差	-40 ~ 0dB 3 db				
Noise 雜音	47 mV Max.				
Max. Operating Voltage 最高使用電壓	AC 50V; DC12V				
Insulation Resistance 絕緣阻抗	DC 250V 100M Min.				
Withstand Voltage 耐電壓	1 minute at AC 250V Min.				
Working Life 旋轉壽命	15,000 Cycles Min.				

Mechanical Characteristics 機械特性

Total Rotational Angle 全迴轉角度	280° \pm 5°
Rotation Stopper Strength 全迴轉止強度	3kgf.cm max./ 3 sec.
Rotational Torque 迴轉扭力	10 ~ 80gf.cm
Pull-Push Strength 壓入拉起強度	5kgf.cm max./ 3 sec.
Shaft Wobble 軸心搖晃接受力	0.8 x L / 20 mm p-p max.
Center Click Torque C.C.扭力	150 ~ 300 g.cm
Shaft Bending 軸心瞬間彎曲	0.3mm max.
Solder Heat 焊錫耐熱性	300 ,3s (Only For Hand-Soldering)
Remark 備註	§ Insulated shaft of black.