

SMD Power Inductor CDEIR12D45ME



Description

- Metal alloy core construction.
- Magnetically shielded.
- L × W × H: 13.7 × 13.0 × 5.0mm Max.
- Product weight :3.0g(Ref.)
- Moisture Sensitivity Level: 1
- RoHS compliance.

Environmental Data

- Operating temperature range: -40°C ~ +105°C (including coil's self temperature rise)
- Storage temperature range: -40°C ~ +105°C
- Solder reflow temperature: 260 °C peak.

Packaging

- Carrier tape and reel packaging.
- 13.0" diameter reel
- 500pcs per reel

Applications

- Ideally used in Notebook, PDA and other high current application .

Dimension - [mm]

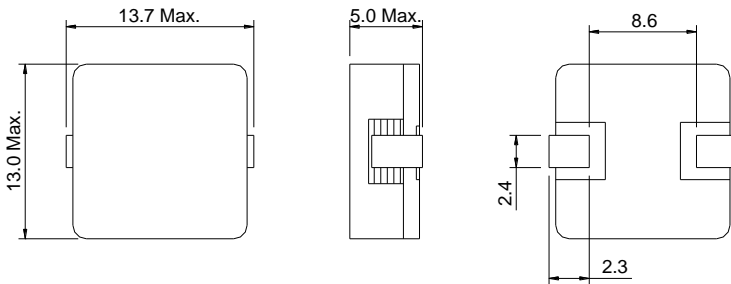

Land pattern and Schematics - [mm]

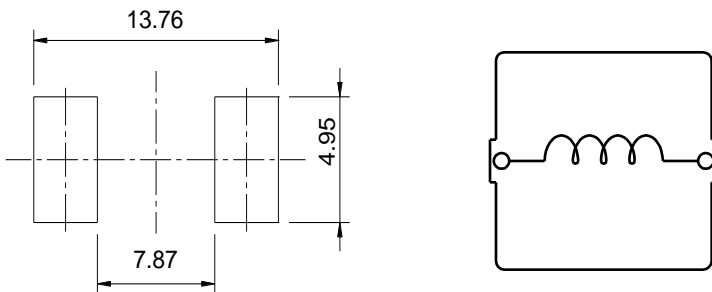

Electrical Characteristics

Part No.	Stamp	Inductance (μ H) [Within] ※2	D. C. R. (m Ω) [Max.]	Saturation current (A) ※3	Temperature Rise Current (A) ※4
CDEIR12D45MENP-1R0MC	1R0	1.0 ± 20%	1.9 (1.6)	29.6 (37.0)	18.0 (21.0)
CDEIR12D45MENP-1R5MC	1R5	1.5 ± 20%	3.8 (3.0)	25.2 (31.5)	14.0 (16.0)
CDEIR12D45MENP-2R2MC	2R2	2.2 ± 20%	5.3 (4.2)	21.6 (27.0)	11.6 (13.4)
CDEIR12D45MENP-3R3MC	3R3	3.3 ± 20%	7.6 (6.1)	15.2 (19.0)	9.8 (11.0)
CDEIR12D45MENP-4R3MC	4R3	4.3 ± 20%	8.9 (7.1)	13.1 (16.4)	9.0 (10.5)

※1. Measuring condition Inductance at 100kHz

※2. The saturation current: The value of DC current when the inductance decreases to 80% of its nominal value (Ta=20°C).

※3. The temperature rise current: The value of DC current when the temperature rise is $\Delta T=40^\circ\text{C}$ (Ta=20°C).

SMD Power Inductor CDEIR12D45ME



Saturation Current & Temperature Rise Graph

— L (25°C) — ΔT

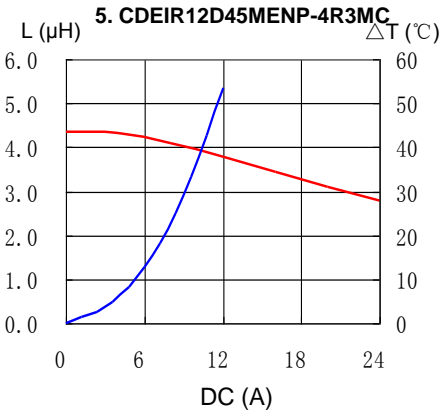
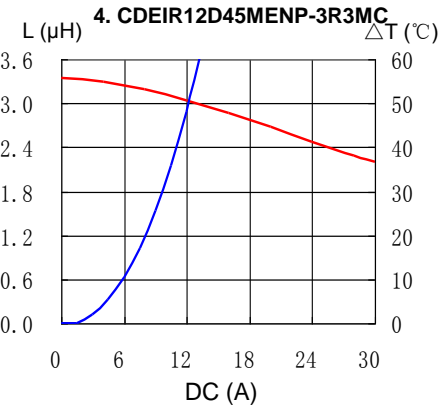
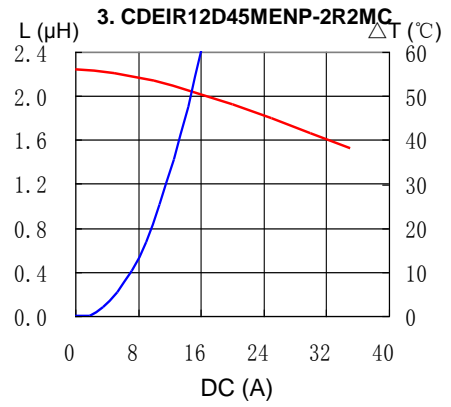
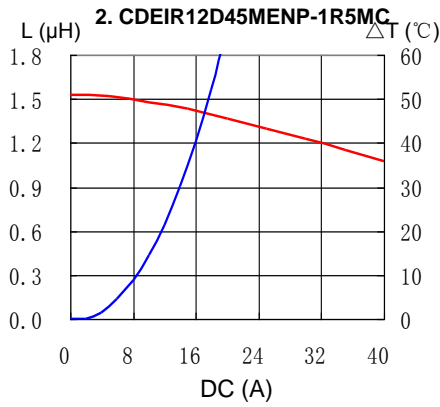
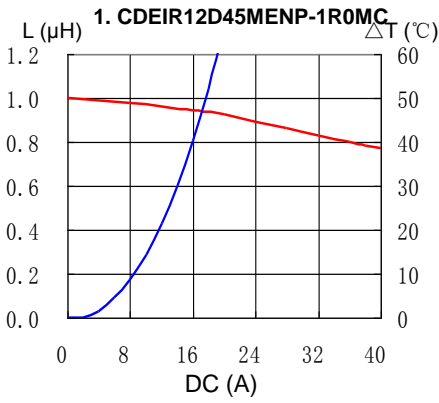

SMD Power Inductor CDEIR12D45ME



Solder Reflow Condition

Heat Endurance

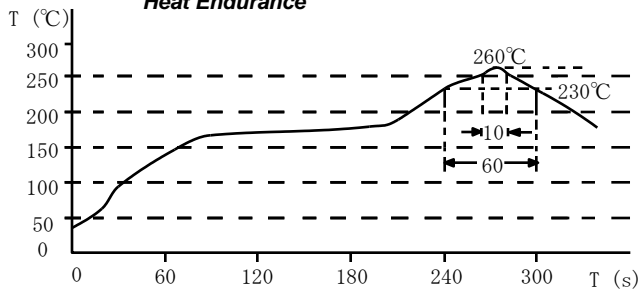

Temperature Chart

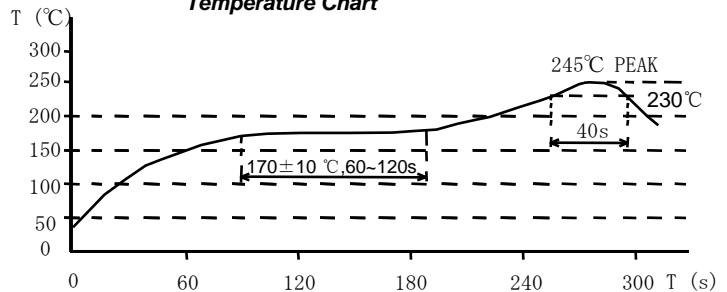

Please refer to the sales offices on our website - <http://www.sumida.com>

Hong Kong

Tel.+852-2880-6781
FAX.+852-2565-9600
sales@hk.sumida.com

Saitama(Japan)

Tel.+81-48-691-7300
FAX.+81-48-691-7340
sales@jp.sumida.com

Chicago

Tel.+1-847-545-6700
FAX. +1-847-545-6720
sales@us.sumida.com

Shanghai

Tel.+86-21-5836-3299
FAX.+86-21-5836-3266
shanghai.sales@cn.sumida.com

Seoul

Tel.+82-2-6237-0777
FAX.+82-2-6237-0778
sales@kr.sumida.com

Obernzell

Tel.+49-8591-937-0
FAX. +49-8591-937-103
contact@eu.sumida.com

Shenzhen

Tel.+86-755-8291-0228
FAX.+86-755-8291-0338
shenzhen.sales@cn.sumida.com

Singapore

Tel.+65-6296-3388
FAX.+65-6841-4426
sales@sg.sumida.com

Neumarkt

Tel.+49-9181-4509-110
FAX. +49-9181-4509-310
infocomp@eu.sumida.com

Taipei

Tel.+886-2-8751-2737
FAX.+886-2-8751-2738
sales@tw.sumida.com

San Jose

Tel.+1-408-321-9660
FAX.+1-408-321-9308
sales@us.sumida.com