

# SMD Power Inductor CDEIR18D88ME

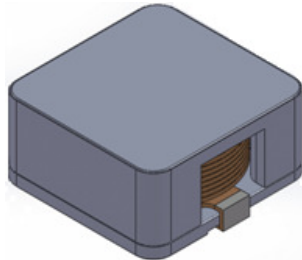

## Description

- Metal alloy core construction.
- Magnetically shielded.
- L × W × H: 20.0 × 18.7 × 9.4mm Max.
- Product weight : 14.9 g(Ref.)
- Moisture Sensitivity Level: 1
- RoHS compliance.

## Environmental Data

- Operating temperature range: -40°C~+125°C (including coil's self temperature rise)
- Storage temperature range: -40°C~+105°C
- Solder reflow temperature: 260 °C peak.

## Packaging

- Carrier tape and reel packaging.
- 13.0" diameter reel
- 150pcs per reel

## Applications

- Ideally used in Notebook, PDA, Communication equipment and other high current application .

## Dimension - [mm]

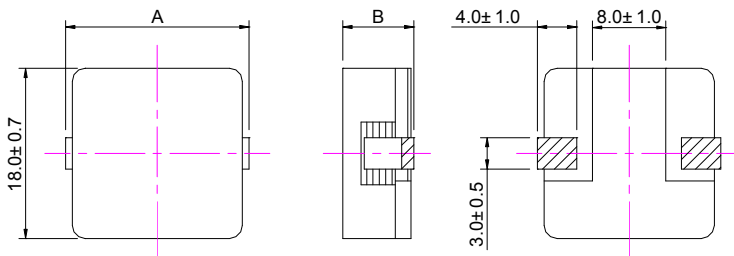

Dimension Inductance	A (Length)	B (Height)
2.6~3.3 $\mu$ H	19.0 $\pm$ 1.0	9.0 $\pm$ 0.4
4.5~10.0 $\mu$ H	18.3 $\pm$ 1.0	8.8 $\pm$ 0.4

## Land pattern and Schematics - [mm]

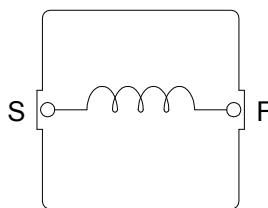
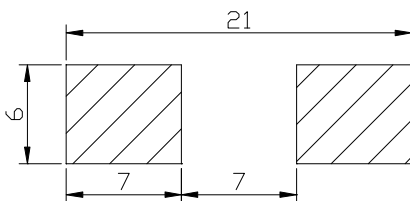

# SMD Power Inductor CDEIR18D88ME



## Electrical Characteristics

Part No.	Stamp	Inductance ( $\mu\text{H}$ ) [Within] ※1	D.C.R. ( $\text{m}\Omega$ ) Max.(Typ.) (at 20°C)	Saturation Current 1 (A) Typ. (at 20°C) ※2	Saturation Current 2 (A) Typ. (at 20°C) ※3	Temperature Rise Current (A) Typ. ※4
CDEIR18D88MENP-2R6MC	2R6	2.6 $\pm$ 20%	1.9 (1.6)	30.0	45.0	28.0
CDEIR18D88MENP-3R3MC	3R3	3.3 $\pm$ 20%	2.4 (2.0)	30.0	45.0	25.0
CDEIR18D88MENP-4R5MC	4R5	4.5 $\pm$ 20%	3.5 (2.9)	28.0	40.0	21.0
CDEIR18D88MENP-5R6MC	5R6	5.6 $\pm$ 20%	4.0 (3.3)	25.0	38.0	19.0
CDEIR18D88MENP-6R8MC	6R8	6.8 $\pm$ 20%	4.0 (3.3)	19.0	28.0	19.0
CDEIR18D88MENP-100MC	100	10.0 $\pm$ 20%	7.0 (5.8)	15.0	22.0	15.0

※1 Measuring condition at 100kHz 1V.

※2 Saturation current: The actual value of DC current when the inductance decreases to 82% of its nominal value.

※3 Saturation current: The actual value of DC current when the inductance decreases to 70% of its nominal value.

※4 Temperature rise current: The actual value of DC current when the temperature rise is  $\Delta T=50^\circ\text{C}$  ( $T_a=20^\circ\text{C}$ ).

## Saturation Current & Temperature Rise Graph

— L (20°C)    —  $\Delta T$

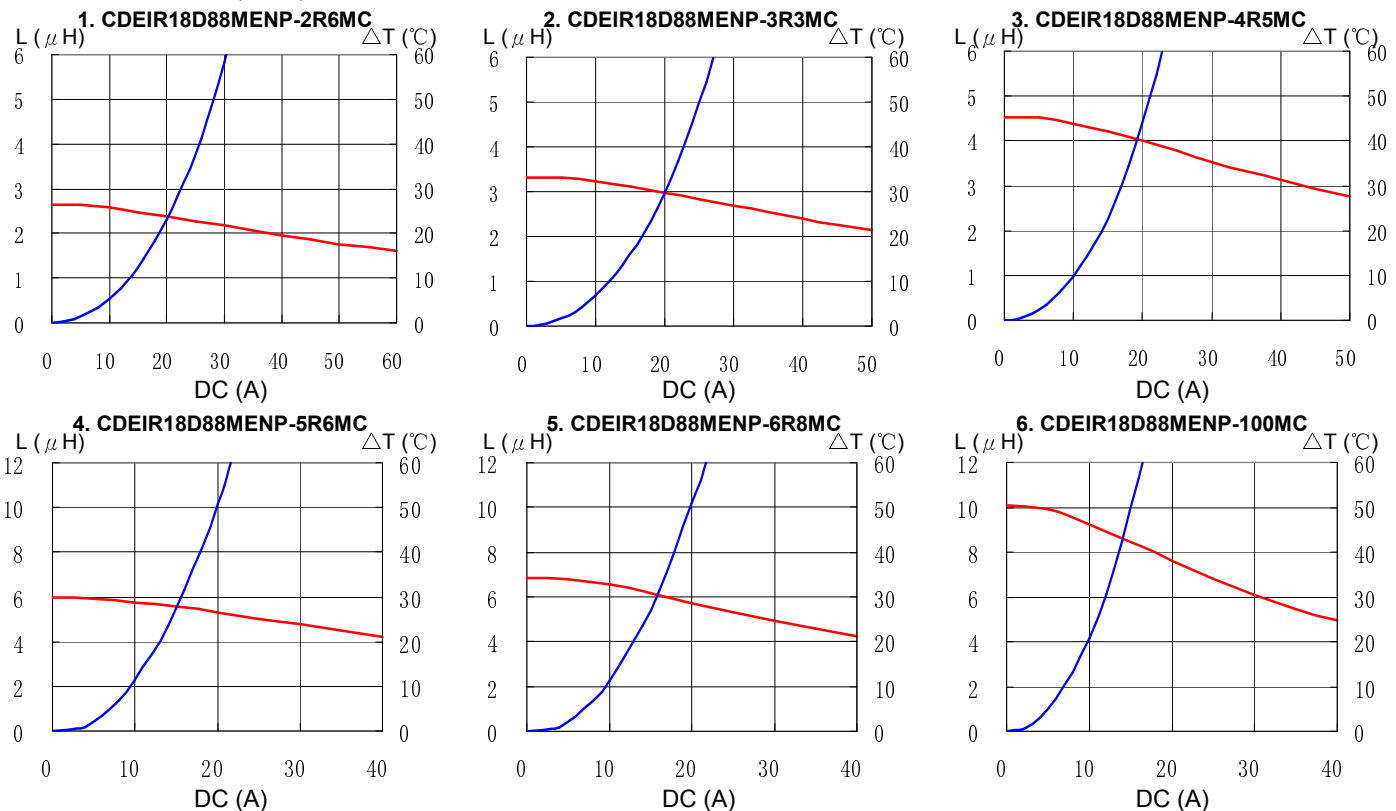

# SMD Power Inductor CDEIR18D88ME



## Solder Reflow Condition

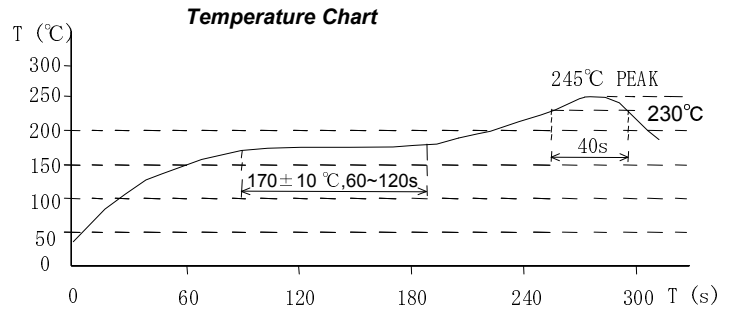
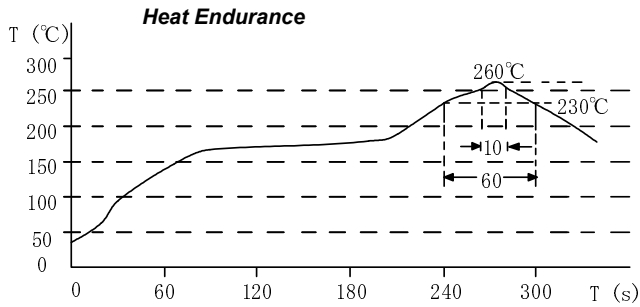

Please refer to the sales offices on our website - <http://www.sumida.com>

**Hong Kong**  
Tel.+852-2880-6781  
FAX.+852-2565-9600  
[sales@hk.sumida.com](mailto:sales@hk.sumida.com)

**Saitama(Japan)**  
Tel.+81-48-691-7300  
FAX.+81-48-691-7340  
[sales@jp.sumida.com](mailto:sales@jp.sumida.com)

**Chicago**  
Tel.+1-847-545-6700  
FAX. +1-847-545-6720  
[sales@us.sumida.com](mailto:sales@us.sumida.com)

**Shanghai**  
Tel.+86-21-5836-3299  
FAX.+86-21-5836-3266  
[shanghai.sales@cn.sumida.com](mailto:shanghai.sales@cn.sumida.com)

**Seoul**  
Tel.+82-2-6237-0777  
FAX.+82-2-6237-0778  
[sales@kr.sumida.com](mailto:sales@kr.sumida.com)

**Oberzell**  
Tel.+49-8591-937-0  
FAX. +49-8591-937-103  
[contact@eu.sumida.com](mailto:contact@eu.sumida.com)

**Shenzhen**  
Tel.+86-755-8291-0228  
FAX.+86-755-8291-0338  
[shenzhen.sales@cn.sumida.com](mailto:shenzhen.sales@cn.sumida.com)

**Singapore**  
Tel.+65-6296-3388  
FAX.+65-6841-4426  
[sales@sg.sumida.com](mailto:sales@sg.sumida.com)

**Neumarkt**  
Tel.+49-9181-4509-110  
FAX. +49-9181-4509-310  
[infocomp@eu.sumida.com](mailto:infocomp@eu.sumida.com)

**Taipei**  
Tel.+886-2-8751-2737  
FAX.+886-2-8751-2738  
[sales@tw.sumida.com](mailto:sales@tw.sumida.com)

**San Jose**  
Tel.+1-408-321-9660  
FAX.+1-408-321-9308  
[sales@us.sumida.com](mailto:sales@us.sumida.com)