

## BLD 系列晶体管/ BLD SERIES TRANSISTORS

## BLD123D

●特点: 耐压高 开关速度快 安全工作区宽 符合 RoHS 规范

●FEATURES: ■HIGH VOLTAGE CAPABILITY ■HIGH SPEED SWITCHING ■WIDE SOA ■RoHS COMPLIANT

●应用: 电子镇流器 节能灯

●APPLICATIONS: ■ELECTRONIC BALLAST ■FLUORESCENT LAMP

●最大额定值 (Tc=25°C)

●Absolute Maximum Ratings (Tc=25°C) TO-126/ TO-126S

参数	符号 SYMBOL	额定值 VALUE	单位 UNIT
集电极-基极电压 Collector-Base Voltage	V <sub>CB0</sub>	600	V
集电极-发射极电压 Collector-Emitter Voltage	V <sub>CEO</sub>	400	V
发射极-基极电压 Emitter-Base Voltage	V <sub>EBO</sub>	9	V
集电极电流 Collector Current	I <sub>C</sub>	2.0	A
集电极耗散功率 Total Power Dissipation	P <sub>C</sub>	30	W
最高工作温度 Junction Temperature	T <sub>j</sub>	150	°C
贮存时间 Storage Temperature	T <sub>stg</sub>	-65-150	°C

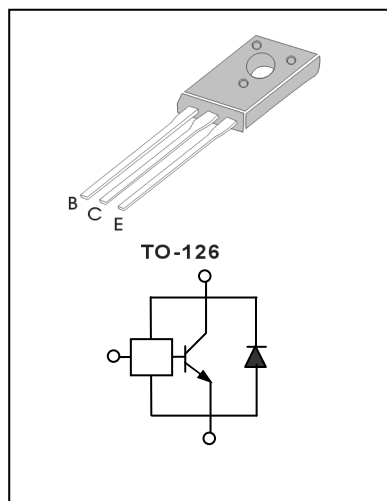

●电特性 (Tc=25°C)

●Electrical Characteristics (Tc=25°C)

参数名称 CHARACTERISTIC	符号 SYMBOL	测试条件 TEST CONDITION	最小值 MIN	最大值 MAX	单位 UNIT
集电极-基极截止电流 Collector-Cutoff Current	I <sub>CB0</sub>	V <sub>CB</sub> =600V		10	μA
集电极-发射极截止电流 Collector-Cutoff Current	I <sub>CEO</sub>	V <sub>CE</sub> =400V, I <sub>B</sub> =0		30	μA
集电极-发射极电压 Collector-Emitter Voltage	V <sub>CEO</sub>	I <sub>C</sub> =10mA, I <sub>B</sub> =0	400		V
发射极-基极电压 Emitter-Base Voltage	V <sub>EBO</sub>	I <sub>E</sub> =1mA, I <sub>C</sub> =0	9		V
集电极-发射极饱和电压 Collector-Emitter Saturation Voltage	V <sub>cesat</sub>	I <sub>C</sub> =200mA, I <sub>B</sub> =20mA		0.3	V
		I <sub>C</sub> =0.5A, I <sub>B</sub> =0.1A		0.4	
		I <sub>C</sub> =1.5A, I <sub>B</sub> =0.5A		0.9	
发射极-基极饱和电压 Base-Emitter Saturation Voltage	V <sub>besat</sub>	I <sub>C</sub> =0.5A, I <sub>B</sub> =0.1A		1.2	V
电流放大倍数 DC Current Gain	h <sub>FE</sub>	V <sub>CE</sub> =5V, I <sub>C</sub> =1mA	7		
		V <sub>CE</sub> =5V, I <sub>C</sub> =0.2A	10	40	
		V <sub>CE</sub> =5V, I <sub>C</sub> =2.0A	5		
贮存时间 Storage Time	t <sub>s</sub>	V <sub>CC</sub> =5V, I <sub>C</sub> =0.25A (UI9600)	2.0	4.0	us
下降时间 Falling Time	t <sub>f</sub>			0.8	us
内置二极管正向压降 Diode Forward Voltage	V <sub>F</sub>	I <sub>F</sub> =0.8A		2.0	V

BLD 系列晶体管/ BLD SERIES TRANSISTORS

BLD123D

SOA (DC)

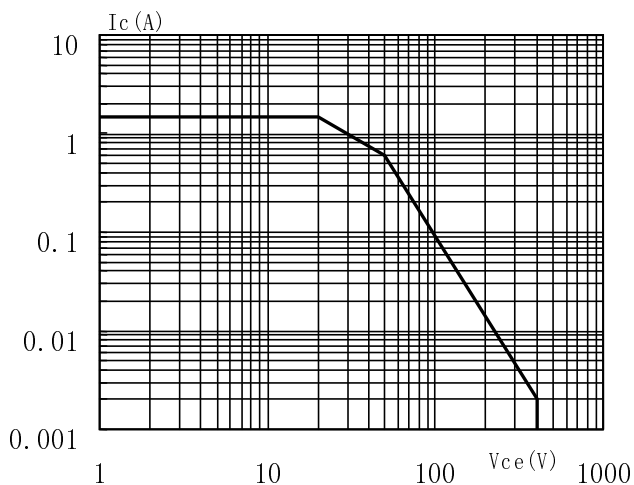

$P_c \propto T_j$

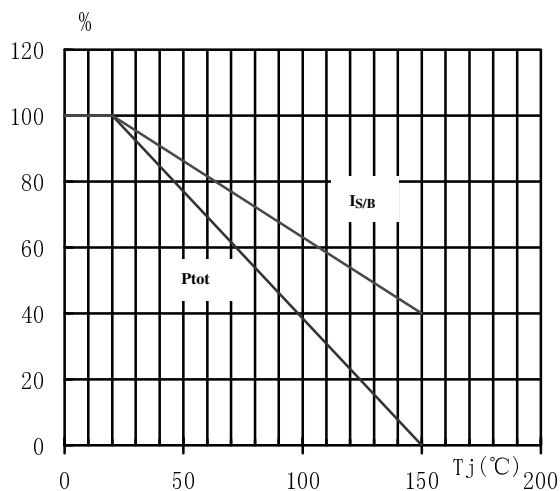

hFE **h<sub>FE</sub> - I<sub>c</sub>**

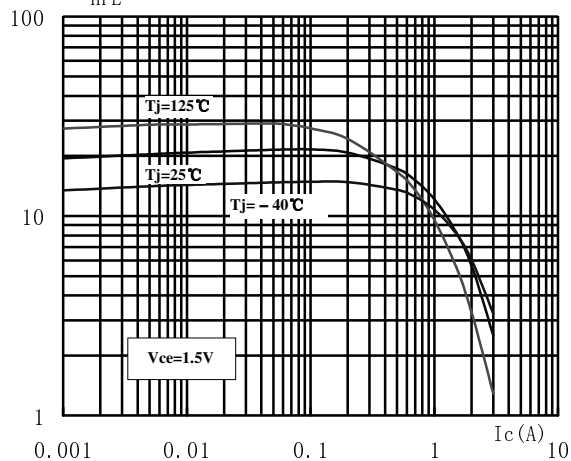

hFE **h<sub>FE</sub> - I<sub>c</sub>**

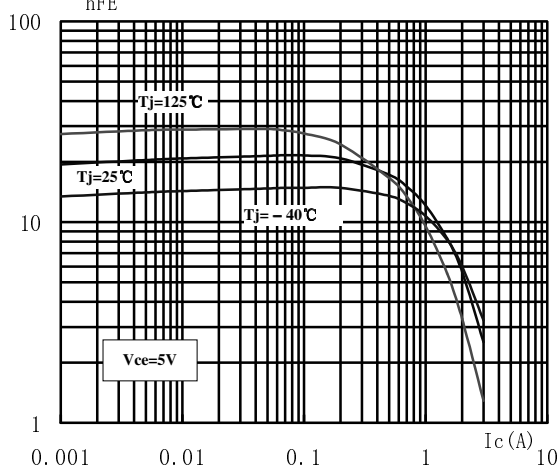

**V<sub>cesat</sub> - I<sub>c</sub>**

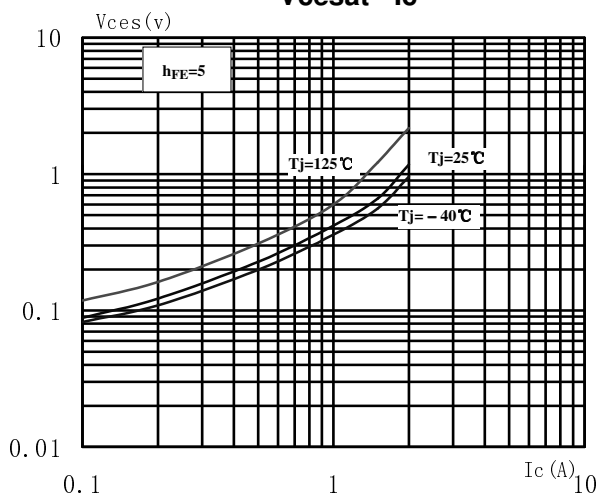

**V<sub>besat</sub> - I<sub>c</sub>**

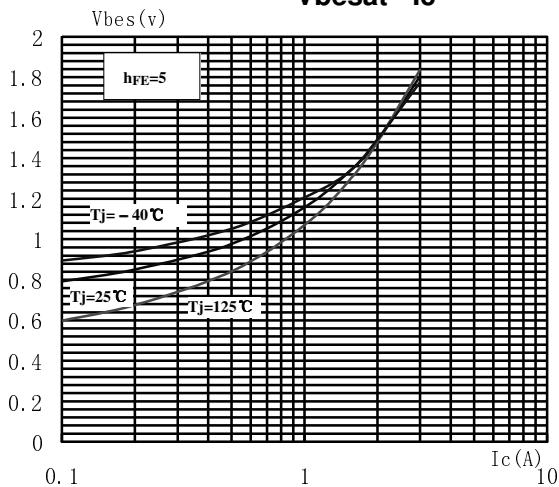

### TO-126 封装机械尺寸 TO-126 MECHANICAL DATA

单位:毫米/UNIT: mm

符号 SYMBOL	最小值 min	典型值 nom	最大值 max	符号 SYMBOL	最小值 min	典型值 nom	最大值 max
A	2.30		2.80	L	15.00		16.5
B	1.15		1.42	L1	1.50		2.54
b	0.65		0.90	$\phi P$	2.90		3.60
c	0.45		0.65	$\phi P1$		5.0	
D	10.50		11.10	Q	3.60		4.40
E	7.20		7.80	Q1	0.90		1.50
e		2.29		R		0.5*	

SI 201005

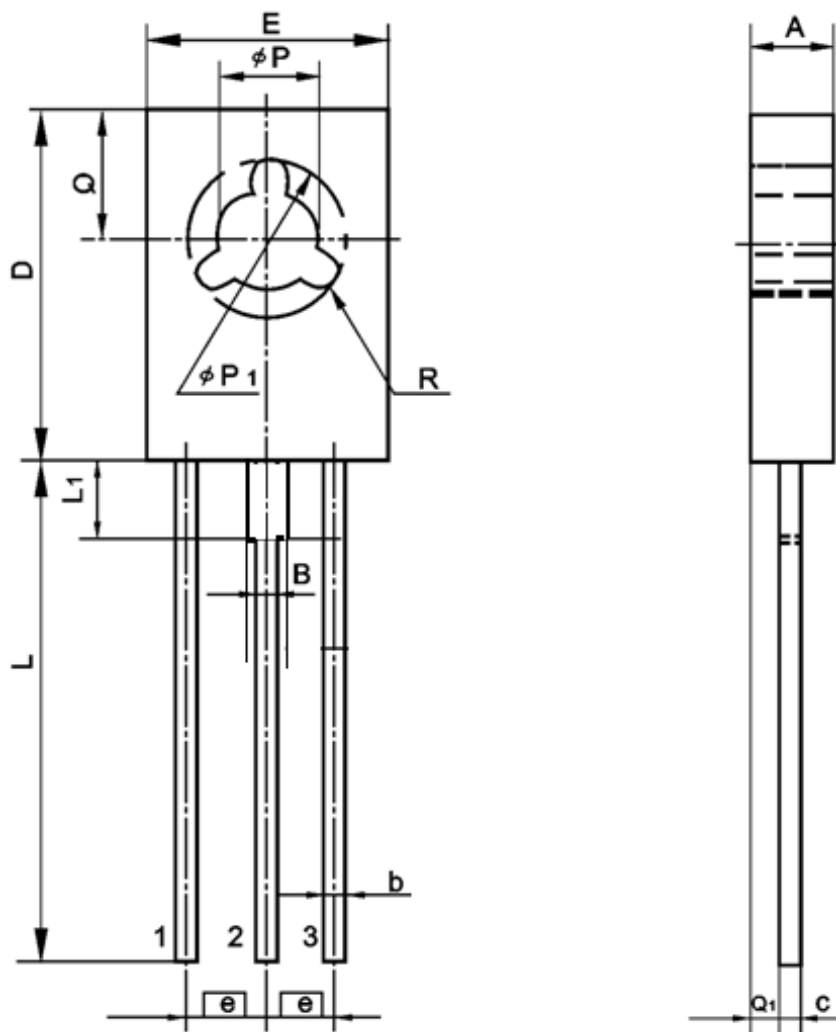

### TO-126S 封装机械尺寸 TO-126S MECHANICAL DATA

单位:毫米/UNIT: mm

符号 SYMBOL	最小值 min	典型值 nom	最大值 max	符号 SYMBOL	最小值 min	典型值 nom	最大值 max
A	2.30		2.80	L	3.20		3.60
B	1.15		1.42	L1	1.50		2.54
b	0.65		0.90	$\phi P$	2.90		3.60
c	0.40		0.65	$\phi P1$		5.0	
D	10.50		11.10	Q	3.60		4.40
E	7.20		7.80	Q1	0.90		1.50
e		2.29		R		0.5*	

SI 201005

