

## IEC Appliance Inlet C14 with Fuseholder 1- or 2-pole



Screw-on mounting  
with fuseholder 1- or 2-pole  
Sandwich/rear-side



Snap-in version  
with fuseholder 1- or 2-pole  
Sandwich/rear-side



Pick and Place Version  
IEC connector C14 with fuse holder 1- or 2-pole  
Sandwich/rear-side



See below:  
[Approvals and Compliances](#)

### Description

- Panel mount :  
Sandwich/rear-side
- 2 Functions :  
Appliance Inlet Protection class I , with or without Fuseholder for fuse-links 5 x 20 mm on the rear-side 1- or 2-pole
- Meets the requirements of IEC 60335-1 for appliances in unattended use. This includes the enhanced requirements of glow wire tests acc. to IEC 60695-2-11 or -12 & -13.
- For PCB mounting
- Pick and place version

### Characteristics

- PCB mount with snap-in or screw-on feet  
Suitable for automatic PCB assembling
- All single elements are already wired
- Fuseholder on the inside of the equipment prevents accidental use of incorrect fuse-links by the user
- With or without rear-side insulation cover
- Blister tray as optional packaging variant
- Suitable for use in equipment according to IEC/UL 62368-1

### Other versions on request

- Ground terminal with quick-connect terminal 6,3 x 0,8 mm
- Ground terminal with solder terminal
- For protection class II

### Weblinks

[pdf data sheet](#), [html datasheet](#), [General Product Information](#), [Approvals](#), [Distributor-Stock-Check](#), [Accessories](#), [Detailed request for product](#)

Newly available variants corresponding to V-Lock mating cordset. The connector is equipped with a notch intended for use with the latching cordset. The cord latching system prevents against accidental removal of the cordset.

### Technical Data

|                                   |   |                                   |  |
|-----------------------------------|---|-----------------------------------|--|
| Ratings IEC                       | 10A / 250VAC; 50Hz  | Appliance inlet/-outlet           | C14 acc. to IEC 60320-1, UL 498, CSA C22.2 no. 42 (for cold conditions) pin-temperature 70 °C, 10A, Protection Class I |
| Ratings UL/CSA                    | 10A / 250VAC; 60Hz<br>without fuseholder 16A (UL)                             | Fuseholder                        | 1-/2-pole, Shocksafe category PC2 acc. to IEC 60127-6, for fuse-links 5 x 20mm   |
| Dielectric Strength               | > 3 kVAC between L-N<br>> 4 kVAC between L/N-PE<br>(1 min/50Hz)               | Rated Power Acceptance @ Ta 23 °C | 5 x 20: 3.15W (1 pole)/ 2.5W (2-pole) per pole   |
| Allowable Operation Temperature   | -25 °C to 70 °C   | Power Acceptance @ Ta > 23 °C     | Admissible power acceptance at higher ambient temperature see derating curves  |
| IP-Protection                     | from front side IP40 acc. to IEC 60529  |                                   |  |
| Protection against electric shock | Suitable for appliances with protection class I acc. to IEC 61140             |                                   |  |
| Terminal                          | For PCB mounting  |                                   |  |
| Panel Thickness S                 | Screw: max 6 mm<br>Mounting screw torque max 0.3Nm<br>Snap-in: 1.5/2/2.5/3 mm |                                   |  |
| Material: Housing                 | Thermoplastic, black, UL 94V-0  |                                   |  |

### Approvals and Compliances



Detailed information on product approvals, code requirements, usage instructions and detailed test conditions can be looked up in [Details about Approvals](#)

SCHURTER products are designed for use in industrial environments. They have approvals from independent testing bodies according to national and international standards. Products with specific characteristics and requirements such as required in the automotive sector according to IATF 16949, medical technology according to ISO 13485 or in the aerospace industry can be offered exclusively with customer-specific, individual agreements by SCHURTER.

## Approvals





The approval mark is used by the testing authorities to certify compliance with the safety requirements placed on electronic products.

Approval Reference Type: GSF1

| Approval Logo  | Certificates  | Certification Body | Description                              |
|--|---------------|--------------------|--|
|  | VDE Approvals | VDE                | Certificate Number: 40024857             |
|  | UL Approvals  | UL                 | UL File Number: E93617, E96454           |
|  | CCC Approvals | CCC                | CCC Certificate Number: 2006010204183182 |



## Product standards

Product standards that are referenced

| Organization   | Design                | Standard         | Description   |
|--|-----------------------|------------------|---|
|  | Designed according to | IEC 60320-1      | Appliance couplers for household and similar general purposes         |
|  | Designed according to | IEC 60127-6      | Miniature fuses. Part 6. Fuse-holders for miniature fuse-links        |
|  | Designed according to | IEC 61058-1      | Switches for appliances. Part 1. General requirements                 |
|  | Designed according to | UL 498           | Standard for Attachment Plugs and Receptacles                         |
|  | Designed according to | CSA C22.2 no. 42 | General Use Receptacles, Attachment Plugs, and Similar Wiring Devices |







## Application standards

Application standards where the product can be used

| Organization   | Design                         | Standard       | Description  |
|--|--------------------------------|----------------|--|
|  | Designed for applications acc. | IEC/UL 62368-1 | IEC 62368-1 includes the basic requirements for safety of audio, video, information technology and office equipment.   |
|  | Designed for applications acc. | IEC 60335-1    | Safety of electrical appliances for household and similar purposes. Meets the requirements for appliances in unattended use. This includes the enhanced requirements of glow wire tests acc. to IEC 60695-2-11 or -12 & -13. |

## Compliances

The product complies with following Guide Lines

| Identification   | Details                      | Initiator   | Description  |
|--|------------------------------|-------------|--|
|  | CE declaration of conformity | SCHURTER AG | The CE marking declares that the product complies with the applicable requirements laid down in the harmonisation of Community legislation on its affixing in accordance with EU Regulation 765/2008.                        |
|  | RoHS                         | SCHURTER AG | Directive RoHS 2011/65/EU, Amendment (EU) 2015/863   |
|  | China RoHS                   | SCHURTER AG | The law SJ / T 11363-2006 (China RoHS) has been in force since 1 March 2007. It is similar to the EU directive RoHS.   |
|  | REACH                        | SCHURTER AG | On 1 June 2007, Regulation (EC) No 1907/2006 on the Registration, Evaluation, Authorization and Restriction of Chemicals 1 (abbreviated as "REACH") entered into force.  |
|  |                              | SCHURTER AG | V-Lock system are based on a matching plug-dose combination. The connector is equipped with a notch intended for use with the latching cordset. The cord latching system prevents against accidental removal of the cordset. |
|  | White Paper Glow wire test   | SCHURTER AG | Meets the requirements of IEC 60335-1 for appliances in unattended use. This includes the enhanced requirements of glow wire tests acc. to IEC 60695-2-11 or -12 & -13.  |

## Dimensions [mm]

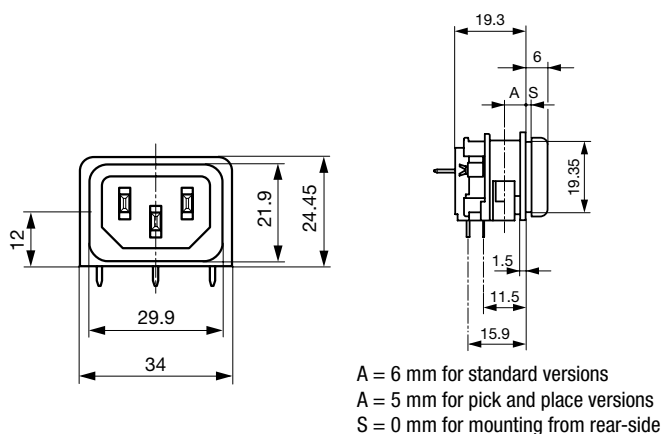

with insulation cover

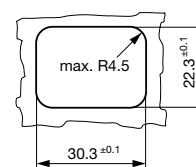
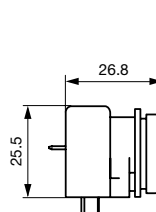

for mounting from rear-side

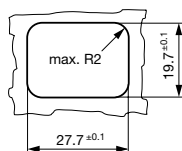
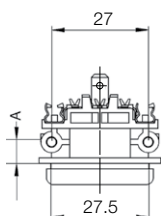

A = 6 mm for standard versions  
 A = 5 mm for pick and place versions

for sandwich mounting

## Drilling diagrams

without fuseholder

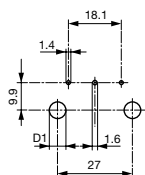

D1 for snap-in mounting =  $6 \pm 0.05$   
 D1 for self-tapping screw =  $3.6 \pm 0.1$

with 1-pole fuseholder

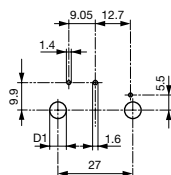

D1 for snap-in mounting =  $6 \pm 0.05$   
 D1 for self-tapping screw =  $3.6 \pm 0.1$

with 2-pole fuseholder

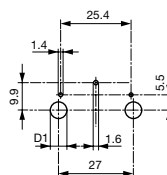

D1 for snap-in mounting =  $6 \pm 0.05$   
 D1 for self-tapping screw =  $3.6 \pm 0.1$

Pick and Place versions  
 without / with 1-pole or  
 2-pole fuseholder

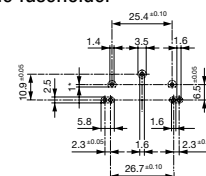

1\* only for protection class II

## Derating Curves

1-pole

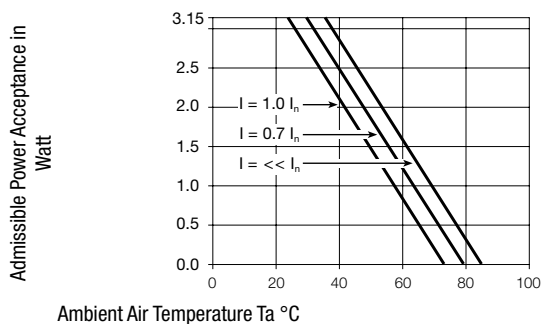

2-pole

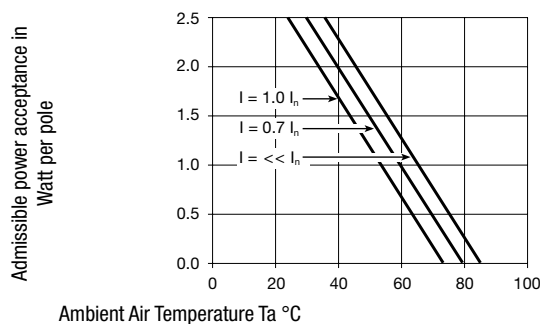

## All Variants

| Mounting side | Panel mounting | Panel Thickness<br>s [mm] | Fuseholder | Ground terminal 4.8<br>x 0.8 mm | Ground terminal direction | Packaging    | V-Lock | Order Number |
|---------------|----------------|---------------------------|------------|---------------------------------|---------------------------|--------------|--------|--------------|
| Sandwich      | Snap-in        | 1.5                       | -          | ●                               | angled to pin axis        | -            |        | GSF1.0202.31 |
| Sandwich      | Snap-in        | 1.5                       | -          | ●                               | straight                  | -            |        | GSF1.0201.31 |
| Sandwich      | Snap-in        | 2                         | -          | ●                               | angled to pin axis        | -            |        | GSF1.0202.41 |
| Sandwich      | Snap-in        | 2                         | -          | ●                               | straight                  | -            |        | GSF1.0201.41 |
| Sandwich      | Snap-in        | 2.5                       | -          | ●                               | angled to pin axis        | -            |        | GSF1.0202.51 |
| Sandwich      | Snap-in        | 2.5                       | -          | ●                               | straight                  | -            |        | GSF1.0201.51 |
| Sandwich      | Snap-in        | 3                         | -          | ●                               | angled to pin axis        | -            |        | GSF1.0202.61 |
| Sandwich      | Snap-in        | 3                         | -          | ●                               | straight                  | -            |        | GSF1.0201.61 |
| Sandwich      | Snap-in        | 1.5                       | 1-pole     | ●                               | angled to pin axis        | -            |        | GSF1.1202.31 |
| Sandwich      | Snap-in        | 1.5                       | 1-pole     | ●                               | straight                  | -            |        | GSF1.1201.31 |
| Sandwich      | Snap-in        | 2                         | 1-pole     | ●                               | angled to pin axis        | -            |        | GSF1.1202.41 |
| Sandwich      | Snap-in        | 2                         | 1-pole     | ●                               | straight                  | -            |        | GSF1.1201.41 |
| Sandwich      | Snap-in        | 2.5                       | 1-pole     | ●                               | angled to pin axis        | -            |        | GSF1.1202.51 |
| Sandwich      | Snap-in        | 2.5                       | 1-pole     | ●                               | straight                  | -            |        | GSF1.1201.51 |
| Sandwich      | Snap-in        | 3                         | 1-pole     | ●                               | angled to pin axis        | -            |        | GSF1.1202.61 |
| Sandwich      | Snap-in        | 3                         | 1-pole     | ●                               | straight                  | -            |        | GSF1.1201.61 |
| Sandwich      | Snap-in        | 1.5                       | 2-pole     | ●                               | angled to pin axis        | -            |        | GSF1.2202.31 |
| Sandwich      | Snap-in        | 1.5                       | 2-pole     | ●                               | straight                  | -            |        | GSF1.2201.31 |
| Sandwich      | Snap-in        | 2                         | 2-pole     | ●                               | angled to pin axis        | -            |        | GSF1.2202.41 |
| Sandwich      | Snap-in        | 2                         | 2-pole     | ●                               | straight                  | -            |        | GSF1.2201.41 |
| Sandwich      | Snap-in        | 2.5                       | 2-pole     | ●                               | angled to pin axis        | -            |        | GSF1.2202.51 |
| Sandwich      | Snap-in        | 2.5                       | 2-pole     | ●                               | straight                  | -            |        | GSF1.2201.51 |
| Sandwich      | Snap-in        | 3                         | 2-pole     | ●                               | straight                  | -            |        | GSF1.2201.61 |
| Sandwich      | Screw          | 1.5                       | -          | ●                               | angled to pin axis        | -            |        | GSF1.0002.31 |
| Sandwich      | Screw          | 1.5                       | -          | ●                               | straight                  | -            |        | GSF1.0001.31 |
| Sandwich      | Screw          | 2                         | -          | ●                               | angled to pin axis        | -            |        | GSF1.0002.41 |
| Sandwich      | Screw          | 2                         | -          | ●                               | straight                  | -            |        | GSF1.0001.41 |
| Sandwich      | Screw          | 2.5                       | -          | ●                               | angled to pin axis        | -            |        | GSF1.0002.51 |
| Sandwich      | Screw          | 2.5                       | -          | ●                               | straight                  | -            |        | GSF1.0001.51 |
| Sandwich      | Screw          | 3                         | -          | ●                               | angled to pin axis        | -            |        | GSF1.0002.61 |
| Sandwich      | Screw          | 3                         | -          | ●                               | straight                  | -            |        | GSF1.0001.61 |
| Sandwich      | Screw          | 1.5                       | 1-pole     | ●                               | angled to pin axis        | -            |        | GSF1.1002.31 |
| Sandwich      | Screw          | 1.5                       | 1-pole     | ●                               | straight                  | -            |        | GSF1.1001.31 |
| Sandwich      | Screw          | 2                         | 1-pole     | ●                               | angled to pin axis        | -            |        | GSF1.1002.41 |
| Sandwich      | Screw          | 2                         | 1-pole     | ●                               | straight                  | -            |        | GSF1.1001.41 |
| Sandwich      | Screw          | 2.5                       | 1-pole     | ●                               | angled to pin axis        | -            |        | GSF1.1002.51 |
| Sandwich      | Screw          | 2.5                       | 1-pole     | ●                               | straight                  | -            |        | GSF1.1001.51 |
| Sandwich      | Screw          | 2.5                       | 1-pole     | ●                               | straight                  | -            |        | GSF1.1006.51 |
| Sandwich      | Screw          | 2.5                       | 1-pole     | ●                               | straight                  | Blister tray |        | 3-104-974    |
| Sandwich      | Screw          | 3                         | 1-pole     | ●                               | angled to pin axis        | -            |        | GSF1.1002.61 |
| Sandwich      | Screw          | 3                         | 1-pole     | ●                               | straight                  | -            |        | GSF1.1001.61 |
| Sandwich      | Screw          | 1.5                       | 2-pole     | ●                               | angled to pin axis        | -            |        | GSF1.2002.31 |
| Sandwich      | Screw          | 1.5                       | 2-pole     | ●                               | straight                  | -            |        | GSF1.2001.31 |
| Sandwich      | Screw          | 2                         | 2-pole     | ●                               | angled to pin axis        | -            |        | GSF1.2002.41 |
| Sandwich      | Screw          | 2                         | 2-pole     | ●                               | straight                  | -            |        | GSF1.2001.41 |
| Sandwich      | Screw          | 2.5                       | 2-pole     | ●                               | angled to pin axis        | -            |        | GSF1.2002.51 |

| Mounting side | Panel mounting | Panel Thickness<br>s [mm] | Fuseholder | Ground terminal 4.8<br>x 0.8 mm | Ground terminal direction | Packaging    | V-Lock | Order Number |
|---------------|----------------|---------------------------|------------|---------------------------------|---------------------------|--------------|--------|--------------|
| Sandwich      | Screw          | 2.5                       | 2-pole     | ●                               | straight                  | -            |        | GSF1.2001.51 |
| Sandwich      | Screw          | 3                         | 2-pole     | ●                               | angled to pin axis        | -            |        | GSF1.2002.61 |
| Sandwich      | Screw          | 3                         | 2-pole     | ●                               | straight                  | -            |        | GSF1.2001.61 |
| Rear Side     | Snap-in        | 6                         | -          | ●                               | angled to pin axis        | -            |        | GSF1.0202.01 |
| Rear Side     | Snap-in        | 6                         | -          | ●                               | straight                  | -            |        | GSF1.0201.01 |
| Rear Side     | Snap-in        | 6                         | 1-pole     | ●                               | angled to pin axis        | -            |        | GSF1.1202.01 |
| Rear Side     | Snap-in        | 6                         | 1-pole     | ●                               | straight                  | -            |        | GSF1.1201.01 |
| Rear Side     | Snap-in        | 6                         | 2-pole     | ●                               | angled to pin axis        | -            |        | GSF1.2202.01 |
| Rear Side     | Snap-in        | 6                         | 2-pole     | ●                               | straight                  | -            |        | GSF1.2201.01 |
| Rear Side     | Screw          | 6                         | -          | ●                               | angled to pin axis        | -            |        | GSF1.0002.01 |
| Rear Side     | Screw          | 6                         | -          | ●                               | straight                  | -            |        | GSF1.0001.01 |
| Rear Side     | Screw          | 6                         | 1-pole     | ●                               | angled to pin axis        | -            |        | GSF1.1002.01 |
| Rear Side     | Screw          | 6                         | 1-pole     | ●                               | straight                  | -            |        | GSF1.1001.01 |
| Rear Side     | Screw          | 6                         | 2-pole     | ●                               | angled to pin axis        | -            |        | GSF1.2002.01 |
| Rear Side     | Screw          | 6                         | 2-pole     | ●                               | straight                  | -            |        | GSF1.2001.01 |
| Rear Side     | Metal snaps    | 6                         | -          | ●                               | angled to pin axis        | Blister tray |        | GSF1.3402.01 |
| Rear Side     | Metal snaps    | 6                         | 1-pole     | ●                               | angled to pin axis        | Blister tray |        | GSF1.4402.01 |
| Rear Side     | Metal snaps    | 6                         | 2-pole     | ●                               | angled to pin axis        | Blister tray |        | GSF1.5402.01 |

Most Popular.

Availability for all products can be searched real-time: <https://www.schurter.com/en/Stock-Check/Stock-Check-SCHURTER>

Insulation cover must be ordered separately. Order No. 0098.0078

Optional blister tray packaging 250 Pcs

**Packaging unit** 50 Pcs

## Accessories

### Description



Assorted Covers  
Rear Cover



RC320  
Rear Cover for Power Entry Module

Mating Outlets/Connectors

Category / Description

[Appliance Outlet Overview complete](#)



|   |      |
|---|------|
| 4787, Mounting: Screw-on mounting, Appliance Outlet: IEC Solder terminals, 10 A, Suitable for appliances with protection class I            | 4787 |
| 4788, Mounting: Snap-in version, Appliance Outlet: IEC Solder/Quick Connect Terminal, 10 A, Suitable for appliances with protection class I | 4788 |
| IEC Appliance Outlet F or H, Screw-on Mounting, Front Side, Solder, PCB or Quick-connect Terminal   | 5091 |

[Connector Overview complete](#)



|   |         |
|---|---------|
| 4782 Mounting: Power Cord, 3 x 1 mm² / 3 x 18 AWG, Cable, Connector: IEC C13    | 4782    |
| 4785 Mounting: Power Cord, 3 x 1 mm² / 3 x 18 AWG, Cable, Connector: IEC C13    | 4785    |
| 4300-06 Mounting: Power Cord, 3 x 1 mm² / 3 x 18 AWG, Cable, Connector: IEC C13 | 4300-06 |
| 4781 Mounting: Power Cord, Cable, Connector: IEC C15                            | 4781    |
| 4784 Mounting: Power Cord, 3 x 1 mm² / 3 x 18 AWG, Cable, Connector: IEC C15    | 4784    |

...

Mating Outlets/Connectors shuttered



[Connector Overview complete](#)

|  |      |
|--|------|
| 4783 Mounting: Power Cord, 3 x 1 mm² / 3 x 18 AWG, Cable, Connector: IEC C13 | 4783 |
|--|------|



[Power Cord Overview complete](#)

|   |         |
|---|---------|
| VAC13KS, Overview, V-Lock cord retaining, diverse Connector IEC C13, diverse, black         | VAC13KS |
| VAC17KS, V-Lock cord retaining, diverse m, Connector IEC C17, diverse, black / grey / white | VAC17KS |