

1 Products affected

| Product hierarchy no. * | | | | Part no. | SBU | Type / Description | Customer part no. |
|-------------------------|-----|-----|------------|----------------|------------|-------------------------------------|-------------------|
| SBU | PG | PUG | Type | | | | |
| 02 | 007 | 038 | 0000002289 | See list below | Connectors | 4789 Appliance Inlet for Cable 16A | - |
| 02 | 007 | 043 | 0000002290 | See list below | Connectors | 4790 Appliance Outlet for Cable 16A | - |
| 02 | 007 | 043 | 0000002295 | See list below | Connectors | 4795 Appliance Outlet for Cable 16A | - |
| 02 | 007 | 038 | 0000002296 | See list below | Connectors | 4796 Appliance Inlet for Cable 16A | - |
| 02 | 007 | 037 | 0000002350 | See list below | Connectors | 9009 Appliance Inlet for Cable 10A | - |

*SBU (2-digit) / PG (3-digit) / PUG (3-digit) / Type (10-digit)

| List of part numbers affected | | | | |
|-------------------------------|-----------|-----------|-----------|-----------|
| 4789.1100 | 4790.1200 | 4796.0000 | 9900.0003 | 9009.0211 |
| 4789.1200 | 4795.0000 | 4796.0100 | 9009.0111 | 9009.0221 |
| 4790.1100 | 4795.0100 | 9900.0000 | 9009.0121 | |

2 Type of change

Change of markings on the moulding body.

3 Detailed description of change

| Old product appearance | New product appearance |
|--|--|
| <p>4789</p> <p>The diagram shows a side view of the 4789 connector. A red circle highlights the top marking '4789.XXXX'. Another red circle highlights the bottom marking '4789.XXXX'.</p> | <p>4789</p> <p>The diagram shows the same side view of the 4789 connector. The top marking area is now blank. The bottom marking area is also blank.</p> |
| <p>4790</p> <p>The diagram shows a side view of the 4790 connector. A red circle highlights the top marking '4790.XXXX'. Another red circle highlights the bottom marking '4790.XXXX'.</p> | <p>4790</p> <p>The diagram shows the same side view of the 4790 connector. The top marking area is now blank. The bottom marking area is also blank.</p> |

| Product Change Notification | | | | | PCN - Exclusion of Laser Marking | | |
|-----------------------------|---------------|--------------|-------------|-----------------|----------------------------------|--------|-------------|
| owner | creation date | release date | released by | change order no | rev | page | D10-037-117 |
| vetersa | 29.05.2019 | 03.06.2019 | limachcl | 2017746 | A | 1 of 3 | |

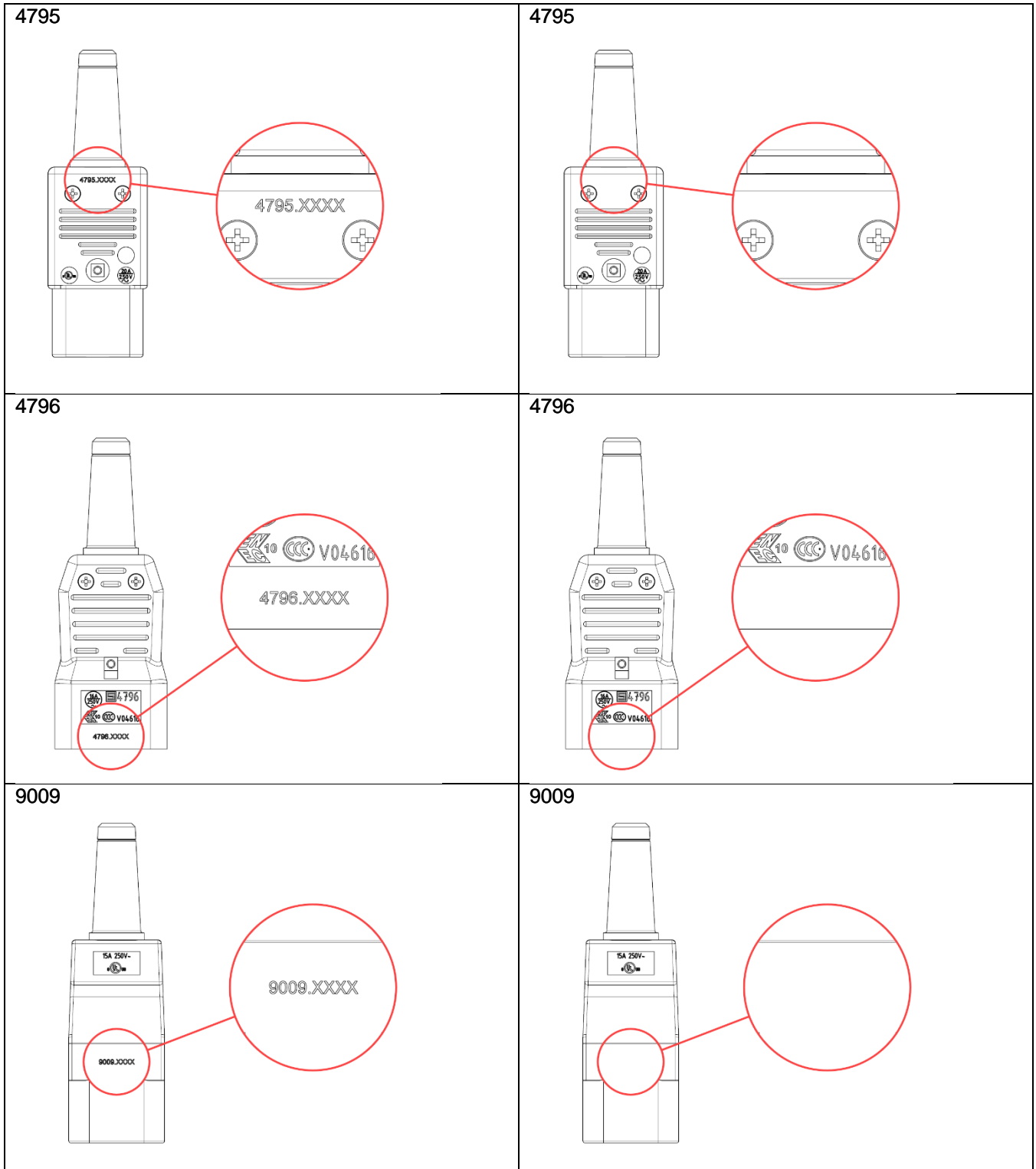

4 Reason of change

The laser marking is no longer required by the approval bodies and will be excluded.

5 Release date

The change takes effect in ww 26/2019 (Date code 1926 or higher on label).

| Product Change Notification | | | | | PCN - Exclusion of Laser Marking | | |
|-----------------------------|---------------|--------------|-------------|-----------------|----------------------------------|--------|-------------|
| owner | creation date | release date | released by | change order no | rev | page | D10-037-117 |
| vetersa | 29.05.2019 | 03.06.2019 | limachcl | 2017746 | A | 2 of 3 | |

6 Impact of change and recommended action

| | | |
|---------------|-----|---|
| Form | Yes | Laser marking is no longer on the moulding body |
| Fit | No | No change for dimension |
| Function | No | No change in function |
| Manufacturing | No | No change for manufacturing site |
| Label | No | No change on label |
| Packaging | No | No change in packaging |

7 Reference Documents / Attachments

| Kind of document | Remarks |
|---------------------------------|---------|
| Data Sheet 4789 | |
| Data Sheet 4790 | |
| Data Sheet 4795 | |
| Data Sheet 4796 | |
| Data Sheet 9009 | |

| | | | | | | | |
|-----------------------------|---------------|--------------|-------------|-----------------|----------------------------------|--------|-------------|
| Product Change Notification | | | | | PCN - Exclusion of Laser Marking | | |
| owner | creation date | release date | released by | change order no | rev | page | D10-037-117 |
| vetersa | 29.05.2019 | 03.06.2019 | limachcl | 2017746 | A | 3 of 3 | |