

DO NOT
SCALE FROM
THIS PRINT

**ALL DIMENSIONS ARE REFERENCE
(SEE T-1M44-XXXX-XX FOR CONTROL PRINT)**

CARRIER SPECIFICATIONS

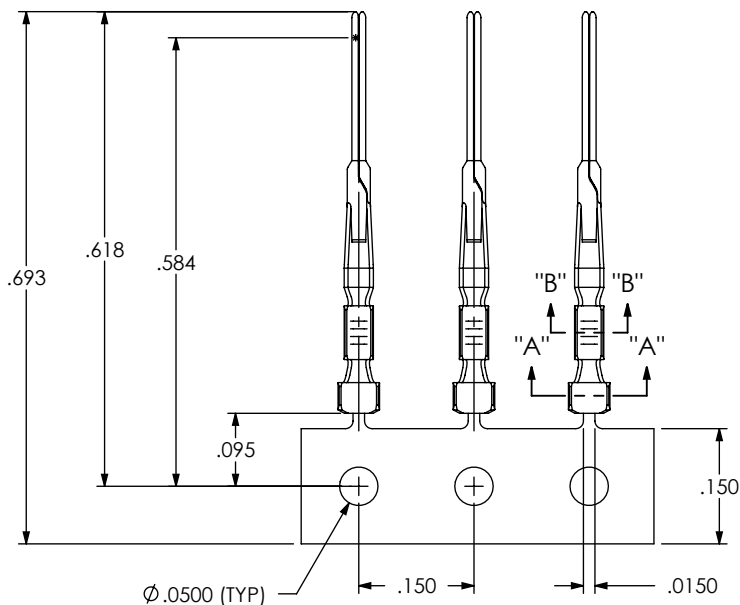

T1M44-X-XXXX-01-XX

SUPPLIED
-L: LOOSE
-R: REEL
-M: MINI REEL

LEAD STYLE
-2830: 28-30 AWG

PLATING SPECIFICATION

-GF: 3μ" FLASH SELECTIVE IN CONTACT AREA,
3μ" GOLD ON TAIL
-G: 10μ" LIGHT GOLD IN CONTACT AREA,
3μ" GOLD ON TAIL
-H: 30μ" HEAVY GOLD IN CONTACT AREA,
3μ" GOLD ON TAIL

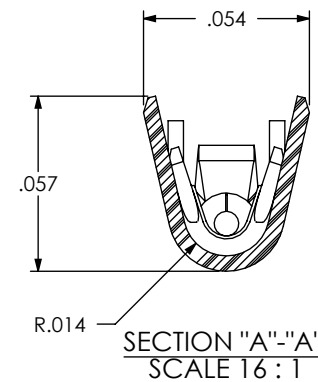
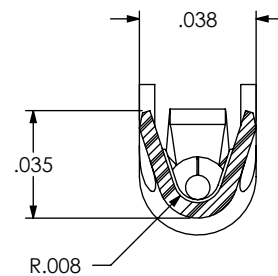
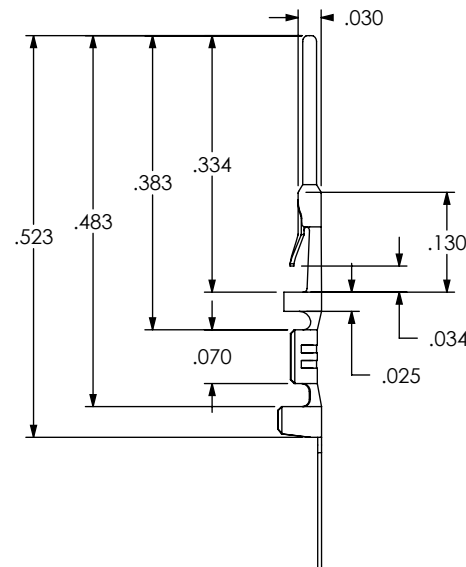

NOTES:

1. PLATED T-1MM PARTS ARE TO BE UNWOUND THEN REWOUND AND COUNTED, POSITIONED AS SHOWN ON SAMTEC REEL WITH VIEWPORTS, LABELED T1M44 WITH APPROPRIATE PLATE CALL OUT AND LABEL PLACED AS SHOWN.
2. MAXIMUM ALLOWABLE SPLICES PER REEL:
-R: 2
-M: 1
3. SPLICES ARE NOT TO BE CONNECTED.
4. NUMBER OF SPLICES TO BE MARKED ON EACH REEL.
5. REELED PARTS TO BE INTERLEAVED WITH PAPER BETWEEN EACH LAYER OF PARTS.
6. ALLOWABLE INTERLEAF SPLICES PER REEL:
-R: 3
-M: 1
7. SECURELY CONNECT INTERLEAF SPLICE.
8. OUTER WRAP SHALL RECEIVE RB-24-0.75-P PROTECTIVE REEL BAND.
9. DUE TO PLATING REQUIREMENTS CONTACT SAMPLES MAY BE REMOVED INTERMITTINGLY FROM THE BANDOLIER RESULTING IN SMALL GAPS BUT DOES NOT AFFECT FINAL COUNT.
10. QTY PER REEL:
-R: 35,000 +100/-0 PCS
-M: 5,000 +300/-0 PCS

UNLESS OTHERWISE SPECIFIED,
DIMENSIONS ARE IN INCHES.
TOLERANCES ARE:
DECIMALS ANGLES

PROPRIETARY NOTE

THIS DOCUMENT CONTAINS INFORMATION
CONFIDENTIAL AND PROPRIETARY TO
SAMTEC, INC. AND SHALL NOT BE REPRODUCED
OR TRANSFERRED TO OTHER DOCUMENTS OR
DISCLOSED TO OTHERS OR USED FOR ANY
PURPOSE OTHER THAN THAT WHICH IT WAS
OBTAINED WITHOUT THE EXPRESSED WRITTEN
CONSENT OF SAMTEC, INC.

samtec

520 PARK EAST BLVD, NEW ALBANY, IN 47150
PHONE: 812-944-6733 FAX: 812-948-5047
e-Mail: info@SAMTEC.com code: 55322

MATERIAL: DO NOT SCALE DRAWING SHEET SCALE: 8:1
BeCu
THICKNESS: .0050

DESCRIPTION:
.050" C.L. DISCRETE WIRE TERMINAL

DWG. NO.
T1M44-X-XXXX-01-XX

BY: G. PURVIS 12/21/2007 **SHEET 1 OF 2**

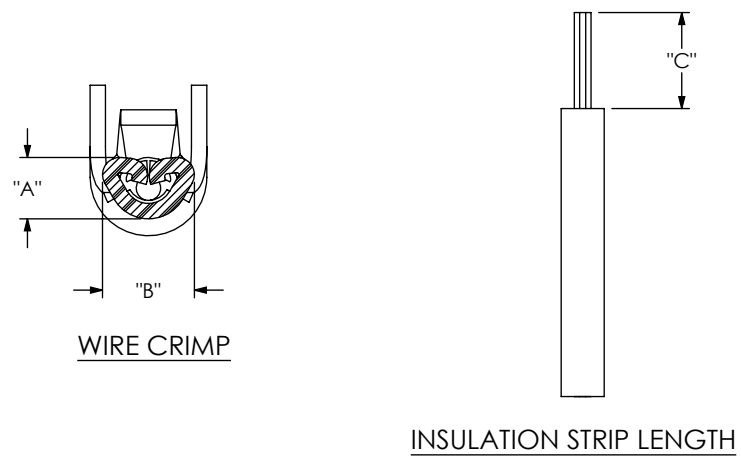

TABLE 1						
P/N	AWG	STRANDS/AWG	INSULATION OD	"A"	"B"	"C"
T-1M44-2830-XX	30	7/38	.0290-.0380	0.0170	0.0300	0.105
	28	7/36		0.0180	0.0300	

FIG 2
RECOMMENDED PROCESSING

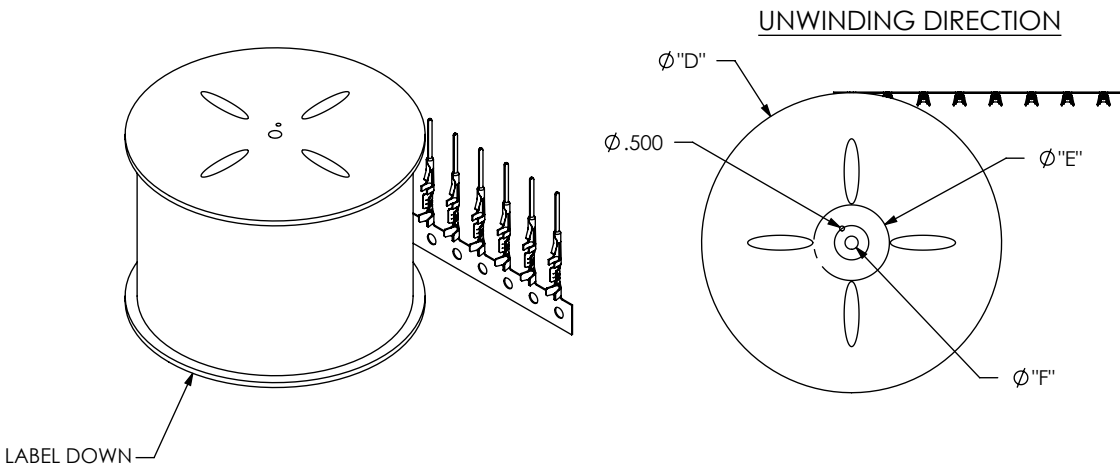

TABLE 2				
SUPPLIED	REEL PART NUMBER	"D"	"E"	"F"
-R	R-24-05.00-0.75-P	24.0	5.50	1.125
-M	MR-12-5.375-0.75-C	12.0	5.375	1.000

FIG 3
REEL SPECIFICATIONS

PROPRIETARY NOTE
THIS DOCUMENT CONTAINS INFORMATION
CONFIDENTIAL AND PROPRIETARY TO
SAMTEC, INC. AND SHALL NOT BE REPRODUCED
OR TRANSFERRED TO OTHER DOCUMENTS OR
DISCLOSED TO OTHERS OR USED FOR ANY
PURPOSE OTHER THAN THAT WHICH IT WAS
OBTAINED WITHOUT THE EXPRESSED WRITTEN
CONSENT OF SAMTEC, INC.

DO NOT SCALE DRAWING

SHEET SCALE: 8:1

520 PARK EAST BLVD, NEW ALBANY, IN 47150
PHONE: 812-944-6733 FAX: 812-948-5047
e-Mail: info@SAMTEC.com code: 55322

DESCRIPTION:
.050" C.L. DISCRETE WIRE TERMINAL

DWG. NO.
T1M44-X-XXXX-01-XX

BY: G. PURVIS 12/21/2007 SHEET 2 OF 2