

DO NOT  
SCALE FROM  
THIS PRINT

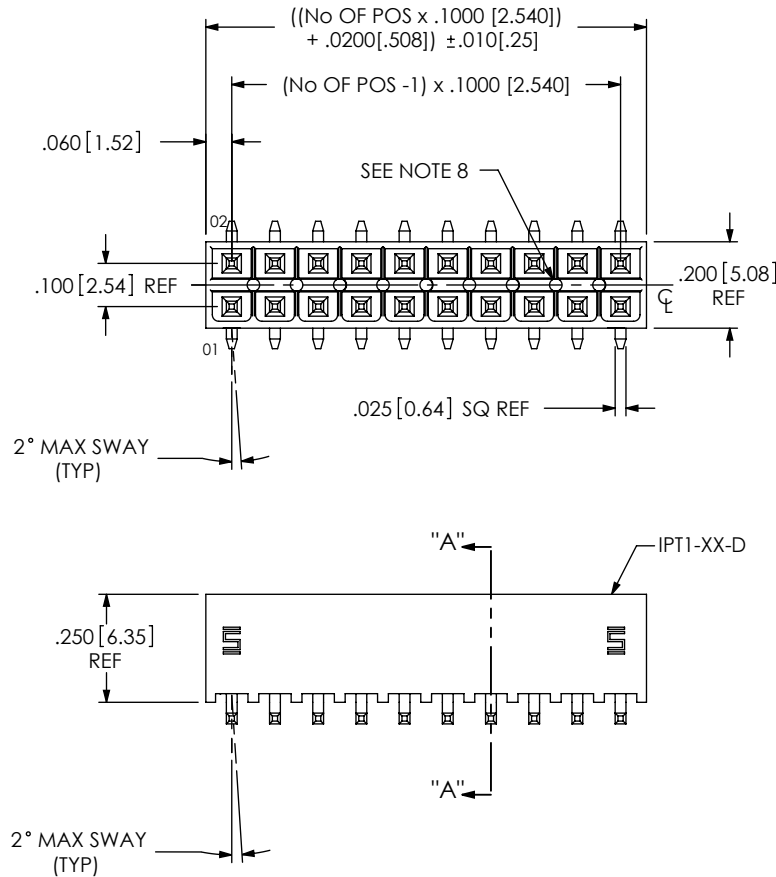

# IPT1-1XX-XX-XX-D-VS-XX-XX

- No OF POS PER ROW  
-02 THRU -25
- LEAD STYLE  
-01
- PLATING SPECIFICATION  
-S: SELECTIVE, 30 Au / 50 Ni MIN ON CONTACT, MATTE TIN TAIL  
-SM: SELECTIVE, 30 Au / 50 Ni MIN ON CONTACT, MATTE TIN TAIL  
-L: LIGHT SELECTIVE, 10 Au / 50 Ni MIN ON CONTACT, MATTE TIN TAIL
- OPTION  
-K: POLYIMIDE FILM PAD [AVAILABLE ON POSITIONS -03 THRU -25 ONLY]  
-TR: TAPE AND REEL
- OPTION  
-A: ALIGNMENT PIN (USE SM-A11) [4 POS MIN]  
-LC: LOCKING CLIP (USE LC-07-TM) [4 POS MIN] (SEE NOTE 10)  
-FL: FRICTION LOCK [POS -05 THRU -25] (USE IPT1-XX-D-FL-X & T-1S64-05-X)  
-PL: POSITION #1 REMOVED (USE IPT1-XX-D-P) (SEE NOTE 12)
- TAIL OPTION  
-VS: VERTICAL SURFACE MOUNT
- ROW SPECIFICATION  
-D: DOUBLE (USE IPT1-XX-D) (SEE NOTE 11)

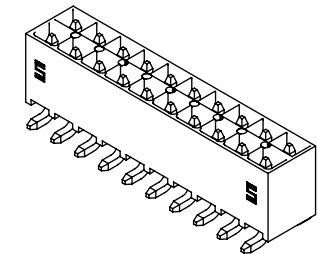
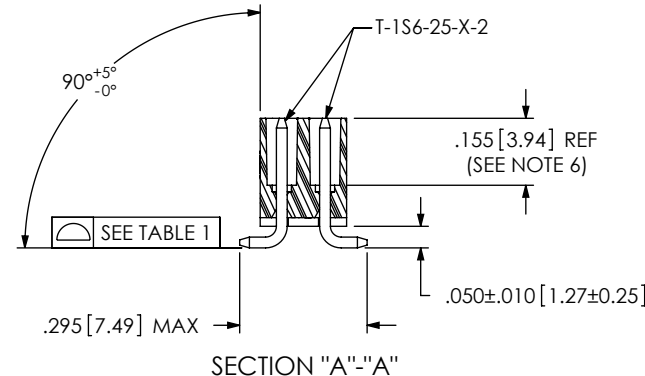
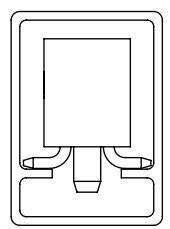

TABLE 1	
POSITION	COPLANARITY
-02 THRU -10	.005[.13]
-11 THRU -25	.006[.15]

- NOTES:
1. REPRESENTS A CRITICAL DIMENSION.
  2. MAXIMUM ALLOWABLE CUT FLASH: .010[.25].
  3. MINIMUM TERMINAL PUSH OUT FORCE: 2 lbs.
  4. MAXIMUM VARIATION BETWEEN PIN ROWS: .005[.13].
  5. "END WALLS" AFTER CUTTING SHOULD BE .010+/- .003[.25+/- .08].
  6. PINS TO BE FLUSH TO .008 [.20] MAXIMUM RECESSED IN BODY.
  7. ALL DIMENSIONS TO BE ABOUT CENTERLINE WITHIN +/- .005[.13].
  8. PRESENCE OF VOIDS IS OPTIONAL AND PATTERN TO WHICH THEY OCCUR IS VARIABLE.
  9. NOTE DELETED.
  10. DUE TO THE HIGH AMOUNT OF INSERTION FORCE NEEDED, THE -LC OPTION IS NOT COMPATIBLE WITH AUTO PLACEMENT. SAMTEC RECOMMENDS MANUAL PLACEMENT FOR ALL ASSEMBLIES WITH THE -LC OPTION.
  11. STANDARD BODIES CAN BE CUT TO POSITION. FOR -LC, -FL & -PL OPTIONS, BODIES MUST BE MOLDED TO POSITION.
  12. FOR EXISTING CUSTOMERS ONLY, -POL CAN BE SUBSTITUTED FOR -PL.

## PACKAGING VIEW

[-02 POSITION TO BE BULK PACKAGED]



TUBE: PT-1-24-01-103  
PLUG: TP-09

## -TR: TAPE & REEL PACKAGING OPTION

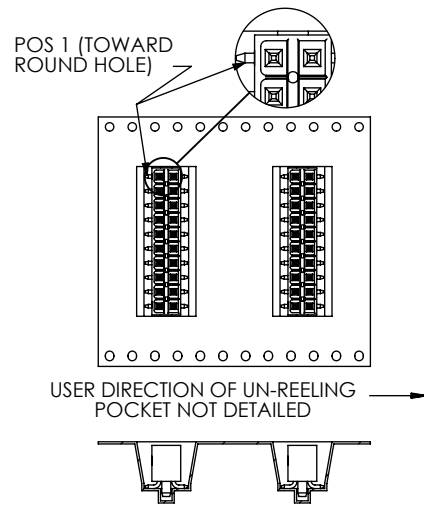

## IN-PROCESS

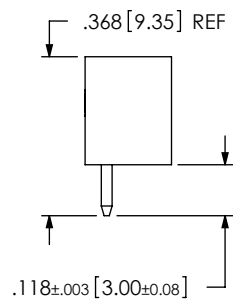

UNLESS OTHERWISE SPECIFIED, DIMENSIONS ARE IN INCHES.  
TOLERANCES ARE:  
DECIMALS ANGLES  
.XX: ±.01 [.3] ± 2°  
.XXX: ±.005 [.13]  
.XXXX: ±.0020 [.051]

PROPRIETARY NOTE  
THIS DOCUMENT CONTAINS INFORMATION CONFIDENTIAL AND PROPRIETARY TO SAMTEC, INC. AND SHALL NOT BE REPRODUCED OR TRANSFERRED TO OTHER DOCUMENTS OR DISCLOSED TO OTHERS OR USED FOR ANY PURPOSE OTHER THAN THAT WHICH IT WAS OBTAINED WITHOUT THE EXPRESSED WRITTEN CONSENT OF SAMTEC, INC.



520 PARK EAST BLVD, NEW ALBANY, IN 47150  
PHONE: 812-944-6733 FAX: 812-948-5047  
e-Mail info@SAMTEC.com code 55322

MATERIAL: DO NOT SCALE DRAWING SHEET SCALE: 2.25:1  
INSULATOR: LCP, UL 94 VO, COLOR: BLACK  
CONTACT: PHOS BRONZE, 510, 3/4 HARD

DESCRIPTION:  
.100 DOUBLE ROW SHROUDED TERMINAL ASSEMBLY  
DWG. NO.  
IPT1-1XX-XX-XX-D-VS-XX-XX

**-FL: FRICTION LOCK OPTION**

IPT1-110-01-X-D-VS-FL SHOWN

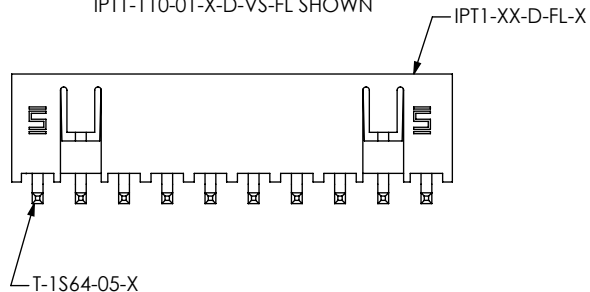

**-A: ALIGNMENT PIN OPTION**

IPT1-110-01-X-D-VS-A SHOWN

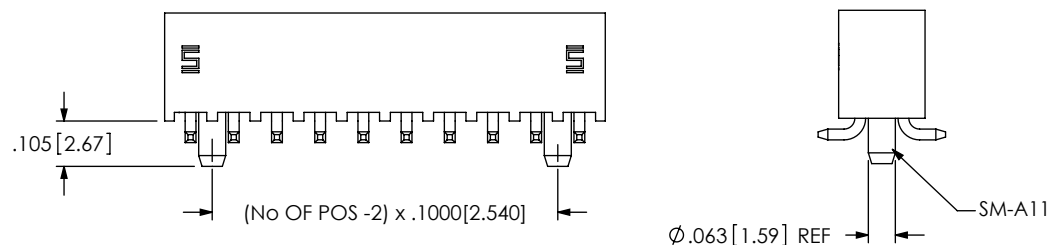

Ø.063[1.59] REF

**-PL: POLARIZED OPTION**

IPT1-110-01-X-D-VS-PL SHOWN

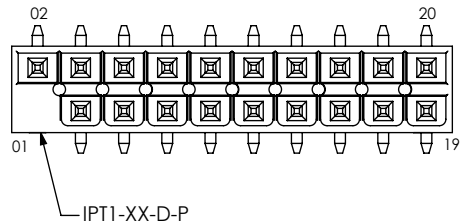

**-K: POLYIMIDE FILM PAD OPTION**

[AVAILABLE ON POSITIONS -03 THRU -25 ONLY]

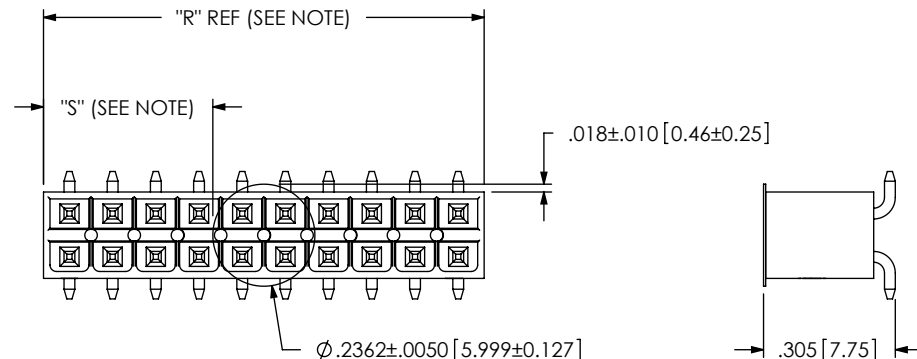

NOTE: "R" = USE MEASURED DIMENSION  
"S" = (( "R" - .2362[6.000] / 2 ) ±.020[.51])

**-LC: LOCKING CLIP OPTION**

IPT1-110-01-X-D-VS-LC-FL SHOWN

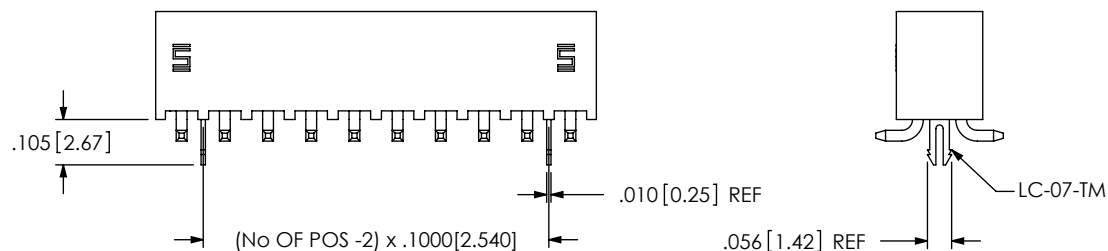

**PROPRIETARY NOTE**

THIS DOCUMENT CONTAINS INFORMATION  
CONFIDENTIAL AND PROPRIETARY TO  
SAMTEC, INC. AND SHALL NOT BE REPRODUCED  
OR TRANSFERRED TO OTHER DOCUMENTS OR  
DISCLOSED TO OTHERS OR USED FOR ANY  
PURPOSE OTHER THAN THAT WHICH IT WAS  
OBTAINED WITHOUT THE EXPRESSED WRITTEN  
CONSENT OF SAMTEC, INC.

DO NOT SCALE DRAWING

SHEET SCALE: 2:25:1

**samtec**

520 PARK EAST BLVD, NEW ALBANY, IN 47150  
PHONE: 812-944-6733 FAX: 812-948-5047  
e-Mail info@SAMTEC.com code 55322

DESCRIPTION:  
.100 DOUBLE ROW SHROUDED TERMINAL ASSEMBLY

DWG. NO.  
IPT1-1XX-XX-XX-D-VS-XX-XX

BY: DEAN P 11-06-2002 SHEET 2 OF 2