

ASO ONLY (APPLICATION SPECIFIC ORDER)

QSH-XXX-01-X-D-EMX

DO NOT
SCALE FROM
THIS PRINT

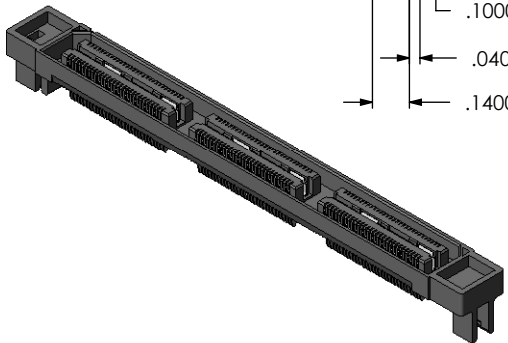
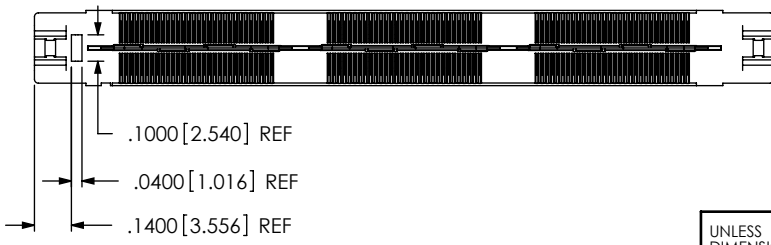
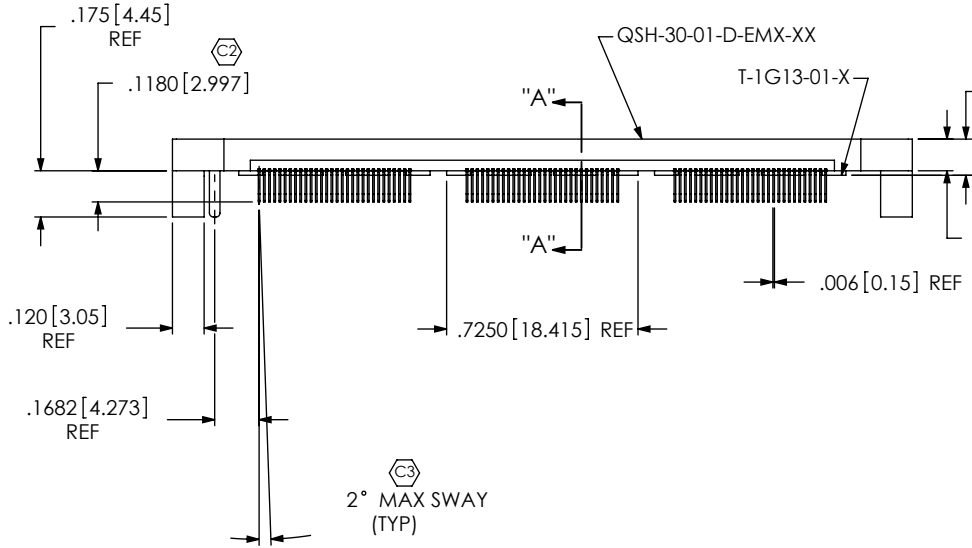
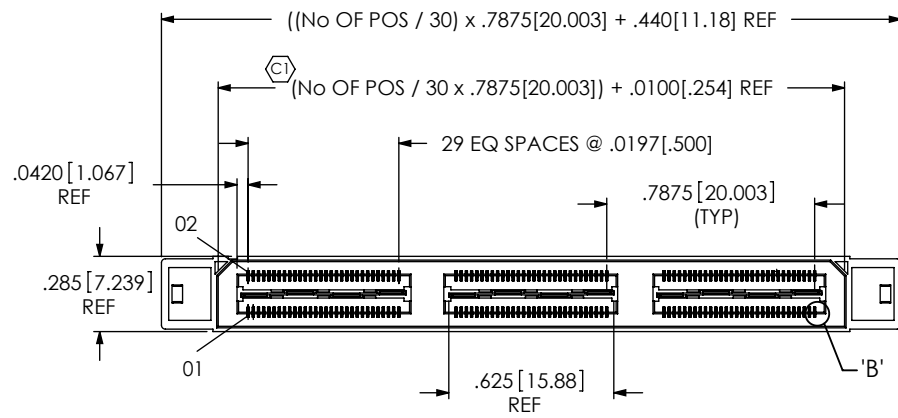

No OF POSITIONS
-030, -060, -090,
*-120, *-150
(PER ROW)

LEAD STYLE
-01: .1380[3.505]

PLATING SPECIFICATION
-F: FLASH SELECTIVE GOLD WITH MATTE TIN TAILS
(USE C-162-XX-F & T-1G13-01-F)
(SEE NOTE 6)
-L: LIGHT SELECTIVE GOLD WITH MATTE TIN TAILS
(USE C-162-XX-L & T-1G13-01-L)
-H: HEAVY GOLD
(USE C-162-XX-H & T-1G13-01-G)

* -120, -150 DO NOT DESIGN IN. SAMTEC
WILL ONLY SUPPORT EXISTING BUSINESS 12/07/07.
(SEE NOTE 11)

EDGE MOUNT THICKNESS
-EM2: .064[1.63] +/- .004 PCB
(USE QSH-30-01-D-EM2-XX & C-162-01-X)
-EM3: (USE QSH-30-01-D-EM3-XX
& C-162-02-X) **SEE NOTE 10**

ROW SPECIFICATION
-D: DOUBLE (USE QSH-30-01-D-EMX-XX)

No OF BANKS

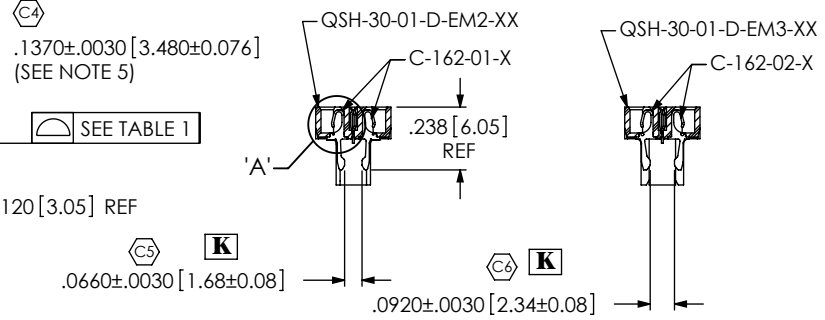

SECTION "A-A"
EDGE MOUNT THICKNESS
-EM2: .064 [1.63] +/- .004 PCB

SECTION "A-A"
EDGE MOUNT THICKNESS
-EM3:
SEE NOTE 10
(DIFFERENT AS SHOWN, OTHERWISE
SAME AS -EM2 PCB THICKNESS)

- NOTES:
1. Ⓢ REPRESENTS A CRITICAL DIMENSION.
 2. CONTACT RETENTION: 6 OZ MIN.
 3. GROUND PLANE RETENTION: 8 OZ MIN.
 4. PARTS ARE "MOLD TO POSITION".
 5. MAX VARIANCE OF .002[.05].
 6. -L PLATING CAN BE SUBSTITUTED FOR -F PLATED SIGNAL PIN.
 7. NOTE DELETED.
 8. NOTE DELETED.
 9. SEE www.samtec.com/processing/edgemt_tectalk/index.htm FOR INFORMATION ON PROCESSING EDGE MOUNT PARTS TO BOARDS.
 10. -EM3 IS NOT A STANDARD OFFERING; AVAILABLE AS AN ASP ONLY. PLEASE CONTACT SAMTEC INTERCONNECT PROCESSING GROUP WITH ORDER INQUIRIES
 11. FOR NEW APPLICATIONS REQUIRING THESE POSITIONS, PLEASE CONTACT SAMTEC INTERCONNECT PROCESSING GROUP.

TABLE 1 Ⓢ		
No OF POSITIONS	ASSEMBLY BOW	GND PLANE COPLANARITY
-030 & -060	.004 [.10]	.004 [.10]
-090, -120, & -150	.005[1.27]	.005[1.27]

UNLESS OTHERWISE SPECIFIED, DIMENSIONS ARE IN INCHES.

TOLERANCES ARE:

DECIMALS	ANGLES
.XX: ±.01[.3]	2°
.XXX: ±.005[.13]	
.XXXX: ±.0020[.051]	

PROPRIETARY NOTE

THIS DOCUMENT CONTAINS INFORMATION CONFIDENTIAL AND PROPRIETARY TO SAMTEC, INC. AND SHALL NOT BE REPRODUCED OR TRANSFERRED TO OTHER DOCUMENTS OR DISCLOSED TO OTHERS OR USED FOR ANY PURPOSE OTHER THAN THAT WHICH IT WAS OBTAINED WITHOUT THE EXPRESSED WRITTEN CONSENT OF SAMTEC, INC.

520 PARK EAST BLVD, NEW ALBANY, IN 47150
PHONE: 812-944-6733 FAX: 812-948-5047
e-Mail: info@SAMTEC.com code: 55322

MATERIAL: DO NOT SCALE DRAWING SHEET SCALE: 1.375:1

INSULATOR: LCP, COLOR: BLACK
CONTACT & GROUND PLANE: PHOS BRONZE

F:\DWG\MISC\MKTG\QSH-XXX-01-X-D-EMX-MKT.SLDDRW

DESCRIPTION:
.5mm EDGE MOUNT HIGH SPEED SOCKET ASSEMBLY

DWG. NO.
QSH-XXX-01-X-D-EMX

BY: DEAN P 5/31/2000 SHEET 1 OF 2

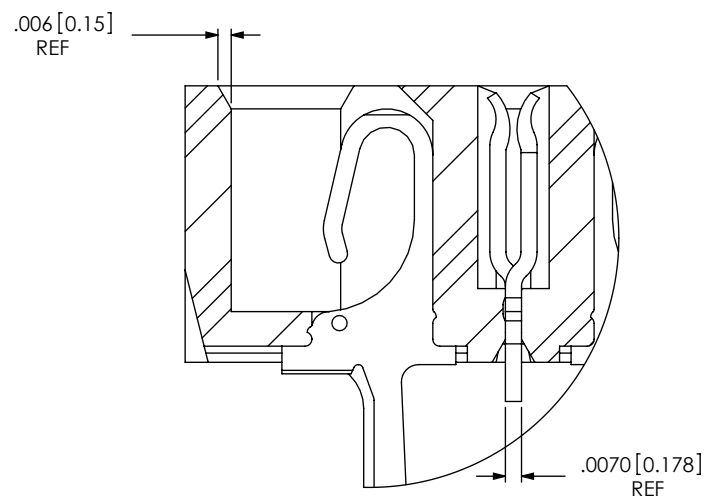

DETAIL 'A'
SCALE 12: 1

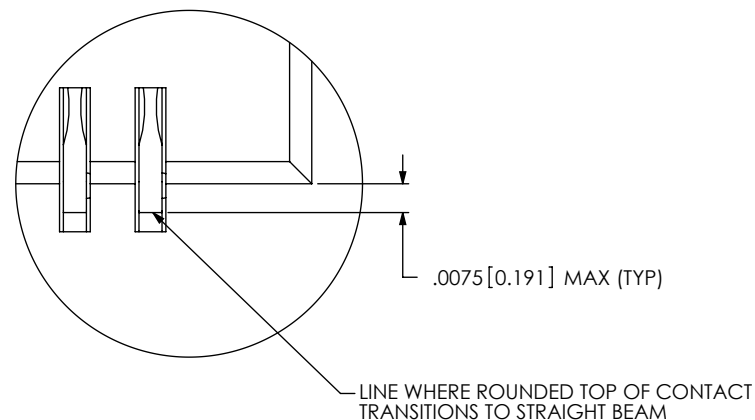

DETAIL 'B'
SCALE 20: 1

PROPRIETARY NOTE

THIS DOCUMENT CONTAINS INFORMATION
CONFIDENTIAL AND PROPRIETARY TO
SAMTEC, INC. AND SHALL NOT BE REPRODUCED
OR TRANSFERRED TO OTHER DOCUMENTS OR
DISCLOSED TO OTHERS OR USED FOR ANY
PURPOSE OTHER THAN THAT WHICH IT WAS
OBTAINED WITHOUT THE EXPRESSED WRITTEN
CONSENT OF SAMTEC, INC.

DO NOT SCALE DRAWING

SHEET SCALE: 4:1

samtec

520 PARK EAST BLVD, NEW ALBANY, IN 47150
PHONE: 812-944-6733 FAX: 812-948-5047
e-Mail: info@SAMTEC.com code: 55322

DESCRIPTION:
.5mm EDGE MOUNT HIGH SPEED SOCKET ASSEMBLY

DWG. NO.
QSH-XXX-01-X-D-EMX

BY: DEAN P 5/31/2000 SHEET 2 OF 2