

-----Original Message-----

From: Richard Cornell [<mailto:Richard.Cornell@samtec.com>]

Sent: Friday, November 07, 2008 1:11 PM

To: CustEN

Subject: Samtec Engineering Change Notification - Drawings Attached

<<Cad.zip>>

ECN Number: 99850

Part #: QSE-XXX-XX-X-D-DP-XXX-XXXXX

Date of Change: 11/03/08

ECN Changes:

END VIEW, UNDER C-126-21-X AND LEADER, ADD *SEE NOTE 14. ADD NOTE 14:

FOR

-056, -070 POSITIONS USE C-269-01-X. DO NOT SUB C-126. PLATING OPTIONS,

CHANGE C-126-21-X TO C-126-21-X * SEE NOTE 14; CHG GROUND PLANE FROM -L

TO

-G.

PROPRIETARY NOTE:

The enclosed documents contain information confidential and proprietary to

Samtec, Inc. and shall not be reproduced or transferred to other documents

or disclosed to others without the expressed written consent of Samtec, Inc.

- <SAMTEC_PCN_PARTS_AFFECTED>
<PART NAME="QSE-014-01-F-D-DP" />
<PART NAME="QSE-014-01-F-D-DP-A" />
<PART NAME="QSE-014-01-F-D-DP-A-K" />
<PART NAME="QSE-014-01-F-D-DP-A-K-TR" />
<PART NAME="QSE-014-01-F-D-DP-A-RT1" />
<PART NAME="QSE-014-01-F-D-DP-A-RT1-.F/H" />
<PART NAME="QSE-014-01-F-D-DP-A-TR" />
<PART NAME="QSE-014-01-F-D-DP-EM2" />
<PART NAME="QSE-014-01-F-D-DP-LC" />
<PART NAME="QSE-014-01-H-D-DP-.F/H" />
<PART NAME="QSE-014-01-H-D-DP-A" />
<PART NAME="QSE-014-01-H-D-DP-A-.F/H" />
<PART NAME="QSE-014-01-H-D-DP-A-K" />
<PART NAME="QSE-014-01-H-D-DP-A-K-TR" />
<PART NAME="QSE-014-01-H-D-DP-A-RT1-.F/H" />
<PART NAME="QSE-014-01-H-D-DP-A-RT1-K" />
<PART NAME="QSE-014-01-H-D-DP-A-TR" />
<PART NAME="QSE-014-01-H-D-DP-EM2" />
<PART NAME="QSE-014-01-H-D-DP-EM2-.F/H" />
<PART NAME="QSE-014-01-L-D-DP" />
<PART NAME="QSE-014-01-L-D-DP-A" />
<PART NAME="QSE-014-01-L-D-DP-A-.F/H" />
<PART NAME="QSE-014-01-L-D-DP-A-GP" />
<PART NAME="QSE-014-01-L-D-DP-A-K" />
<PART NAME="QSE-014-01-L-D-DP-A-K-TR" />
<PART NAME="QSE-014-01-L-D-DP-A-K-TY" />
<PART NAME="QSE-014-01-L-D-DP-A-TR" />
<PART NAME="QSE-014-01-L-D-DP-EM2" />
<PART NAME="QSE-014-01-L-D-DP-EM2-GP" />
<PART NAME="QSE-014-01-L-D-DP-LC" />
<PART NAME="QSE-020-01-C-D-A" />
<PART NAME="QSE-020-01-F-D" />
<PART NAME="QSE-020-01-F-D-A" />
<PART NAME="QSE-020-01-F-D-A-.CLS" />
<PART NAME="QSE-020-01-F-D-A-FL" />
<PART NAME="QSE-020-01-F-D-A-GP" />
<PART NAME="QSE-020-01-F-D-A-GP-K" />
<PART NAME="QSE-020-01-F-D-A-GP-K-TR" />
<PART NAME="QSE-020-01-F-D-A-K" />
<PART NAME="QSE-020-01-F-D-A-K-TR" />
<PART NAME="QSE-020-01-F-D-A-K-TR-.CLS" />
<PART NAME="QSE-020-01-F-D-A-K-TR-.H" />
<PART NAME="QSE-020-01-F-D-A-K-TR-.R" />
<PART NAME="QSE-020-01-F-D-A-RT1" />
<PART NAME="QSE-020-01-F-D-A-RT1-.F/H" />
<PART NAME="QSE-020-01-F-D-A-TR" />
<PART NAME="QSE-020-01-F-D-A-TR-.MIR" />
<PART NAME="QSE-020-01-F-D-EM2" />
<PART NAME="QSE-020-01-F-D-EM2-GP" />
<PART NAME="QSE-020-01-F-D-FL" />
<PART NAME="QSE-020-01-F-D-GP" />

<PART NAME="QSE-020-01-F-D-K" />
<PART NAME="QSE-020-01-F-D-K-TR" />
<PART NAME="QSE-020-01-F-D-K-TR-.SLR" />
<PART NAME="QSE-020-01-F-D-LC" />
<PART NAME="QSE-020-01-F-D-LC-K" />
<PART NAME="QSE-020-01-F-D-LC-K-TR" />
<PART NAME="QSE-020-01-F-D-LC-TR" />
<PART NAME="QSE-020-01-F-D-TR" />
<PART NAME="QSE-020-01-H-D-A" />
<PART NAME="QSE-020-01-H-D-A-.F/H" />
<PART NAME="QSE-020-01-H-D-A-GP" />
<PART NAME="QSE-020-01-H-D-A-K" />
<PART NAME="QSE-020-01-H-D-A-K-TR" />
<PART NAME="QSE-020-01-H-D-A-K-TR-.F/H" />
<PART NAME="QSE-020-01-H-D-A-K-TR-.SLR" />
<PART NAME="QSE-020-01-H-D-A-RT1-.F/H" />
<PART NAME="QSE-020-01-H-D-A-TR" />
<PART NAME="QSE-020-01-H-D-A-TY" />
<PART NAME="QSE-020-01-H-D-EM2" />
<PART NAME="QSE-020-01-H-D-EM2-.F/H" />
<PART NAME="QSE-020-01-H-D-K-TR" />
<PART NAME="QSE-020-01-H-D-LC" />
<PART NAME="QSE-020-01-L-D" />
<PART NAME="QSE-020-01-L-D-A" />
<PART NAME="QSE-020-01-L-D-A-.F/H" />
<PART NAME="QSE-020-01-L-D-A-FL" />
<PART NAME="QSE-020-01-L-D-A-FL-.CR" />
<PART NAME="QSE-020-01-L-D-A-GP" />
<PART NAME="QSE-020-01-L-D-A-GP-K" />
<PART NAME="QSE-020-01-L-D-A-GP-K-TR" />
<PART NAME="QSE-020-01-L-D-A-GP-TR" />
<PART NAME="QSE-020-01-L-D-A-K" />
<PART NAME="QSE-020-01-L-D-A-K-GP" />
<PART NAME="QSE-020-01-L-D-A-K-TR" />
<PART NAME="QSE-020-01-L-D-A-K-TR-.A" />
<PART NAME="QSE-020-01-L-D-A-K-TR-.CLS" />
<PART NAME="QSE-020-01-L-D-A-K-TR-.F" />
<PART NAME="QSE-020-01-L-D-A-K-TR-.JAB" />
<PART NAME="QSE-020-01-L-D-A-K-TR-.JABFL" />
<PART NAME="QSE-020-01-L-D-A-K-TR-.JBL" />
<PART NAME="QSE-020-01-L-D-A-K-TR-.SOL" />
<PART NAME="QSE-020-01-L-D-A-K-TR-.SOLTX" />
<PART NAME="QSE-020-01-L-D-A-K-TY" />
<PART NAME="QSE-020-01-L-D-A-TR" />
<PART NAME="QSE-020-01-L-D-A-TR-.JABFL" />
<PART NAME="QSE-020-01-L-D-EM2" />
<PART NAME="QSE-020-01-L-D-EM2-GP" />
<PART NAME="QSE-020-01-L-D-EM3-.PARATE" />
<PART NAME="QSE-020-01-L-D-GP" />
<PART NAME="QSE-020-01-L-D-K" />
<PART NAME="QSE-020-01-L-D-K-TR" />
<PART NAME="QSE-020-01-L-D-K-TY" />

<PART NAME="QSE-020-01-L-D-LC" />
<PART NAME="QSE-020-01-L-D-TR" />
<PART NAME="QSE-028-01-F-D-DP" />
<PART NAME="QSE-028-01-F-D-DP-A" />
<PART NAME="QSE-028-01-F-D-DP-A-K" />
<PART NAME="QSE-028-01-F-D-DP-A-K-TR" />
<PART NAME="QSE-028-01-F-D-DP-A-RT1-.F/H" />
<PART NAME="QSE-028-01-F-D-DP-EM2" />
<PART NAME="QSE-028-01-F-D-DP-GP" />
<PART NAME="QSE-028-01-F-D-DP-LC" />
<PART NAME="QSE-028-01-H-D-DP-A" />
<PART NAME="QSE-028-01-H-D-DP-A-.F/H" />
<PART NAME="QSE-028-01-H-D-DP-A-K" />
<PART NAME="QSE-028-01-H-D-DP-A-K-TR" />
<PART NAME="QSE-028-01-H-D-DP-A-RT1" />
<PART NAME="QSE-028-01-H-D-DP-A-RT1-.F/H" />
<PART NAME="QSE-028-01-H-D-DP-A-TR" />
<PART NAME="QSE-028-01-H-D-DP-EM2" />
<PART NAME="QSE-028-01-H-D-DP-EM2-.F/H" />
<PART NAME="QSE-028-01-H-D-DP-K-TR" />
<PART NAME="QSE-028-01-L-D-DP" />
<PART NAME="QSE-028-01-L-D-DP-.F/H" />
<PART NAME="QSE-028-01-L-D-DP-A" />
<PART NAME="QSE-028-01-L-D-DP-A-.F/H" />
<PART NAME="QSE-028-01-L-D-DP-A-.H" />
<PART NAME="QSE-028-01-L-D-DP-A-GP" />
<PART NAME="QSE-028-01-L-D-DP-A-GP-.F/H" />
<PART NAME="QSE-028-01-L-D-DP-A-K" />
<PART NAME="QSE-028-01-L-D-DP-A-K-TR" />
<PART NAME="QSE-028-01-L-D-DP-A-RT1" />
<PART NAME="QSE-028-01-L-D-DP-A-TR" />
<PART NAME="QSE-028-01-L-D-DP-A-TR-.NARA" />
<PART NAME="QSE-028-01-L-D-DP-EM2" />
<PART NAME="QSE-028-01-L-D-DP-GP" />
<PART NAME="QSE-028-01-L-D-DP-LC" />
<PART NAME="QSE-040-01-C-D-A" />
<PART NAME="QSE-040-01-F-D" />
<PART NAME="QSE-040-01-F-D-A" />
<PART NAME="QSE-040-01-F-D-A-.F/H" />
<PART NAME="QSE-040-01-F-D-A-.MIR" />
<PART NAME="QSE-040-01-F-D-A-FL" />
<PART NAME="QSE-040-01-F-D-A-GP" />
<PART NAME="QSE-040-01-F-D-A-GP-K" />
<PART NAME="QSE-040-01-F-D-A-GP-K-TR" />
<PART NAME="QSE-040-01-F-D-A-GP-TR" />
<PART NAME="QSE-040-01-F-D-A-K" />
<PART NAME="QSE-040-01-F-D-A-K-TR" />
<PART NAME="QSE-040-01-F-D-A-K-TR-.CLS" />
<PART NAME="QSE-040-01-F-D-A-K-TR-.FUJIT" />
<PART NAME="QSE-040-01-F-D-A-K-TR-.H" />
<PART NAME="QSE-040-01-F-D-A-K-TR-.R" />
<PART NAME="QSE-040-01-F-D-A-K-TR-.XYRAT" />

<PART NAME="QSE-040-01-F-D-A-RT1" />
<PART NAME="QSE-040-01-F-D-A-RT1-.F/H" />
<PART NAME="QSE-040-01-F-D-A-TR" />
<PART NAME="QSE-040-01-F-D-EM2" />
<PART NAME="QSE-040-01-F-D-EM2-GP" />
<PART NAME="QSE-040-01-F-D-K" />
<PART NAME="QSE-040-01-F-D-K-TR" />
<PART NAME="QSE-040-01-F-D-LC" />
<PART NAME="QSE-040-01-F-D-LC-K" />
<PART NAME="QSE-040-01-F-D-LC-TR" />
<PART NAME="QSE-040-01-F-D-TR" />
<PART NAME="QSE-040-01-H-D-A" />
<PART NAME="QSE-040-01-H-D-A-.F/H" />
<PART NAME="QSE-040-01-H-D-A-GP" />
<PART NAME="QSE-040-01-H-D-A-K" />
<PART NAME="QSE-040-01-H-D-A-K-TR" />
<PART NAME="QSE-040-01-H-D-A-TR" />
<PART NAME="QSE-040-01-H-D-A-TY" />
<PART NAME="QSE-040-01-H-D-EM2" />
<PART NAME="QSE-040-01-H-D-EM2-.F/H" />
<PART NAME="QSE-040-01-H-D-K-TR" />
<PART NAME="QSE-040-01-H-D-LC" />
<PART NAME="QSE-040-01-L-D" />
<PART NAME="QSE-040-01-L-D-A" />
<PART NAME="QSE-040-01-L-D-A-.F/H" />
<PART NAME="QSE-040-01-L-D-A-.JBL" />
<PART NAME="QSE-040-01-L-D-A-.K" />
<PART NAME="QSE-040-01-L-D-A-GP" />
<PART NAME="QSE-040-01-L-D-A-GP-.F/H" />
<PART NAME="QSE-040-01-L-D-A-GP-K" />
<PART NAME="QSE-040-01-L-D-A-GP-K-TR" />
<PART NAME="QSE-040-01-L-D-A-GP-TR" />
<PART NAME="QSE-040-01-L-D-A-K" />
<PART NAME="QSE-040-01-L-D-A-K-.H" />
<PART NAME="QSE-040-01-L-D-A-K-TR" />
<PART NAME="QSE-040-01-L-D-A-K-TR-.JAB" />
<PART NAME="QSE-040-01-L-D-A-K-TR-.JABSC" />
<PART NAME="QSE-040-01-L-D-A-K-TR-.JBL" />
<PART NAME="QSE-040-01-L-D-A-K-TY" />
<PART NAME="QSE-040-01-L-D-A-RT1" />
<PART NAME="QSE-040-01-L-D-A-RT1-K-TR" />
<PART NAME="QSE-040-01-L-D-A-TR" />
<PART NAME="QSE-040-01-L-D-A-TY" />
<PART NAME="QSE-040-01-L-D-EM2" />
<PART NAME="QSE-040-01-L-D-EM2-GP" />
<PART NAME="QSE-040-01-L-D-EM2-GP-.F/H" />
<PART NAME="QSE-040-01-L-D-EM3-.C-DOT" />
<PART NAME="QSE-040-01-L-D-GP" />
<PART NAME="QSE-040-01-L-D-K" />
<PART NAME="QSE-040-01-L-D-K-TR" />
<PART NAME="QSE-040-01-L-D-K-TY" />
<PART NAME="QSE-040-01-L-D-LC" />

<PART NAME="QSE-040-01-L-D-LC-.F/H" />
<PART NAME="QSE-040-01-L-D-LC-K-TR" />
<PART NAME="QSE-040-01-L-D-LC-TR" />
<PART NAME="QSE-040-01-L-D-TR" />
<PART NAME="QSE-042-01-F-D-DP" />
<PART NAME="QSE-042-01-F-D-DP-A" />
<PART NAME="QSE-042-01-F-D-DP-A-K" />
<PART NAME="QSE-042-01-F-D-DP-A-K-TR" />
<PART NAME="QSE-042-01-F-D-DP-A-K-TR-.JAB" />
<PART NAME="QSE-042-01-F-D-DP-A-RT1" />
<PART NAME="QSE-042-01-F-D-DP-A-RT1-.F/H" />
<PART NAME="QSE-042-01-F-D-DP-A-TR" />
<PART NAME="QSE-042-01-F-D-DP-EM2" />
<PART NAME="QSE-042-01-H-D-DP" />
<PART NAME="QSE-042-01-H-D-DP-A" />
<PART NAME="QSE-042-01-H-D-DP-A-.F/H" />
<PART NAME="QSE-042-01-H-D-DP-A-TR" />
<PART NAME="QSE-042-01-H-D-DP-EM2" />
<PART NAME="QSE-042-01-H-D-DP-EM2-.F/H" />
<PART NAME="QSE-042-01-L-D-DP" />
<PART NAME="QSE-042-01-L-D-DP-A" />
<PART NAME="QSE-042-01-L-D-DP-A-.F/H" />
<PART NAME="QSE-042-01-L-D-DP-A-GP" />
<PART NAME="QSE-042-01-L-D-DP-A-K" />
<PART NAME="QSE-042-01-L-D-DP-A-K-TR" />
<PART NAME="QSE-042-01-L-D-DP-A-TR" />
<PART NAME="QSE-042-01-L-D-DP-EM2" />
<PART NAME="QSE-042-01-L-D-DP-EM2-GP" />
<PART NAME="QSE-042-01-L-D-DP-GP" />
<PART NAME="QSE-056-01-F-D-DP-A" />
<PART NAME="QSE-056-01-F-D-DP-A-K" />
<PART NAME="QSE-056-01-H-D-DP-A" />
<PART NAME="QSE-056-01-H-D-DP-A-.F/H" />
<PART NAME="QSE-056-01-H-D-DP-EM2" />
<PART NAME="QSE-056-01-H-D-DP-EM2-.F/H" />
<PART NAME="QSE-056-01-L-D-DP" />
<PART NAME="QSE-056-01-L-D-DP-A" />
<PART NAME="QSE-056-01-L-D-DP-A-GP" />
<PART NAME="QSE-056-01-L-D-DP-A-K" />
<PART NAME="QSE-056-01-L-D-DP-EM2" />
<PART NAME="QSE-056-01-L-D-DP-GP" />
<PART NAME="QSE-056-01-L-D-DP-K" />
<PART NAME="QSE-056-01-L-D-DP-LC" />
<PART NAME="QSE-060-01-F-D" />
<PART NAME="QSE-060-01-F-D-A" />
<PART NAME="QSE-060-01-F-D-A-.F/H" />
<PART NAME="QSE-060-01-F-D-A-GP" />
<PART NAME="QSE-060-01-F-D-A-GP-K" />
<PART NAME="QSE-060-01-F-D-A-GP-K-.SLR" />
<PART NAME="QSE-060-01-F-D-A-K" />
<PART NAME="QSE-060-01-F-D-A-K-.R" />
<PART NAME="QSE-060-01-F-D-A-K-TR" />

<PART NAME="QSE-060-01-F-D-A-K-TR-.R" />
<PART NAME="QSE-060-01-F-D-A-RT1" />
<PART NAME="QSE-060-01-F-D-A-RT1-.F/H" />
<PART NAME="QSE-060-01-F-D-A-TR" />
<PART NAME="QSE-060-01-F-D-EM2" />
<PART NAME="QSE-060-01-F-D-EM2-GP" />
<PART NAME="QSE-060-01-F-D-GP" />
<PART NAME="QSE-060-01-F-D-K-TR" />
<PART NAME="QSE-060-01-F-D-LC" />
<PART NAME="QSE-060-01-F-D-LC-K" />
<PART NAME="QSE-060-01-F-D-LC-K-TR" />
<PART NAME="QSE-060-01-H-D-A" />
<PART NAME="QSE-060-01-H-D-A-.F/H" />
<PART NAME="QSE-060-01-H-D-A-GP" />
<PART NAME="QSE-060-01-H-D-A-K" />
<PART NAME="QSE-060-01-H-D-A-K-TR" />
<PART NAME="QSE-060-01-H-D-A-RT1" />
<PART NAME="QSE-060-01-H-D-A-RT1-.F/H" />
<PART NAME="QSE-060-01-H-D-A-TR" />
<PART NAME="QSE-060-01-H-D-A-TY" />
<PART NAME="QSE-060-01-H-D-EM2" />
<PART NAME="QSE-060-01-H-D-EM2-.F/H" />
<PART NAME="QSE-060-01-H-D-EM2-GP" />
<PART NAME="QSE-060-01-H-D-EM2-TY" />
<PART NAME="QSE-060-01-H-D-GP-LC" />
<PART NAME="QSE-060-01-H-D-K-TR" />
<PART NAME="QSE-060-01-L-D" />
<PART NAME="QSE-060-01-L-D-A" />
<PART NAME="QSE-060-01-L-D-A-.F/H" />
<PART NAME="QSE-060-01-L-D-A-GP" />
<PART NAME="QSE-060-01-L-D-A-GP-K" />
<PART NAME="QSE-060-01-L-D-A-K" />
<PART NAME="QSE-060-01-L-D-A-K-.H" />
<PART NAME="QSE-060-01-L-D-A-K-TR" />
<PART NAME="QSE-060-01-L-D-A-K-TR-.JABMX" />
<PART NAME="QSE-060-01-L-D-A-K-TR-.MIR" />
<PART NAME="QSE-060-01-L-D-A-K-TY" />
<PART NAME="QSE-060-01-L-D-A-TR" />
<PART NAME="QSE-060-01-L-D-EM2" />
<PART NAME="QSE-060-01-L-D-EM2-GP" />
<PART NAME="QSE-060-01-L-D-FL" />
<PART NAME="QSE-060-01-L-D-FL-K-TR" />
<PART NAME="QSE-060-01-L-D-GP" />
<PART NAME="QSE-060-01-L-D-K" />
<PART NAME="QSE-060-01-L-D-K-TR" />
<PART NAME="QSE-060-01-L-D-K-TY" />
<PART NAME="QSE-060-01-L-D-LC" />
<PART NAME="QSE-060-01-L-D-LC-K" />
<PART NAME="QSE-060-01-L-D-LC-TR" />
<PART NAME="QSE-060-01-L-D-TR" />
<PART NAME="QSE-070-01-F-D-DP-A" />
<PART NAME="QSE-070-01-F-D-DP-DDSDD" />

<PART NAME="QSE-070-01-F-D-DP-EM2" />
<PART NAME="QSE-070-01-F-D-DP-SDDSS" />
<PART NAME="QSE-070-01-F-D-DP-SSDSD" />
<PART NAME="QSE-070-01-H-D-DP-A" />
<PART NAME="QSE-070-01-H-D-DP-A-.F/H" />
<PART NAME="QSE-070-01-L-D-DP" />
<PART NAME="QSE-070-01-L-D-DP-A" />
<PART NAME="QSE-070-01-L-D-DP-A-.F/H" />
<PART NAME="QSE-070-01-L-D-DP-A-GP" />
<PART NAME="QSE-070-01-L-D-DP-A-K" />
<PART NAME="QSE-070-01-L-D-DP-EM2" />
<PART NAME="QSE-080-01-F-D" />
<PART NAME="QSE-080-01-F-D-A" />
<PART NAME="QSE-080-01-F-D-A-GP" />
<PART NAME="QSE-080-01-F-D-A-GP-K" />
<PART NAME="QSE-080-01-F-D-A-K" />
<PART NAME="QSE-080-01-F-D-A-K-.R" />
<PART NAME="QSE-080-01-F-D-EM2" />
<PART NAME="QSE-080-01-F-D-EM2-.XYRAT" />
<PART NAME="QSE-080-01-F-D-LC" />
<PART NAME="QSE-080-01-H-D-A" />
<PART NAME="QSE-080-01-H-D-A-.F/H" />
<PART NAME="QSE-080-01-H-D-A-GP" />
<PART NAME="QSE-080-01-H-D-A-K" />
<PART NAME="QSE-080-01-H-D-A-TY" />
<PART NAME="QSE-080-01-H-D-EM2" />
<PART NAME="QSE-080-01-H-D-EM2-.F/H" />
<PART NAME="QSE-080-01-H-D-EM2-TY" />
<PART NAME="QSE-080-01-L-D" />
<PART NAME="QSE-080-01-L-D-A" />
<PART NAME="QSE-080-01-L-D-A-GP" />
<PART NAME="QSE-080-01-L-D-A-GP-K" />
<PART NAME="QSE-080-01-L-D-A-K" />
<PART NAME="QSE-080-01-L-D-A-K-.H" />
<PART NAME="QSE-080-01-L-D-A-TY" />
<PART NAME="QSE-080-01-L-D-EM2" />
<PART NAME="QSE-080-01-L-D-EM3-.NORTEL" />
<PART NAME="QSE-080-01-L-D-GP" />
<PART NAME="QSE-080-01-L-D-K" />
<PART NAME="QSE-080-01-L-D-LC" />
<PART NAME="QSE-100-01-F-D" />
<PART NAME="QSE-100-01-F-D-A" />
<PART NAME="QSE-100-01-F-D-A-GP" />
<PART NAME="QSE-100-01-F-D-A-GP-K" />
<PART NAME="QSE-100-01-F-D-A-K" />
<PART NAME="QSE-100-01-F-D-A-K-.R" />
<PART NAME="QSE-100-01-F-D-A-K-GP" />
<PART NAME="QSE-100-01-F-D-A-TY" />
<PART NAME="QSE-100-01-F-D-EM2" />
<PART NAME="QSE-100-01-F-D-EM3-.CEDAR" />
<PART NAME="QSE-100-01-H-D" />
<PART NAME="QSE-100-01-H-D-.F/H" />

<PART NAME="QSE-100-01-H-D-A" />
<PART NAME="QSE-100-01-H-D-A-.F/H" />
<PART NAME="QSE-100-01-L-D" />
<PART NAME="QSE-100-01-L-D-A" />
<PART NAME="QSE-100-01-L-D-A-.F/H" />
<PART NAME="QSE-100-01-L-D-A-FL" />
<PART NAME="QSE-100-01-L-D-A-GP" />
<PART NAME="QSE-100-01-L-D-A-K" />
<PART NAME="QSE-100-01-L-D-A-K-TY" />
<PART NAME="QSE-100-01-L-D-EM2" />
<PART NAME="QSE-100-01-L-D-EM3-.CEDAR" />
<PART NAME="QSE-100-01-L-D-EM3-.PLEXUS" />
<PART NAME="QSE-100-01-L-D-GP" />
<PART NAME="QSE-100-01-L-D-LC" />
<PART NAME="QSE-14-01-D-DP-01-A" />
<PART NAME="QSE-14-01-D-DP-02-A" />
<PART NAME="QSE-14-01-D-DP-03-A" />
<PART NAME="QSE-14-01-D-DP-05" />
<PART NAME="QSE-20-01-D-01" />
<PART NAME="QSE-20-01-D-01-.CR" />
<PART NAME="QSE-20-01-D-01-A" />
<PART NAME="QSE-20-01-D-01-A-.CR" />
<PART NAME="QSE-20-01-D-01-A-FL" />
<PART NAME="QSE-20-01-D-01-A-FL-.CR" />
<PART NAME="QSE-20-01-D-01-A-GP" />
<PART NAME="QSE-20-01-D-01-A-RT1" />
<PART NAME="QSE-20-01-D-01-FL" />
<PART NAME="QSE-20-01-D-01-GP" />
<PART NAME="QSE-20-01-D-02" />
<PART NAME="QSE-20-01-D-02-.CR" />
<PART NAME="QSE-20-01-D-02-A" />
<PART NAME="QSE-20-01-D-02-A-.CR" />
<PART NAME="QSE-20-01-D-02-A-FL" />
<PART NAME="QSE-20-01-D-02-A-FL-.CR" />
<PART NAME="QSE-20-01-D-02-A-GP" />
<PART NAME="QSE-20-01-D-02-A-RT1" />
<PART NAME="QSE-20-01-D-02-GP" />
<PART NAME="QSE-20-01-D-03" />
<PART NAME="QSE-20-01-D-03-.CR" />
<PART NAME="QSE-20-01-D-03-A" />
<PART NAME="QSE-20-01-D-03-A-.CR" />
<PART NAME="QSE-20-01-D-03-A-GP" />
<PART NAME="QSE-20-01-D-03-A-RT1" />
<PART NAME="QSE-20-01-D-03-FL" />
<PART NAME="QSE-20-01-D-03-FL-.CR" />
<PART NAME="QSE-20-01-D-03-GP" />
<PART NAME="QSE-20-01-D-04" />
<PART NAME="QSE-20-01-D-04-.CR" />
<PART NAME="QSE-20-01-D-04-A" />
<PART NAME="QSE-20-01-D-04-A-.CR" />
<PART NAME="QSE-20-01-D-04-A-GP" />
<PART NAME="QSE-20-01-D-04-GP" />

<PART NAME="QSE-20-01-D-05" />
<PART NAME="QSE-20-01-D-05-.CR" />
<PART NAME="QSE-20-01-D-05-A" />
<PART NAME="QSE-20-01-D-05-A-FL" />
<PART NAME="QSE-20-01-D-05-A-GP" />
<PART NAME="QSE-20-01-D-05-GP" />
<PART NAME="QSE-20-01-D-EM2-01" />
<PART NAME="QSE-20-01-D-EM2-01-GP" />
<PART NAME="QSE-20-01-D-EM2-02" />
<PART NAME="QSE-20-01-D-EM2-02-GP" />
<PART NAME="QSE-20-01-D-EM2-03" />
<PART NAME="QSE-20-01-D-EM2-03-GP" />
<PART NAME="QSE-20-01-D-EM2-04" />
<PART NAME="QSE-20-01-D-EM2-04-GP" />
<PART NAME="QSE-20-01-D-EM2-05" />
<PART NAME="QSE-20-01-D-EM2-05-GP" />
<PART NAME="QSE-20-01-D-EM3-01" />
<PART NAME="QSE-20-01-D-EM3-02" />
<PART NAME="QSE-20-01-D-EM3-02-GP" />
<PART NAME="QSE-20-01-D-EM3-03" />
<PART NAME="QSE-20-01-D-EM3-04" />
<PART NAME="QSE-20-01-D-EM3-05" />
<PART NAME="QSE-DP-SAMPLE-BOARD" />
<PART NAME="QSE-EM2-GP-SAMPLE-BOARD" />
</SAMTEC_PCN_PARTS_AFFECTED>

DO NOT SCALE FROM THIS PRINT

QSE-XXX-XX-X-D-DP-XXX-XXXX

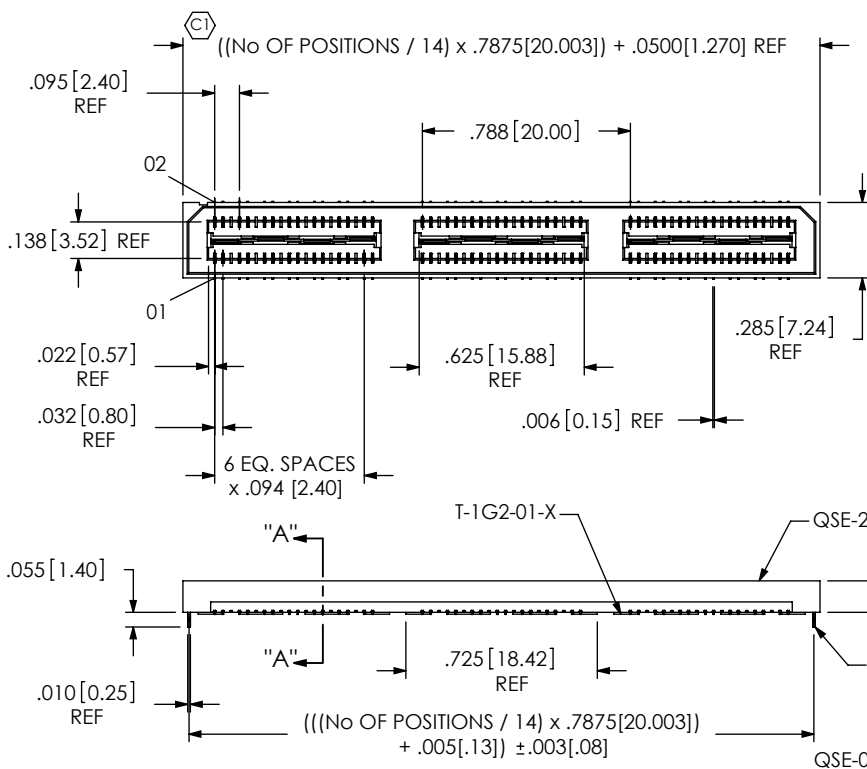

-LC: LOCKING CLIP OPTION SHOWN

- No OF POSITIONS**
(SEE NOTE 11)
-014, -028, -042,
**-056, **-070
(PER ROW)
- LEAD STYLE**
-01: .1280 [3.30]
*-02: .2460 [6.248]
- PLATING SPECIFICATION**
-F: FLASH SELECTIVE GOLD WITH MATTE TIN TAILS (USE C-126-21-F, T-1G2-01-F) (SEE NOTE 7 & 12)
-L: LIGHT SELECTIVE GOLD WITH MATTE TIN TAILS (SEE NOTE 12) (USE C-126-21-L, T-1G2-01-L)
-H: HEAVY GOLD (SEE NOTE 12) (USE C-126-21-H, T-1G2-01-G)
-C: ELECTRO POLISHED SELECTIVE (SEE NOTE 12) (USE C-126-21-C, T-1G2-01-L)
- OPTION**
-A: ALIGNMENT PINS (USE QSE-20-01-D-XX-A)
-LC: LOCKING CLIPS (USE LC-08-TM-01)
-K: POLYIMIDE FILM (USE K-DOT-.325-.450-.005, SEE FIG. 2)
-TR: TAPE & REEL (42 POS. MAX) (28 POS. MAX FOR -GP)
-GP: GUIDE POSTS (USE QSE-20-XX-D-GP, SEE FIG. 3)
-RT1: RETENTION (MUST USE -A OPTION) (USE QSE-20-01-D-XX-A-RT1 & SUB-SC-05-01-FF) (SEE FIG. 4, SHEET 2) (NOT AVAILABLE WITH -LC OR -GP) (NOT AVAILABLE IN 056 OR 070 POS)
- BODY STYLE**
-DP: DIFFERENTIAL PAIRS
- ROW SPECIFICATION**
-D: DOUBLE (USE QSE-20-01-D-XX)
- PIN COUNT, BANKS 1-5 (SEE NOTE 11)**
-S: STANDARD
-D: DIFFERENTIAL (SEE NOTE 10 SEE FIG. 5, PAGE 3)
- No OF BANKS**

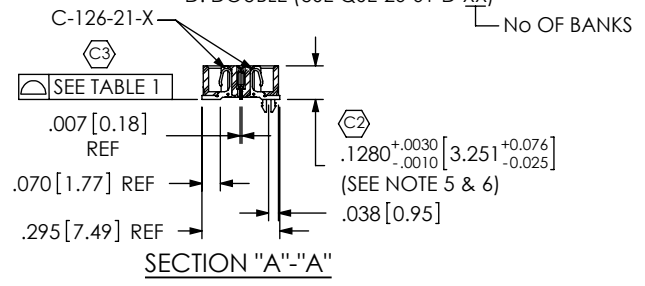
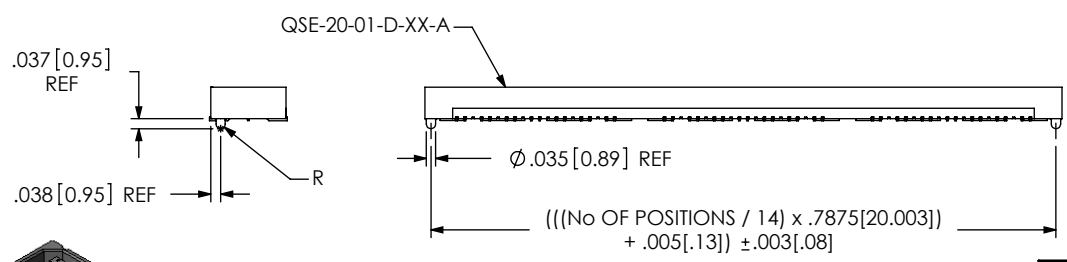

FIG. 1

QSE-042-01-X-D-DP-LC SHOWN

NOTES:

1. Ⓞ REPRESENTS A CRITICAL DIMENSION.
2. MINIMUM RETENTION: 5 OZ.
3. MINIMUM GROUND PLANE RETENTION: 8 OZ.
4. PARTS TO BE MOLDED TO POSITION.
5. MAXIMUM VARIANCE OF .002 [.05].
6. DIMENSION APPLIES TO TERMINALS AND GROUND PLANE.
7. -L PLATING CAN BE SUBSTITUTED FOR -F PLATING.
- G PLATED GROUND PLANE CAN BE SUBSTITUTED FOR -F GROUND PLANE.
8. GROUND PLANE PRESS HEIGHT MUST BE .003 [.08] LESS THAN THE MAXIMUM HEIGHT OR .001 [.03] GREATER THAN THE MINIMUM HEIGHT OF THE SOCKETS.
9. SUB-SC-05-01-XX RETENTION TO BE 1.0 LBF IN BODY.
10. IF ORDERING ALL BANKS DIFFERENTIAL PAIR, LEAVE BLANK. IF ORDERING ALL BANKS STANDARD PIN COUNT, ORDER QSE-XXX-XX-X-D-XXX (STANDARD QSE)
11. PIN COUNT PER ROW= (# -DP BANKS X 14) + (# -S BANKS X 20)
12. MAY SUB C-126-01-X FOR C-126-21-X.
13. FOR NEW APPLICATIONS REQUIRING THESE POSITIONS, PLEASE CONTACT SAMTEC INTERCONNECT PROCESSING GROUP.



-A: ALIGNMENT PIN OPTION SHOWN

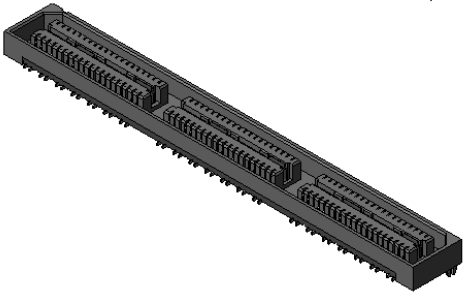

TABLE 1	
No OF POSITIONS	COPLANARITY INCLUDING GP
-014 THRU -042	.004 [.10]
-056 THRU -070	.006 [.15]

UNLESS OTHERWISE SPECIFIED, DIMENSIONS ARE IN INCHES.
TOLERANCES ARE:
DECIMALS ANGLES
.XX: ±.01 [.25] 2°
.XXX: ±.005 [.13]
.XXXX: ±.0020 [.05]

PROPRIETARY NOTE
THIS DOCUMENT CONTAINS INFORMATION CONFIDENTIAL AND PROPRIETARY TO SAMTEC, INC. AND SHALL NOT BE REPRODUCED OR TRANSFERRED TO OTHER DOCUMENTS OR DISCLOSED TO OTHERS OR USED FOR ANY PURPOSE OTHER THAN THAT WHICH IT WAS OBTAINED WITHOUT THE EXPRESSED WRITTEN CONSENT OF SAMTEC, INC.

520 PARK EAST BLVD, NEW ALBANY, IN 47150
PHONE: 812-944-6733 FAX: 812-948-5047
e-Mail: info@SAMTEC.com code: 55322

MATERIAL:
INSULATOR: BLACK LCP
CONTACT: PHOS BRONZE
GROUND PLANE: PHOS BRONZE

SHEET SCALE: 1.375:1

DESCRIPTION:
.8mm DIFFERENTIAL PAIRS HS SOCKET ASSEMBLY

DWG. NO.
QSE-XXX-XX-X-D-DP-XXX-XXXX

BY: DEAN P 5/05/2000 SHEET 1 OF 3

FIG. 2
 -K: POLYIMIDE FILM PAD
 [USE K-DOT-.325-.450-.005]

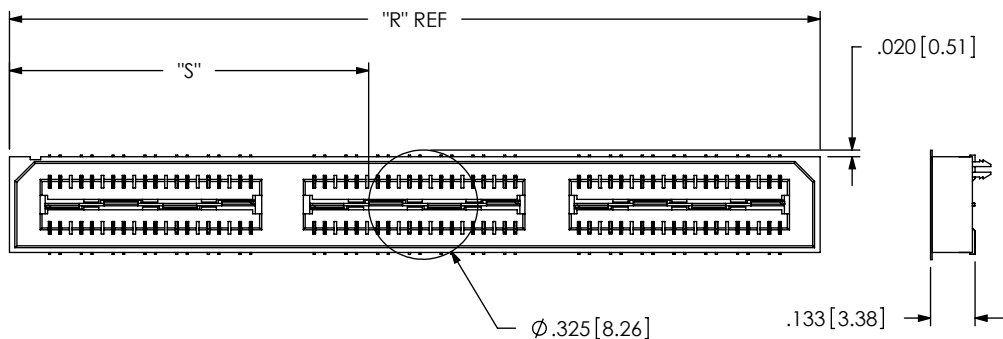

NOTE: "R" = ((No OF POSITIONS / 14) x .7875[20.003]) + .050[1.27]
 "S" = ("R" - .325[8.26]) / 2 ± .020[.51]

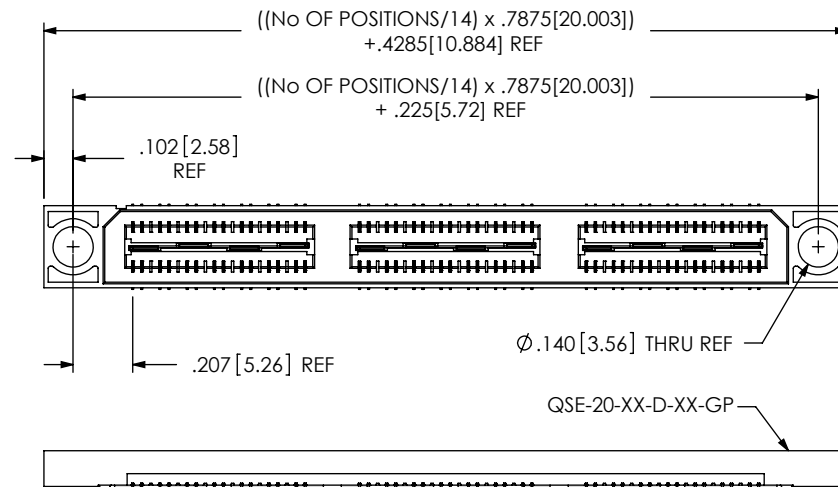
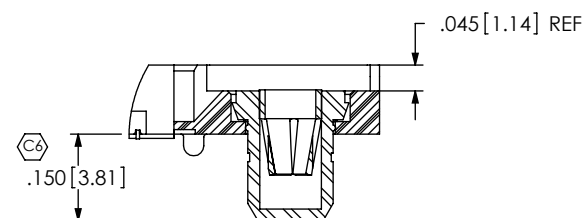
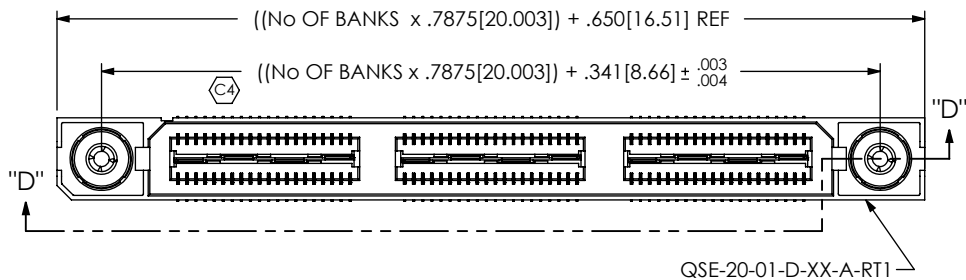
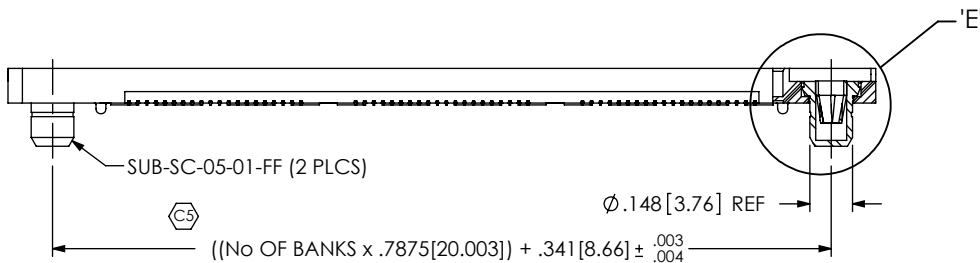

FIG. 3
 -GP OPTION
 (SAME AS FIG. 1, UNLESS OTHERWISE STATED)
 AVAILABLE ON LEAD STYLES -01 & -01-A ONLY
 (28 POSITION MAX FOR TAPE & REEL PACKAGING)

FIG. 4
 -RT1: RETENTION OPTION
 (MUST USE -A OPTION)
 (NOT AVAILABLE WITH -LC OR -GP OPTIONS)
 (SAME AS FIG. 1, UNLESS OTHERWISE STATED)



DETAIL 'E'
 SCALE 3:1



SECTION "D"-"D"
 SCALE 1.5:1

PROPRIETARY NOTE
 THIS DOCUMENT CONTAINS INFORMATION
 CONFIDENTIAL AND PROPRIETARY TO
 SAMTEC, INC. AND SHALL NOT BE REPRODUCED
 OR TRANSFERRED TO OTHER DOCUMENTS OR
 DISCLOSED TO OTHERS OR USED FOR ANY
 PURPOSE OTHER THAN THAT WHICH IT WAS
 OBTAINED WITHOUT THE EXPRESSED WRITTEN
 CONSENT OF SAMTEC, INC.

DO NOT SCALE DRAWING

SHEET SCALE: 2:1

samtec
 520 PARK EAST BLVD, NEW ALBANY, IN 47150
 PHONE: 812-944-6733 FAX: 812-948-5047
 e-Mail: info@SAMTEC.com code: 55322

DESCRIPTION:
 .8mm DIFFERENTIAL PAIRS HS SOCKET ASSEMBLY

DWG. NO.
QSE-XXX-XX-X-D-DP-XXX-XXXXX

BY: DEAN P 5/05/2000 SHEET 2 OF 3

FIG. 5
QSE-070-01-X-D-DP-A-DDDDS

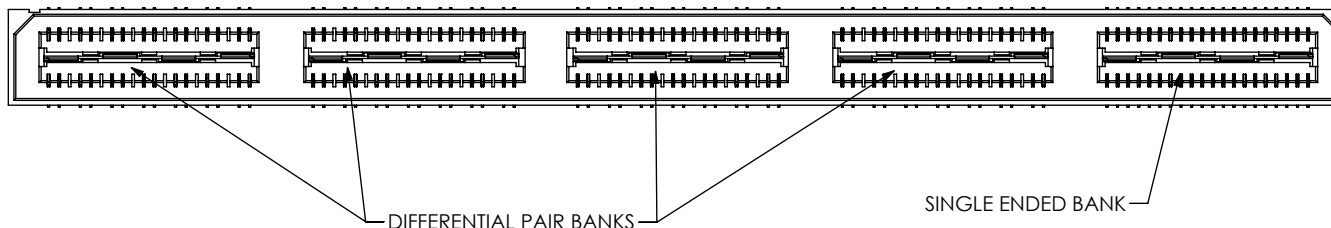
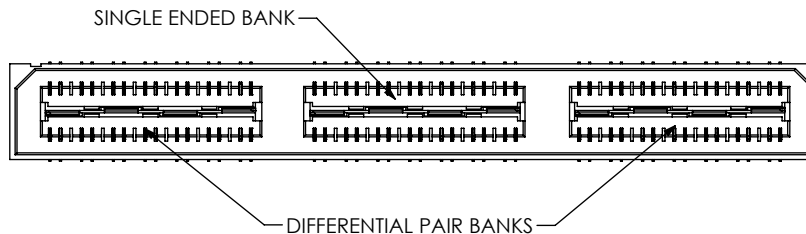



FIG. 6
QSE-042-01-X-D-DP-A-DSD SHOWN



<p>PROPRIETARY NOTE THIS DOCUMENT CONTAINS INFORMATION CONFIDENTIAL AND PROPRIETARY TO SAMTEC, INC. AND SHALL NOT BE REPRODUCED OR TRANSFERRED TO OTHER DOCUMENTS OR DISCLOSED TO OTHERS OR USED FOR ANY PURPOSE OTHER THAN THAT WHICH IT WAS OBTAINED WITHOUT THE EXPRESSED WRITTEN CONSENT OF SAMTEC, INC.</p> <p>DO NOT SCALE DRAWING</p> <p>SHEET SCALE: 2:1</p>			
	<p>520 PARK EAST BLVD, NEW ALBANY, IN 47150 PHONE: 812-944-6733 FAX: 812-948-5047 e-Mail: info@SAMTEC.com code: 55322</p>		
	<p>DESCRIPTION: .8mm DIFFERENTIAL PAIRS HS SOCKET ASSEMBLY</p>		
	<p>DWG. NO. QSE-XXX-XX-X-D-DP-XXX-XXXXX</p>		
	BY: DEAN P	5/05/2000	SHEET 3 OF 3