

DO NOT  
SCALE FROM  
THIS PRINT

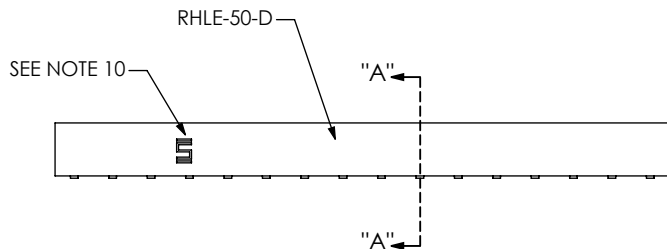
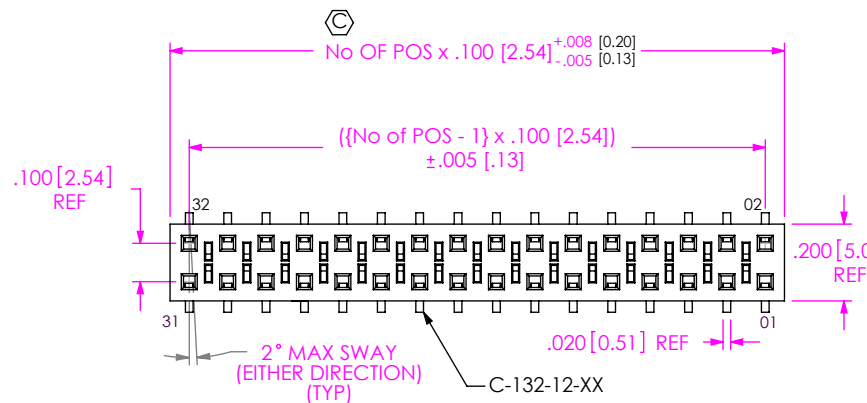
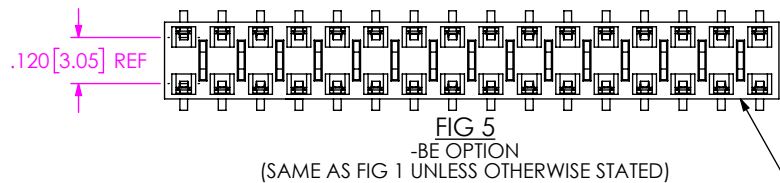
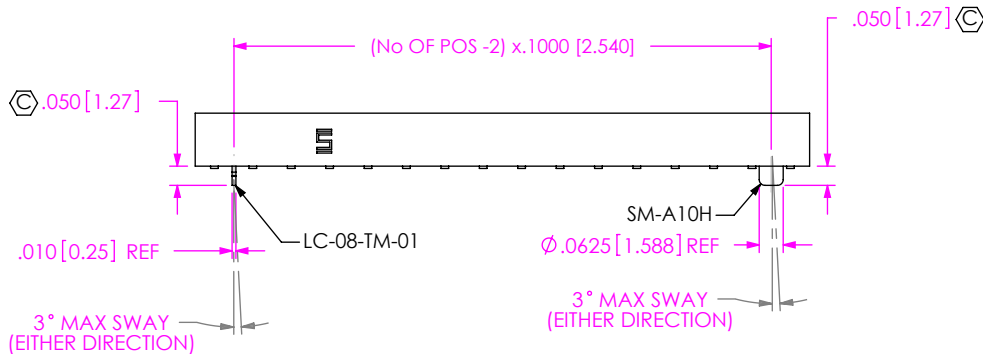

TABLE 2	
POSITION	COPLANARITY
-01 THRU -20	.004 [.10]
-21 THRU -50	.006 [.15]

FIG 2  
-A & -LC OPTION



# HLE-1XX-02-XXX-DV-XX-XX-X-XX

## No OF POSITIONS

-02 THRU -50  
(PER ROW)

## LEAD STYLE

-02: SURFACE MOUNT  
(USE C-132-12-X)

## PLATING SPECIFICATION

- G: 20µ" GOLD IN CONTACT AREA  
3µ" ON TAIL (USE C-132-12-G)
- S: 30µ" SELECTIVE GOLD IN CONTACT  
AREA MATTE TIN ON TAIL  
(USE C-132-12-S)
- F: 3µ" SELECTIVE FLASH GOLD IN CONTACT  
AREA MATTE TIN ON TAIL  
(USE C-132-12-F)
- L: 10µ" SELECTIVE LIGHT GOLD IN  
CONTACT AREA MATTE TIN ON TAIL  
(USE C-132-12-L)
- H: 30µ" HEAVY GOLD IN CONTACT AREA  
3µ" ON TAIL (USE C-132-12-H)
- STL: 30µ" SELECTIVE GOLD IN CONTACT  
AREA TIN/LEAD (90%/10 +/-5%)  
(USE C-132-12-STL)
- SM: 30µ" SELECTIVE GOLD IN CONTACT  
AREA MATTE TIN ON TAIL  
(USE C-132-12-S)
- FM: 3µ" SELECTIVE FLASH GOLD IN CONTACT  
AREA MATTE TIN ON TAIL (USE C-132-12-F)
- LM: 10µ" LIGHT GOLD IN CONTACT AREA  
MATTE TIN ON TAIL (USE C-132-12-L)

## PACKAGING

- BLANK: TUBES  
(SEE NOTES 14 & 15)
- TR: TAPE & REEL  
(2 - 29 POSITIONS ONLY)  
(SEE NOTE 15 & 16)
- FR: FULL REEL QTY  
TAPE & REEL  
(2-29 POSITIONS ONLY)  
(SEE NOTE 15 & 16)

## PICK & PLACE OPTION

- P: PICK & PLACE PAD  
(POS -03 THRU -50 ONLY)
- K: USE K-DOT-.256-.375-.005  
POLYIMIDE FILM PAD (AVAILABLE  
ON POS -03 THRU -50; .005 [0.13]  
THICKNESS)  
(SEE FIG 4)

## OPTION

- A: STAKED OR MOLDED ALIGNMENT PIN  
(4 POS MIN) (SEE NOTE 13)
- LC: LOCKING CLIP (2 POS MIN)  
(SEE NOTE 9)

## OPTION

- BE: BOTTOM ENTRY  
(USE RHLE-50-DBE) (SEE FIG 5)  
(LEAVE BLANK FOR STANDARD)

## ROW SPECIFICATION

- DV: DOUBLE VERTICAL  
(USE RHLE-50-D)

## NOTES:

1. ⌀ REPRESENTS A CRITICAL DIMENSION.
2. ALL IDENTIFICATION MARKS MUST NOT STAND GREATER THAN .002 [0.05]  
OFF THE SURFACE OF THE PART.
3. MINIMUM PULL OUT FORCE FOR -LC, -A, & CONTACT: 12 oz
4. COPLANARITY: SEE TABLE 2.
5. MAXIMUM BURR ALLOWANCE: .003 [0.08]
6. CUT ASSEMBLIES AFTER FILL.  
MAXIMUM CUT FLASH: .010 WITH NO FLASH ALLOWED IN HOLES OR EXTENDING BELOW LEADS.  
WILL LOSE A POSITION FOR EVERY CUT MADE ON A SOCKET STRIP.
7. NOTE DELETED.
8. ENDWALL THICKNESS: .030±.005 [0.76±0.13] TO BE MEASURED FROM BOTTOM VIEW.
9. DUE TO THE HIGH AMOUNT OF INSERTION FORCE NEEDED, THE -LC OPTION IS NOT COMPATIBLE WITH AUTO  
PLACEMENT. SAMTEC RECOMMENDS MANUAL PLACEMENT FOR ALL ASSEMBLIES WITH THE -LC OPTION.
10. SAMTEC LOGO MAY NOT BE PRESENT ON CUT TO POSITION CONNECTORS.
11. NOTE DELETED.
12. NOTE DELETED.
13. STAKED ALIGNMENT PIN USED AT SAMTEC'S DISCRETION.
14. TUBES ARE STANDARD PACKAGING FOR 03-50 POS. 02 POS IS LAYER PACKAGED.
15. ORDERS WILL BE PACKAGED ACCORDING TO THE SAMTEC PACKAGING EFFICIENCY STANDARDS  
(SPES) FOUND ON WWW.SAMTEC.COM
16. ATTACH LABEL TO EACH REEL.

UNLESS OTHERWISE SPECIFIED,  
DIMENSIONS ARE IN INCHES.

TOLERANCES ARE:

DECIMALS ANGLES  
.XX: ±.01 [.3]  
.XXX: ±.005 [.13]  
.XXXX: ±.0020 [.051]

## PROPRIETARY NOTE

THIS DOCUMENT CONTAINS CONFIDENTIAL AND  
PROPRIETARY INFORMATION AND ALL DESIGN,  
MANUFACTURING, REPRODUCTION, USE, PATENT RIGHTS  
AND SALES RIGHTS ARE EXPRESSLY RESERVED BY SAMTEC,  
INC. THIS DOCUMENT SHALL NOT BE DISCLOSED, IN WHOLE  
OR PART, TO ANY UNAUTHORIZED PERSON OR ENTITY NOR  
REPRODUCED, TRANSFERRED OR INCORPORATED IN ANY  
OTHER PROJECT IN ANY MANNER WITHOUT THE EXPRESS  
WRITTEN CONSENT OF SAMTEC, INC.

MATERIAL: DO NOT SCALE DRAWING SHEET SCALE: 2:1  
BODY: VECTRA E130i, UL94V-0  
CONTACT: BeCu

F:\DWG\MISC\MKTG\HLE-1XX-02-XXX-DV-XX-XX-X-XX-MKT.SLDDRW

**samtec**

520 PARK EAST BLVD, NEW ALBANY, IN 47150  
PHONE: 812-944-6733 FAX: 812-948-5047  
e-Mail: info@SAMTEC.com code: 55322

DESCRIPTION:  
[2.54] .100 TIGER BEAM SOCKET ASSEMBLY  
DWG. NO.  
**HLE-1XX-02-XXX-DV-XX-XX-X-XX**  
BY: ED MESSER 12/19/98 SHEET 1 OF 2

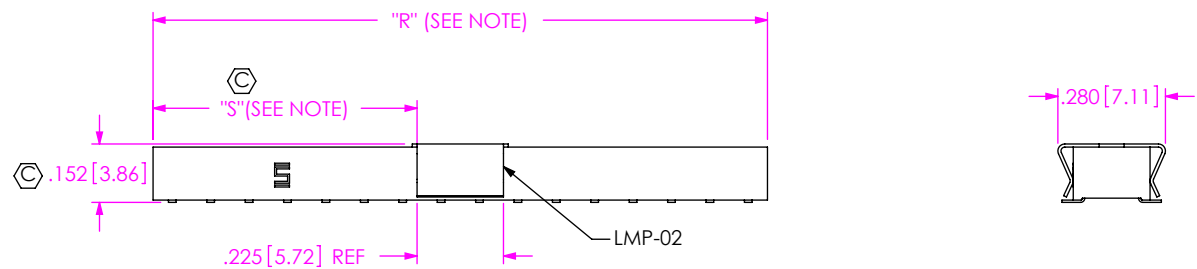

NOTE: "R" = USE MEASURED DIM (REF)  
"S" = {("R" - .225 [5.72])/2} ±.020 [0.51]

FIG 3  
(-P: PICK AND PLACE PAD)  
AVAILABLE ON POSITIONS 03 THRU 50

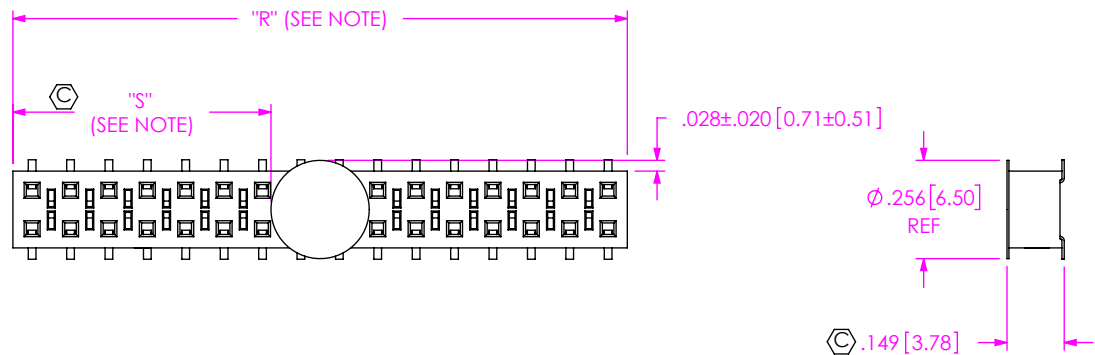

NOTE: "R" = USE MEASURED DIM (REF)  
"S" = {("R" - .2559 [6.500])/2} ±.020 [0.51]

FIG 4  
-K: POLYIMIDE FILM PAD  
AVAILABLE ON POS 03 THRU 50

F:\DWG\MISC\MKTG\HLE-1XX-02-XXX-DV-XX-XX-X-XX-MKT.SLDDRW

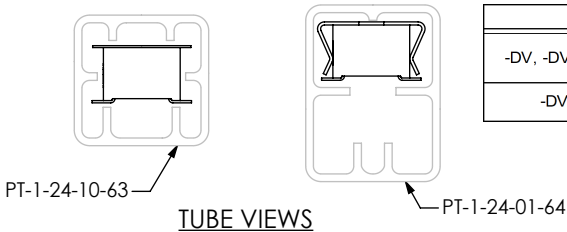

STYLE	PKG TUBE	PLUG
-DV, -DV-LC, -DV-A, -DV-A-P, -DV-P	PT-1-24-01-64	TP-09
-DV-K, -DV-A-K, -DV-LC-K	PT-1-24-10-63	TP-24

• PROPRIETARY NOTE  
THIS DOCUMENT CONTAINS CONFIDENTIAL AND PROPRIETARY INFORMATION AND ALL DESIGN, MANUFACTURING, REPRODUCTION, USE, PATENT RIGHTS AND SALES RIGHTS ARE EXPRESSLY RESERVED BY SAMTEC, INC. THIS DOCUMENT SHALL NOT BE DISCLOSED, IN WHOLE OR PART, TO ANY UNAUTHORIZED PERSON OR ENTITY NOR REPRODUCED, TRANSFERRED OR INCORPORATED IN ANY OTHER PROJECT IN ANY MANNER WITHOUT THE EXPRESS WRITTEN CONSENT OF SAMTEC, INC.

DO NOT SCALE DRAWING

SHEET SCALE: 2:1



520 PARK EAST BLVD, NEW ALBANY, IN 47150  
PHONE: 812-944-6733 FAX: 812-948-5047  
e-Mail: info@SAMTEC.com code: 55322

DESCRIPTION:  
.100 TIGER BEAM SOCKET ASSEMBLY

DWG. NO.  
HLE-1XX-02-XXX-DV-XX-XX-X-XX

BY: ED MESSER 12/19/98 SHEET 2 OF 2