

No OF POSITIONS  
-03, -04, -05, -08, -10,  
-13, -17, -20, -25  
LEAD STYLE  
-01

PLATING SPECIFICATION

-L: 10μ" SELECTIVE GOLD IN CONTACT AREA, MATTE TIN ON TAIL (USE T-1SXX-XX-L)  
-F: 3μ" SELECTIVE GOLD IN CONTACT AREA, MATTE TIN ON TAIL (USE T-1SXX-XX-F)  
-S: 30μ" SELECTIVE GOLD IN CONTACT AREA, MATTE TIN ON TAIL (USE T-1SXX-XX-S)  
-H: 30μ" GOLD IN CONTACT AREA, 3μ" GOLD ON TAIL (USE T-1SXX-XX-H)  
-LM: 10μ" SELECTIVE GOLD IN CONTACT AREA, MATTE TIN ON TAIL (USE T-1SXX-XX-L)  
-SM: 30μ" SELECTIVE GOLD IN CONTACT AREA, MATTE TIN ON TAIL (USE T-1SXX-XX-S)  
-FM: 3μ" SELECTIVE GOLD IN CONTACT AREA, MATTE TIN ON TAIL (USE T-1SXX-XX-F)

PACKAGING (SEE NOTES 9 & 10)

BLANK: TUBES (SEE NOTE 8)  
-TR: TAPE & REEL PACKAGING (FOR -D-SM, -D-SM-P, & -D-SM-K ONLY) (NOT AVAILABLE ON -D-SM-LC)  
-FR: FULL REEL QTY TAPE & REEL

PAD

-P: PICK & PLACE PAD (FOR -D-SM ONLY) (FOR -03 & -04, USE PPP-25, SEE FIG 7, SHT 3) (FOR -05 THRU -25, USE PPP-48, SEE FIG 2)  
-K: POLYIMIDE FILM (SEE FIG 3)

OPTION

-LC: LOCKING CLIP (FOR -D-SM ONLY) (SEE NOTE 7)

POLARIZED OPTION

-XX = PIN OMITTED (N/A ON -RA OPTION)

TAIL OPTION

(LEAVE BLANK FOR THROUGH HOLE, SEE FIG 4, SHEET 2, USE T-1S63-01-XX)  
-SM: SURFACE MOUNT (USE T-1S15-02-XX)  
-RA: RIGHT ANGLE (USE T-1S63-02-XX AND T-1S63-03-XX) (SEE FIG 5, SHEET 2)

ROW SPECIFICATION

-D: DOUBLE

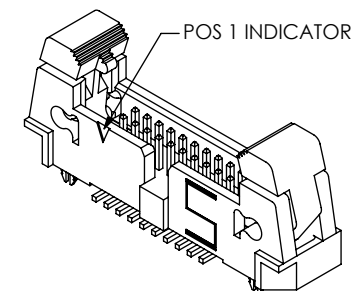
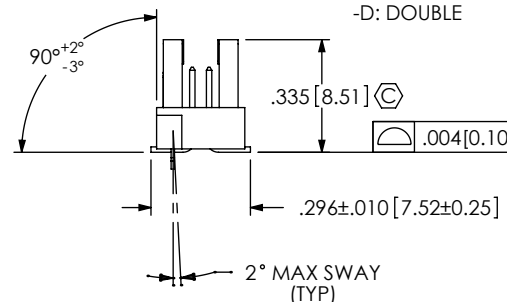

NOTES:

1. REPRESENTS A CRITICAL DIMENSION.
2. COPLANARITY TO BE WITHIN .004 [0.10].
3. MAXIMUM BURR ALLOWANCE: .0015 [0.038].
4. MINIMUM PUSHOUT FORCE: 1 LB.
5. MAXIMUM ALLOWABLE BOW: .002 [0.05] INCH/INCH AFTER ASSEMBLY.
6. NOTE DELETED.
7. DUE TO THE HIGH AMOUNT OF INSERTION FORCE NEEDED, THE -LC OPTION IS NOT COMPATIBLE WITH AUTO PLACEMENT. SAMTEC RECOMMENDS MANUAL PLACEMENT FOR ALL ASSEMBLIES WITH THE -LC OPTION.
8. TUBES ARE STANDARD PACKAGING
9. TR/FR OPTION ORDERS INVOLVING REELS AS WELL AS SOME TRAY PACKAGED ORDERS WILL BE PACKAGED ACCORDING TO THE SAMTEC PACKAGING EFFICIENCY STANDARDS (SPES) FOUND ON WWW.SAMTEC.COM
10. ATTACH LABEL TO EACH REEL

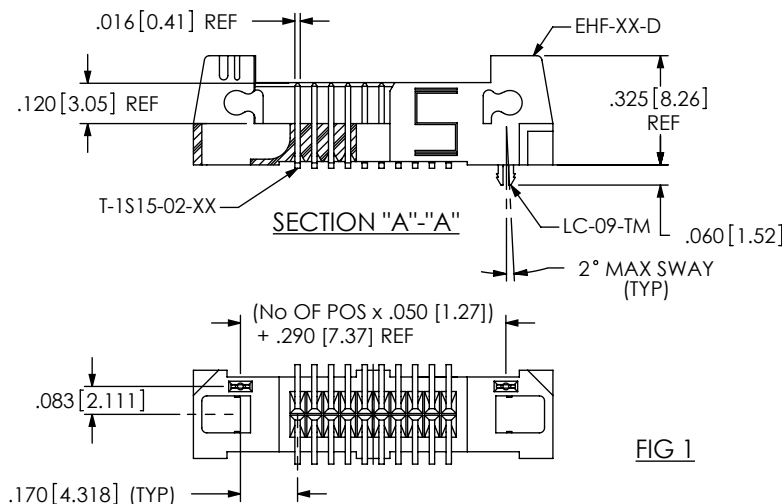
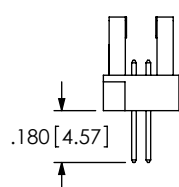

FIG 1

EHF-110-01-XX-D-SM-LC

-SM IN-PROCESS 1  
(SCALE: 1.5:1)



-SM IN-PROCESS 2  
(SCALE: 1.5:1)

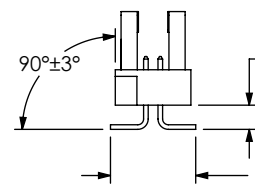

{(No OF POS X .050 [1.27] + .370 [9.40]) / 2} ± .020 [0.51]

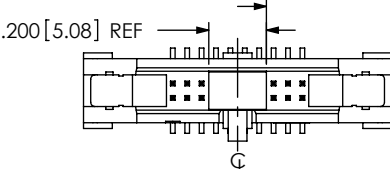
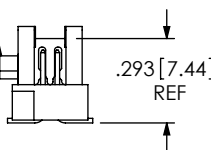

FIG 2  
-P: PICK AND PLACE PAD  
(SCALE 1.5:1)

PPP-48



UNLESS OTHERWISE SPECIFIED, DIMENSIONS ARE IN INCHES.

TOLERANCES ARE:

DECIMALS

ANGLES

.XX: ±.01 [0.3]

.XXX: ±.005 [0.13]

.XXXX: ±.0020 [0.051]

2°

PROPRIETARY NOTE

THIS DOCUMENT CONTAINS CONFIDENTIAL AND PROPRIETARY INFORMATION AND ALL DESIGN, MANUFACTURING, REPRODUCTION, USE, PATENT RIGHTS AND SALES RIGHTS ARE EXPRESSLY RESERVED BY SAMTEC, INC. THIS DOCUMENT SHALL NOT BE DISCLOSED, IN WHOLE OR PART, TO ANY UNAUTHORIZED PERSON OR ENTITY NOR REPRODUCED, TRANSFERRED OR INCORPORATED IN ANY OTHER PROJECT IN ANY MANNER WITHOUT THE EXPRESS WRITTEN CONSENT OF SAMTEC, INC.

MATERIAL:

DO NOT SCALE DRAWING  
INSULATOR: VECTRA E130i, COLOR BLACK  
50% REGRIND  
TERMINAL: PHOS BRONZE 510 SPRING

SHEET SCALE: 1.75:1

DESCRIPTION:

**samtec**

520 PARK EAST BLVD, NEW ALBANY, IN 47150  
PHONE: 812-944-6733 FAX: 812-948-5047  
e-Mail: info@SAMTEC.com code: 55322

.050 EJECTOR HEADER ASSEMBLY

DWG. NO.

EHF-1XX-01-XX-D-XX-XX-XX-X-XX

BY: ERIC M. 08/17/01

SHEET 1 OF 3

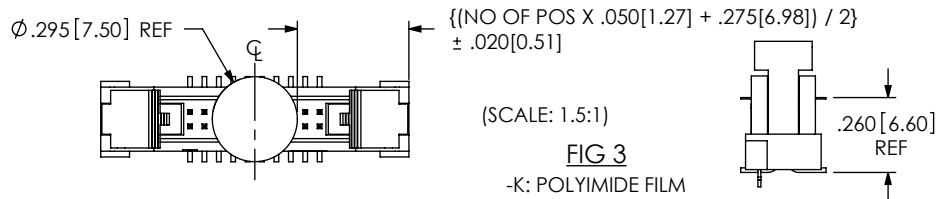

TABLE 1	
No OF POS	-K PART NUMBER
-01 THRU -07	K-500-300
-08 THRU-25	K-DOT-.295-.406-.005

FIG 4  
STANDARD THROUGH HOLE  
(SHOWN: EHF-110-01-XX-D)  
(SAME AS FIG 1, UNLESS OTHERWISE STATED)

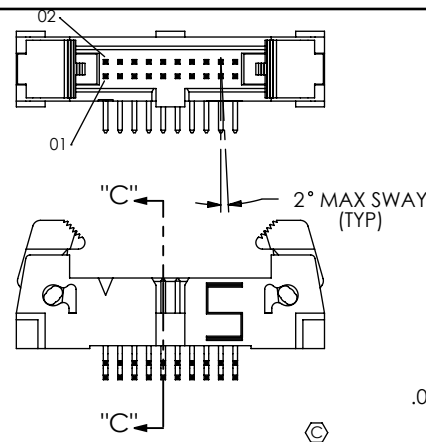
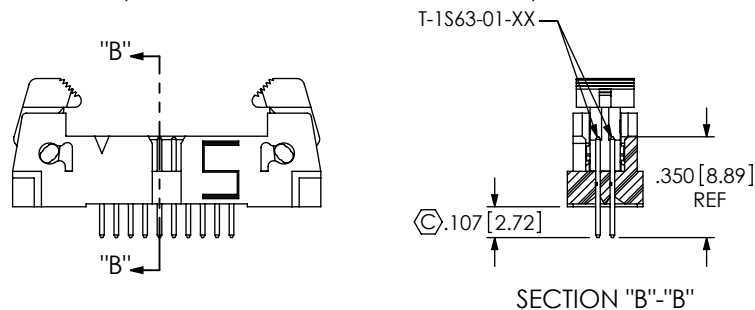
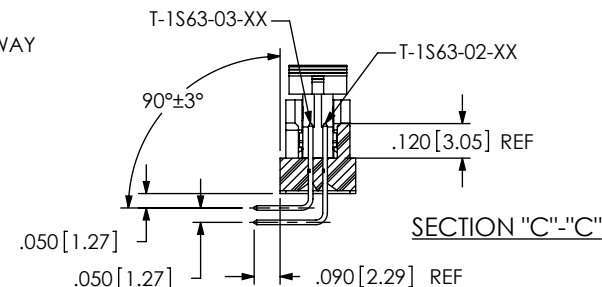

FIG 5  
-RA: RIGHT ANGLE OPTION  
(SHOWN: EHF-110-01-XX-D-RA)  
(SAME AS FIG 1, UNLESS OTHERWISE STATED)



### PACKAGING VIEWS

(LOAD PARTS WITH POSITION #1 INDICATOR  
IN SAME DIRECTION AS ARROW ON TUBE)

TAIL OPTION	OPTION	PACKAGING TUBE	PLUG
THROUGH HOLE	N/A	PT-1-24-05-09	TP-07
-SM	NONE, -LC, -K, -LC-K	PT-1-24-16-29	
-SM	-P, -LC-P	PT-1-24-01-51	TP-13
-RA	N/A	PT-1-24-01-52	

NOTE: ARROW POINTS INTO THE SHEET AWAY FROM YOU.

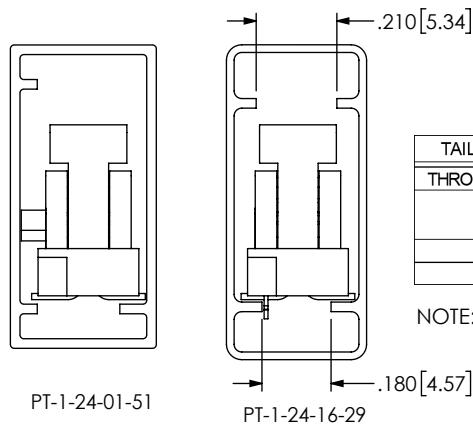

EJECTOR ARM MUST BE IN UPRIGHT  
POSITION WHEN LOADED INTO TUBES

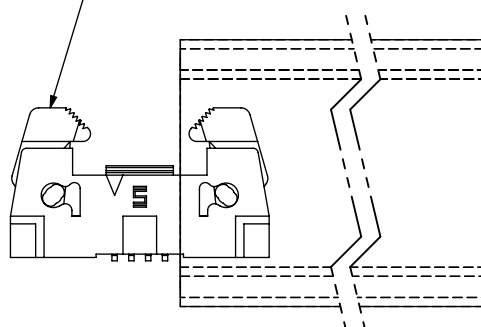

### -RA IN-PROCESS 1

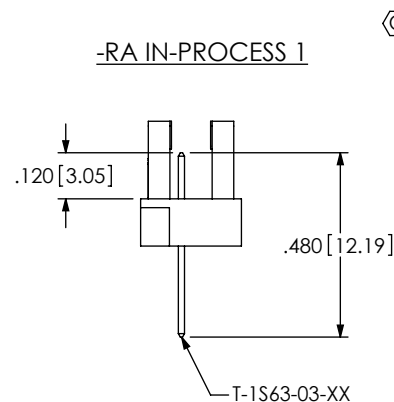

### -RA IN-PROCESS 2

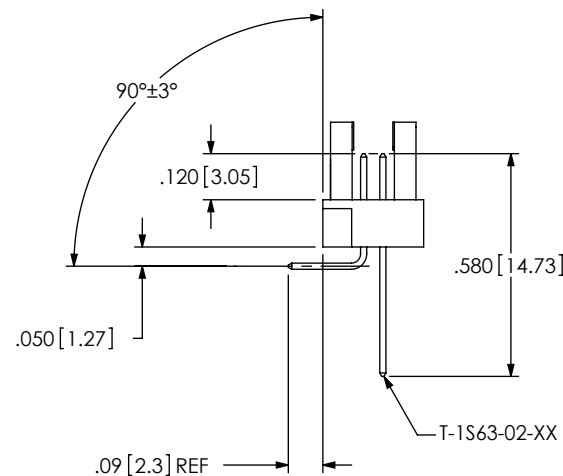

c:\enterprisevault\DWG\MISC\MKTG\EHF-1XX-01-XX-D-XX-XX-XX-MKT.SLDDRW

**PROPRIETARY NOTE**  
THIS DOCUMENT CONTAINS CONFIDENTIAL AND  
PROPRIETARY INFORMATION AND ALL DESIGN,  
MANUFACTURING, REPRODUCTION, USE, PATENT RIGHTS  
AND SALES RIGHTS ARE EXPRESSLY RESERVED BY SAMTEC,  
INC. THIS DOCUMENT SHALL NOT BE DISCLOSED, IN WHOLE  
OR PART, TO ANY UNAUTHORIZED PERSON OR ENTITY NOR  
REPRODUCED, TRANSFERRED OR INCORPORATED IN ANY  
OTHER PROJECT IN ANY MANNER WITHOUT THE EXPRESS  
WRITTEN CONSENT OF SAMTEC, INC.

DO NOT SCALE DRAWING

SHEET SCALE: 2:1

**samtec**

520 PARK EAST BLVD, NEW ALBANY, IN 47150  
PHONE: 812-944-6733 FAX: 812-948-5047  
e-Mail: info@SAMTEC.com code: 55322

DESCRIPTION:  
.050 EJECTOR HEADER ASSEMBLY

DWG. NO.  
EHF-1XX-01-XX-D-XX-XX-XX-X-XX

BY: ERIC M. 08/17/01 SHEET 2 OF 3

FIG 6

-SM: SURFACE MOUNT OPTION  
(SHOWN: EHF-110-01-XX-D-SM-LC)  
(SHOWN WITH LATCHES OPEN)

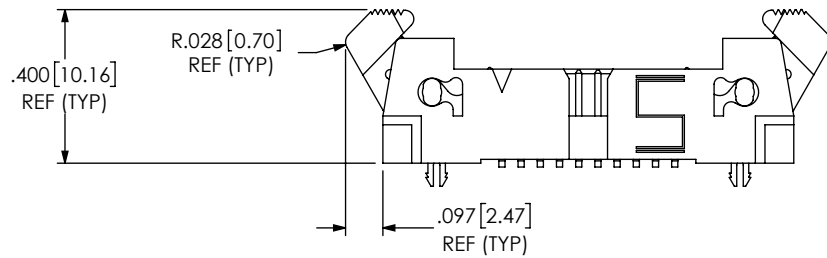
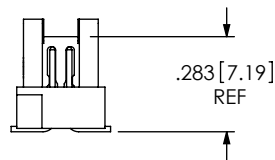
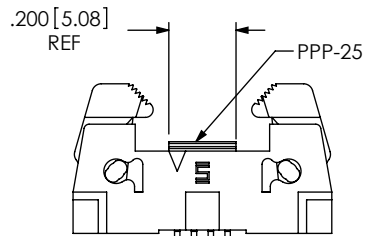

FIG 7

-03 & -04 PICK AND PLACE PAD  
(SHOWN: EHF-104-01-XX-D-SM-XX-P)



LATCHES OMITTED FOR CLARITY

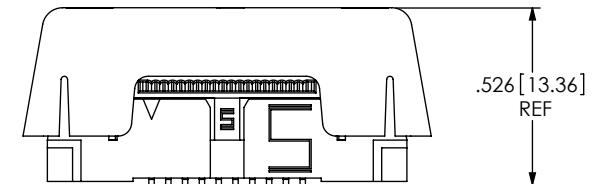
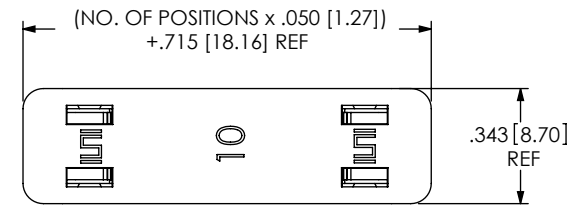

FIG 8

APPLICATION VIEW  
EHF MATED WITH FFSD AND ECF

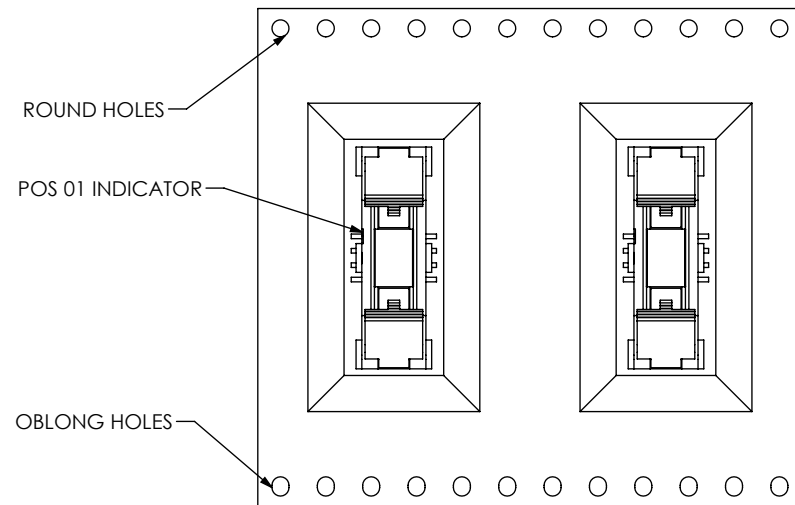
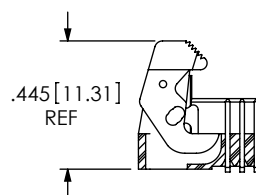
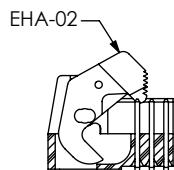
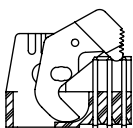
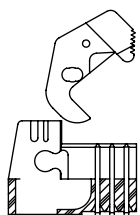

FIG 9  
-TR: TAPE & REEL

ARM ASSEMBLY & ROTATION



c:\enterprisevault\DWG\MISC\MKTG\EHF-1XX-01-XX-D-XX-XX-XX-X-XX-MKT.SLDDRW

**PROPRIETARY NOTE**  
THIS DOCUMENT CONTAINS CONFIDENTIAL AND PROPRIETARY INFORMATION AND ALL DESIGN, MANUFACTURING, REPRODUCTION, USE, PATENT RIGHTS AND SALES RIGHTS ARE EXPRESSLY RESERVED BY SAMTEC, INC. THIS DOCUMENT SHALL NOT BE DISCLOSED, IN WHOLE OR PART, TO ANY UNAUTHORIZED PERSON OR ENTITY NOR REPRODUCED, TRANSFERRED OR INCORPORATED IN ANY OTHER PROJECT IN ANY MANNER WITHOUT THE EXPRESS WRITTEN CONSENT OF SAMTEC, INC.

DO NOT SCALE DRAWING

SHEET SCALE: 2:1

**samtec**

520 PARK EAST BLVD, NEW ALBANY, IN 47150  
PHONE: 812-944-6733 FAX: 812-948-5047  
e-Mail: info@SAMTEC.com code: 55322

DESCRIPTION:  
.050 EJECTOR HEADER ASSEMBLY

DWG. NO.  
EHF-1XX-01-XX-D-XX-XX-XX-X-XX

BY: ERIC M. 08/17/01 SHEET 3 OF 3