

DO NOT SCALE FROM THIS PRINT

TABLE 1					
STYLE	"A"	"B"	BODY	TERMINAL	MATED HEIGHT WITH BSE
-01	.1600[4.064] REF	.1680[4.267]	BTE-XXX-01-D	T-1S39-01-X	.1980[5.029] REF
-02	.2781[7.064] REF	.2861[7.267]	BTE-XXX-02-D	T-1S59-02-X	.3161[8.029] REF
-03	.3962[10.063] REF	.4042[10.267]	BTE-XXX-03-D	T-1S39-03-X	.4342[11.029] REF

BTE-XXX-XX-X-D-XX

No OF POSITIONS  
 -020, -040, -060,  
 [-080, \*-090, -100, -120]  
 (PER ROW)  
 \*-03, -04 & -08 BODY STYLE ONLY

OPTION

- A: ALIGNMENT PINS  
(USE BTE-XXX-XX-D-A)
- LC: LOCKING CLIPS(SEE NOTE 13)  
(USE LC-08-TM-01)
- K: POLYIMIDE FILM  
(N/A ON STYLES -07 & -08)  
(USE K-DOT-.276-.375-.005, SEE FIG 2)
- TR: TAPE & REEL (80 POS MAX)  
[N/A ON STYLE -05, -06, -07 & -08]
- FL: FRICTION LOCK (SEE FIG 4, SHEET 3)  
(USE BTE-XXX-01-D-X-FL)  
(AVAIL ON LEAD STYLE -01 ONLY,  
-020 THRU -100 POSITIONS ONLY)

BODY STYLE  
 -01: .1680[4.267]  
 -02: .2861[7.264]  
 -03: .4042[10.266]  
 -04: .6010[15.265]  
 -05: .7190[18.263]  
 -06: .8370[21.260]  
 -07: .9542[24.237]  
 -08: 1.1511[29.238]  
 -09: .5224 [13.269]

ROW SPECIFICATION

- D: DOUBLE (USE BTE-XXX-XX-D-X & BTEH-XXX-XX-D-X)

PLATING SPECIFICATION

- F: 3μ" SELECTIVE GOLD IN CONTACT AREA, WITH MATTE TIN TAILS  
(USE T-1SXX-XX-F) (SEE NOTE 10)
- L: 10μ" SELECTIVE GOLD IN CONTACT AREA, MATTE TIN TAILS  
(USE T-1SXX-XX-L) (SEE NOTE 10)
- H: 30μ" GOLD IN CONTACT AREA, 3μ" GOLD ON TAIL (USE T-1SXX-XX-H)
- C: 50μ" GOLD IN CONTACT AREA, 3μ" GOLD ON TAIL (USE T-1SXX-XX-C)

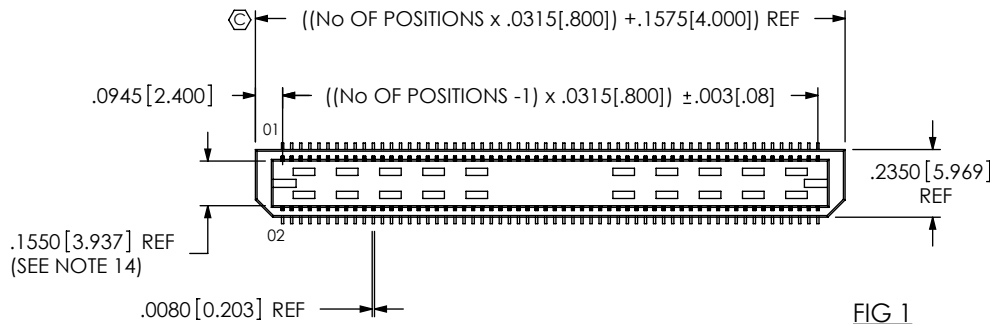
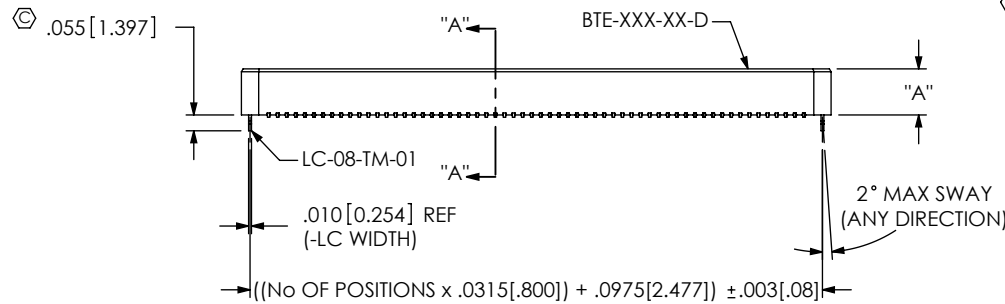
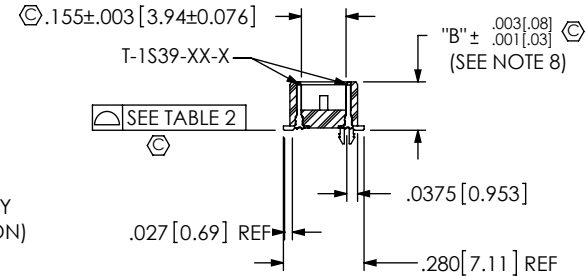

FIG 1  
 BTE-060-01-X-D-LC SHOWN



-LC: LOCKING CLIP OPTION



SECTION "A"-"A"

BTE-XXX-XX-D-A

-A: ALIGNMENT PIN OPTION

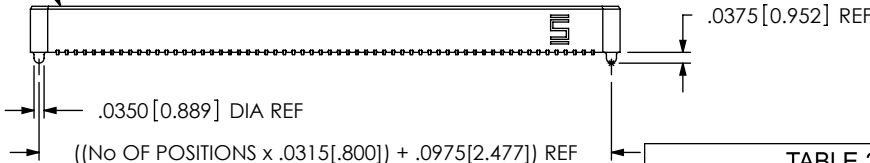
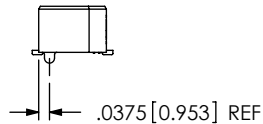

TABLE 2	
POSITIONS	COPLANARITY
-20 THRU -60	.004[.10]
-80 THRU -120	.006[.15]

NOTES:

1. Ⓢ REPRESENTS A CRITICAL DIMENSION.
2. NOTE DELETED.
3. BURR ALLOWANCE: .0015[.038] MAX.
4. NOTE DELETED.
5. MINIMUM PUSHOUT FORCE: 6 OZ.
6. NOTE DELETED.
7. PARTS TO BE MOLD TO POSITION.
8. MAX VARIANCE OF .002[.05].
9. BTE-XXX-03-D BODY CAN BE SUBSTITUTED FOR BTE-XXX-03-D-A.
10. -L PLATING CAN BE SUBSTITUTED FOR -F PLATING.
11. NOTE DELETED.
12. NOTE DELETED.
13. DUE TO THE HIGH AMOUNT OF INSERTION FORCE NEEDED, THE -LC OPTION IS NOT COMPATIBLE WITH AUTO PLACEMENT. SAMTEC RECOMMENDS MANUAL PLACEMENT FOR ALL ASSEMBLIES WITH THE -LC OPTION."
14. PIN CAN EXTEND PAST WALL .003 [.08] MAX.

UNLESS OTHERWISE SPECIFIED, DIMENSIONS ARE IN INCHES. TOLERANCES ARE:  
 DECIMALS ANGLES  
 .XX: ±.01 [.3] 2°  
 .XXX: ±.005 [.13]  
 .XXXX: ±.0020 [.051]

PROPRIETARY NOTE

THIS DOCUMENT CONTAINS INFORMATION CONFIDENTIAL AND PROPRIETARY TO SAMTEC, INC. AND SHALL NOT BE REPRODUCED OR TRANSFERRED TO OTHER DOCUMENTS OR DISCLOSED TO OTHERS OR USED FOR ANY PURPOSE OTHER THAN THAT WHICH IT WAS OBTAINED WITHOUT THE EXPRESSED WRITTEN CONSENT OF SAMTEC, INC.



520 PARK EAST BLVD. NEW ALBANY, IN 47150  
 PHONE: 812-944-6733 FAX: 812-948-5047  
 e-Mail: info@SAMTEC.com code 55322

MATERIAL: DO NOT SCALE DRAWING SHEET SCALE: 1.5:1  
 INSULATOR: LCP, COLOR: BLACK, FLAMMABILITY RATING: UL94VO  
 TERMINAL: PHOS BRONZE

DESCRIPTION: .8mm DOUBLE ROW TERMINAL ASSEMBLY  
 DWG. NO. BTE-XXX-XX-X-D-XX

FIG 2  
-K: POLYIMIDE FILM PAD

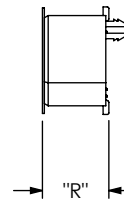
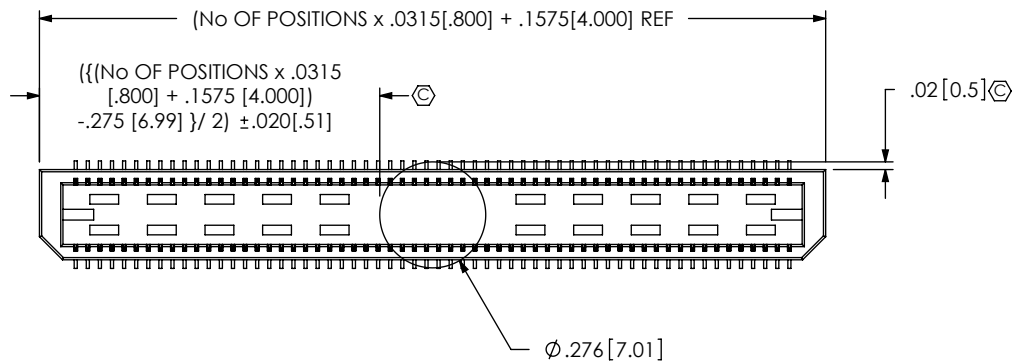

STYLE	"R"
-01	.173 4.39
-02	.291 7.39
-03	.409 10.39
-04	.606 15.39
-05	.724 18.39
-06	.842 21.39
-09	.527 13.40

PACKAGING VIEW

[PARTS NEED TO BE LOADED PER PACKAGING VIEWS]  
[-05 LEADSTYLE PARTS WITH KAPTON TO BE LOADED WITH KAPTON RESTING ON THE TUBE RIBS].



TUBE: PT-1-24-01-78  
PLUG: TP-07

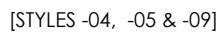

TUBE: PT-1-24-01-98  
PLUG: TP-26



TUBE: PT-1-24-01-105  
PLUG: TP-26



TUBE: PT-1-24-02-104  
PLUG: TP-26



TUBE: PT-1-24-01-104  
PLUG: TP-26

STYLE	PACKAGING TUBE	PLUG
-01	PT-1-24-01-78	TP-07
-02		
-03		
-04	PT-1-24-01-98	TP-26
-05		
-06	PT-1-24-01-105	
-07	PT-1-24-02-104	
-08	PT-1-24-01-104	
-09	PT-1-24-01-98	TP-26

C:\EnterpriseVault\DWG\MISC\MKTG\BTE-XXX-XX-X-D-XX-MKT.SLDDRW

PROPRIETARY NOTE

THIS DOCUMENT CONTAINS INFORMATION CONFIDENTIAL AND PROPRIETARY TO SAMTEC, INC. AND SHALL NOT BE REPRODUCED OR TRANSFERRED TO OTHER DOCUMENTS OR DISCLOSED TO OTHERS OR USED FOR ANY PURPOSE OTHER THAN THAT WHICH IT WAS OBTAINED WITHOUT THE EXPRESSED WRITTEN CONSENT OF SAMTEC, INC.

DO NOT SCALE DRAWING

SHEET SCALE: 2:1



520 PARK EAST BLVD, NEW ALBANY, IN 47150  
PHONE: 812-944-6733 FAX: 812-948-5047  
e-Mail info@SAMTEC.com code 55322

DESCRIPTION: .8mm DOUBLE ROW TERMINAL ASSEMBLY

DWG. NO. BTE-XXX-XX-X-D-XX

BY: DEAN P 03/22/1999 SHEET 2 OF 3

FIG 3

BTE-060-06-X-D-LC SHOWN  
[DIFFERENT AS SHOWN, OTHERWISE SAME AS FIG 1]

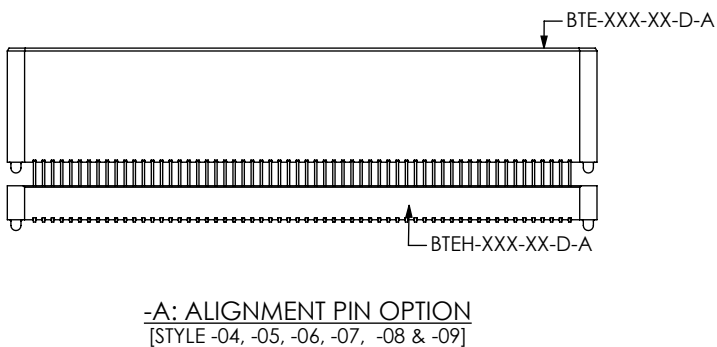
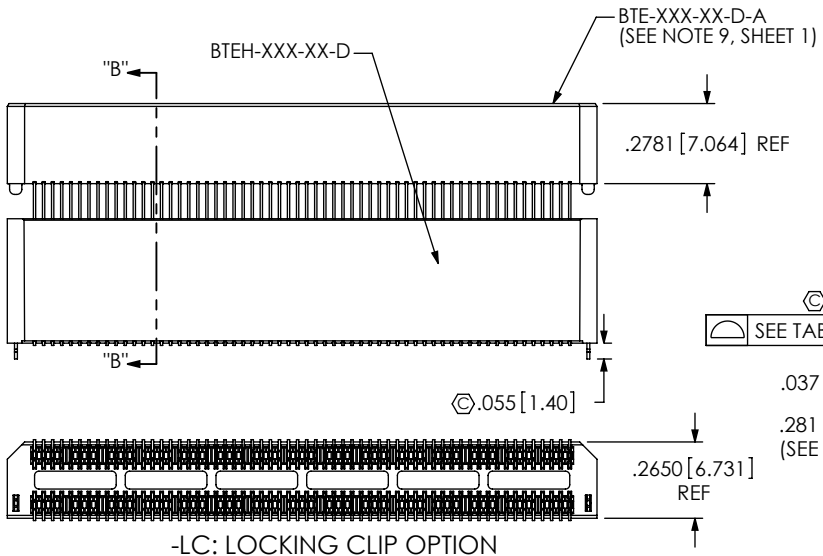
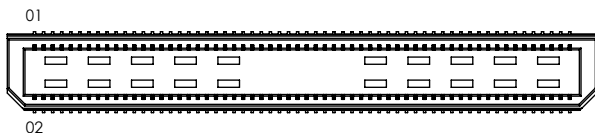
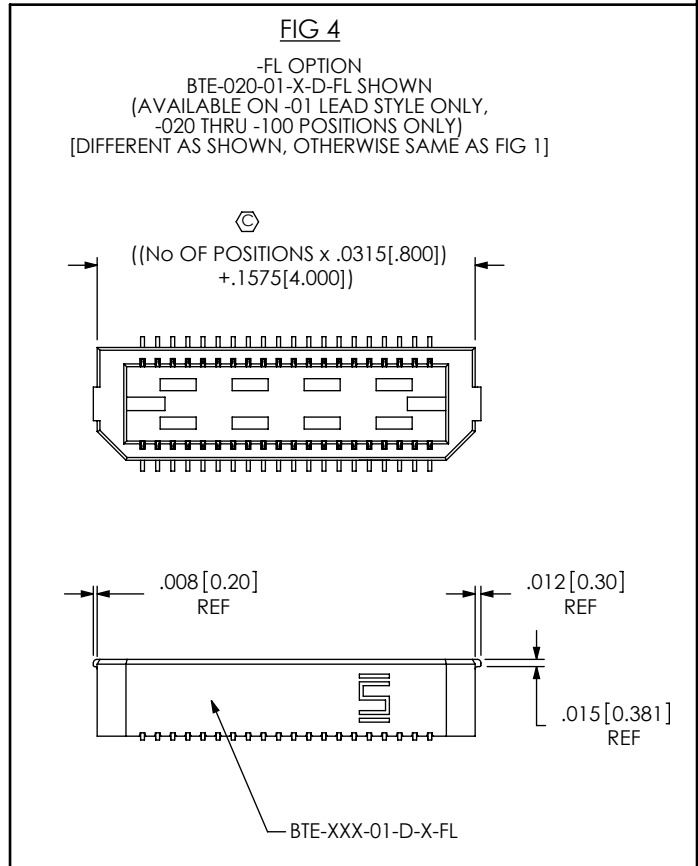
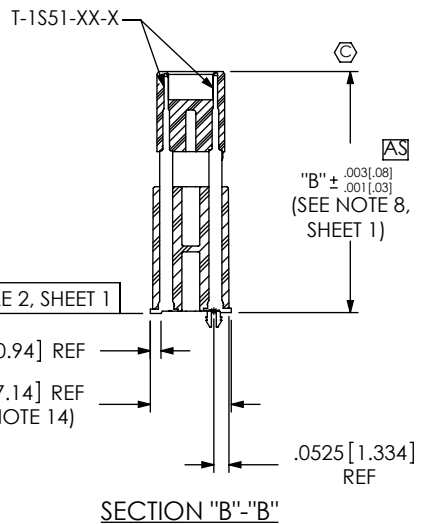

TABLE 4					
STYLE	"B"	TERMINAL	BOTTOM BODY	TOP BODY	MATED HEIGHT WITH BSE
-04	.6010 [15.265]	T-1S41-04-X	BTEH-XXX-01-D-X	BTE-XXX-03-D-A	.634 [16.10] REF
-05	.7190 [18.263]	T-1S41-05-X	BTEH-XXX-01-D-X	BTE-XXX-03-D-A	.752 [19.10] REF
-06	.8370 [21.260]	T-1S51-06-X	BTEH-XXX-03-D-X	BTE-XXX-02-D-A	.867 [22.02] REF
-07	.9542 [24.237]	T-1S61-21-F, T-1S61-21-L, T-1S61-21-H	BTEH-XXX-04-D-X	BTE-XXX-02-D-A	.9842 [25.00] REF
-08	1.1511 [29.238]	T-1S61-22-X	BTEH-XXX-04-D-X	BTE-XXX-02-D-A	1.1811 [30.00] REF
-09	.5224 [13.269]	T-1S60-09-X	BTEH-XXX-01-D-X	BTE-XXX-02-D-A	.551 [14.00] REF



**PROPRIETARY NOTE**  
THIS DOCUMENT CONTAINS INFORMATION CONFIDENTIAL AND PROPRIETARY TO SAMTEC, INC. AND SHALL NOT BE REPRODUCED OR TRANSFERRED TO OTHER DOCUMENTS OR DISCLOSED TO OTHERS OR USED FOR ANY PURPOSE OTHER THAN THAT WHICH IT WAS OBTAINED WITHOUT THE EXPRESSED WRITTEN CONSENT OF SAMTEC, INC.

DO NOT SCALE DRAWING  
SHEET SCALE: 1.5:1

**samtec**  
520 PARK EAST BLVD, NEW ALBANY, IN 47150  
PHONE: 812-944-6733 FAX: 812-948-5047  
e-Mail: info@SAMTEC.com code 55322

DESCRIPTION:  
.8mm DOUBLE ROW TERMINAL ASSEMBLY

DWG. NO.  
**BTE-XXX-XX-X-D-XX**

BY: DEAN P 03/22/1999 SHEET 3 OF 3