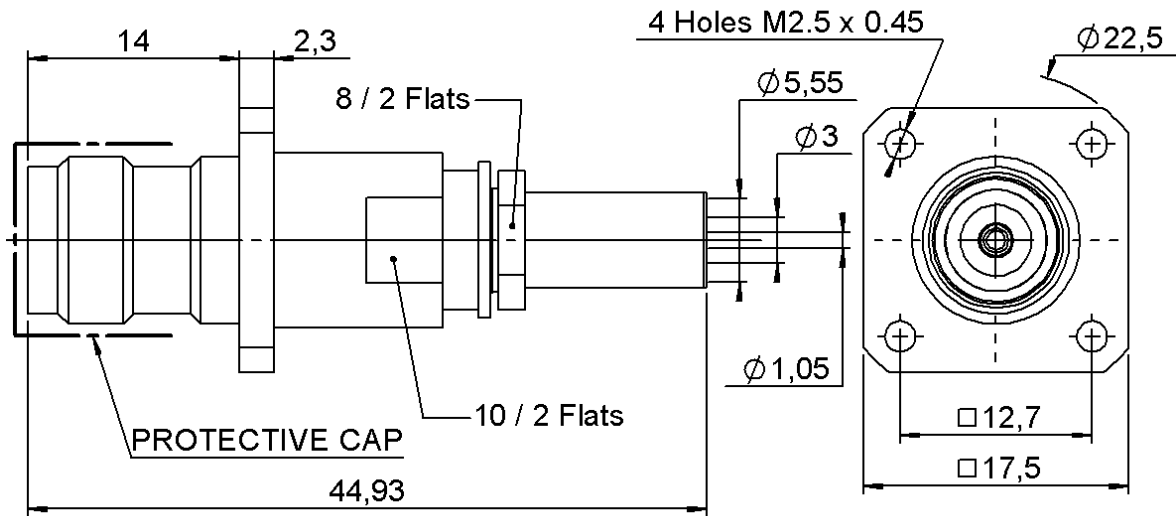
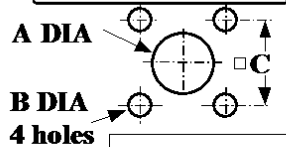

## SQUARE FLANGE RECEPTABLE

CAB 5/50D

**R143.297.700**

Series : TNC-P

**PANEL CUT OUT**

	mm	
	Maxi	mini
A	11.3	11.2
B	2.7	2.6
C	12.75	12.65

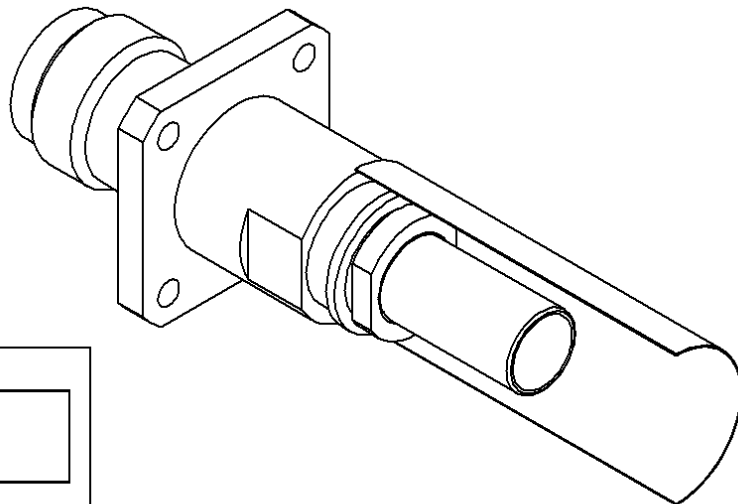
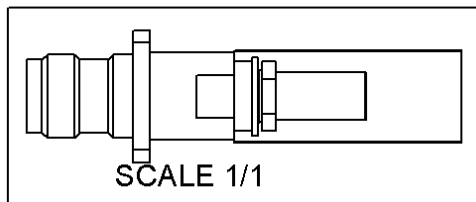

All dimensions are in mm.

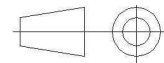

COMPONENTS	MATERIALS	PLATINGS (μm)
BODY	STAINLESS STEEL	PASSIVATED.
CENTER CONTACT	BERYLLIUM COPPER	GOLD 0.5 OVER NICKEL 2
OUTER CONTACT	-	-
INSULATOR	PTFE	-
GASKET	-	-
OTHERS PARTS	BRASS	NICKEL 2
-	-	-
-	-	-

Issue : 1406 C

In the effort to improve our products, we reserve the right to make changes judged to be necessary.



**SQUARE FLANGE RECEPTABLE****CAB 5/50D****R143.297.700**Series : **TNC-P****PACKAGING**

Standard	Unit	Other
<b>100</b>	<b>'W' option</b>	<b>Contact us</b>

**ELECTRICAL CHARACTERISTICS**

Impedance	<b>50</b>	$\Omega$
Frequency	<b>0-6 6</b>	GHz
VSWR	<b>1.3 + 0,0000</b>	x F(GHz) Maxi
Insertion loss	<b>0.2</b>	$\sqrt{F}(\text{GHz})$ dB Maxi
RF leakage	- ( - )	- F(GHz)) dB Maxi
Voltage rating	<b>500</b>	Veff Maxi
Dielectric withstanding voltage	<b>1500</b>	Veff mini
Insulation resistance	<b>5000</b>	M $\Omega$ mini

**MECHANICAL CHARACTERISTICS**

Center contact retention	
Axial force – Mating end	<b>NA</b> N mini
Axial force – Opposite end	<b>NA</b> N mini
Torque	<b>NA</b> N.cm mini

Recommended torque	
Mating	<b>NA</b> N.cm
Panel nut	<b>NA</b> N.cm
Clamp nut	<b>170</b> N.cm
A/F clamp nut	<b>8,0000</b> mm

Mating life	<b>500</b> Cycles mini
Weight	<b>19,8000</b> g

**ENVIRONMENTAL**

Operating temperature	<b>-65/+165</b> °C
Hermetic seal	<b>NA</b> Atm.cm3/s
Panel leakage	<b>NA</b>

**SPECIFICATION**

- ASN-E0461TC01

**CABLE ASSEMBLY**

Stripping	a	b	c	d	e	f
mm	9,00	9,00	23,0	0,00	0,00	0,00

Assembly instruction :

Recommended cable(s)

KX 23

RG 142 FTX

RG 142

RG 400

RG 223

Characteristics indicated on this data sheet are those that can be achieved with the highest performance cable. Intrinsic limitations of the cable may diminish the performance of the assembly

Cable retention

- pull off	<b>180</b> N mini
- torque	<b>NA</b> N.cm

**TOOLING**

Part Number	Description	Hexagon
.	.	.

**OTHERS CHARACTERISTICS**

-

Issue : **1406 C**

In the effort to improve our products, we reserve the right to make changes judged to be necessary.

**RADIALL**®

## SQUARE FLANGE RECEPTABLE

CAB 5/50D

**R143.297.700**

Series : TNC-P

## COMPONENTS

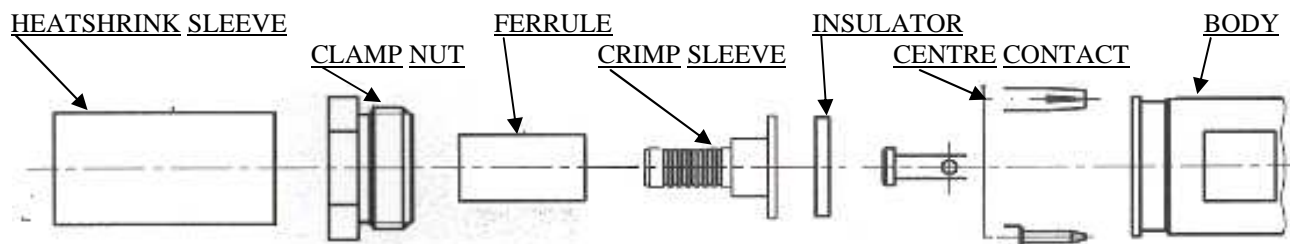

1

Slide onto the cable the heatshrink and the ferrule.  
Strip the cable.

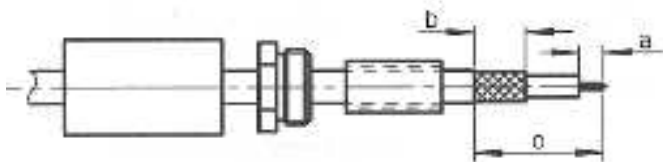

2

Slide the clamp nut onto the crimp sleeve.  
Slide sub-assembly under the braid.  
Slide ferrule over the braid against clamp nut. (In direction F)  
Crimp the ferrule with crimping tool + dies.

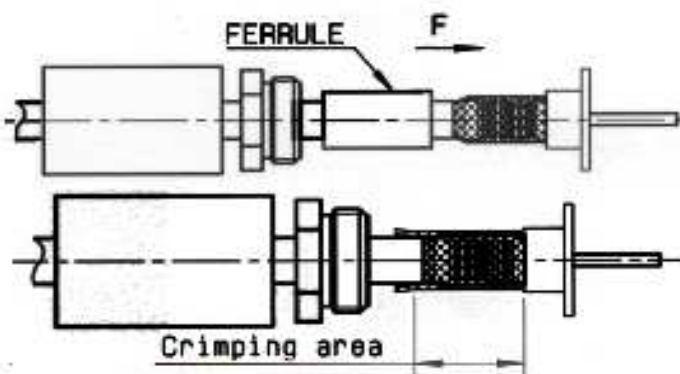

3

Cut the dielectric flush to crimp sleeve.  
Mount insulator against crimp sleeve.

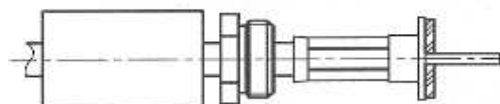

4

Slide the centre contact onto the cable inner conductor against insulator.  
Crimp centre contact with crimping tool and positioner.

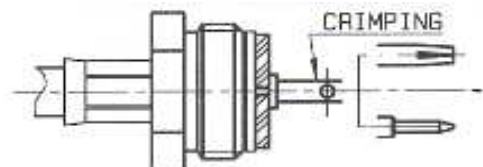

heatshrink sleeve not shown

5

Screw sub-assembly into the connector body.  
(recommended coupling see connector TDS)  
Slide sleeve over ferrule and Heatshrink sleeve in place.

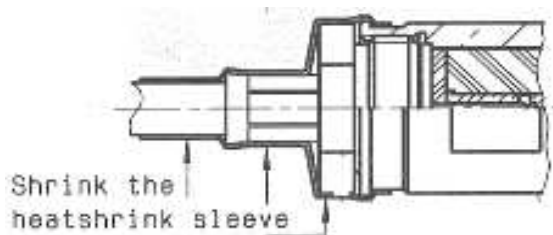

Issue : 1406 C

In the effort to improve our products, we reserve the right to make changes judged to be necessary.

**RADIALL**