



Series
EPXA

20 environmental insert
20 cavities for size 22 pin contacts

Issue:
Jul 9 2002

Page
1 / 1

Mating face

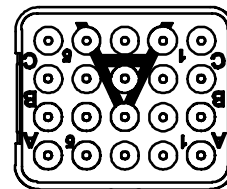
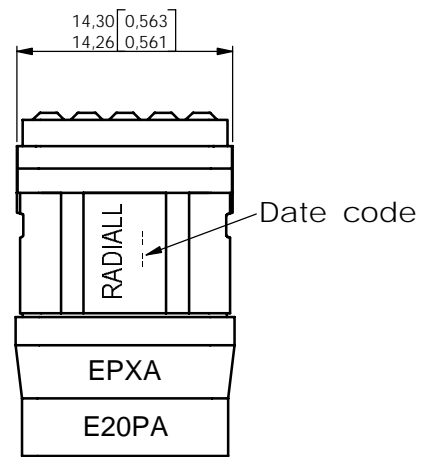
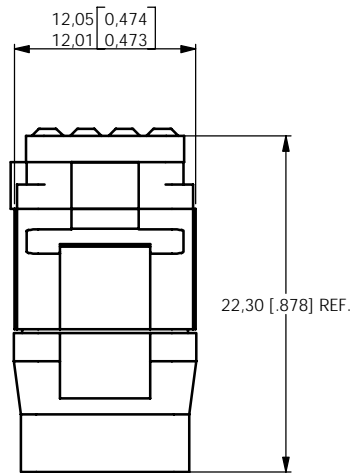
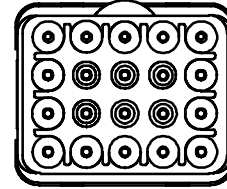

Materials :

- Insert : Thermosetting fiberglass filled per ASTM D 5948-96, with metallic retention clips per ASTM-B-194
- Rear grommet and interfacial seal : Fluorosilicone elastomer per MIL-R-25988 B except 4.6.6.1
- Temperature range : -65°C +175°C (-85°F +347°F)

DIMENSIONS : mm (inch) -

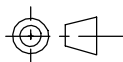

CREATION				
PEN:				
NOM: Marques				
DATE: Jul 9 2002				
APPR.: C. Lahoreau	Issue	Revisions	Name	Approved

RADIALL[®]

EPXAE20PAEN

This information is given as an indication in the continual goal to improve our products, we reserve the right to make any modifications judged necessary.

4112_9311