

RADIALL PROPRIETARY INTERFACE ADAPTERS

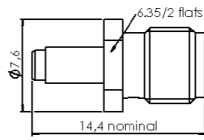

Part number	Interface
R191 366 091	MC-Card Female - SMA Female

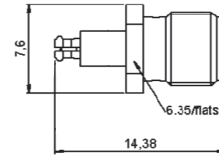

Part number	Interface
R191 366 071	MC-Card Male - SMA Female

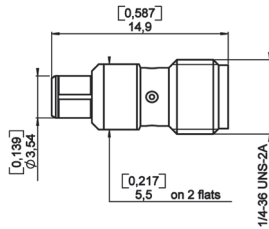

Part number	Interface
R191 857 000	Moebius Male - SMA Female

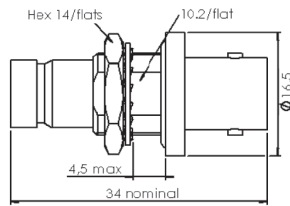

Part number	Interface	Panel drilling
R191 416 000	MQ Female - BNC Female	P06

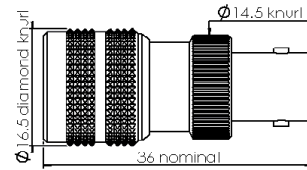

Part number	Interface
R191 413 000	MQ Male - BNC Female

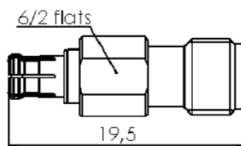

Part number	Interface
R191 976 020	R-MCX Female - SMA Female

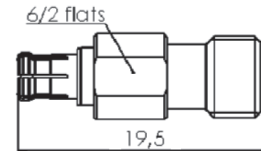

Part number	Interface
R191 977 020	R-MCX Female - SMA Male

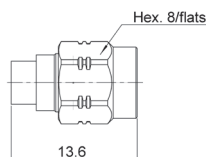

Part number	Interface
R191 984 008	R-MCX Male - SMA Male

# RADIALL PROPRIETARY INTERFACE ADAPTERS

ADAPTERS 50Ω

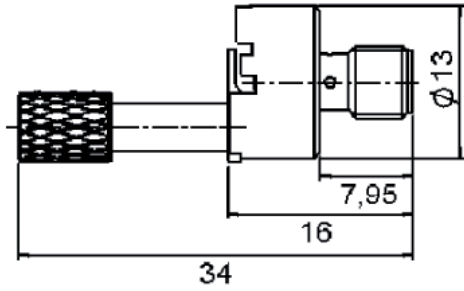

Part number	Interface
R107 009 901	UMP H2 - SMA Female

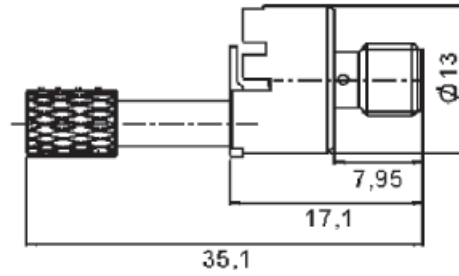

Part number	Interface
R107 009 902	UMP H2.6 - SMA Female

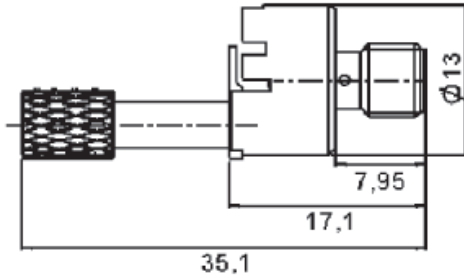

Part number	Interface
R107 009 903	UMP H3 - SMA Female

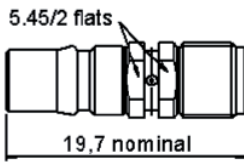

Part number	Interface
R191 913 000	QMA Female - SMA Female

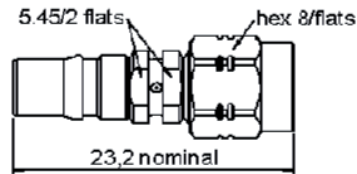

Part number	Interface
R191 912 000	QMA Female - SMA Male

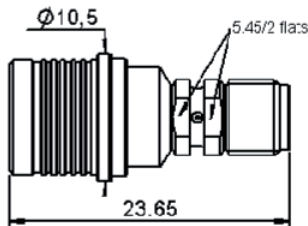

Part number	Interface
R191 911 000	QMA Female - SMA Female

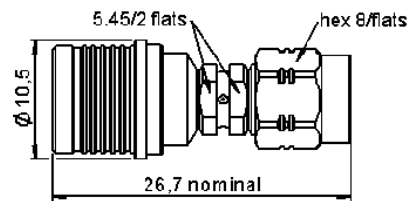

Part number	Interface
R191 910 000	QMA Male - SMA Male

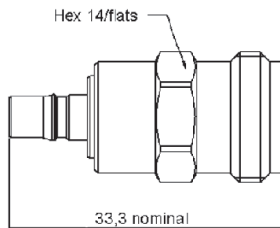

Part number	Interface
R191 764 000	QMA Female - N Female

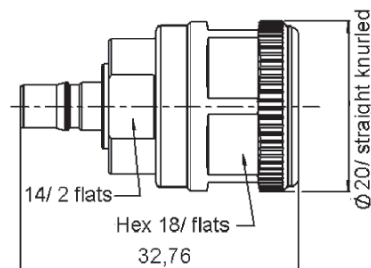

Part number	Interface
R191 762 000	QMA Female - N Male

To download data sheets and assembly instructions, visit [www.radiall.com](http://www.radiall.com) & enter the part number in the Search box.  
**Bold part numbers** represent products typically in stock & available for immediate shipment.  
 See page 8 and 9 for packaging information.

RADIALL PROPRIETARY INTERFACE ADAPTERS

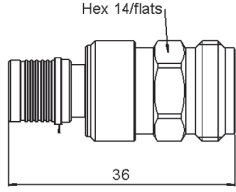

Part number	Interface
R191 763 000	QMA Male - N Female

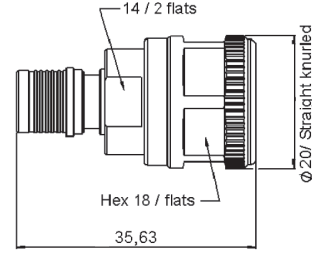

Part number	Interface
R191 765 000	QMA Male - N Male

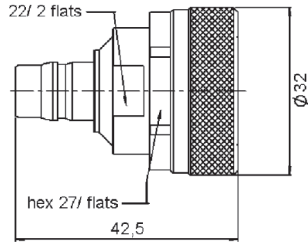

Part number	Interface
R191 923 000	QN Female - 7/16 Male

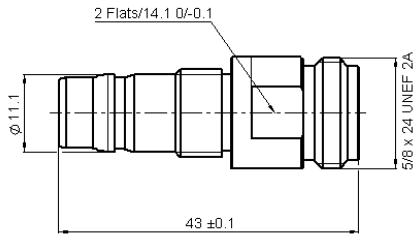

Part number	Interface
R191 760 010	QN Female - N Female

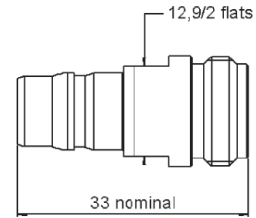

Part number	Interface
R191 760 000	QN Female - N Female

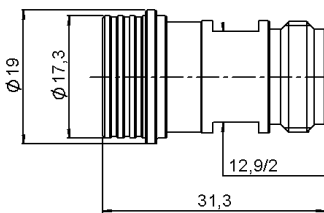

Part number	Interface
R191 759 000	QN Male - N Female

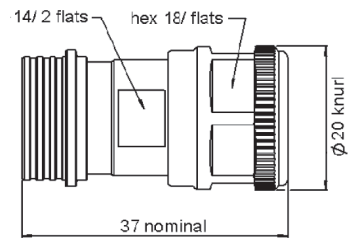

Part number	Interface
R191 757 000	QN Male - N Male

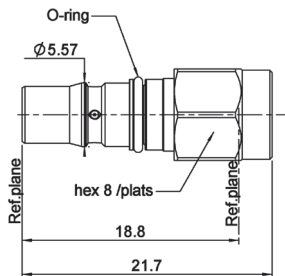

Part number	Interface
R191 927 L01	QRE Female - SMA Male

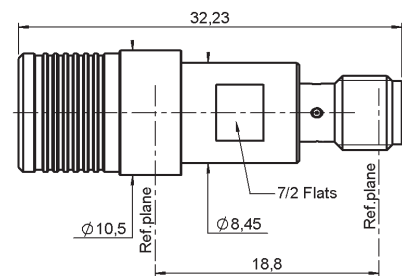

Part number	Interface
R191 926 L01	QRE Male - SMA Female