



ADAPTERS

R191/R192

Section 16 Table of Contents

BETWEEN SERIES 50Ω ADAPTERS

*Adapters for Radial Proprietary Interfaces: MC-CARD, Moebius, MQ (MiniQuick), R-MCX, QMA, QN and QRE Series
(Needed to Connect to your Analyzer)*

Finder Guide	16-4
Drawing	16-11 to 16-14

Adapters with High Frequency and Precision Connectors: N18 GHz, PC7, SMA 2.4, SMA 2.9, SMA 3.5 and TNC18 GHz Series

Finder Guide	16-5
Drawing	16-15 to 16-18

Adapters with all Standard Series: 1.0/2.3, 7/16, BMA, BNC, C, HN, MCX, MMBX, MMCX, N, SMA, SMB, SMC, SMP, SSMA, SSMC, TNC and UHF Series

Finder Guide	16-6 to 16-8
Drawing	16-20 to 16-35

Push-On Adapters: N, SMA and TNC Series (For Time Savings during Testing Activity)

Finder Guide	16-5
Drawing	16-18

BETWEEN SERIES 75Ω ADAPTERS

Adapters with Standard Series: 1.0/2.3, 1.6/5.6, BNC, MCX and N Series

Finder Guide	16-4
Drawing	16-11
Panel Drilling	16-36

IN SERIES 50Ω AND 75Ω ADAPTERS

Finder Guide	16-9 to 16-10
--------------------	---------------

Adapters

INTRODUCTION

Radiall offers an extended range of coaxial connectors and adapters. The following finder guides and drawings will help you to find the between series adapters that fit your needs. Adapters are categorized into one of the following families identified below.

FINDER GUIDE

75Ω ADAPTERS

1 ST INTERFACE		2 ND INTERFACE		PART NUMBER	PAGE
Series	Gender	Series	Gender		
BNC	F	N	F	R192 418 000	16-11
			M	R192 421 000	
	M		F	R192 419 000	
N	F	BNC	F	R192 418 000	
			M	R192 419 000	
			F	R192 421 000	

50Ω ADAPTERS FOR RADIAL PROPRIETARY INTERFACES

1 ST INTERFACE		2 ND INTERFACE		PART NUMBER	PAGE
Series	Gender	Series	Gender		
MC-Card	F	SMA	F	R191 366 091	16-11
	M			R191 366 071	
Moebius	M	SMA	F	R191 857 000	
R-MCX	F	SMA	F	R191 976 020	16-12
			M	R191 977 020	
			M	R191 984 008	
QLI	F	7/16	M	R191 663 000	
			F	R191 665 000	
		N	M	R191 793 000	
			M	R191 662 000	
			F	R191 664 000	
			M	R191 792 000	
QMA	M	SMA	F	R191 794 000	
			M	R191 764 000	
		N	M	R191 762 000	
			F	R191 913 000	
		SMA	M	R191 912 000	
			F	R191 763 000	
QN	F	7/16	M	R191 765 000	16-13
			M	R191 911 000	
		SMA	F	R191 910 000	
			M	R191 923 000	
		N	F	R191 760 010	
			M	R191 760 000	
QRE	M	SMA	F	R191 759 000	16-14
			M	R191 757 000	
		SMA 3.5	F	R191 927 L01	
			M	R191 946 700	
		SMA	F	R191 926 L01	
			M	R191 944 700	
MMS	M	SMA 3.5	F	R191 975 781	16-18
UMP H2	M	SMA	F	R107 009 901	
UMP H3	M	SMA	F	R107 009 903	

Adapters

50Ω ADAPTERS WITH HIGH FREQUENCY AND PRECISION CONNECTORS

1 ST INTERFACE		2 ND INTERFACE		PART NUMBER	PAGE		
Series	Gender	Series	Gender				
N18	F	SMA 3.5	F	R191 330 000	16-15		
			M	R191 333 000			
	M		F	R191 326 000			
			M	R191 328 000			
PC7	-	BNC	F	R191 015 000		16-16	
			M	R191 013 000			
		N	F	R191 027 000			
			M	R191 025 000			
		SMA	F	R191 011 000			
			M	R191 009 000			
		SMA3.5	F	R191 012 000			
			M	R191 010 000			
		SMB	F	R191 007 000			
			M	R191 003 000			
2.4 mm	F	SMA 2.9	F	R191 970 091	16-34		
			M	R191 970 071			
		SMPM	F	R191 565 000			
			M	R191 564 000			
	M	SMA 2.9	F	R191 970 081	16-6		
			M	R191 970 061			
		SMPM	F	R191 563 000	16-34		
			M	R191 562 000			
		SMA 2.9	F	SMA 2.4	F	R191 970 091	16-16
					M	R191 970 081	
SMP	F			R191 969 002			
	M			R191 968 001			
M	SMPM		F	R191 959 000	16-17		
			M	R191 958 000			
	SMA 2.4		F	R191 970 071		16-16	
			M	R191 970 061			
	SMP		F	R191 967 002			
			M	R191 966 001			
SMA 3.5	F	MMS	M	R191 975 781	16-15		
			F	R191 330 000			
		N18	F	R191 333 000			
			M	R191 328 000			
		PC7	-	R191 012 000		16-16	
			F	R191 946 700			
	M	QRE	M	R191 944 700	16-18		
			F	R191 944 700			
		TNC18	F	R191 316 700			
			F	R191 326 000			
TNC18	F	SMA	M	R191 324 000	16-15		
			-	R191 318 700			
	SMA 3.5	F	SMA	R191 314 730	16-33		
			SMA	R191 314 700			
				R191 316 700	16-18		

50Ω PUSH-ON ADAPTERS

1 ST INTERFACE		2 ND INTERFACE		PART NUMBER	PAGE
Series	Gender	Series	Gender		
MCX Push-On	F	SMA	M	R191 977 520	16-18
N Push-On	M	N	F	R161 791 500	
TNC Push-On	M	TNC		R143 713 000	
SMA Push-On	M	SMA		R125 792 501	
	F		R125 791 501		

Adapters

TEST PROBE ADAPTERS

1 ST INTERFACE		2 ND INTERFACE		PART NUMBER	PAGE
Series	Gender	Series	Gender		
SMA	F	MMBX	F	R191 389 800	16-19
		MML H2.5 & H2.0	F	R191 597 800	
		SMA	F	R191 300 800	
		SMB	M	R191 201 800	
		SMP	M	R191 844 800	
		SMP-MAX	F	R191 553 800	

50Ω ADAPTERS WITH ALL STANDARD SERIES

1 ST INTERFACE		2 ND INTERFACE		PART NUMBER	PAGE		
Series	Gender	Series	Gender				
2B4 (Banana Plug 4mm)	F	BNC	M	R191 453 000	16-20		
	M		F	R191 454 000			
4.1-9.5	F	4.3-10	M	R191 455 000			
4.3-10	F	7/16	M	R191 598 007	16-22		
		N		R191 592 007			
	M	7/16	F	R191 591 007	16-20		
		N		R191 592 017			
	F	7/16	M	R191 591 017	16-22		
		N		R191 592 037			
7/16	F	4.1-9.5	M	R191 592 027	16-22		
		4.3-10	F	R191 598 007			
		HN	M	R191 592 017		16-20	
		N	F	R191 592 037			
		QLI	M	R191 908 000		16-21	
		N	F	R191 723 000			
	M	QLI	M	R191 720 000	16-12		
		N	F	R191 665 000			
		4.3-10	M	R191 664 000	16-20		
		HN	F	R191 592 007			
		N	M	R191 592 027	16-22		
		QLI	F	R191 907 000			
BMA	F	SMA	F	R191 663 000	16-23		
			M	R191 353 711			
		SMP	M	R191 353 701			
			M	R191 351 701			
	M	SMA	F	R191 815 110	16-24		
			M	R191 352 001			
		SMP	F	R191 355 001			
			M	R191 354 001			
BNC	F	2B4	M	R191 350 001	16-20		
		C	M	R191 811 110			
		HN	M	R191 455 000		16-24	
		MCX	F	R191 429 000			
		N	F	R191 477 120		16-25	
			M	R191 422 000			
		PC7	-	R191 424 000		16-15	
		SMA	M	R191 421 000			
		SMB	F	M		R191 015 000	16-25
						R191 303 000	
						R191 215 000	
			M	F		5512-7501-000	16-25
R191 212 500							
R191 213 000							
			M	R191 212 000	16-26		

1 ST INTERFACE		2 ND INTERFACE		PART NUMBER	PAGE	
Series	Gender	Series	Gender			
BNC	F	SMC	F	R191 123 000	16-26	
			M	R191 124 000		
			M	R191 120 000		
		TNC	M	5510-1501-000	16-22	
			F	R191 405 000	16-26	
			F	R191 447 000		
	M	2B4	F	R191 453 000	16-20	
			F	R191 454 000		
		N	F	R191 419 000	16-26	
			M	R191 417 000		
		PC7	-	R191 013 000	16-15	
		SMA	F	M	R191 305 000	16-27
	R191 301 000					
	SMB		F	M	R191 214 000	16-27
					5405-1501-000	
			M	F	5404-1501-000	
					5403-1501-000	
	C	F	N	R191 417 000	16-22	
R191 209 000						
R191 708 000						
M		F	M	R191 703 000	16-28	
				R191 403 000		
				R191 429 000		
HN	F	M	R191 933 000	16-28		
			R191 705 000			
			R191 707 000			
	M	F	N	R191 907 000	16-21	
				R191 933 000		
				R191 908 000		
LC	F	M	R191 449 000	-		
			R191 737 000			
			R191 741 000			
	M	F	N	R191 741 000	16-28	
				R191 741 000		
				R191 741 000		
MCX	F	M	R191 741 000	16-28		
			R191 741 000			
			R191 741 000			
	M	F	N	R191 741 000	16-28	
				R191 741 000		
				R191 741 000		
MMCX	F	M	R191 741 000	16-28		
			R191 741 000			
			R191 741 000			
	M	F	N	R191 741 000	16-28	
				R191 741 000		
				R191 741 000		
MMBX	F	M	R191 741 000	16-29		
			R191 741 000			
			R191 741 000			
	M	F	N	R191 741 000	16-29	
				R191 741 000		
				R191 741 000		

Adapters

1 ST INTERFACE		2 ND INTERFACE		PART NUMBER	PAGE	
Series	Gender	Series	Gender			
N	F	4.3-10	M	R191 591 017	16-30	
		7/16	F	R191 723 000	16-21	
			M	R191 722 000		
		BNC	F	R191 422 000	16-25	
			M	R191 424 000		
		C	F	R191 419 000	16-26	
			M	R191 708 000		
		HN	F	R191 705 000	16-27	
			M	R191 737 000		
		LC	M	R191 741 000	16-28	
		PC7	F	R191 027 000	16-15	
		QLI	-	R191 027 000	16-15	
		QMA	F	R191 794 000	16-12	
			M	R191 794 000		
		QMA	F	R191 764 000	16-13	
			M	R191 763 000		
		QN	F	R191 760 010	16-14	
			M	R191 760 000		
	SMA	F	R191 759 000	16-30		
			R191 334 000			
			R191 332 000			
			R191 331 000			
			R191 381 000			
	SMA	M	R191 327 000	16-30		
			R191 377 000			
			R191 377 000			
	SMB	F	R191 239 000	16-31		
		M	R191 236 000			
	TNC	F	R191 514 000	16-31		
		M	R191 511 000			
	UHF	M	R191 733 000	16-31		
	M	M	4.3-10	F	R191 591 000	16-20
			7/16	F	R191 720 000	16-21
				M	R191 721 000	
			BNC	F	R191 421 000	16-25
				M	R191 417 000	
C			F	R191 703 000	16-28	
PC7			-	R191 025 000	16-15	
QLI			F	R191 793 000	16-12	
			M	R191 792 000		
QMA			F	R191 762 000	16-13	
			M	R191 765 000		
QN			M	R191 757 000	16-14	
SMA			F	R191 329 000	16-31	
			M	R191 325 000		
SMB			M	R191 233 000	16-31	
TNC			F	R191 513 000	16-31	
			M	R191 513 050		
UHF			F	R191 731 000	16-31	
SMA	F	BMA	F	R191 353 711	16-23	
			M	R191 353 701		
		BMA	M	R191 352 001	16-24	
			M	R191 355 001		
		BNC	M	R191 305 000	16-27	
		MC-Card	F	R191 366 091	16-11	
			M	R191 366 071		
		MCX	F	R191 388 000	16-28	
			M	R191 387 107		
		MMBX	F	R191 387 000	16-29	
			M	R191 389 400		
		MMCX	F	R191 389 200	16-29	
			M	R191 389 100		
		Moebius	M	R191 398 020	16-11	
			M	R191 857 000	16-11	

1 ST INTERFACE		2 ND INTERFACE		PART NUMBER	PAGE
Series	Gender	Series	Gender		
SMA	F	N	F	R191 334 000	16-30
				R191 332 000	
				R191 331 000	
				R191 381 000	
		N	M	R191 329 000	16-31
				R191 011 000	16-16
		PC7	-	R191 011 000	16-16
		QMA	F	R191 913 000	16-13
			M	R191 911 000	
		QRE	M	R191 926 L01	16-14
		R-MCX	F	R191 976 020	16-12
			F	R191 203 007	
		SMB	F	R191 201 007	16-32
			M	R191 844 002	
		SMP	M	R191 843 001	16-23
				R191 843 421	
				R191 843 401	
				R191 843 429	
				R191 843 409	
		SMPM	M	5964-9513-001	16-32
				5965-9513-000	
	SSMA	F	R191 349 000	16-32	
	SSMC	F	5945-9503-000	16-32	
	TNC	F	R191 315 000	16-33	
			R191 365 000		
	TNC	M	R191 313 000	16-33	
			R191 318 700		
	TNC 18 GHz	F	R191 314 730	16-18	
			R191 314 700		
	TNC 18 GHz	F	R191 351 701	16-23	
			R191 354 001		
	BMA	M	R191 350 001	16-24	
			R191 350 001		
	BNC	F	R191 303 000	16-25	
		M	R191 301 000	16-27	
	MCX	F	R191 386 000	16-28	
		M	R191 385 000		
	MMCX	F	R191 389 300	16-29	
		M	R191 389 100		
	N	F	R191 327 000	16-30	
			R191 377 000		
	N	M	R191 325 000	16-31	
R191 325 000					
PC7	-	R191 009 000	16-16		
QMA	F	R191 912 000	16-13		
	M	R191 910 000			
QRE	F	R191 927 L01	16-14		
R-MCX	F	R191 977 020	16-12		
	M	R191 984 008			
SMB	M	R191 200 007	16-33		
SMC	F	R191 374 000	16-33		
SMP	F	R191 842 002	16-34		
	M	R191 841 001			
SSMA	F	R191 374 000	16-34		
SSMC	M	5938-1503-000	16-34		
TNC	F	R191 311 000	16-34		
	M	R191 309 000			

Adapters

1 ST INTERFACE		2 ND INTERFACE		PART NUMBER	PAGE
Series	Gender	Series	Gender		
SMB	F	BNC	F	R191 215 000	16-25
			M	5512-7501-000	
			F	R191 214 000	16-27
			M	5405-1501-000	16-22
		N	F	R191 239 000	16-30
		PC7	-	R191 007 000	16-16
	SMA	F	R191 203 007	16-32	
	M	BNC	F	R191 212 500	16-25
			M	R191 213 000	
			F	R191 212 000	16-26
			M	R191 209 000	16-27
		M	5404-1501-000	16-22	
		N	F	R191 236 000	16-30
		M	R191 233 000	16-31	
SMA		F	R191 201 007	16-32	
M	R191 200 007	16-33			
SMC	F	BNC	F	R191 123 000	16-26
			M	R191 124 000	
		M	5403-1501-000	16-22	
		PC7	-	R191 003 000	16-16
	SMA	M	R191 374 000	16-33	
	M	BNC	F	R191 120 000	16-26
			M	5510-1501-000	16-22
M			R191 117 000	16-27	
M	5402-1501-000	16-22			
SMP	F	BMA	M	R191 811 110	16-24
		SMA	F	R191 844 002	16-32
			M	R191 842 002	16-33
			F	R191 969 002	16-17
		M	R191 967 002		
	M	BMA	F	R191 815 110	16-23
		SMA	F	R191 843 001	16-32
			F	R191 843 429	16-23
			M	R191 843 409	
		M	R191 841 001	16-34	
		SMA 2.9	F	R191 968 001	16-17
M	R191 966 001				
SMPM	M	R191 570 100	16-34		

1 ST INTERFACE		2 ND INTERFACE		PART NUMBER	PAGE
Series	Gender	Series	Gender		
SMPM	F	2.4 mm	F	R191 565 000	16-34
			M	R191 563 000	
		SMA 2.9	F	R191 959 000	16-17
			M	R191 957 000	
	M	2.4 mm	F	R191 564 000	16-35
			M	R191 562 000	
		SMA	F	5964-9513-001	
			M	5965-9513-000	
		SMA 2.9	F	R191 958 000	
			M	R191 958 020	
	SMP	M	R191 956 020		
SSMA	F	SMA	F	R191 570 100	16-34
			M	R191 349 000	16-32
SSMC	F	SMA	F	R191 347 000	16-34
	M		F	5945-9503-000	16-32
TNC	F	BNC	M	5938-1503-000	16-34
			F	R191 403 000	16-27
		N	M	R191 514 000	16-30
			M	R191 513 000	16-31
		M	R191 513 050		
		SMA	F	R191 315 000	16-33
	M		R191 365 000		
	M	BNC	F	R191 311 000	16-34
			M	R191 405 000	16-26
		N	F	R191 511 000	16-31
			M	R191 313 000	16-33
SMA		M	R191 309 000	16-34	
UHF	F	BNC	M	R191 445 000	16-27
		N	M	R191 731 000	16-31
	M	BNC	F	R191 447 000	16-26
		N	F	R191 733 000	16-31

Adapters

50Ω AND 75Ω IN SERIES ADAPTERS (FOR REFERENCE ONLY)

In Series Adapters	Part Number	Gender (Male - Female)				Type					Function								
		Side 1	Side 2	Side 3	Side 4	Str.	R/A	U	T	X	Bulkhead	Sealed		Panel Isolated	Flange	Press-In	Locked On Panel	Hermetic	
												Panel	Inside Line						
7/16	R183 703 000	M	M			X													
	R185 705 000	F	F			X													
	R185 707 000	M	F			X													
	R185 710 000	F	F			X													
	R185 730 020	F	F			X						X	X		X				
2.4 mm	R327 703 000	M	M			X													
	R327 704 000	M	F			X													
	R327 705 000	F	F			X													
	R327 771 000	M	F				X												
4.1-9.5	R170 703 007	M	M			X													
	R141 703 000	M	M			X													
	R141 704 000	F	F			X													
	R141 710 000	F	F			X													
	R141 717 000	F	F			X								X	X				
	R141 720 000	F	F			X					X								
	R141 723 000	F	F			X					X			X					
	R141 723 161	F	F			X					X			X					
	R141 730 000	F	F			X					X	X							
	R141 753 000	F	F			X					X	X						X	
	R141 770 000	M	F				X												
	R141 780 000	F	F	M					X										
	R141 782 000	F	F	F					X										
	R141 789 000	F	M	F					X										
	R141 799 000	F	F	F	M					X									
	BNC	R142 703 000	M	M			X												
R142 704 000		F	F			X													
R142 710 000		F	F			X								X					
R142 720 000		F	F			X					X								
R142 723 000		F	F			X					X			X					
R142 770 000		M	F				X												
R142 780 000		F	F	M															
R142 782 000		F	F	F															
R142 789 000		M	F	F															
R142 703 703		M	M			X													
BNC 75 Ω	R142 720 700	F	F			X					X								
	R316 704 000	F	F			X													
BNC HT	R316 754 000	F	F			X					X	X	X						
	R166 705 000	F	F			X													
C	R166 770 000	M	F				X												
	R166 753 000	F	F			X					X	X						X	
DT-F	R139 705 023	F	F			X													
	R176 754 000	F	F			X					X	X	X					X	
HN	R176 754 150	F	F			X					X	X							
	R176 770 000	M	F				X												
	R199 001 703	M	M			X									X				
MCC2	R199 001 713	M	M			X													
	R199 001 733	M	M			X											X		
	R113 704 000	F	F			X													
MCX	R110 704 103	F	F			X					X								
MMCX	R209 703 070	M	M			X													
MMS	R210 703 507	F	F Slide On			X													
MMT	R161 703 000	M	M			X													
	R161 705 000	F	F			X													
	R161 715 000	F	F			X													
	R161 730 000	F	F			X					X	X		X					
	R161 753 000	F	F			X					X	X	X					X	
	R161 771 000	M	F				X												
	R161 780 000	F	F	M															
	R161 782 000	F	F	F															
	R161 791 500	F	M Slide On			X													
	R161 791 530	M	F			X													
N18 GHz	R163 703 001	M	M			X													
	R163 705 001	F	F			X													
	R163 708 001	M	F			X													
N75 Ω	R162 703 000	M	M			X													
	R162 705 000	F	F			X													
QMA	R123 703 000	M	M			X													
	R123 704 000	M	F			X													
	R123 705 000	F	F			X													
QN	R164 705 000	F	F			X													
	R164 708 000	M	F			X													

Notes

Drawings can be found in the corresponding series' section

Adapters

In Series Adapters	Part Number	Gender (Male - Female)				Type					Function							
		Side 1	Side 2	Side 3	Side 4	Str.	R/A	U	T	X	Bulkhead	Sealed		Panel Isolated	Flange	Press-In	Locked On Panel	Hermetic
						1-2	1-2	1-2	1-2-3	1-2-3-4		Panel	Inside Line					
SHV	R317 720 000	M	M			X					X							
	R125 703 000	M	M			X												
SMA	R125 703 001	M	M			X												
	R125 704 000	M	F			X												
	R125 704 001	M	F			X												
	R125 705 000	F	F			X												
	R125 705 001	F	F			X												
	R125 720 000	F	F			X					X							
	R125 720 001	F	F			X					X							
	R125 753 000	F	F			X					X	X	X				X	
	R125 753 001	F	F			X					X	X	X				X	
	R125 771 000	M	F				X											
	R125 771 001	M	F				X											
	R125 780 000	F	F	M					X									
	R125 780 001	F	F	M					X									
	R125 781 000	F	F	F					X									
	R125 781 001	F	F	F					X									
	R125 791 501	F	M Slide On				X											
	R125 792 501	F	F Slide On				X											
	SMA 2.9	R127 703 001	M	M			X											
		R127 704 001	M	F			X											
		R127 705 001	F	F			X											
R127 712 001		F	F			X								X				
R127 732 100		F	F			X					X	X						
R127 753 000		F	F			X					X	X	X				X	
R127 870 001		F	F			X												
R127 871 001		M	M			X												
SMB	R127 872 001	M	F			X												
	R114 703 000	M	M			X												
	R114 704 000	F	F			X												
	R114 720 000	M	M			X					X							
	R114 753 000	M	M			X					X	X	X				X	
	R114 780 000	M	M	F														
	R114 781 000	M	M	M														
	5207-1501-000	M	M	M					X									
	5213-1501-000	M	M						X									
	5215-1501-000	M	M	F					X									
SMC	R112 720 000	M	M			X					X							
	R112 780 000	M	M	F					X									
SSMA	R121 703 000	M	M			X												
	R121 705 000	F	F			X												
SSMB	R121 705 001	F	F			X												
	7222-1501-600	M	M			X					X							
TNC	7122-1502-000	M	M			X					X							
	R143 703 000	M	M			X												
	R143 704 000	F	F			X												
	R143 710 000	F	F			X								X				
	R143 713 000	F	M Slide On			X								X				
	R143 713 200	M	F			X									X			
	R143 720 000	F	F			X					X							
	R143 753 000	F	F			X					X	X	X				X	
	R143 770 000	M	F				X											
	R143 780 000	F	F	M					X									
	R143 782 000	F	F	F					X									
	TNC18	R143 703 700	M	M			X											
R143 704 700		F	F			X												
R143 705 700		M	F			X												
R143 710 700		F	F			X								X				
UHF	R143 730 700	F	F			X					X	X						
	R155 705 000	F	F			X												

Notes

Drawings can be found in the corresponding series' section

Adapters 75Ω & 50Ω

75 OHMS ADAPTERS

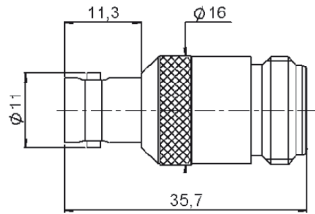

PART NUMBER	INTERFACE
R192 418 000	BNC Female - N Female

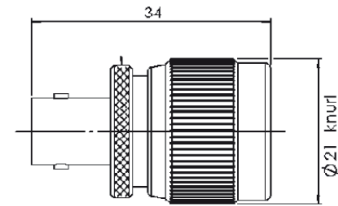

PART NUMBER	INTERFACE
R192 421 000	BNC Female - N Male

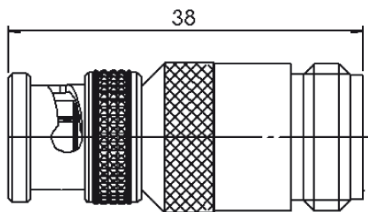

PART NUMBER	INTERFACE
R192 419 000	BNC Male - N Female

RADIALL PROPRIETARY INTERFACE ADAPTERS

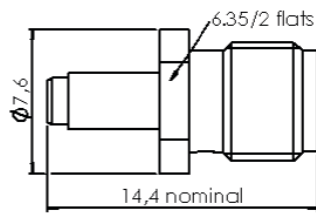

PART NUMBER	INTERFACE
R191 366 091	MC-Card Female - SMA Female

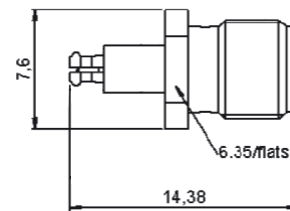

PART NUMBER	INTERFACE
R191 366 071	MC-Card Male - SMA Female

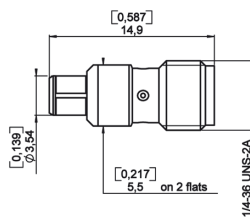

PART NUMBER	INTERFACE
R191 857 000	Moebius Male - SMA Female

Adapters 50Ω

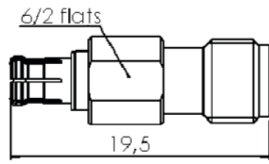

PART NUMBER	INTERFACE
R191 976 020	R-MCX Female - SMA Female

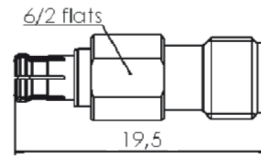

PART NUMBER	INTERFACE
R191 977 020	R-MCX Female - SMA Male

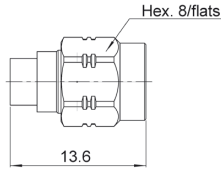

PART NUMBER	INTERFACE
R191 984 008	R-MCX Male - SMA Male

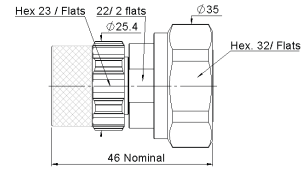

PART NUMBER	INTERFACE
R191 663 000	QLI Female - 7/16 Male

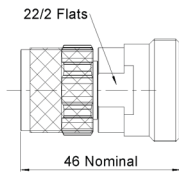

PART NUMBER	INTERFACE
R191 665 000	QLI Female - 7/16 Female

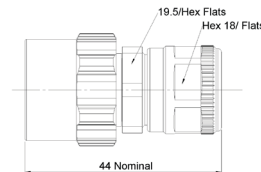

PART NUMBER	INTERFACE
R191 793 000	QLI Female - N Male

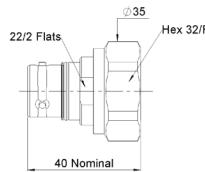

PART NUMBER	INTERFACE
R191 662 000	QLI Male - 7/16 Male

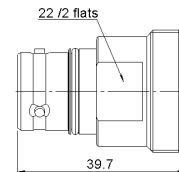

PART NUMBER	INTERFACE
R191 664 000	QLI Male - 7/16 Female

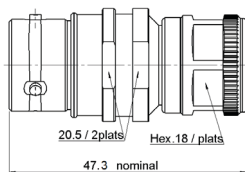

PART NUMBER	INTERFACE
R191 792 000	QLI Male - N Male

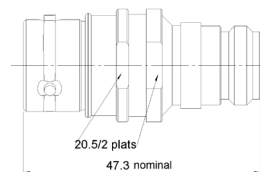

PART NUMBER	INTERFACE
R191 794 000	QLI Male - N Female

Adapters 50Ω

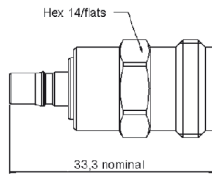

PART NUMBER	INTERFACE
R191 764 000	QMA Female - N Female

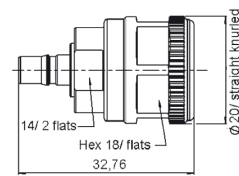

PART NUMBER	INTERFACE
R191 762 000	QMA Female - N Male

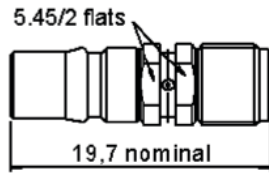

PART NUMBER	INTERFACE
R191 913 000	QMA Female - SMA Female

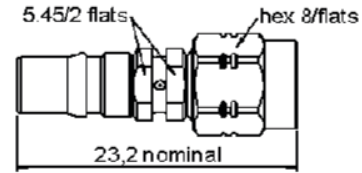

PART NUMBER	INTERFACE
R191 912 000	QMA Female - SMA Male

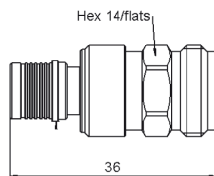

PART NUMBER	INTERFACE
R191 763 000	QMA Male - N Female

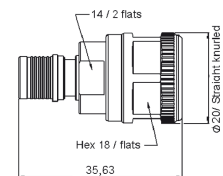

PART NUMBER	INTERFACE
R191 765 000	QMA Male - N Male

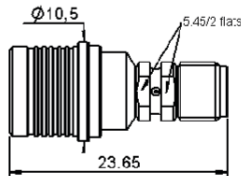

PART NUMBER	INTERFACE
R191 911 000	QMA Female - SMA Female

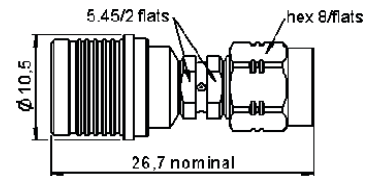

PART NUMBER	INTERFACE
R191 910 000	QMA Male - SMA Male

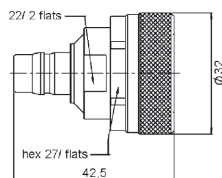

PART NUMBER	INTERFACE
R191 923 000	QN Female - 7/16 Male

Adapters 50Ω

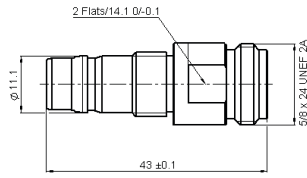

PART NUMBER	INTERFACE
R191 760 010	QN Female - N Female

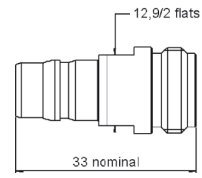

PART NUMBER	INTERFACE
R191 760 000	QN Female - N Female

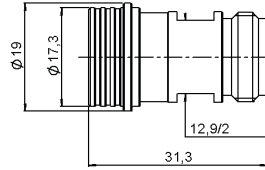

PART NUMBER	INTERFACE
R191 759 000	QN Male - N Female

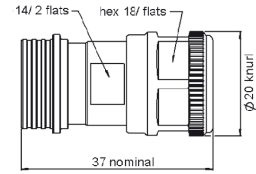

PART NUMBER	INTERFACE
R191 757 000	QN Male - N Male

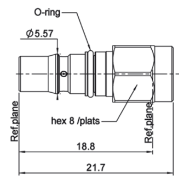

PART NUMBER	INTERFACE
R191 927 L01	QRE Female - SMA Male

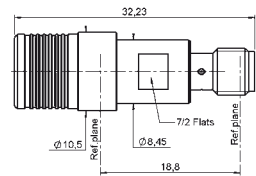

PART NUMBER	INTERFACE
R191 926 L01	QRE Male - SMA Female

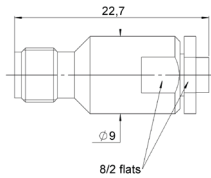

PART NUMBER	INTERFACE
R191 975 781	MMS Male - SMA 3.5 Female

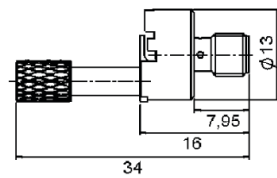

PART NUMBER	INTERFACE
R107 009 901	UMP H2 - SMA Female

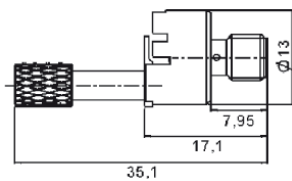

PART NUMBER	INTERFACE
R107 009 903	UMP H3 - SMA Female

Adapters 50Ω

HIGH FREQUENCY AND PRECISION CONNECTOR ADAPTERS

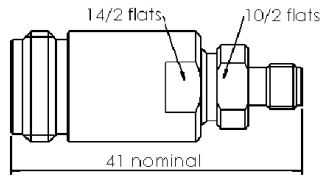

PART NUMBER	INTERFACE
R191 330 000	N18 Female - SMA 3.5 Female

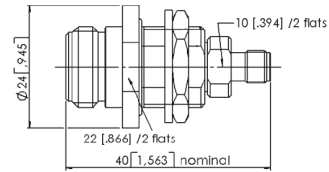

PART NUMBER	INTERFACE	PANEL DRILLING
R191 333 000	N18 Female - SMA 3.5 Female	P11

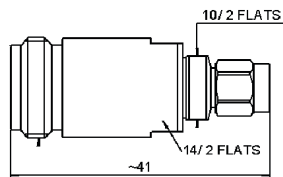

PART NUMBER	INTERFACE
R191 326 000	N18 Female - SMA 3.5 Male

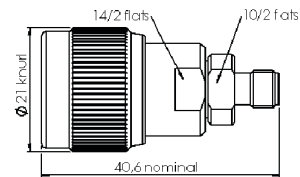

PART NUMBER	INTERFACE
R191 328 000	N18 Male - SMA 3.5 Female

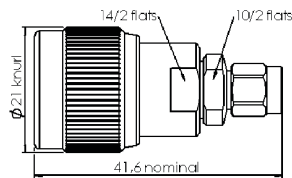

PART NUMBER	INTERFACE
R191 324 000	N18 Male - SMA 3.5 Male

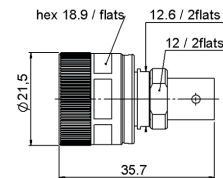

PART NUMBER	INTERFACE
R191 015 000	PC7 - BNC Female

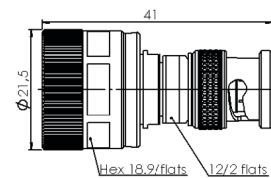

PART NUMBER	INTERFACE
R191 013 000	PC7 - BNC Male

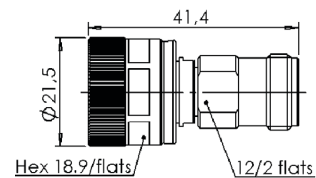

PART NUMBER	INTERFACE
R191 027 000	PC7 - N Female

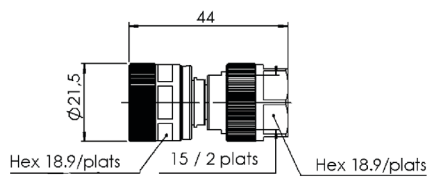

PART NUMBER	INTERFACE
R191 025 000	PC7 - N Male

Adapters 50Ω

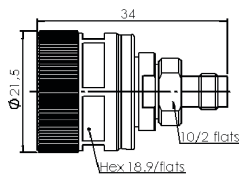

PART NUMBER	INTERFACE
R191 011 000	PC7 - SMA Female

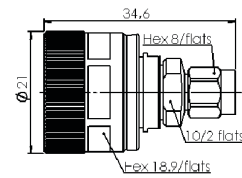

PART NUMBER	INTERFACE
R191 009 000	PC7 - SMA Male

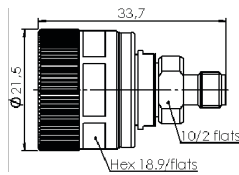

PART NUMBER	INTERFACE
R191 012 000	PC7 - SMA 3.5 Female

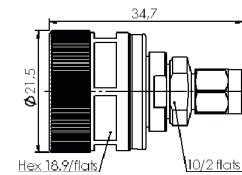

PART NUMBER	INTERFACE
R191 010 000	PC7 - SMA 3.5 Male

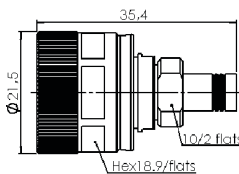

PART NUMBER	INTERFACE
R191 007 000	PC7 - SMB Female

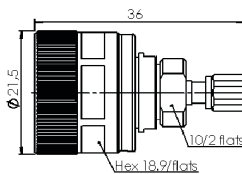

PART NUMBER	INTERFACE
R191 003 000	PC7 - SMC Female

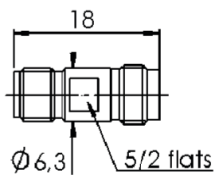

PART NUMBER	INTERFACE
R191 970 091	SMA 2.4 Female - SMA 2.9 Female

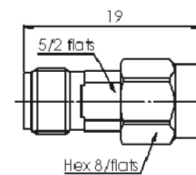

PART NUMBER	INTERFACE
R191 970 071	SMA 2.4 Female - SMA 2.9 Male

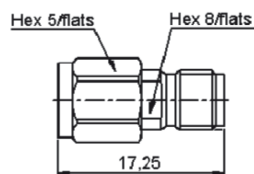

PART NUMBER	INTERFACE
R191 970 081	SMA 2.4 Male - SMA 2.9 Female

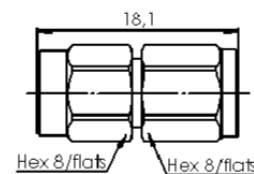

PART NUMBER	INTERFACE
R191 970 061	SMA 2.4 Male - SMA 2.9 Male

Adapters 50Ω

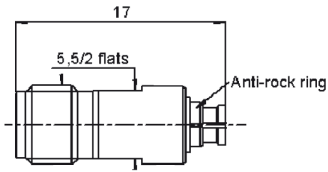

PART NUMBER	INTERFACE
R191 969 002	SMA 2.9 Female - SMP Female

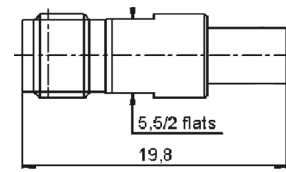

PART NUMBER	INTERFACE
R191 968 001	SMA 2.9 Female - SMP Male

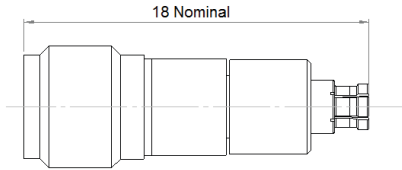

PART NUMBER	INTERFACE
R191 959 000	SMA 2.9 Female - SMPM Female

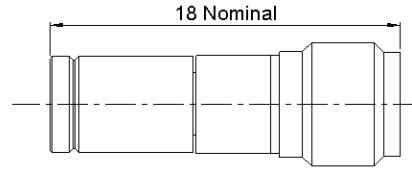

PART NUMBER	INTERFACE
R191 958 000	SMA 2.9 Female - SMPM Male

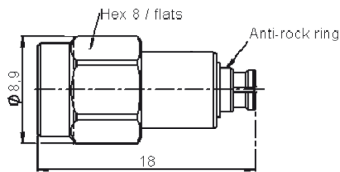

PART NUMBER	INTERFACE
R191 967 002	SMA 2.9 Male - SMP Female

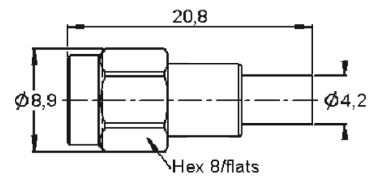

PART NUMBER	INTERFACE
R191 966 001	SMA 2.9 Male - SMP Male

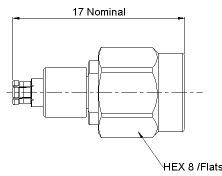

PART NUMBER	INTERFACE
R191 957 000	SMA 2.9 Male - SMPM Female

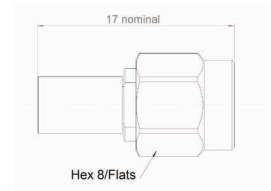

PART NUMBER	INTERFACE
R191 956 020	SMA 2.9 Male - SMPM Male

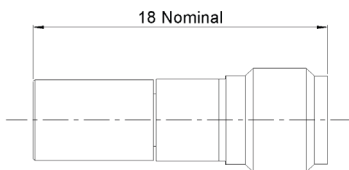

PART NUMBER	INTERFACE
R191 958 020	SMA 2.9 Male - SMPM Male

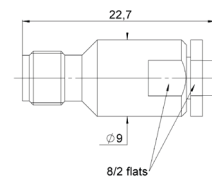

PART NUMBER	INTERFACE
R191 975 781	SMA 3.5 Female - MMS Male

Adapters 50Ω

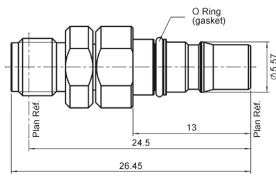

PART NUMBER	INTERFACE
R191 946 700	SMA 3.5 Female - QRE Male



PART NUMBER	INTERFACE
R191 944 700	SMA 3.5 Female - QRE Male

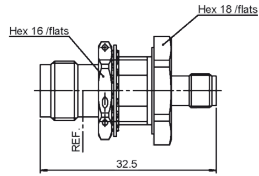

PART NUMBER	INTERFACE	PANEL DRILLING
R191 316 700	TNC18 Female - SMA 3.5 Female	P04

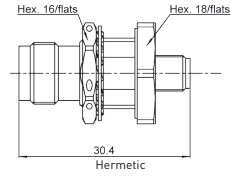

PART NUMBER	INTERFACE	PANEL DRILLING
R191 318 700	TNC18 Female - SMA Female	P04

PUSH-ON ADAPTERS

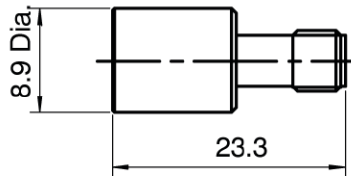

PART NUMBER	INTERFACE
R125 791 501	SMA Push-On Male - SMA Female

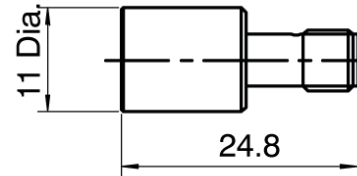

PART NUMBER	INTERFACE
R125 792 501	SMA Push-On Female - SMA Female

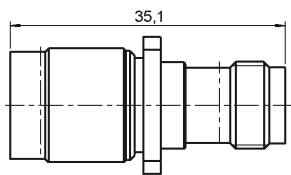

PART NUMBER	INTERFACE	PANEL DRILLING
R143 713 000	TNC Push-On Male - TNC Female	P02

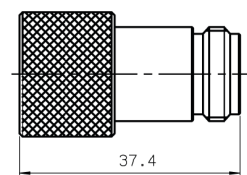

PART NUMBER	INTERFACE
R161 791 500	N Push-On Male - N Female

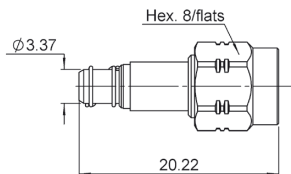

PART NUMBER	INTERFACE
R191 977 520	MCX Push-On Female - SMA Male

Adapters 50Ω

TEST PROBE ADAPTERS

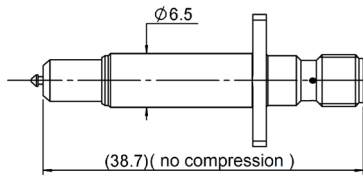

PART NUMBER	INTERFACE
R191 389 800	SMA Female - MMBX Female

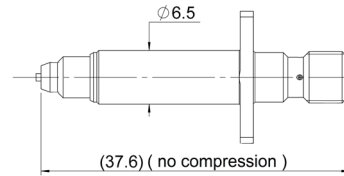

PART NUMBER	INTERFACE
R191 597 800	SMA Female - MML H2.5 & H2.0 Female

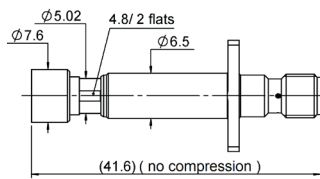

PART NUMBER	INTERFACE
R191 300 800	SMA Female - SMA Female

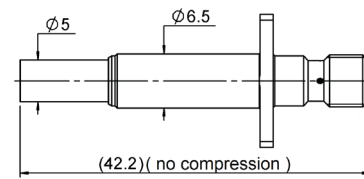

PART NUMBER	INTERFACE
R191 201 800	SMA Female - SMB Male

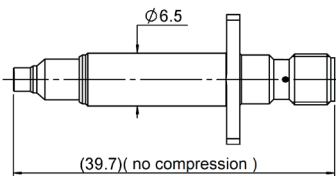

PART NUMBER	INTERFACE
R191 844 800	SMA Female - SMP Female

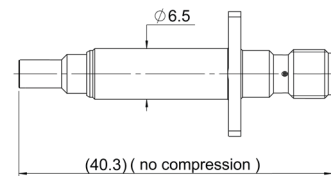

PART NUMBER	INTERFACE
R191 553 800	SMA Female - SMP-MAX Female

Adapters 50Ω

STANDARD SERIES ADAPTERS

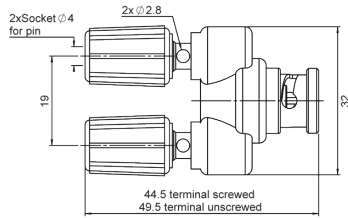

PART NUMBER	INTERFACE
R191 453 000	2B4 Female - BNC Male

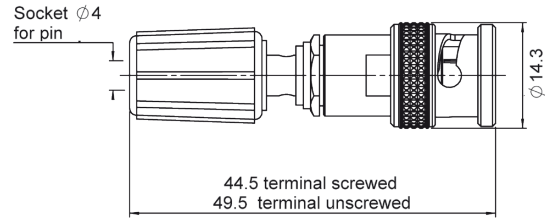

PART NUMBER	INTERFACE
R191 454 000	2B4 Female - BNC Male

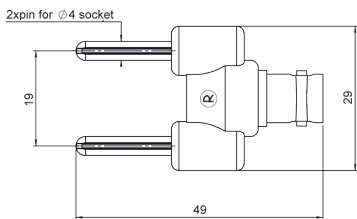

PART NUMBER	INTERFACE
R191 455 000	2B4 Male - BNC Female

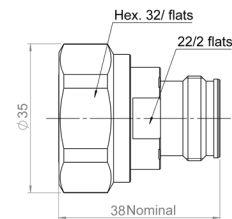

PART NUMBER	INTERFACE
R191 592 007	4.3-10 Female - 7/16 Male

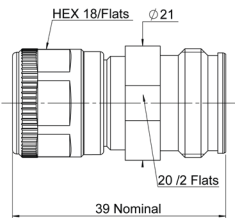

PART NUMBER	INTERFACE
R191 591 007	4.3-10 Female - N Male

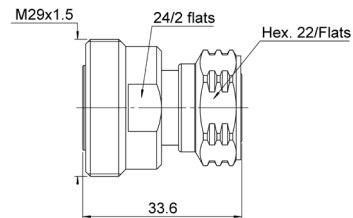

PART NUMBER	INTERFACE
R191 592 017	4.3-10 Male - 7/16 Female

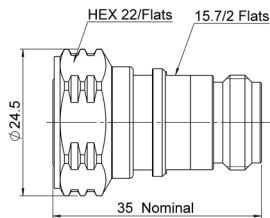

PART NUMBER	INTERFACE
R191 591 017	4.3-10 Male - N Female

Adapters 50Ω

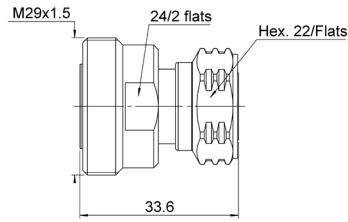

PART NUMBER	INTERFACE
R191 592 017	7/16 Female - 4.3-10 Male

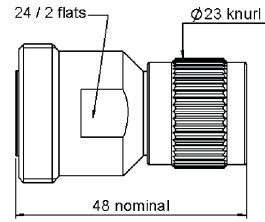

PART NUMBER	INTERFACE
R191 908 000	7/16 Female - HN Male

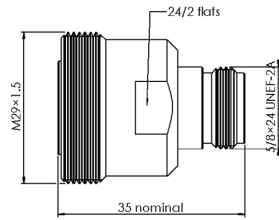

PART NUMBER	INTERFACE
R191 723 000	7/16 Female - N Female

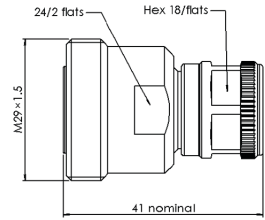

PART NUMBER	INTERFACE
R191 720 000	7/16 Female - N Male

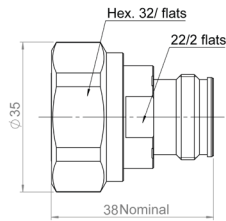

PART NUMBER	INTERFACE
R191 592 007	7/16 Male - 4.3-10 Female

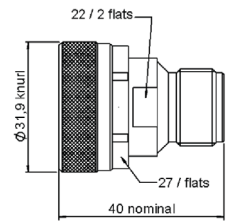

PART NUMBER	INTERFACE
R191 907 000	7/16 Male - HN Female

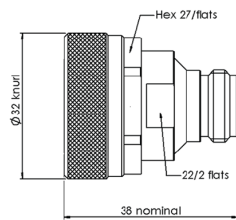

PART NUMBER	INTERFACE
R191 722 000	7/16 Male - N Female

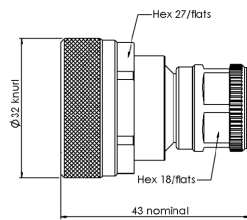

PART NUMBER	INTERFACE
R191 721 000	7/16 Male - N Male

Adapters 50Ω

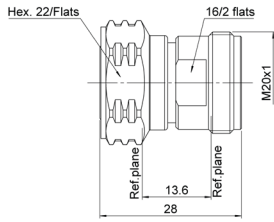

PART NUMBER	INTERFACE
R191 598 007	4.3-10 Male - 4.1-9.5 Female

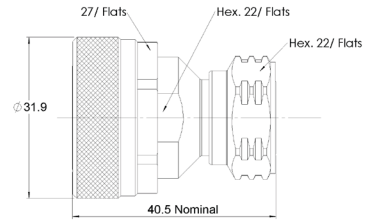

PART NUMBER	INTERFACE
R191 592 027	4.3-10 Male - 7/16 Male

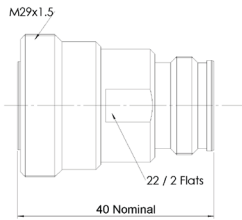

PART NUMBER	INTERFACE
R191 592 037	4.3-10 Male - 4.1-9.5 Female

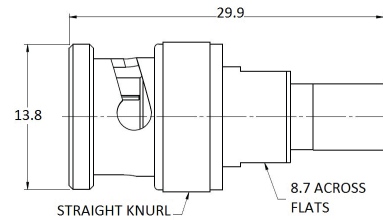

PART NUMBER	INTERFACE
5405-1501-000	BNC Male - SMB Female

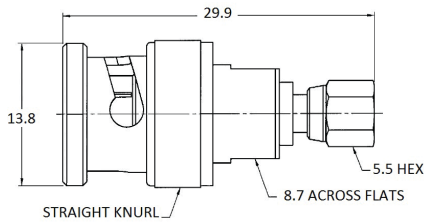

PART NUMBER	INTERFACE
5403-1501-000	BNC Male - SMC Female

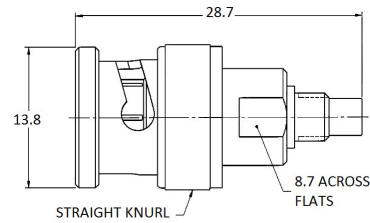

PART NUMBER	INTERFACE
5402-1501-000	BNC Male - SMC Female

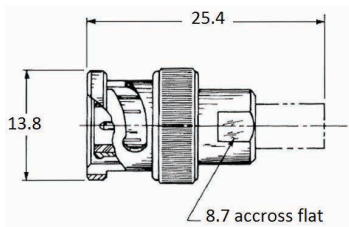

PART NUMBER	INTERFACE
5404-1501-000	BNC Male - SMB Male

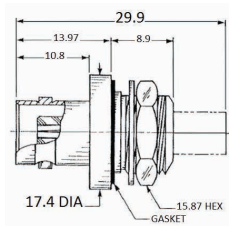

PART NUMBER	INTERFACE
5510-1501-000	BNC Male - SMB Female

Adapters 50Ω

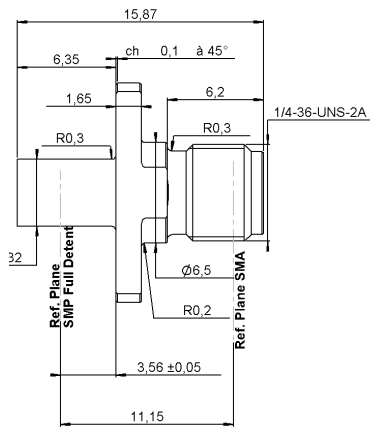

PART NUMBER	INTERFACE
R191 843 429	SMA Female - SMP Male

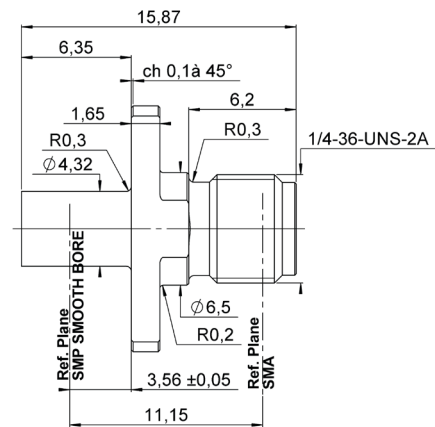

PART NUMBER	INTERFACE
R191 843 409	SMA Female - SMP Male

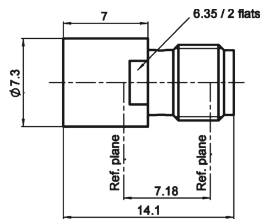

PART NUMBER	INTERFACE
R191 353 711	BMA Female - SMA Female

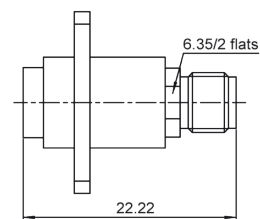

PART NUMBER	INTERFACE	PANEL DRILLING
R191 353 701	BMA Female - SMA Female	P12

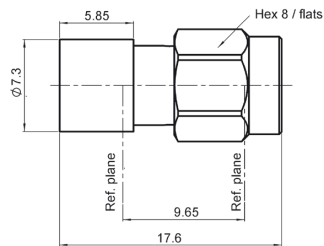

PART NUMBER	INTERFACE
R191 351 701	BMA Female - SMA Male

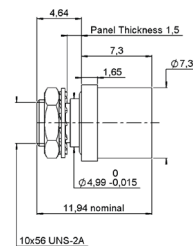

PART NUMBER	INTERFACE
R191 815 110	BMA Female - SMP Male

Adapters 50Ω

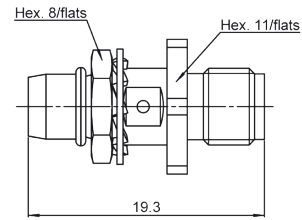
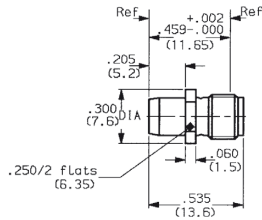

PART NUMBER	INTERFACE
R191 352 001	BMA Male - SMA Female

PART NUMBER	INTERFACE	PANEL DRILLING
R191 355 001	BMA Male - SMA Female	P03

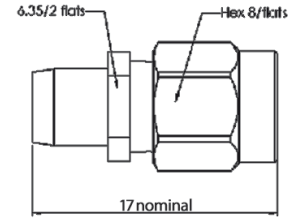
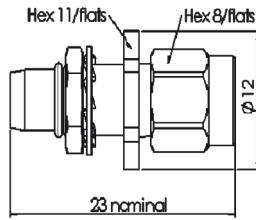

PART NUMBER	INTERFACE	PANEL DRILLING
R191 354 001	BMA Male - SMA Male	P03

PART NUMBER	INTERFACE
R191 350 001	BMA Male - SMA Male

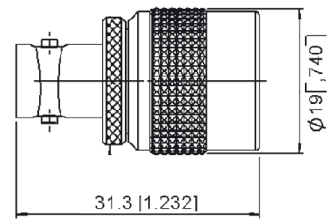
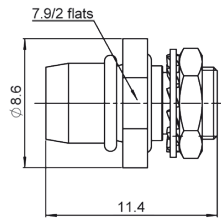

PART NUMBER	INTERFACE	PANEL DRILLING
R191 811 110	BMA Male - SMP Female	P13

PART NUMBER	INTERFACE
R191 429 000	BNC Female - C Male

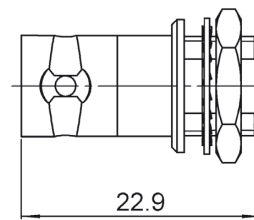
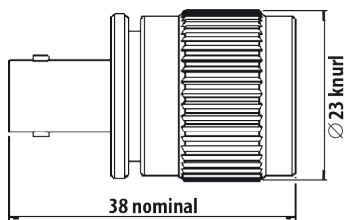

PART NUMBER	INTERFACE
R191 449 000	BNC Female - HN Male

PART NUMBER	INTERFACE	PANEL DRILLING
R191 477 120	BNC Female - MCX Female	P10

Adapters 50Ω

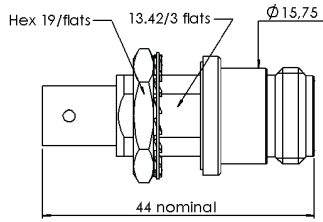

PART NUMBER	INTERFACE	PANEL DRILLING
R191 422 000	BNC Female - N Female	P11

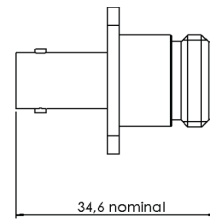

PART NUMBER	INTERFACE	PANEL DRILLING
R191 424 000	BNC Female - N Female	P01

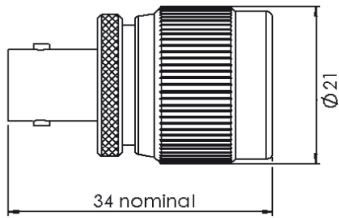

PART NUMBER	INTERFACE
R191 421 000	BNC Female - N Male

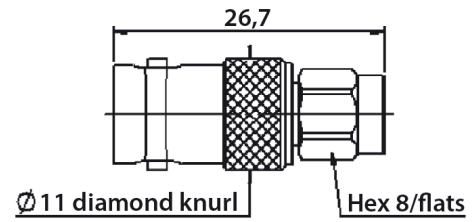

PART NUMBER	INTERFACE
R191 303 000	BNC Female - SMA Male

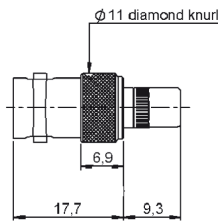

PART NUMBER	INTERFACE
R191 215 000	BNC female - SMB female

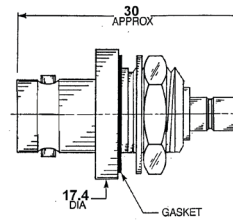

PART NUMBER	INTERFACE	PANEL DRILLING
5512-7501-000	BNC Female - SMB Male	P17

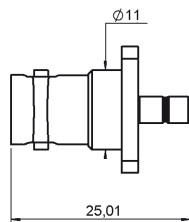

PART NUMBER	INTERFACE	PANEL DRILLING
R191 212 500	BNC Female - SMB Male	P14

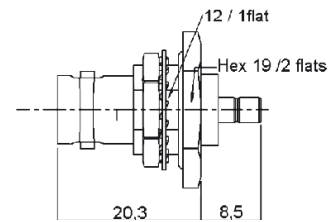

PART NUMBER	INTERFACE	PANEL DRILLING
R191 213 000	BNC Female - SMB Male	P04

Adapters 50Ω

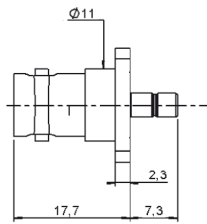

PART NUMBER	INTERFACE	PANEL DRILLING
R191 212 000	BNC Female - SMB Male	P02

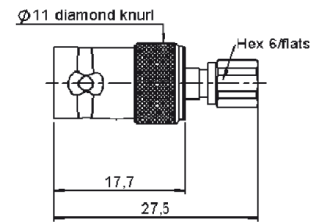

PART NUMBER	INTERFACE
R191 123 000	BNC Female - SMC Female

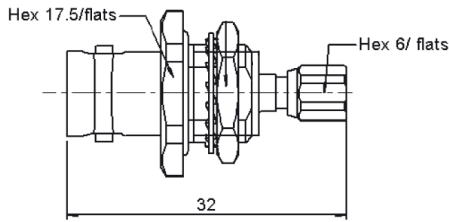

PART NUMBER	INTERFACE	PANEL DRILLING
R191 124 000	BNC Female - SMC Female	P06

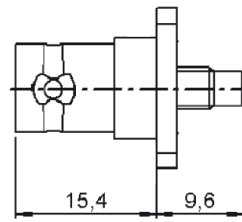

PART NUMBER	INTERFACE	PANEL DRILLING
R191 120 000	BNC Female - SMC Male	P02

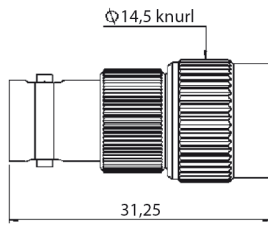

PART NUMBER	INTERFACE
R191 405 000	BNC Female - TNC Male

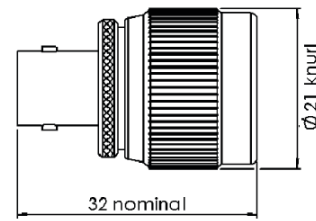

PART NUMBER	INTERFACE
R191 447 000	BNC Female - UHF Male

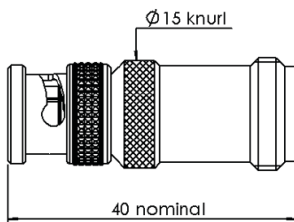

PART NUMBER	INTERFACE
R191 419 000	BNC Male - N Female

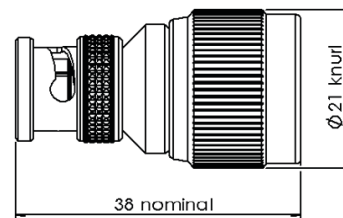

PART NUMBER	INTERFACE
R191 417 000	BNC Male - N Male

Adapters 50Ω

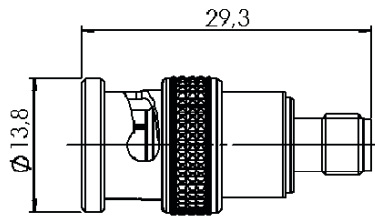

PART NUMBER	INTERFACE
R191 305 000	BNC Male - SMA Female

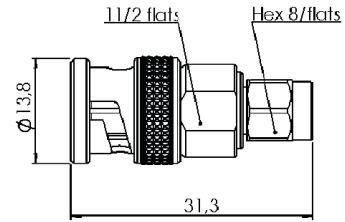

PART NUMBER	INTERFACE
R191 301 000	BNC Male - SMA Male

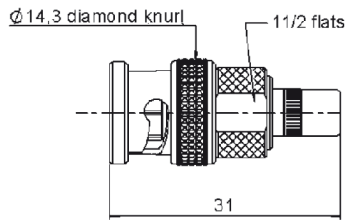

PART NUMBER	INTERFACE
R191 214 000	BNC Male - SMB Female

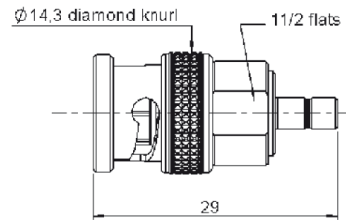

PART NUMBER	INTERFACE
R191 209 000	BNC Male - SMB Male

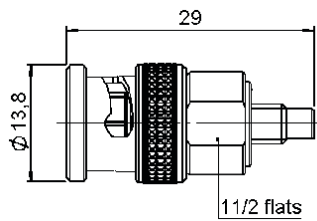

PART NUMBER	INTERFACE
R191 117 000	BNC Male - SMC Male

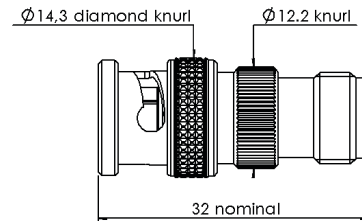

PART NUMBER	INTERFACE
R191 403 000	BNC Male - TNC Female

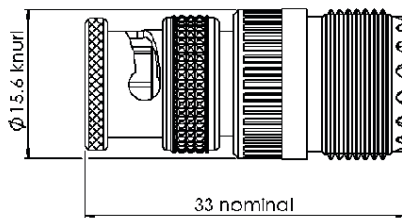

PART NUMBER	INTERFACE
R191 445 000	BNC Male - UHF Female

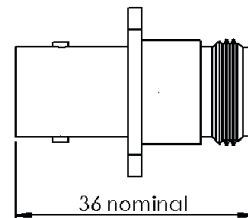

PART NUMBER	INTERFACE	PANEL DRILLING
R191 708 000	C Female - N Female	P01

Adapters 50Ω

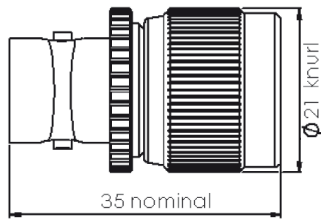

PART NUMBER	INTERFACE
R191 703 000	C Female - N Male

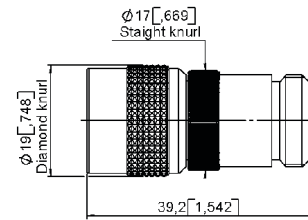

PART NUMBER	INTERFACE
R191 705 000	C Male - N Female

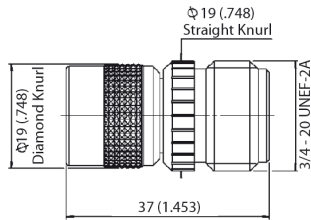

PART NUMBER	INTERFACE
R191 933 000	C Male - HN Female

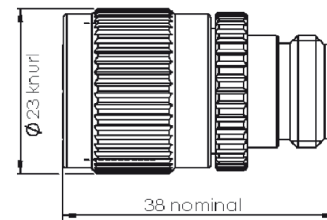

PART NUMBER	INTERFACE
R191 737 000	HN Male - N Female

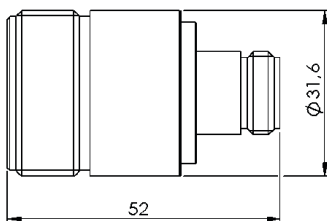

PART NUMBER	INTERFACE
R191 741 000	LC Female - N Female

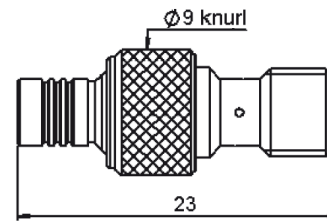

PART NUMBER	INTERFACE
R191 388 000	MCX Female - SMA Female

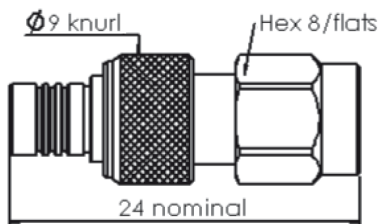

PART NUMBER	INTERFACE
R191 386 000	MCX Female - SMA Male

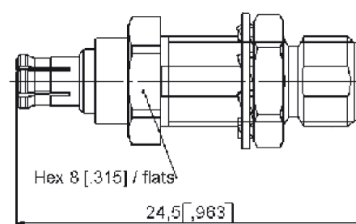

PART NUMBER	INTERFACE	PANEL DRILLING
R191 387 107	MCX Male - SMA Female	P07

Adapters 50Ω

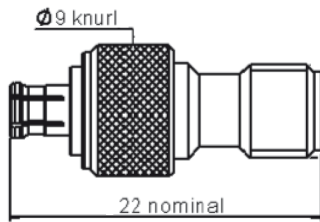

PART NUMBER	INTERFACE
R191 387 000	MCX Male - SMA Female

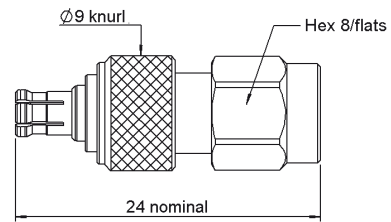

PART NUMBER	INTERFACE
R191 385 000	MCX Male - SMA Male

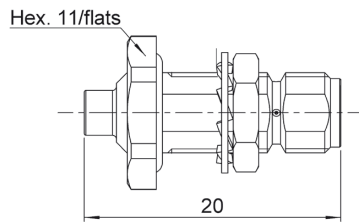

PART NUMBER	INTERFACE	PANEL DRILLING
R191 399 100	MMCX Female - SMA Female	P07

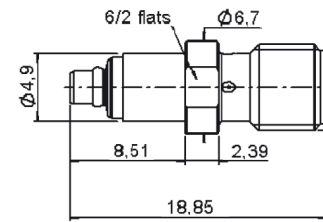

PART NUMBER	INTERFACE
R191 398 020	MMCX Male - SMA Female

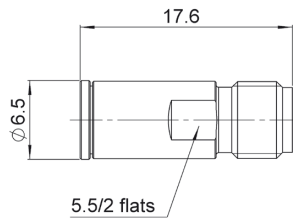

PART NUMBER	INTERFACE
R191 389 400	MMBX Female - SMA Female

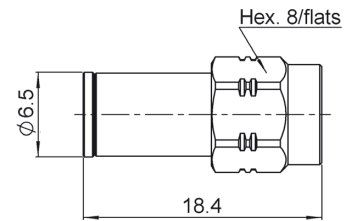

PART NUMBER	INTERFACE
R191 389 300	MMBX Female - SMA Male

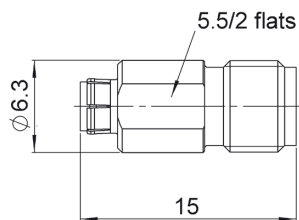

PART NUMBER	INTERFACE
R191 389 200	MMBX Male - SMA Female

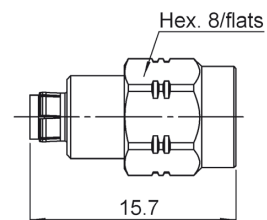

PART NUMBER	INTERFACE
R191 389 100	MMBX Male - SMA Male

Adapters 50Ω

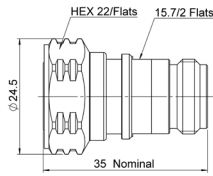

PART NUMBER	INTERFACE
R191 591 017	N Female- 4.3-10 Male

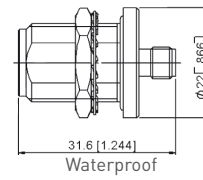

PART NUMBER	INTERFACE	PANEL DRILLING
R191 334 000	N Female - SMA Female	P05

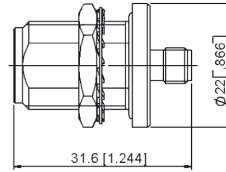

PART NUMBER	INTERFACE	PANEL DRILLING
R191 332 000	N Female - SMA Female	P05

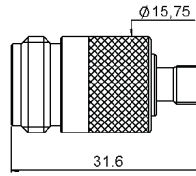

PART NUMBER	INTERFACE
R191 331 000	N Female - SMA Female

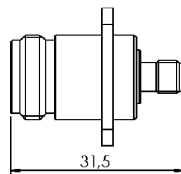

PART NUMBER	INTERFACE	PANEL DRILLING
R191 381 000	N Female - SMA Female	P01

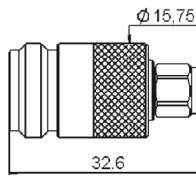

PART NUMBER	INTERFACE
R191 327 000	N Female - SMA Male

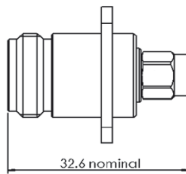

PART NUMBER	INTERFACE	PANEL DRILLING
R191 377 000	N Female - SMA Male	P01

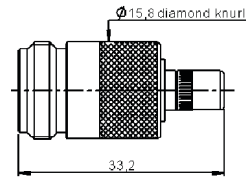

PART NUMBER	INTERFACE
R191 239 000	N Female - SMB Female

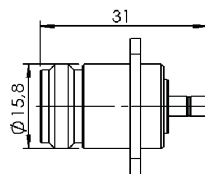

PART NUMBER	INTERFACE	PANEL DRILLING
R191 236 000	N Female - SMB Male	P01

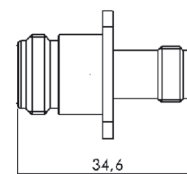

PART NUMBER	INTERFACE	PANEL DRILLING
R191 514 000	N Female - TNC Female	P01

Adapters 50Ω

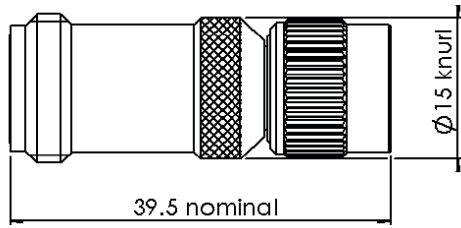

PART NUMBER	INTERFACE
R191 511 000	N Female - TNC Male

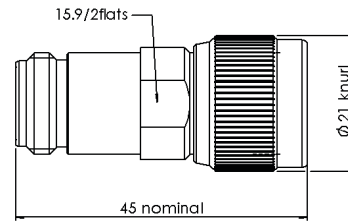

PART NUMBER	INTERFACE
R191 733 000	N Female - UHF Male

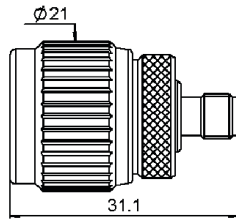

PART NUMBER	INTERFACE
R191 329 000	N Male - SMA Female

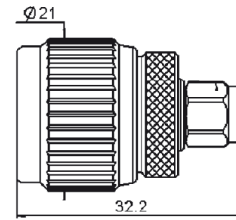

PART NUMBER	INTERFACE
R191 325 000	N Male - SMA Male

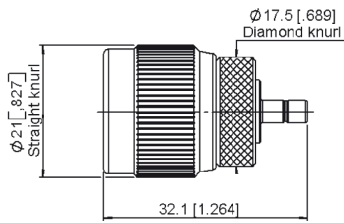

PART NUMBER	INTERFACE
R191 233 000	N Male - SMB Male

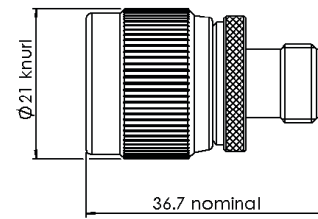

PART NUMBER	INTERFACE
R191 513 000	N Male - TNC Female

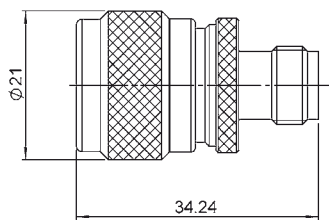

PART NUMBER	INTERFACE
R191 513 050	N Male - TNC Female

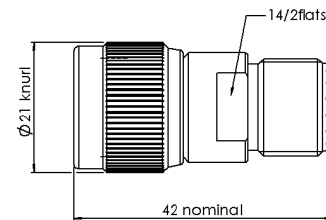

PART NUMBER	INTERFACE
R191 731 000	N Male - UHF Female

Adapters 50Ω

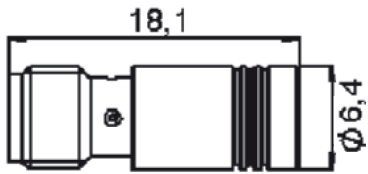

PART NUMBER	INTERFACE
R191 203 007	SMA Female - SMB Female

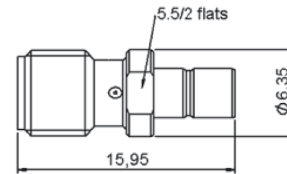

PART NUMBER	INTERFACE
R191 201 007	SMA Female - SMB Male

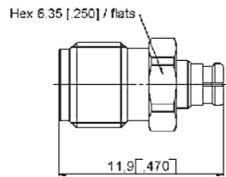

PART NUMBER	INTERFACE
R191 844 002	SMA Female - SMP Female

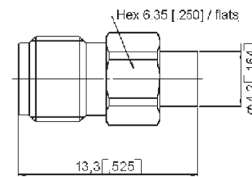

PART NUMBER	INTERFACE
R191 843 001	SMA Female - SMP Male

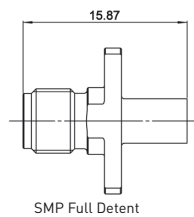

SMP Full Detent

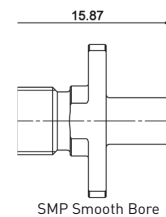

SMP Smooth Bore

PART NUMBER	INTERFACE	PANEL DRILLING
R191 843 421	SMA Female - SMP Male	P15

PART NUMBER	INTERFACE	PANEL DRILLING
R191 843 401	SMA Female - SMP Male	P15

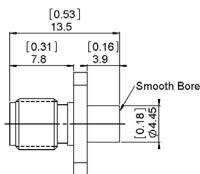

PART NUMBER	INTERFACE	PANEL DRILLING
5964-9513-001	SMA Female - SMPM Male	P15

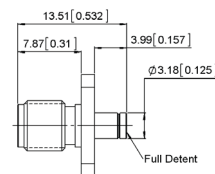

PART NUMBER	INTERFACE	PANEL DRILLING
5965-9513-000	SMA Female - SMPM Male	P15

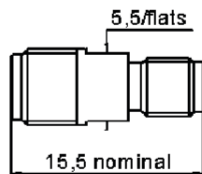

PART NUMBER	INTERFACE
R191 349 000	SMA Female - SSMA Female

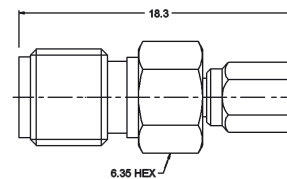

PART NUMBER	INTERFACE
5945-9503-000	SMA Female - SSMC Female

Adapters 50Ω

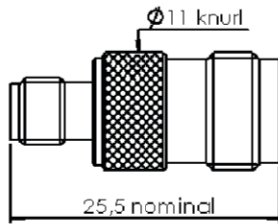

PART NUMBER	INTERFACE
R191 315 000	SMA Female - TNC Female

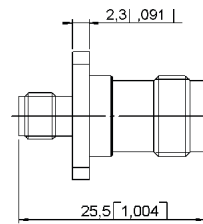

PART NUMBER	INTERFACE	PANEL DRILLING
R191 365 000	SMA Female - TNC Female	P02

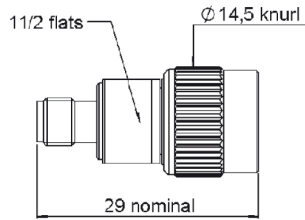

PART NUMBER	INTERFACE
R191 313 000	SMA Female - TNC Male

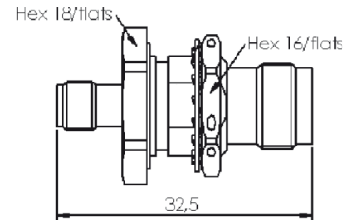

PART NUMBER	INTERFACE	PANEL DRILLING
R191 314 700	SMA Female - TNC18 Female	P04

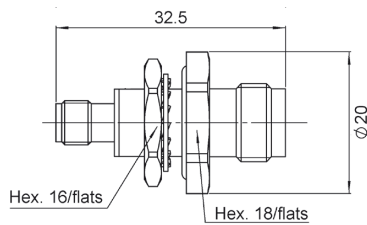

PART NUMBER	INTERFACE	PANEL DRILLING
R191 314 730	SMA Female - TNC18 Female	P08

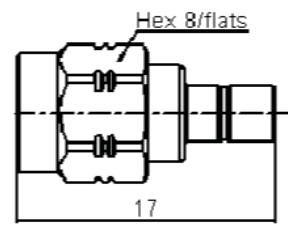

PART NUMBER	INTERFACE
R191 200 007	SMA Male - SMB Male

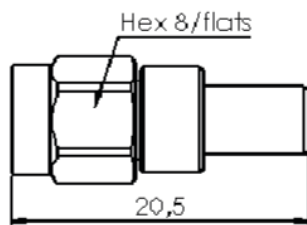

PART NUMBER	INTERFACE
R191 374 000	SMA Male - SMC Female

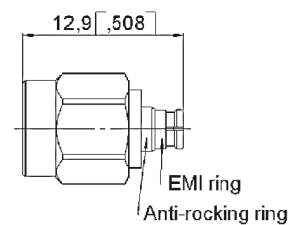

PART NUMBER	INTERFACE
R191 842 002	SMA Male - SMP Female

Adapters 50Ω

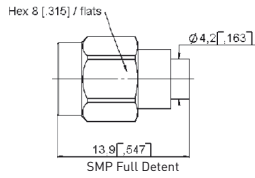

PART NUMBER	INTERFACE
R191 841 001	SMA Male - SMP Male

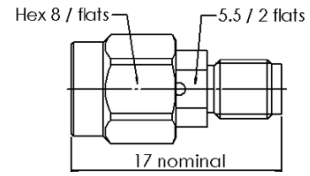

PART NUMBER	INTERFACE
R191 347 000	SMA Male - SSMA Female

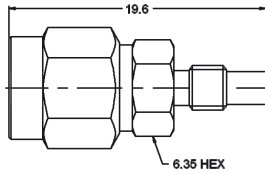

PART NUMBER	INTERFACE
5938-1503-000	SMA Male - SSMC Male

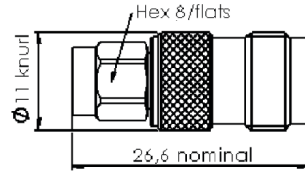

PART NUMBER	INTERFACE
R191 311 000	SMA Male - TNC Female

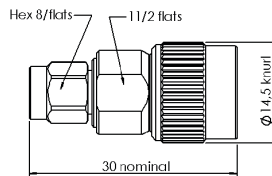

PART NUMBER	INTERFACE
R191 309 000	SMA Male - TNC Male

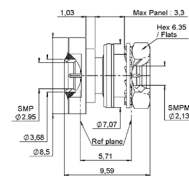

PART NUMBER	INTERFACE
R191 570 100	SMP Male - SMPM Male

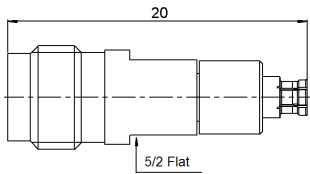

PART NUMBER	INTERFACE
R191 565 000	SMPM Female - 2.4 mm Female

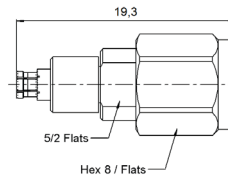

PART NUMBER	INTERFACE
R191 563 000	SMPM Female - 2.4 mm Male

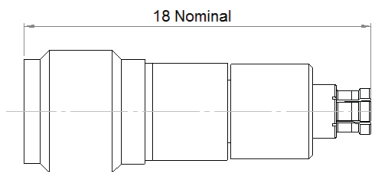

PART NUMBER	INTERFACE
R191 959 000	SMPM Female - 2.9 mm Female

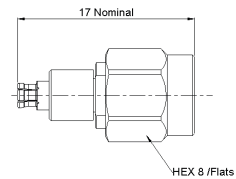

PART NUMBER	INTERFACE
R191 957 000	SMPM Female - 2.9 mm Male

Adapters 50Ω

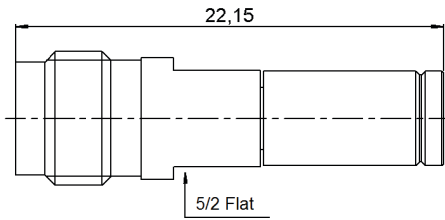

PART NUMBER	INTERFACE
R191 564 000	SMPM Male - 2.4 mm Female

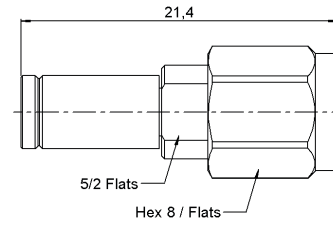

PART NUMBER	INTERFACE
R191 562 000	SMPM Male - 2.4 mm Male

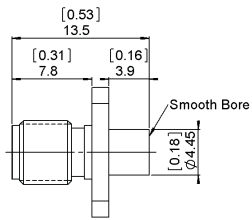

PART NUMBER	INTERFACE
5964-9513-001	SMPM Male - SMA Female

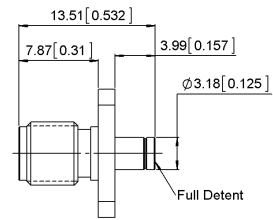

PART NUMBER	INTERFACE
5965-9513-000	SMPM Male - SMA Female

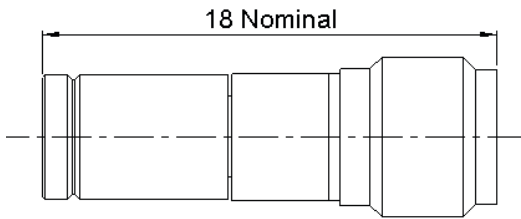

PART NUMBER	INTERFACE
R191 958 000	SMPM Male - SMA 2.9 Female

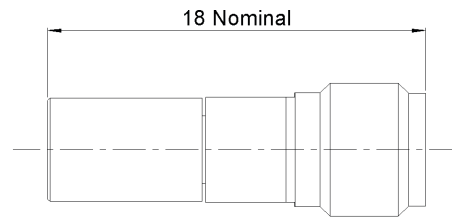

PART NUMBER	INTERFACE
R191 958 020	SMPM Male - SMA 2.9 Male

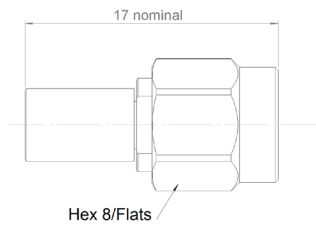

PART NUMBER	INTERFACE
R191 956 020	SMPM Male - SMA 2.9 Male

Adapters

PANEL DRILLING

P01

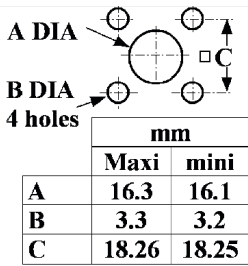

P02

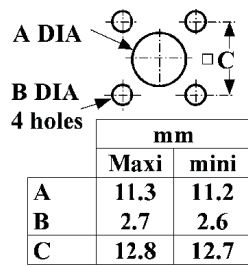

P03

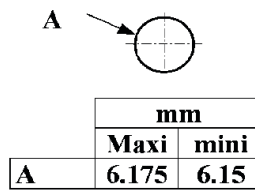

P04

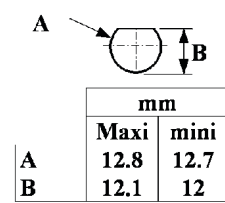

P05

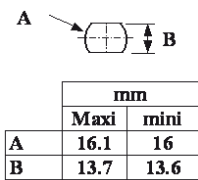

P06

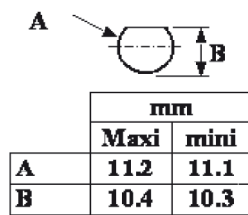

P07

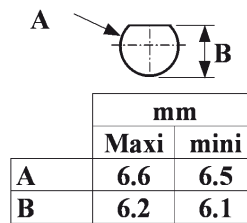

P08

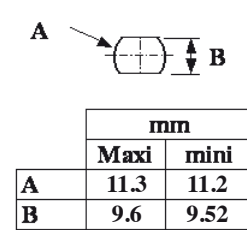

P10

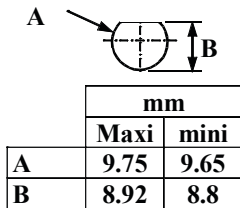

P11

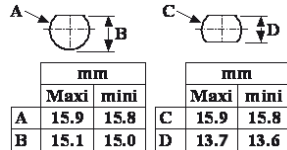

P12

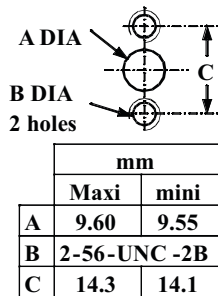

P13

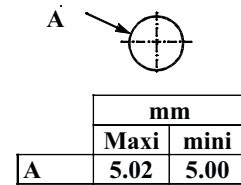

P14

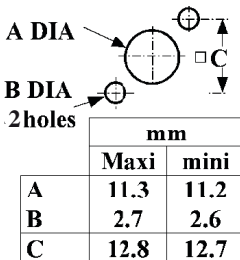

P15

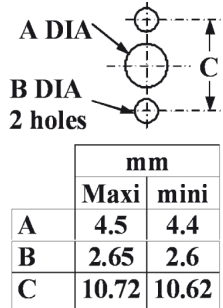

P16

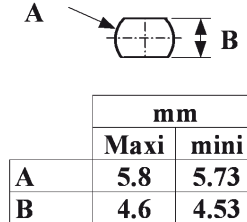

P17

