

THIS DRAWING CONTAINS INFORMATION PROPRIETARY TO POSTTRONIC AND ITS SUBSIDIARIES. POSTTRONIC BELIEVES THE DATA ON THIS DRAWING TO BE RELIABLE. SINCE THE TECHNICAL INFORMATION IS GIVEN FREE OF CHARGE, THE USER ASSUMES ALL LIABILITY FOR THE USE OF THE INFORMATION AND RISK. POSTTRONIC ASSUMES NO RESPONSIBILITY FOR RESULTS OBTAINED OR DAMAGES INCURRED FROM USE OF SUCH INFORMATION IN WHOLE OR IN PART.

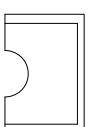

TYPICAL INSERT

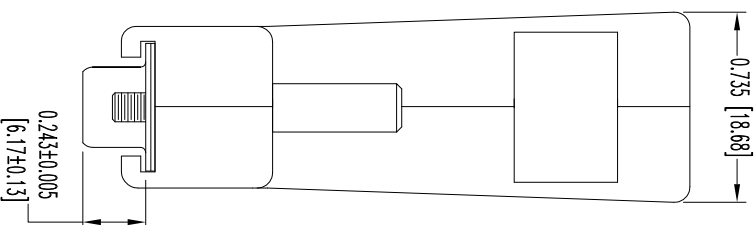
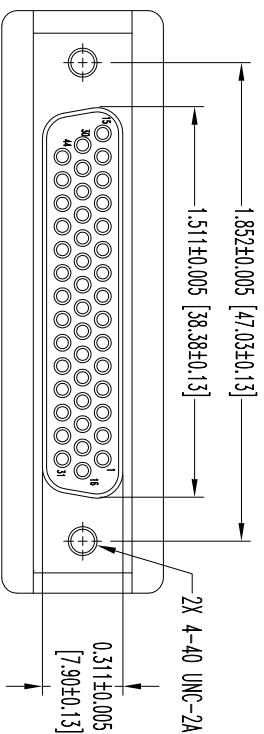
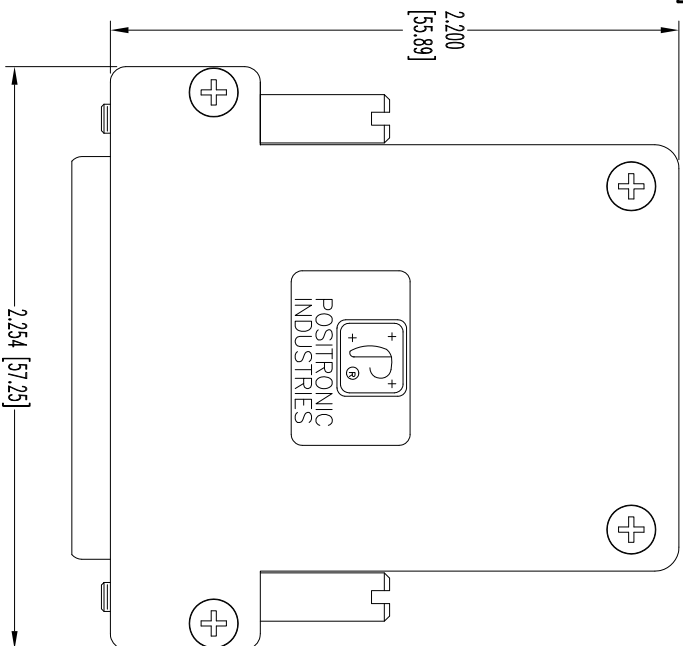
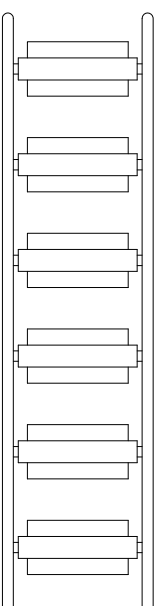

INSERT TREE ASSEMBLY

- NOTES:
1. MATERIALS AND FINISHES:
 INSULATOR: GLASS FILLED POLYESTER PER ASTM-D5927, COLOR: BLUE.
 CONTACTS: PRECISION COPPER, GOLD FLASH OVER NICKEL PLATE.
 SHELLS: STAINLESS STEEL, PASSIVATED.
 HOOD: CONDUCTIVE COMPOSITE.
 JACKSCREWS: STAINLESS STEEL, PASSIVATED.
 2. DETAILED PRODUCT, MECHANICAL, AND ELECTRICAL INFORMATION IS AVAILABLE IN THE LATEST HIGH DENSITY D-SUB PRODUCT PUBLICATION. VISIT CONNECTPOSTTRONIC.COM/PRODUCTS/59/HIGHDENSITYD-SUBMINIATURE OR CONNECTPOSTTRONIC.COM.
 3. DIMENSIONS ARE IN INCHES [MILLIMETERS].

DATE	REV	REVISION/RECORD	APP	DR	CK
5-18-12	NC	ECO 35853	COLB	BS	COLB

SK14098



POSTTRONIC INDUSTRIES INC.
www.connectposttronic.com

FSCM 28198

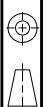

DECIMAL TOL.
 ± 0.015 [0.38]

DD SERIES

SCALE
 N.T.S.

DRAWN BY
 BS

TITLE

DD44S20Z0S

APPROVED BY
 COLB

ANGULAR TOL.
 $\pm 5^\circ$

DATE
 5-18-12

DRAWING NUMBER
 SK14098

REV.
 NC