

THIS DRAWING CONTAINS INFORMATION PROPRIETARY TO POSITRONIC AND IS SUBJECT TO THE SUPERSEDES NOTICE. ANY REVISIONS TO THIS DRAWING WILL BE INDICATED BY A REVISION TABLE. THE USER EMPLOY'S SUCH INFORMATION AT HIS OWN DISCRETION. POSITRONIC ASSUMES NO LIABILITY FOR ANY RESULTS OBTAINED OR DAMAGES INCURRED FROM USE OF SUCH INFORMATION, IN WHOLE OR IN PART.

SK15462

| DATE | REV | REVISION/RECORD | APP | DR | CK |
|----------|-----|-----------------|------|----|------|
| 10-11-13 | NC | ECO 41049 | COLB | BS | COLB |
| | | | | | |
| | | | | | |
| | | | | | |

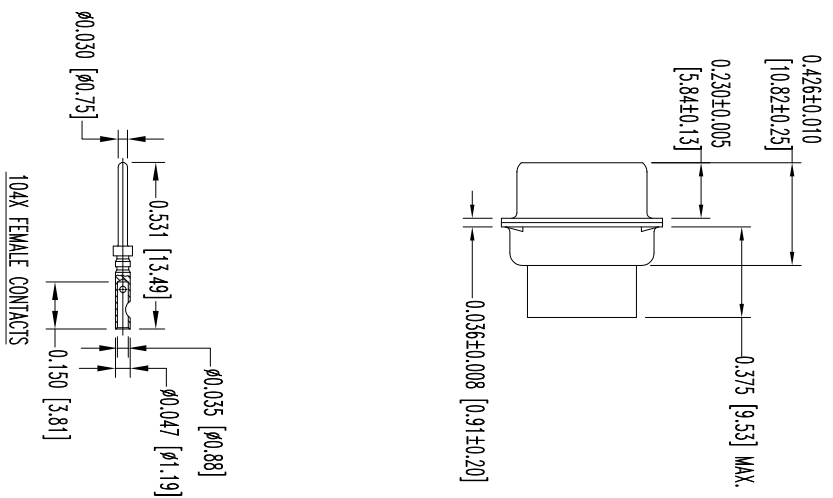
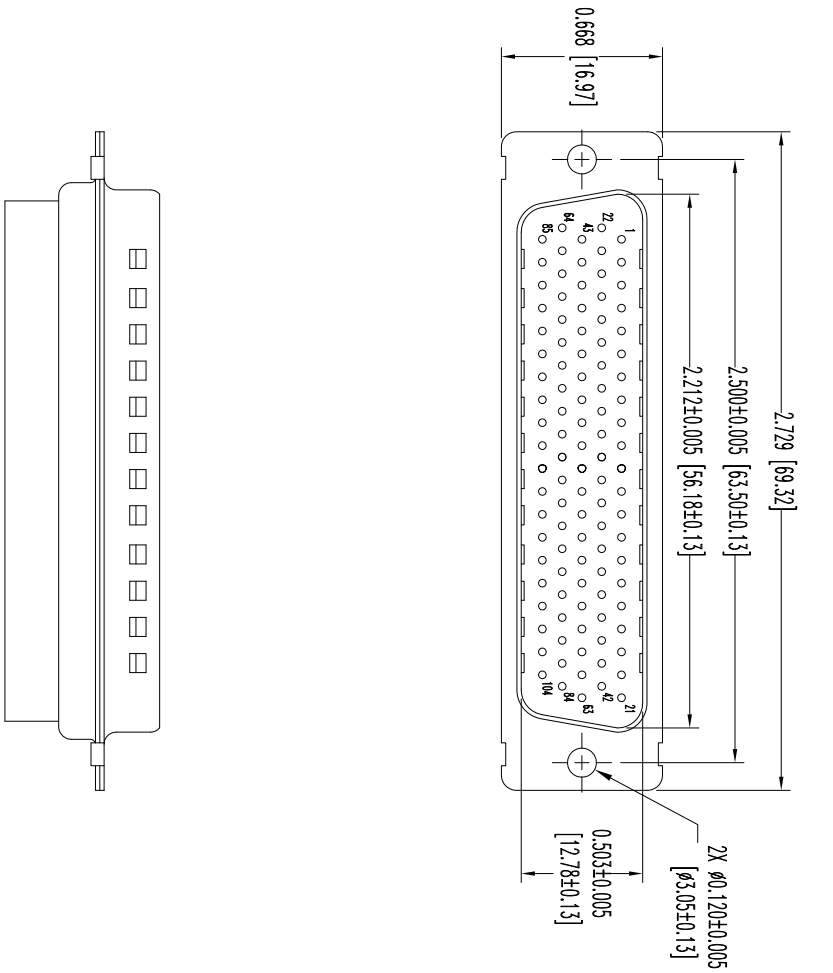

NOTES:
 1. MATERIALS AND FINISHES:
 INSULATOR: GLASS FILLED POLYESTER PER ASTM-D5927, UL 94V-0, COLOR: BLUE.
 CONTACTS: PRECISION MACHINED COPPER ALLOY, GOLD FLASH OVER NICKEL PLATE.
 SHELLS: DIMPLED STEEL WITH TIN PLATE.

2. DETAILED PRODUCT, MECHANICAL, AND ELECTRICAL INFORMATION IS AVAILABLE IN THE LATEST HIGH DENSITY D-SUB PRODUCT PUBLICATION. VISIT CONNECTPOSITRONIC.COM/PRODUCTS/59/HIGHDENSITYD-SUBMINIATURE OR CONNECTPOSITRONIC.COM.
 3. DIMENSIONS ARE IN INCHES [MILLIMETERS].

POSITRONIC INDUSTRIES INC.
www.connectpositronic.com
 FSCM 28198

| | | | |
|--------------|----------------|----------------|-------------|
| DECIMAL TOL. | ± 0.015 [0.38] | ANGULAR TOL. | ± 5° |
| DD SERIES | DD104M2000Z | SCALE | N.T.S. |
| DRAWN BY | B SHELLBY | DATE | 10-11-13 |
| APPROVED BY | COLB | DRAWING NUMBER | SK15462 |
| REV. | NC | TITLE | DD104M2000Z |