

THIS DRAWING CONTAINS INFORMATION PROPRIETARY TO POSITRONIC INDUSTRIES. THE DATA ON THIS DRAWING TO BE RELIABLE SINCE THE USER EMPLOYER'S SUCH INFORMATION AT HIS OWN DISCRETION. RESULTS OBTAINED OR DAMAGES INCURRED FROM USE OF SUCH INFORMATION IN WHOLE OR IN PART.

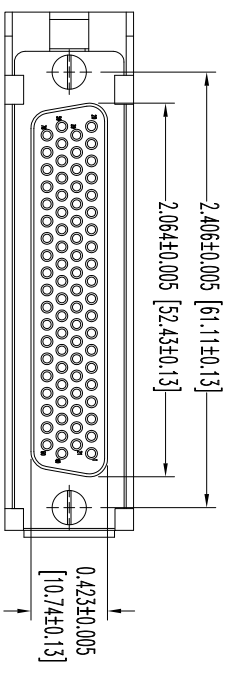
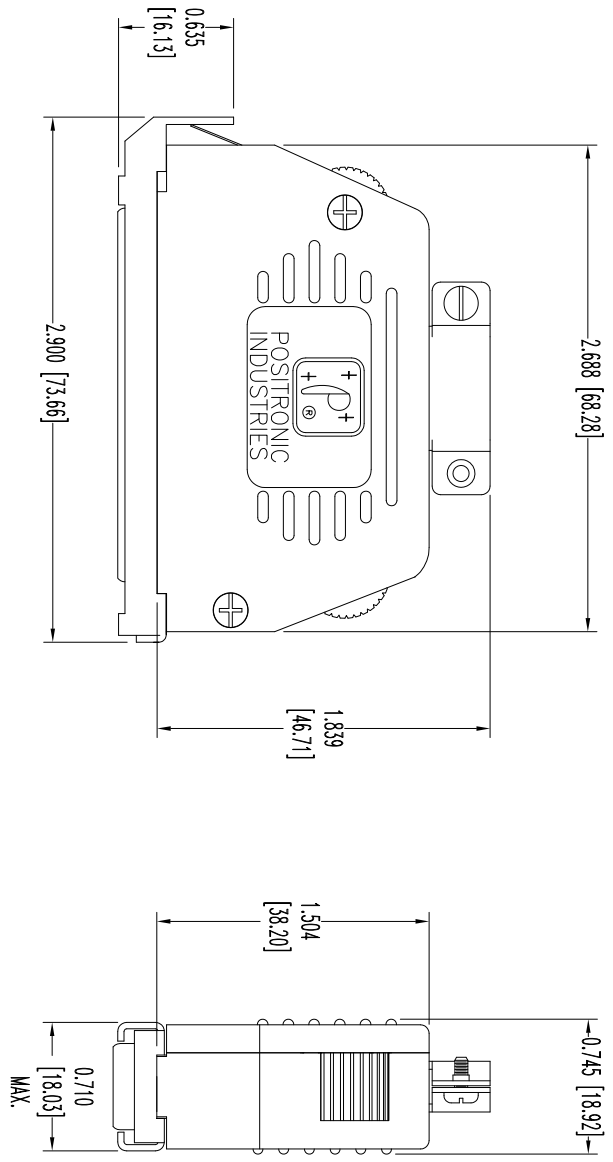

NOTES:

1. MATERIALS AND FINISHES:

INSULATOR: GLASS FILLED POLYESTER PER ASTM-D5927, UL 94V-0, COLOR: BLUE.

SHELLS: STEEL, ZINC PLATE WITH CHROMATE SEAL.

HOOD: GLASS FILLED POLYESTER, UL 94V-0, COLOR: BLACK.

LOCK ARM AND CABLE CLAMPS: STEEL WITH NICKEL PLATE.

LOCK ARM SPRING: BERYLLIUM COPPER WITH NICKEL PLATE.

CABLE CLAMP SCREWS: BRASS, ZINC PLATE WITH CHROMATE SEAL.

SCREWS: STEEL, ZINC PLATE WITH CHROMATE SEAL.

2. DETAILED PRODUCT, MECHANICAL, AND ELECTRICAL INFORMATION IS AVAILABLE IN THE LATEST HIGH DENSITY D-SUB PRODUCT PUBLICATION. VISIT CONNECTPOSITRONIC.COM/PRODUCTS/59/HIGHDENSITY-D-SUB OR CONNECTPOSITRONIC.COM.

3. CONNECTOR IS ROHS COMPLIANT PER ROHS DIRECTIVE 2002/95/EC OF 27 JAN 2003.

4. DIMENSIONS ARE IN INCHES [MILLIMETERS].

DATE	REV	REVISION RECORD	APP	DR	CK
10-18	12	ECO 37417	COLB	BS	COLB

SK14505



POSITRONIC INDUSTRIES INC.
www.connectpositronic.com

FSCM 28198

DECIMAL TOL.	± 0.015 [0.38]	SCALE	N.T.S.	DRAWN BY	B SHELLBUDY
ANGULAR TOL.	± 5°	TITLE	DD SERIES	APPROVED BY	COLB
DATE	10-18-12	DRAWING NUMBER	DD78S00JVL0/AA	REV.	NC