

THIS DRAWING CONTAINS INFORMATION PROPRIETARY TO POSITRONIC INDUSTRIES INC. THE DATA ON THIS DRAWING TO BE RELIABLE SINCE THE USER EMPLOY'S SUCH INFORMATION AT HIS OWN DISCRETION. POSITRONIC INDUSTRIES INC. ASSUMES NO LIABILITY FOR RESULTS OBTAINED OR DAMAGES INCURRED FROM USE OF SUCH INFORMATION IN WHOLE OR IN PART.

SK10273

| DATE | REV | REVISION RECORD | APP | DR | CK |
|----------|-----|-----------------|------|----|------|
| 1-23-09 | NC | ECO 30515 | RCW | YK | TK |
| 4-28-11 | A | ECO 32374 | COLB | BE | SY |
| 11-27-12 | B | ECO 37843 | COLB | BE | COLB |

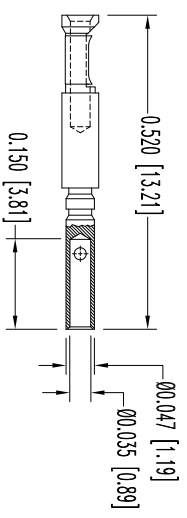
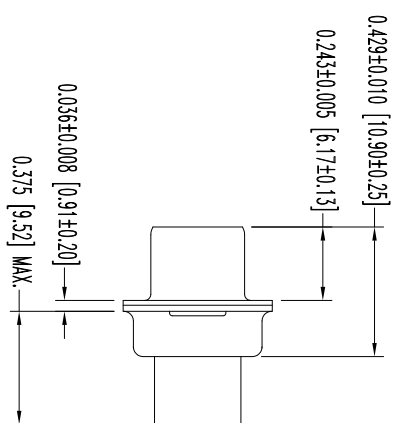
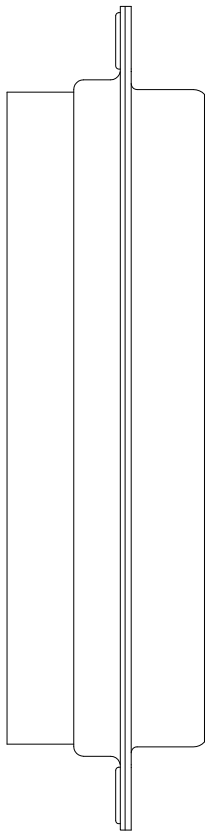
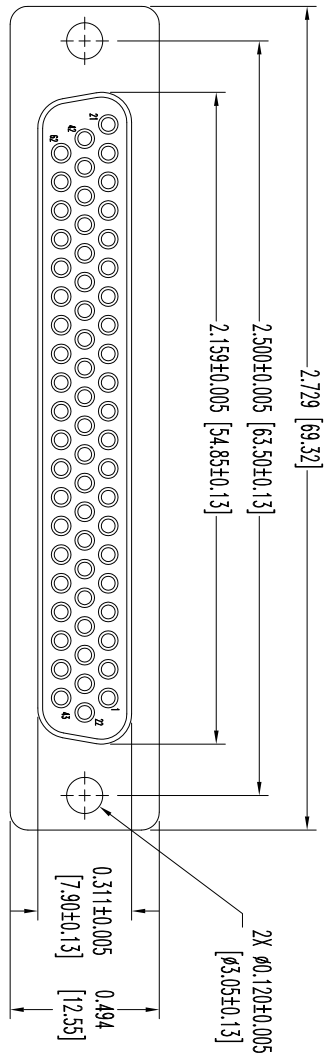

62X FEMALE CONTACT
ENLARGED

- NOTES:
1. MATERIALS AND FINISHES:
INSULATOR: GLASS FILLED POLYESTER PER ASTM D5927, UL 94V-0, BLUE COLOR.
CONTACTS: PRECISION MACHINED COPPER ALLOY, GOLD FLASH OVER NICKEL FINISH.
SHELLS: STEEL, TIN PLATE.
 2. DETAILED PRODUCT, ELECTRICAL, AND MECHANICAL INFORMATION IS AVAILABLE IN THE LATEST HIGH DENSITY D-SUBMINIATURE PRODUCT PUBLICATION. VISIT CONNECTPOSTRONIC.COM/PRODUCTS/59/HIGHDENSITY-D-SUBMINIATURE OR CONNECTPOSTRONIC.COM.
 3. CONNECTORS ARE COMPLIANT TO THE CURRENT ROHS DIRECTIVE.
 4. DIMENSIONS ARE IN INCHES [MILLIMETERS].



POSITRONIC INDUSTRIES INC.
www.connectpositronic.com FSC# 28198

| | | | | |
|--------------------------------|----------------------|---|---------------------------|-----------|
| DECIMAL TOL. ± 0.015 [0.38] | ANGULAR TOL. ± 5° | DATE 1-23-09 | DRAWING NUMBER SK10273 | REV. B |
| | | <p>DD SERIES</p> <p>SCALE: N.T.S.</p> <p>DRAWN BY: YK</p> <p>APPROVED BY: R WILLIAMS</p> <p>DD62S1000X/AA</p> | | |