

THIS DRAWING CONTAINS INFORMATION PROPRIETARY TO POSITRONIC AND ITS SUBSIDIARIES. POSITRONIC BELIEVES THE DATA ON THIS DRAWING TO BE RELIABLE, SINCE THE USER HAS TAKEN THE NECESSARY PRECAUTIONS TO VERIFY THE USER HAS TAKEN THE NECESSARY PRECAUTIONS TO VERIFY THE RESULTS OBTAINED OR DAMAGES INCURRED FROM USE OF SUCH INFORMATION IN WHOLE OR IN PART.

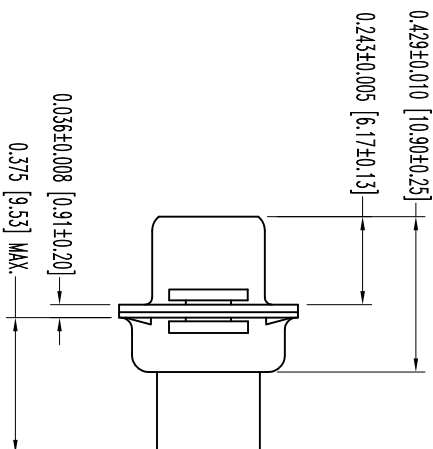
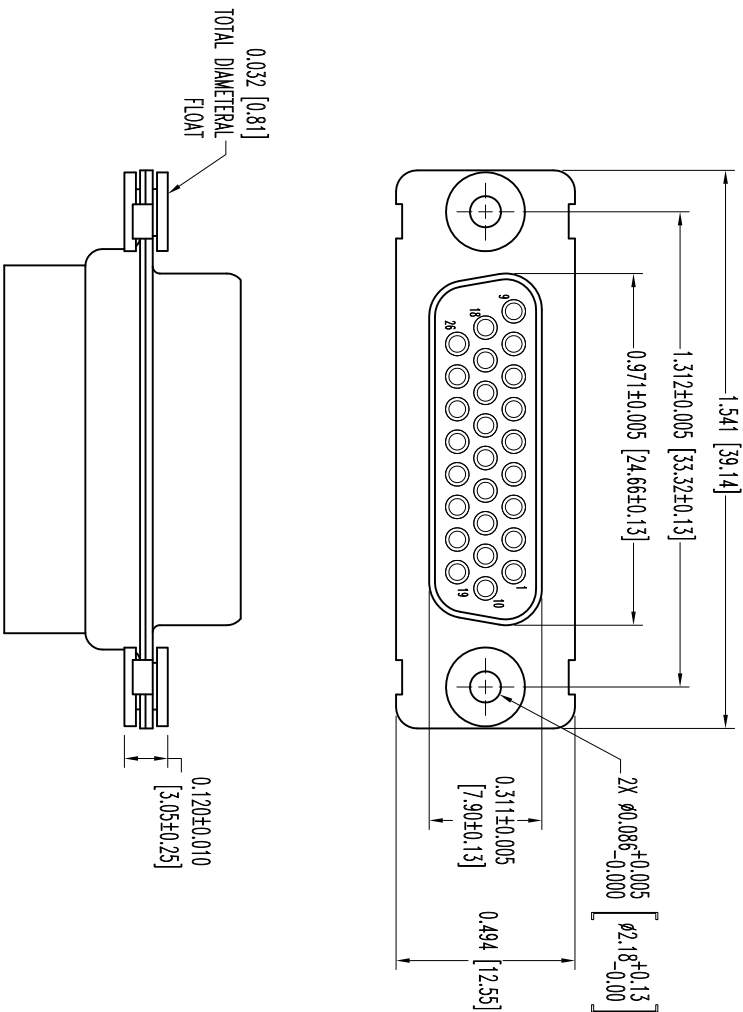

- NOTES:
1. MATERIALS AND FINISHES:  
INSULATOR: GLASS FILLED POLYESTER, UL 94V-0, COLOR: BLUE.  
SHELS: STEEL, ZINC PLATE WITH CHROMATE SEAL.  
FLOAT BUSHINGS: BRASS, ZINC PLATE WITH CHROMATE SEAL.
  2. DETAILED PRODUCT, MECHANICAL, AND ELECTRICAL INFORMATION IS AVAILABLE IN THE LATEST HIGH DENSITY D-SUBMINIATURE PRODUCT PUBLICATION.  
VISIT [CONNECTPOSITRONIC.COM/PRODUCTS/59/HIGHDENSITYD-SUBMINIATURE](http://CONNECTPOSITRONIC.COM/PRODUCTS/59/HIGHDENSITYD-SUBMINIATURE) OR [CONNECTPOSITRONIC.COM](http://CONNECTPOSITRONIC.COM).
  3. DIMENSIONS ARE IN INCHES [MILLIMETERS].

DATE	REV	REVISION RECORD	APP	DR	CK
12-14	NC	ECO 34897	COLM	BS	COLM

SK13313



**POSITRONIC INDUSTRIES INC.**  
www.connectpositronic.com

FSC# 28198



DECIMAL TOL.  
± 0.015 [0.38]

DD SERIES

SCALE  
N.T.S.  
DRAWN BY  
B SHELLYDY  
APPROVED BY  
COLE

DD26S0F000

ANGULAR TOL.  
± 5°

DATE  
12-14-11

DRAWING NUMBER  
SK13313

REV.  
NC