

THIS DRAWING CONTAINS INFORMATION PROPRIETARY TO POSITRONIC INDUSTRIES INC. THE DATA ON THIS DRAWING TO BE RELEASED SINCE THE TECHNICAL INFORMATION IS GIVEN FREE OF CHARGE. THE USER EMPLOYS SUCH INFORMATION AT HIS OWN DISCRETION. POSITRONIC INDUSTRIES INC. ASSUMES NO LIABILITY FOR RESULTS OBTAINED OR DAMAGES INCURRED FROM USE OF SUCH INFORMATION IN WHOLE OR IN PART.

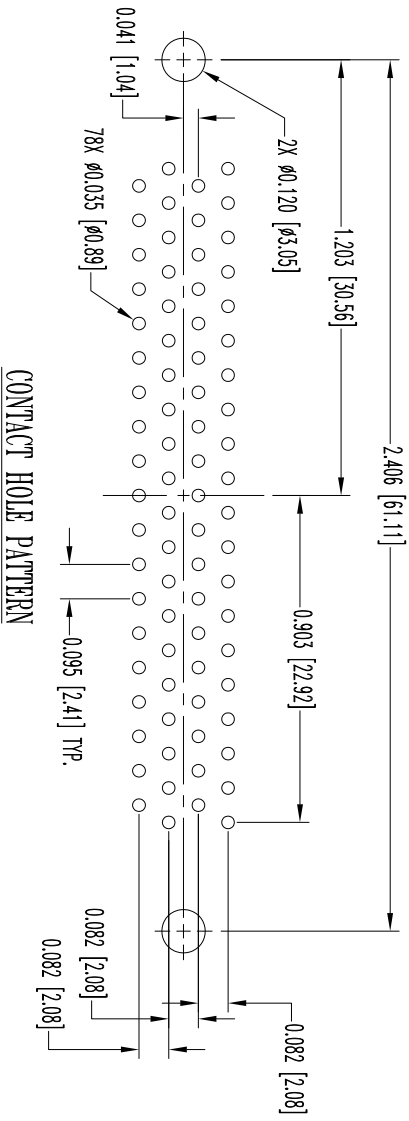
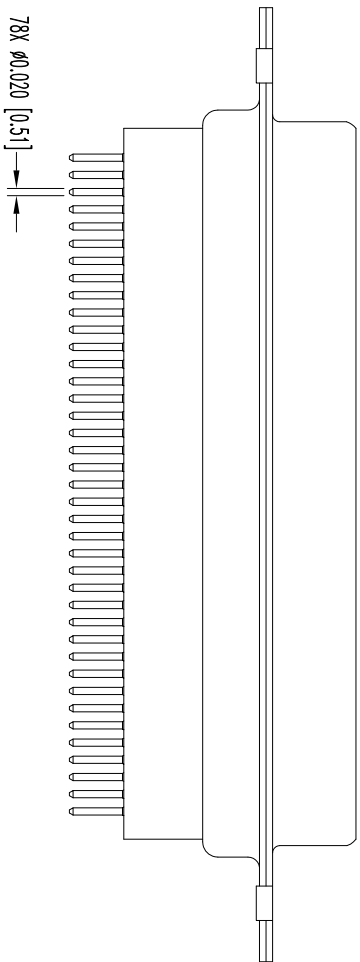
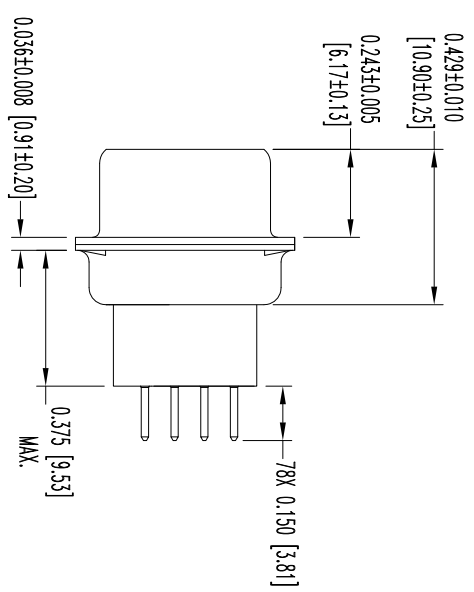
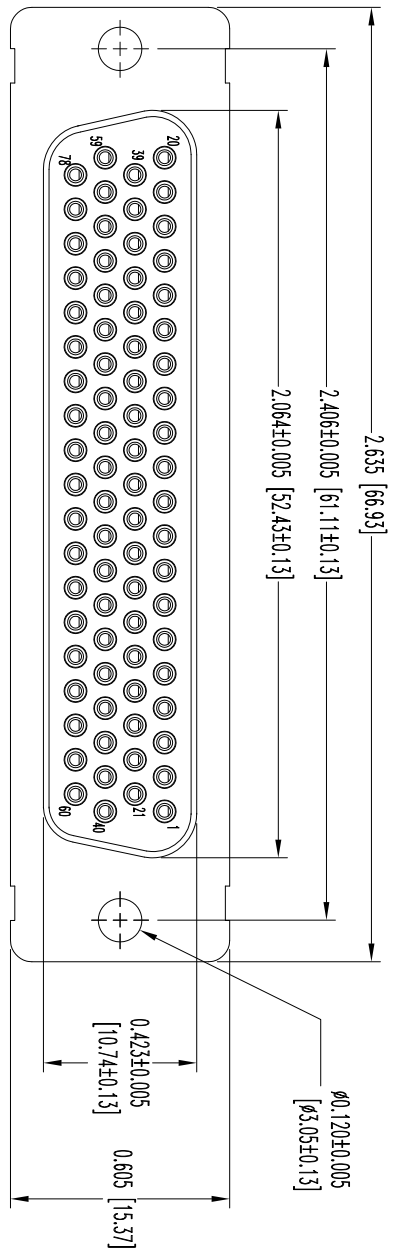

CONTACT HOLE PATTERN

NOTES:

1. MATERIALS AND FINISHES:
INSULATOR: GLASS FILLED POLYESTER PER ASTM-D5927, UL 94V-0, COLOR: BLUE.
CONTACTS: PRECISION MACHINED COPPER ALLOY WITH BERYLLIUM COPPER CLIP, GOLD FLASH OVER NICKEL PLATE.
SHELLS: STAINLESS STEEL, PASSIVATED.
2. DETAILED PRODUCT, MECHANICAL, AND ELECTRICAL INFORMATION IS AVAILABLE IN THE LATEST HIGH DENSITY D-SUB PRODUCT PUBLICATION. VISIT CONNECTPOSTRONIC.COM/PRODUCTS/59/HIGHDENSITYD-SUBMINIATURE-OR-CONNECTPOSTRONIC.COM.
3. CONNECTORS ARE ROHS COMPLIANT PER ROHS DIRECTIVE 2002/95/EC OF 27 JAN 2003.
4. DIMENSIONS ARE IN INCHES [MILLIMETERS].



POSITRONIC INDUSTRIES INC.
www.connectpositronic.com FSCM 28198

DATE	10-23-12	DRAWING NUMBER	SK14514	REV.	NC
SCALE	N.T.S.	DRAWN BY	B STELLARDY	APP	DR
TITLE	DD SERIES	APPROVED BY	COLB	CK	CK
DECIMAL TOL.	± 0.015 [0.38]				
ANGULAR TOL.	± 5°				

DATE	REV	REVISION/RECORD	APP	DR	CK
10-23	NC	ECO 37440	COLB	BS	COLB

SK14514