

THIS DRAWING CONTAINS INFORMATION PROPRIETARY TO POSITRONIC INDUSTRIES INC. THE DATA ON THIS DRAWING TO BE RELIABLE SINCE THE USER EMPLOY'S SUCH INFORMATION AT HIS OWN DISCRETION. POSITRONIC INDUSTRIES INC. ASSUMES NO LIABILITY FOR RESULTS OBTAINED OR DAMAGES INCURRED FROM USE OF SUCH INFORMATION IN WHOLE OR IN PART.

SK13029

DATE	REV	REVISION RECORD	APP	DR	CK
11-7-11	NC	ECO 34705	COLB	LO	COLB
10-22-13	A	ECO 41100	COLB	BE	COLB

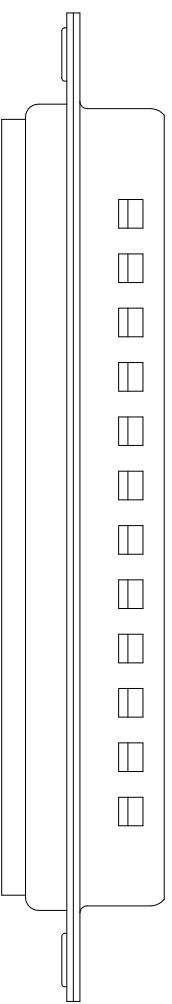
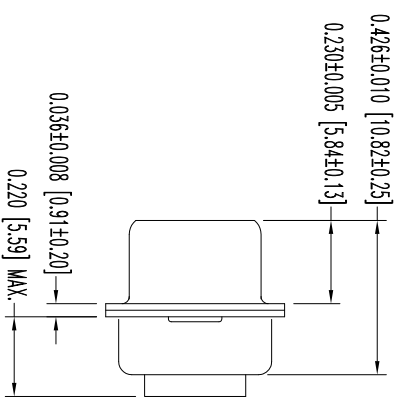
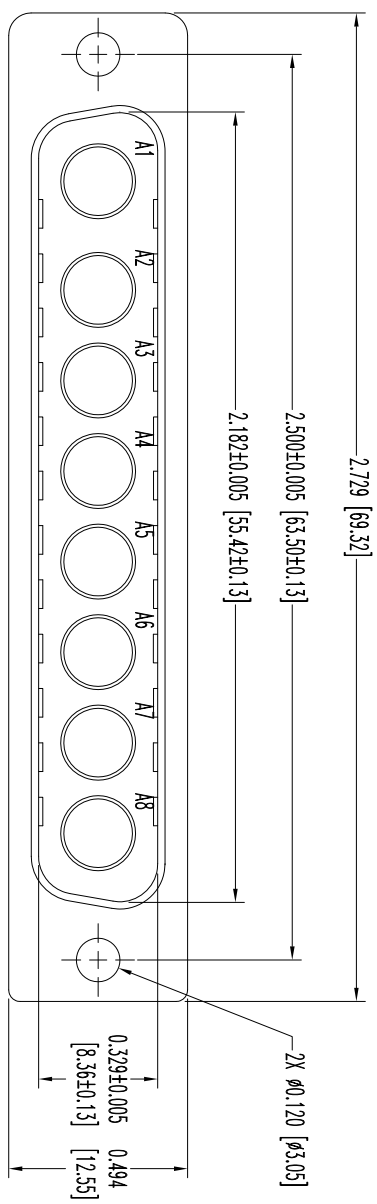

NOTES:

1. MATERIALS AND FINISHES:  
INSULATOR: GLASS FILLED POLYESTER PER ASTM D5927, UL 94V-0, BLUE COLOR.  
SHELLS: STEEL, TIN PLATE AND DIMPLED.
2. DETAILED PRODUCT, MECHANICAL AND ELECTRICAL INFORMATION IS AVAILABLE IN THE LATEST STANDARD DENSITY COMBO-D PRODUCT PUBLICATION. VISIT [CONNECTPOSTRONIC.COM/PRODUCTS/1/STANDARDENSITYCOMBO-D](http://CONNECTPOSTRONIC.COM/PRODUCTS/1/STANDARDENSITYCOMBO-D) OR [CONNECTPOSTRONIC.COM](http://CONNECTPOSTRONIC.COM)
3. CONNECTORS ARE COMPLIANT TO THE CURRENT ROHS DIRECTIVE.
4. DIMENSIONS ARE IN INCHES [MILLIMETERS].



**POSITRONIC INDUSTRIES INC.**  
www.connectpositronic.com

SCALE: N.T.S.  
DRAWN BY: L. OWENS  
APPROVED BY: COLB

TITLE: CBD SERIES  
FSC# 28198  
CBB8W8M0000Z/AA

DATE: 11-7-11  
DRAWING NUMBER: SK13029  
ANGULAR TOL. ± 5°  
DECIMAL TOL. ± 0.015 [0.38]  
REV: A