

THIS DRAWING CONTAINS INFORMATION PROPRIETARY TO POSITRONIC INDUSTRIES. THE DATA ON THIS DRAWING TO BE RELEASED SINCE THE USER EMPLOYS SUCH INFORMATION AT HIS OWN DISCRETION. RESULTS OBTAINED OR DAMAGES INCURRED FROM USE OF SUCH INFORMATION IN WHOLE OR IN PART.

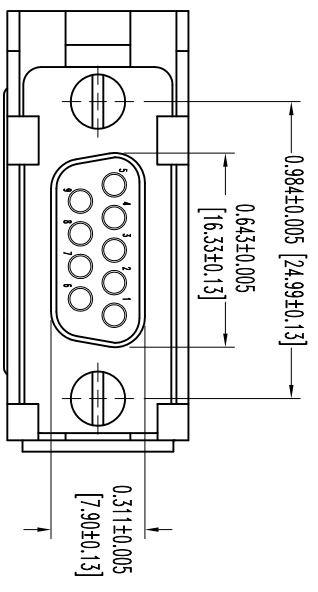
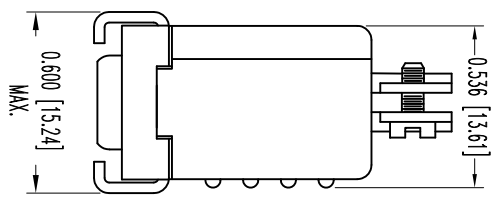
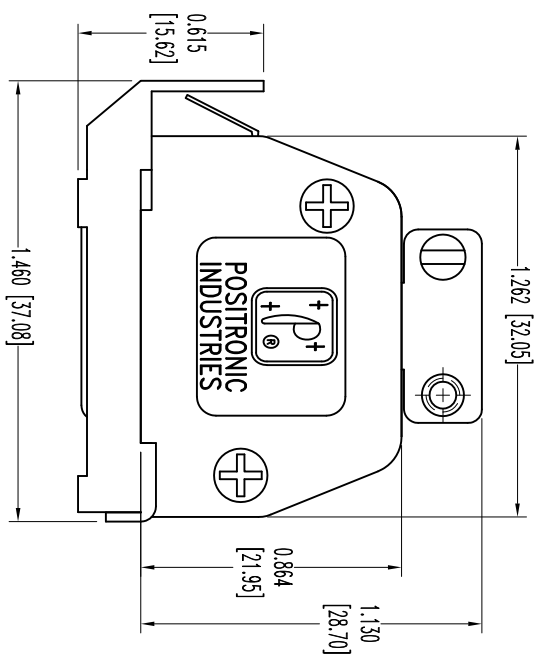

NOTES:

1. MATERIALS AND FINISHES:

INSULATOR: GLASS FILLED DAP PER ASTM-D3948, SDG-F, UL 94V-0, COLOR: GREEN.

SHELLS: STEEL, ZINC PLATE WITH CHROMATE SEAL.

HOOD AND COVER: GLASS FILLED NYLON, UL 94V-0, COLOR: BLACK.

LOCK LEVER AND CABLE CLAMPS: STEEL WITH NICKEL PLATE.

CABLE CLAMP SCREWS: BRASS, ZINC PLATE WITH CHROMATE SEAL.

SCREWS: STEEL, ZINC PLATE WITH CHROMATE SEAL.

2. DETAILED PRODUCT, MECHANICAL, AND ELECTRICAL INFORMATION IS AVAILABLE IN THE LATEST STANDARD DENSITY D-SUB PRODUCT PUBLICATION. VISIT CONNECTPOSITRONIC.COM/PRODUCTS/45/STANDARDENSITY-D-SUBMINIATURE OR CONNECTPOSITRONIC.COM.

3. DIMENSIONS ARE IN INCHES [MILLIMETERS].

DATE	REV	REVISION RECORD	APP	DR	CK
6-22	11	ECO 34174	COLE	BS	COLE

SK12429



POSITRONIC INDUSTRIES INC.
www.connectpositronic.com

DECIMAL TOL.	± 0.015 [0.38]	ANGULAR TOL.	± 5°
TITLE	RD SERIES	SCALE	N.T.S.
DATE	6-22-11	DRAWING NUMBER	SK12429
REV.	NC	DRAWN BY	B SHELLADY
		APPROVED BY	COLE
		FSC#	28198