

THIS DRAWING CONTAINS INFORMATION PROPRIETARY TO POSITRONIC AND ITS SUBSIDIARIES. POSITRONIC BELIEVES THE DATA ON THIS DRAWING TO BE RELIABLE. SINCE THE USER SHALL BE RESPONSIBLE FOR THE PROPER SELECTION AND RISK POSITRONIC ASSUMES NO RESPONSIBILITY FOR SUCH INFORMATION IN WHOLE OR IN PART.

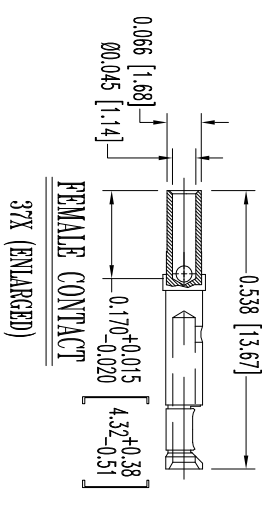
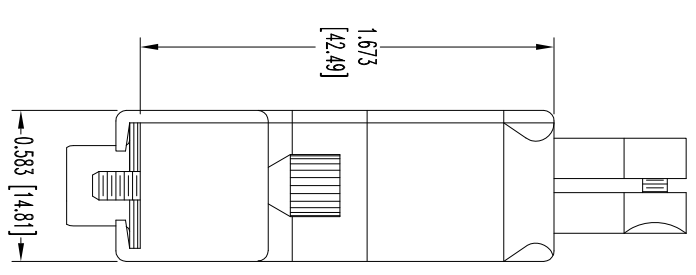
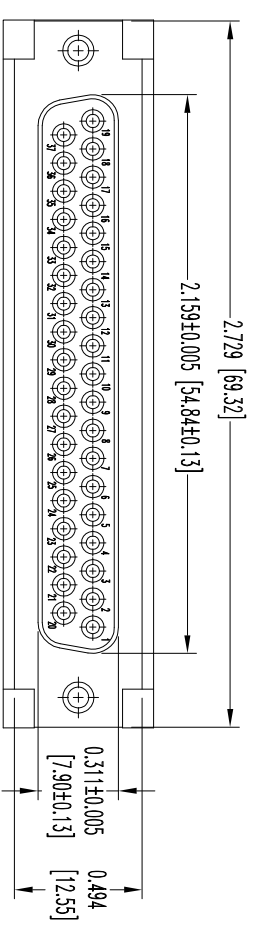
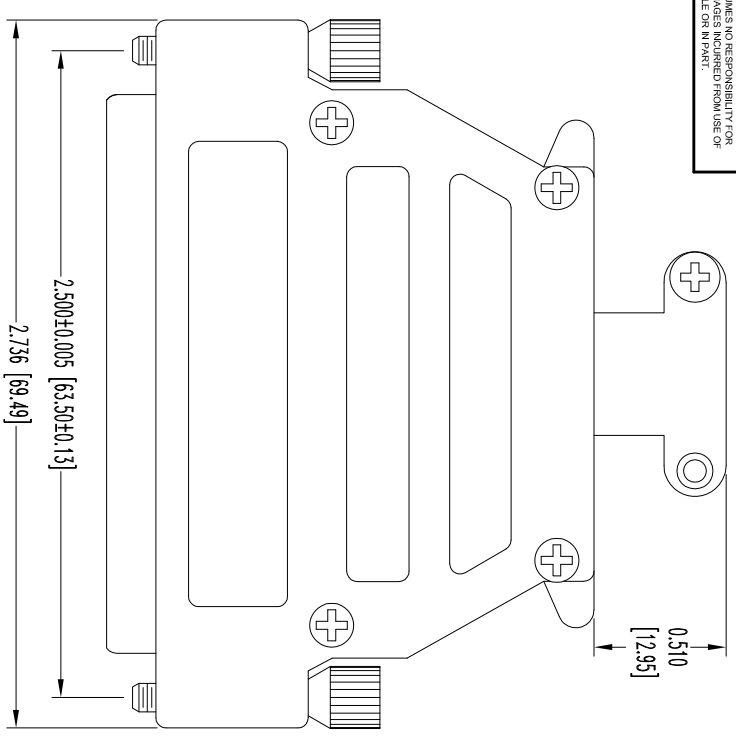

- NOTES:
1. MATERIALS AND FINISHES:
INSULATOR: GLASS FILLED DAP PER ASTM-D-5948, SDG-F, UL 94V-0, COLOR GREEN.
CONTACTS: PRECISION MACHINED HIGH TENSILE COPPER ALLOY WITH BERYLLIUM COPPER CLIP, GOLD FLASH OVER NICKEL PLATE.
SHELLS: STEEL WITH ZINC PLATE AND DICHROMATE SEAL.
HOOD: ZINC, DIE CAST.
JACKSCREWS: STEEL WITH ZINC PLATE AND DICHROMATE SEAL.
 2. ELECTRICAL CHARACTERISTICS:
CONTACT CURRENT RATING: 7.5 AMPERES NOMINAL.
INITIAL CONTACT RESISTANCE: 0.005 OHMS MAXIMUM.
INSULATOR RESISTANCE: 5 G OHMS.
WORKING VOLTAGE: 300 V r.m.s.
 3. TEMPERATURE RANGE: -55°C TO +125°C.
 4. DIMENSIONS ARE IN INCHES [MILLIMETERS].

DATE	REV	REVISION/RECORD	APP	DR	CK
5-21-09	NC	ECO 31051	RCW	ME	TK

SK10719

		POSITRONIC INDUSTRIES INC. www.connectpositronic.com		FSCM 28198			
		RD SPRIRS	SCALE N.T.S.	DRAWN BY ME	APPROVED BY R WILLIAMS	DATE 5-21-09	DRAWING NUMBER SK10719
DECIMAL TOL. ± 0.015 [0.38]		TITLE RD37S10GE0		WIP # 3429		ANGULAR TOL. ± 9°	