

THIS DRAWING CONTAINS INFORMATION PROPRIETARY TO POSITRONIC, INC. ANY REPRODUCTION OR UNAUTHORIZED USE OF THIS DRAWING IS EXPRESSLY PROHIBITED, EXCEPT AS POSITRONIC, INC. MAY OTHERWISE AGREE IN WRITING.

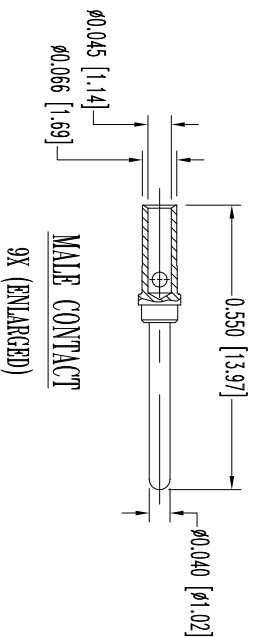
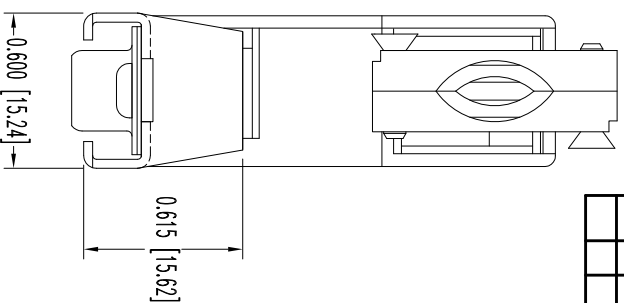
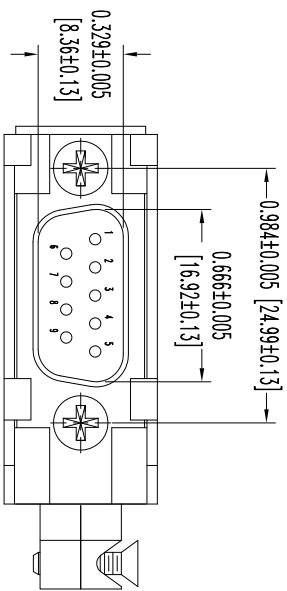
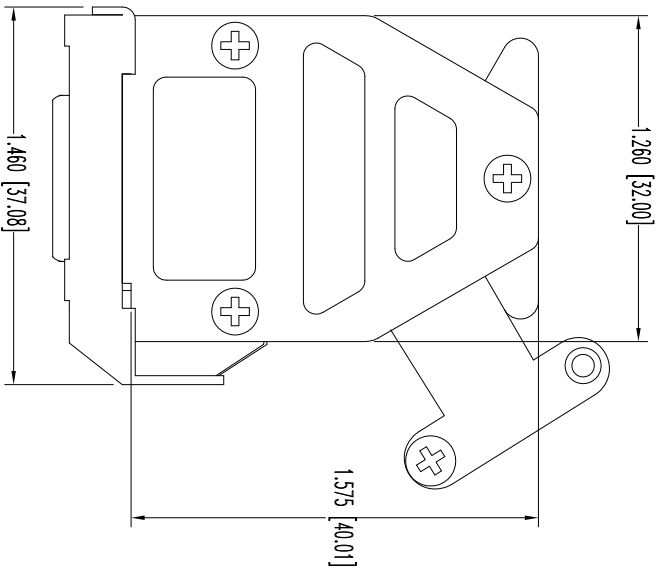

NOTES:

1. MATERIALS AND FINISHES:
INSULATOR: GLASS FILLED DAP PER ASTM-D5948, SDG-F, UL 94V-0, COLOR: GREEN.
CONTACTS: PRECISION MACHINED COPPER ALLOY, GOLD FLASH OVER NICKEL PLATE.
SHELLS: STEEL, ZINC PLATE WITH CHROMATE SEAL.
HOOD AND CABLE CLAMPS: DIE CAST ZINC.
LOCK LEVER AND SCREWS: STEEL WITH NICKEL PLATE.
2. DETAILED PRODUCT, MECHANICAL, AND ELECTRICAL INFORMATION IS AVAILABLE IN THE LATEST STANDARD DENSITY D-SUB PRODUCT PUBLICATION. VISIT CONNECTPOSITRONIC.COM/PRODUCTS/45/STANDARDENSITY-D-SUBMINIATURE-OR-CONNECTPOSITRONIC.COM.
3. DIMENSIONS ARE IN INCHES [MILLIMETERS].

DATE	REV	REVISION RECORD	APP	DR	CK
4-10-12	NC	ECO 35489	COLF	BS	COLF

SK14003



POSITRONIC INDUSTRIES INC.
SPRINGFIELD, MISSOURI 65801

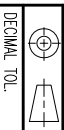

DECIMAL TOL. ± 0.015 [0.38]
ANGULAR TOL. ± 5°

RD9M10GY1.0
RD SERIES
SCALE N.T.S.
DRAWN BY B SHELLBY
APPROVED BY COLF

DATE 4-10-12
DRAWING NUMBER SK14003
REV. NC