

THIS DRAWING CONTAINS INFORMATION PROPRIETARY TO POSITRONIC AND ITS SUBSIDIARIES. POSITRONIC BELIEVES THE DATA ON THIS DRAWING TO BE RELIABLE, SINCE THE USER HAS BEEN ADVISED OF THE LIMITATIONS OF THE DATA AND RISK. POSITRONIC ASSUMES NO RESPONSIBILITY FOR SUCH INFORMATION IN WHOLE OR IN PART.

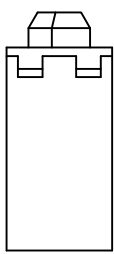
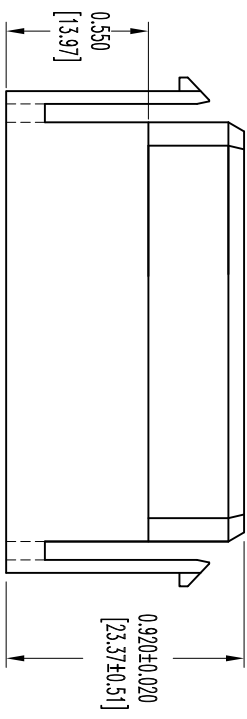
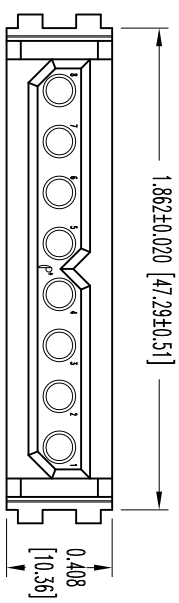

DATE	REV	REVISION RECORD	APP	DR	OK
9-8-05	NC	ECO 24611	RW	YK	TK
3-7-12	A	ECO 35339	JOLE	MP	JOLE

SK6550

- NOTES:
1. MATERIALS AND FINISHES:
INSULATOR: GLASS FILLED POLYESTER, UL 94V-0, COLOR BLUE.
 2. DETAILED PRODUCT, MECHANICAL, AND ELECTRICAL INFORMATION IS AVAILABLE IN THE LATEST POWER CONNECTION SYSTEMS PRODUCT PUBLICATION. VISIT CONNECTPOSITRONIC.COM/PRODUCTS/20/POWERCONNECTIONSYSTEMS OR CONNECTPOSITRONIC.COM.
 3. CONNECTORS ARE ROHS COMPLIANT PER ROHS DIRECTIVE 2002/95/EC OF 27 JAN 2003.
 4. DIMENSIONS ARE IN INCHES [MILLIMETERS].

		POSITRONIC INDUSTRIES INC. www.connectpositronic.com		FSC# 28198	
DECIMAL TOL. ± 0.015 [0.38]	ANGULAR TOL. $\pm 5^\circ$	TITLE PCS SERIES	SCALE N.T.S.	DRAWN BY YK	APPROVED BY R. WILLIAMS
DATE 9-8-05	DRAWING NUMBER SK6550	PLA08F0000/AA			