

THIS DRAWING CONTAINS INFORMATION PROPRIETARY TO POSITRONIC AND ITS SUBSIDIARIES. POSITRONIC BELIEVES THE DATA ON THIS DRAWING TO BE RELIABLE, SINCE THE USER HAS NOTIFIED POSITRONIC OF ANY DISCREPANCY. POSITRONIC ASSUMES NO RESPONSIBILITY FOR RESULTS OBTAINED OR DAMAGES INCURRED FROM USE OF SUCH INFORMATION IN WHOLE OR IN PART.

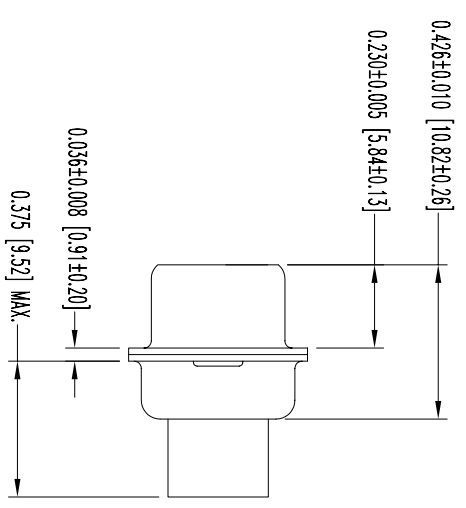
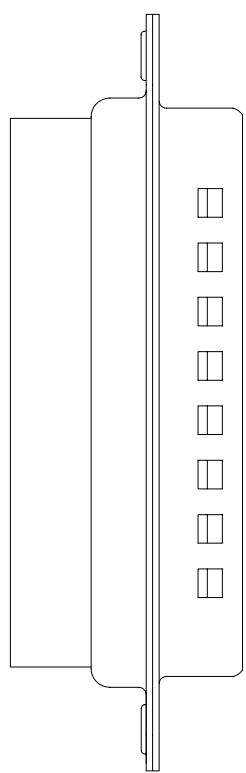
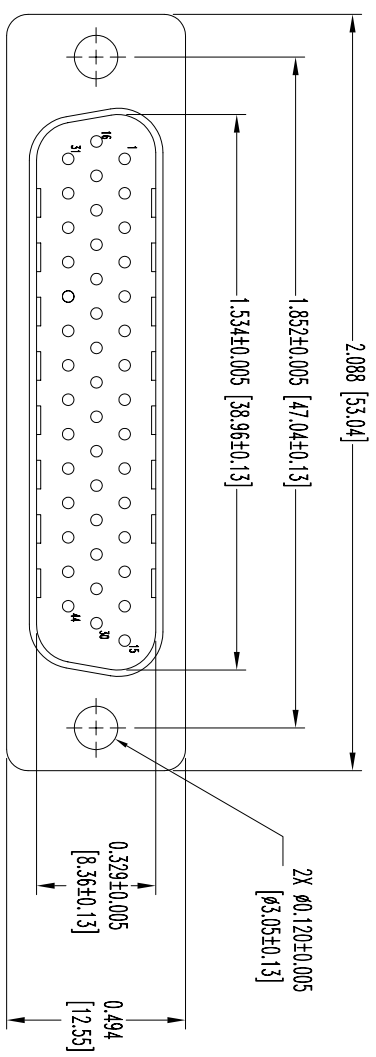

- NOTES:
1. MATERIALS AND FINISHES:
INSULATOR: GLASS FILLED PESTER PER MIL-M-24519, UL 94V-0, COLOR BLUE.
SHELLS: STEEL, TIN PLATED AND DIMPLED.
 2. ELECTRICAL CHARACTERISTICS:
INSULATION RESISTANCE: 5 G OHMS.
WORKING VOLTAGE: 300 V r.m.s.
 3. TEMPERATURE RANGE: -55°C TO +125°C.
 4. CONNECTORS ARE ROHS COMPLIANT PER ROHS DIRECTIVE 2002/95/EC OF 27 JAN 2003.
 5. DIMENSIONS ARE IN INCHES [MILLIMETERS].

DATE	REV	REVISION/RECORD	APP	DR	CK
1-21-08	NC	ECO 28888		YK	TK

SK9193

		POSITRONIC INDUSTRIES INC. www.connectpositronic.com		FSCM 28198	
		DD SERIES	SCALE N.T.S.	DRAWN BY YK	
DECIMAL TOL. ± 0.015 [0.38]	TITLE DD44M0000Z/AA	DATE 1-21-08	DRAWING NUMBER SK9193	REV. NC	
ANGULAR TOL. ± 5°					