

## CRIMP CONTACTS CLOSED CRIMP BARREL

### FEMALE CONTACT

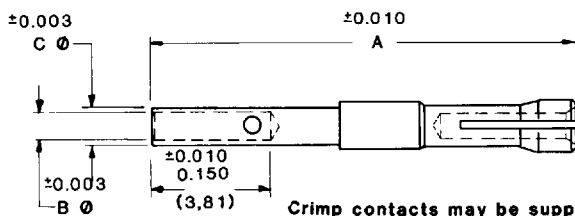

PART NO.	WIRE SIZE AWG/(mm <sup>2</sup> )	A	B Ø	C Ø
FC8122D	22/24/26/28/30 (0,3/0,25/0,12/0,08/0,05)	0.529 (13,44)	0.035 (0,89)	0.047 (1,19)

Material - Phosphor Bronze  
Plating - Gold flash over Nickel

### MALE CONTACT

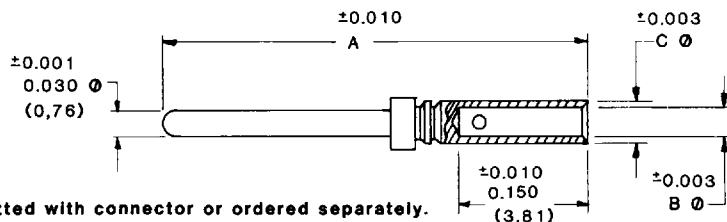

PART NO.	WIRE SIZE AWG/(mm <sup>2</sup> )	A	B Ø	C Ø
MC8122D	22/24/26/28/30 (0,30/0,25/0,12/0,08/0,05)	0.531 (13,49)	0.035 (0,89)	0.047 (1,19)

Material - Brass  
Plating - Gold flash over Nickel

## SOLDER CONTACTS

### FEMALE CONTACT

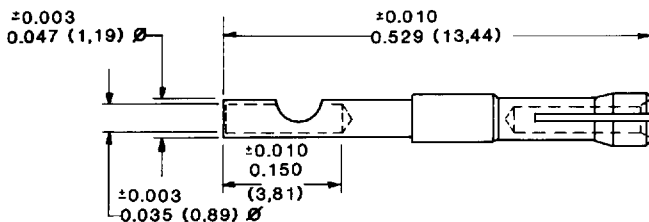

#### PART NUMBER: FS8122D

Material- Phosphor Bronze  
Plating- Gold flash over Nickel

### MALE CONTACT

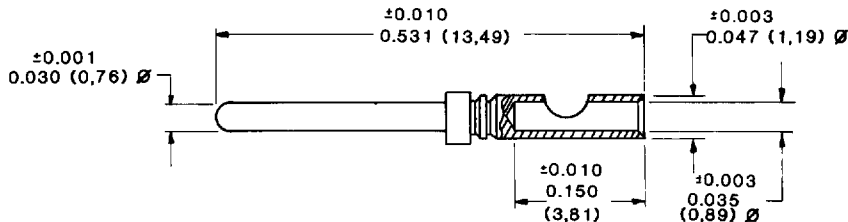

#### PART NUMBER: MS8122D

Material- Brass  
Plating- Gold flash over Nickel

Solder contacts may be supplied kitted with connector or ordered separately.

## PRESS FIT CONNECTOR

For press fit contacts,  
specify code 9 in step 4  
of ordering information.

Typical part number: ODD44F9S0V3X

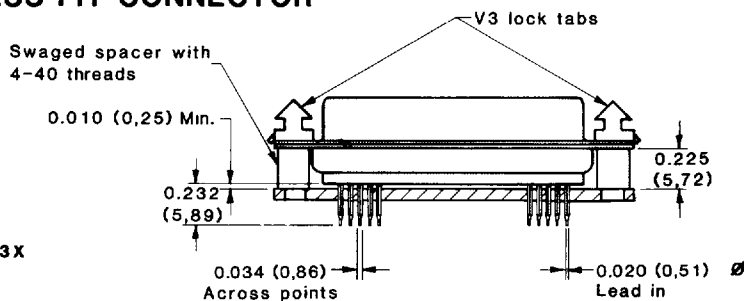

## STRAIGHT PRINTED BOARD MOUNT CONNECTOR

CODE No.	L
3	0.150 (3,81)
32	0.300 (7,62)

For straight printed  
board mount contacts  
specify code no. in step  
4 of ordering information

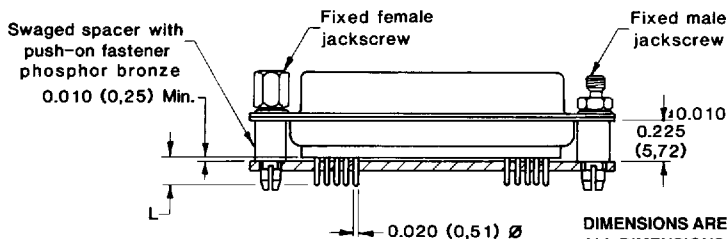

DIMENSIONS ARE IN INCHES (MILLIMETERS)  
ALL DIMENSIONS SUBJECT TO CHANGE

Typical part number: ODD62F3S60T6X

# ODD Series

## PROFESSIONAL QUALITY, REMOVABLE CONTACT, HIGH DENSITY SUBMINIATURE-D CONNECTORS FOR SHELTERED INDOOR/OUTDOOR ENVIRONMENTAL APPLICATIONS

Size 22 Contacts,  
Removable Crimp and  
Fixed Press-Fit and  
Solder Printed Board Mount  
Professional Quality

U.L. Recognized,  
File #E49351

CSA Recognized  
File #LR54219

Telecommunication  
U.L. File #14098

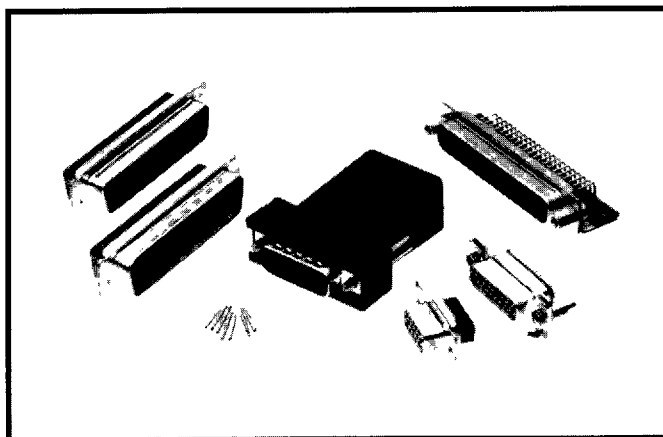

ODD Series connectors are low cost, professional quality, high density rectangular connectors recommended for use in sheltered, non-corrosive indoor environments having normal ventilation.

ODD Series connectors utilize precision machined, removable contacts having closed barrel crimp terminations and solder wire terminations. For printed board mount applications, press-fit and straight solder printed board mount and 90° angled solder terminations are available.

Female removable contacts feature a rugged Robi-D open entry design. Female, fixed contacts for board mounted applications

feature both rugged Robi-D design and standard open entry design, available to customer requirements.

Six standard contact variants are offered in arrangements of 15, 26, 44, 62, 78, and 104 contacts. ODD Series connectors are mateable and compatible with other high density D-subminiature connectors conforming to MIL-C-24308, and are U.L. and CSA recognized.

ODD Series connectors are widely used in computer and industrial control applications.

### ODD SERIES TECHNICAL CHARACTERISTICS

#### MATERIALS AND FINISHES:

<b>Insulators:</b>	Glass filled polyester per MIL-M-24519, UL 94V-0, black color.
<b>Contacts:</b>	Male contacts — precision machined brass alloy or phosphor bronze. Female contacts — precision machined high tensile phosphor bronze.
<b>Contact Plating:</b>	Professional quality — gold flash over nickel plate. Other finishes available upon request.
<b>Shells:</b>	Steel or brass with tin plate, zinc plate with dichromate seal.
<b>Mounting Spacers:</b>	Nylon, plastic and brass, zinc plate with dichromate seal.
<b>Vibration Lock Systems:</b>	Slide lock and lock tabs, steel with nickel plate.
<b>Push-On Fasteners:</b>	Phosphor bronze or beryllium copper with tin plate.
<b>JackscREW Systems:</b>	Steel with zinc plate and dichromate seal, or clear zinc plate.
<b>Hoods:</b>	Thermoplastic UL 94V-0. Composite, brass or steel with zinc plate and dichromate seal.

#### ELECTRICAL CHARACTERISTICS:

<b>Contact Current Rating:</b>	5 amperes nominal.
<b>Initial Contact Resistance:</b>	0.010 ohms maximum.
<b>Proof Voltage:</b>	1000 V. r.m.s.
<b>Insulator Resistance:</b>	5 G ohms.
<b>Clearance and Creepage Distance (minimum):</b>	0.042 inch (1.06mm).
<b>Working Voltage:</b>	300 V r.m.s.

#### CLIMATIC CHARACTERISTICS:

<b>Temperature Range:</b>	-55°C to +125°C.
<b>Damp Heat, Steady State:</b>	10 days.

#### MECHANICAL CHARACTERISTICS:

<b>Removable Contacts:</b>	Insert contact to rear face of insulator and release from rear face of insulator. Size 22 contact, male-0.030 inch (0.76mm) diameter; female removable contacts feature a rugged Robi-D open entry design.
<b>Fixed Contacts, Board Mounted Applications:</b>	Female contact — both rugged Robi-D design and standard open entry design available to customer requirements. 9 lbs. (40 N).
<b>Contact Retention In Insulator:</b>	
<b>Contact Terminations:</b>	Closed barrel crimp, wire sizes 22 AWG (0.3mm <sup>2</sup> ) through 30 AWG (0.05mm <sup>2</sup> ). Solder wire, 0.035 inch (0.89mm) hole diameter for 22 AWG (0.3mm <sup>2</sup> ) wire maximum. 0.020 inch (0.5mm) or 0.030 inch (0.76mm) diameter straight and 90° printed board mount contact terminations. Press-Fit — 0.034 inch (0.86mm) across points with 0.020 inch (0.51mm) lead. Solid metal construction.
<b>Shells:</b>	Male shells may be dimpled for EMI/ESD ground paths.
<b>Polarization:</b>	Trapezoidally shaped shells and polarized jackscrews.
<b>Mounting To Angle Brackets:</b>	JackscREWS and riveted fasteners with 0.120 inch (3.05mm) clearance hole, and threaded riveted fasteners with 4-40 threads and nylon lock inserts.
<b>Mounting To Printed Board:</b>	Rapid installation push-on fasteners and mounting posts.
<b>Locking Systems:</b>	JackscREWS and vibration locking systems.
<b>Mechanical Operations:</b>	500 operations minimum per IEC 512-5.