

CRIMP CONTACTS CLOSED CRIMP BARREL

FEMALE CONTACT ("CLOSED ENTRY" DESIGN)

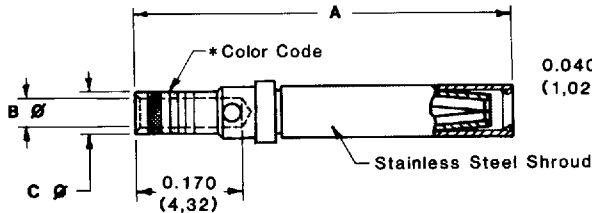

Material - Leaded nickel copper.

Plating - Gold flash over nickel or 0.000050 inch (1,25μ) gold over copper for military specification contacts.

*Color Code - ORANGE/BLUE/GRAY for military specification contacts.

PART NO.	WIRE SIZE AWG/(mm ²)	A	B ∅	C ∅
FC6020D	20/22/24 (0,5/0,3/0,25)	0.538 (13,67)	0.044 (1,12)	0.066 (1,68)
FC6026D	26/28/30 (0,12/0,08/0,05)	0.538 (13,67)	0.027 (0,69)	0.066 (1,68)
*M39029/63-368	20/22/24 (0,5/0,3/0,25)	0.538 (13,67)	0.044 (1,12)	0.066 (1,68)

MALE CONTACT

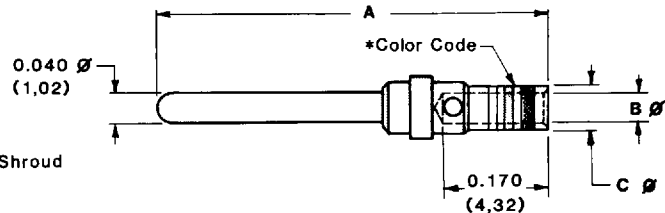

Material - Brass.

Plating - Gold flash over nickel or 0.000050 inch (1,25μ) gold over copper for military specification contacts.

*Color Code - ORANGE/BLUE/WHITE for military specification contacts.

PART NO.	WIRE SIZE AWG/(mm ²)	A	B ∅	C ∅
MC6020D	20/22/24 (0,5/0,3/0,25)	0.550 (13,97)	0.044 (1,12)	0.066 (1,68)
MC6026D	26/28/30 (0,12/0,08/0,05)	0.550 (13,97)	0.027 (0,69)	0.066 (1,68)
*M39029/64-369	20/22/24 (0,5/0,3/0,25)	0.550 (13,97)	0.044 (1,12)	0.066 (1,68)

Crimp contacts may be supplied kitted with connector or ordered separately.
See page 63 of RD series section for crimp tool information.

FEMALE CONTACT ("ROBI-D OPEN ENTRY" DESIGN)

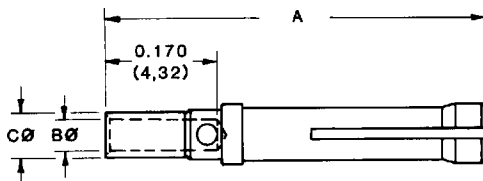

Material - Phosphor bronze.

Plating - Gold flash over nickel

PART NO.	WIRE SIZE AWG/(mm ²)	A	B ∅	C ∅
FC6520D	20/22/24 (0,5/0,3/0,25)	0.538 (13,67)	0.044 (1,12)	0.066 (1,68)

MALE CONTACT 18 AWG (1,0mm²) max.

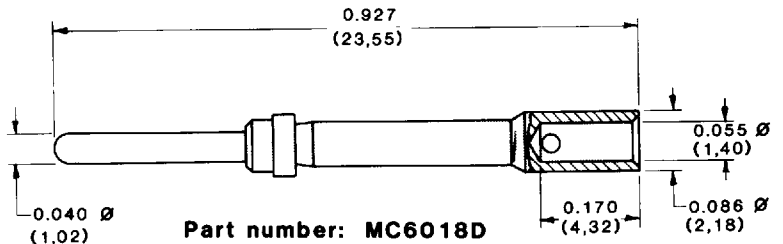

Material - Brass.

Plating - Gold flash over nickel

FEMALE CONTACT ("CLOSED ENTRY" DESIGN) 18 AWG (1,0mm²) max.

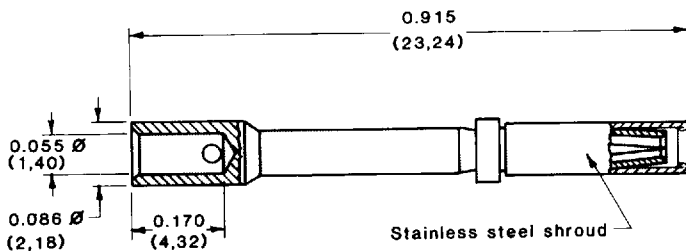

Part number: FC6018D

Material - Phosphor bronze.

Plating - Gold flash over nickel..

REELS FOR AUTOMATIC FEED PNEUMATIC CRIMP TOOLS

Contacts may be supplied in plastic carriers, packaged in reels holding 2,000 contacts for use with the automatic feed pneumatic crimp tools, catalog part number 9550-1. The same type carrier is used for both male and female contacts.

All male and female crimp contacts can be ordered in reels by adding letter "R" after the contact part number, such as MC6020DR for a male contact and FC6026DR for a female contact.

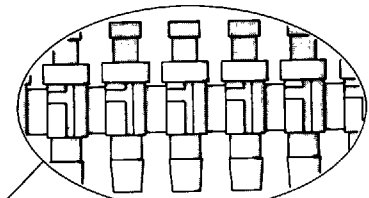
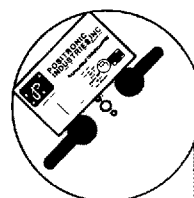

Enlarged section of plastic contact carriers

DIMENSIONS ARE IN INCHES (MILLIMETERS)
ALL DIMENSIONS SUBJECT TO CHANGE

For RD crimping information,
see SD Series, p. 16 and 17.

Rhapso-D Series

MILITARY QUALITY, CRIMP REMOVABLE CONTACT, SUBMINIATURE-D CONNECTORS FOR MILITARY AND SEVERE INDUSTRIAL ENVIRONMENTAL APPLICATIONS

Size 20 Contacts,
Crimp Removable

Military/Industrial
Quality Connectors

IEC Publication 807-3
Performance Level One

MIL-C-24308 and MIL-C-39029

U.L. Recognized File #E49351

CSA Recognized File # LR54219

Telecommunication
U.L. File #14098

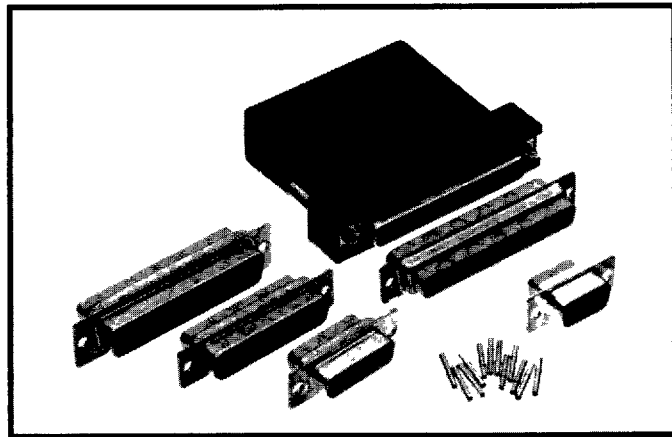

Rhapso-D Series connectors are Military/Industrial quality rectangular connectors designed for use in sheltered, mildly corrosive environments having a wide range of temperature, pressure and humidity changes. These crimp removable contact connectors are qualified to MIL-C-24308 and MIL-C-39029, and will meet the performance requirements of IEC 807-3, Performance Level One.

Rhapso-D Series connectors utilize precision machined contacts with closed barrel, crimp terminations. The female contact features a rugged closed entry design contact with

stainless steel shroud. A Robi-D open entry female contact is also available.

Six standard connector variants are offered in arrangements of 9, 15, 25, 29, 37 and 50 contacts. Rhapsody-D Series connectors are mateable and compatible with all D-Subminiature connectors conforming to MIL-C-24308, IEC 807-2 and IEC 807-3.

A wide assortment of cable support hoods and locking systems is available from stock.

Rhapso-D Series connectors conform to EIA RS 232 and RS 449, and CCITT X.24 interface connection requirements.

RHAPSO-D SERIES TECHNICAL CHARACTERISTICS

MATERIALS AND FINISHES:

Insulator:	Glass filled DAP per MIL-M-14, SDG-F, UL 94V-0, green color.
Contacts:	Male contacts — precision machined brass alloy. Female contacts — precision machined high tensile copper alloy with stainless steel shroud or open entry Robi-D design.
Contact Plating:	Military performance — 0.000050 inch (1,25 microns) gold over copper plate. Industrial performance — gold flash over nickel plate.
Shells:	Steel or brass with tin plate; zinc and cadmium plate with dichromate seal, stainless steel, passivated.
Mounting Spacers:	Brass, zinc plate with dichromate seal.
JackscREW Systems:	Steel with zinc plate and dichromate seal, or clear zinc plate.
Vibration Lock Systems:	Slide lock and lock tabs, steel with nickel plate.
Hoods:	Thermoplastic UL 94V-0. Composite, brass or steel with zinc plate and dichromate seal.

ELECTRICAL CHARACTERISTICS:

Contact Current Rating:	7.5 amperes nominal.
Initial Contact Resistance:	0.005 ohms maximum.
Proof Voltage:	1000 V r.m.s.
Insulator Resistance:	5 G ohms.
Clearance and Creepage Distance (minimum):	0.039 inch (1,0mm).
Working Voltage:	300 V r.m.s.

CLIMATIC CHARACTERISTICS:

Temperature Range:	-55°C to +125°C
Damp Heat, Steady State:	21 days.

MECHANICAL CHARACTERISTICS:

Removable Contacts:	Insert contact to rear face of insulator and release from rear face of insulator. Size 20 contact, male — 0.040 inch (1,02mm) diameter; female — closed entry design with stainless steel shroud or open entry Robi-D design. 9 lbs. (40N).
Contact Retention in Insulator:	
Contact Terminations:	Closed barrel crimp, wire sizes 18 AWG (1,0mm ²) through 30 AWG (0,05mm ²).
Shells:	Male shells may be dimpled for EMI/ESD ground paths.
Polarization:	Trapezoidally shaped shells and polarized jackscrews.
Locking Systems:	Jackscrews and vibration locking systems.
Mechanical Operations:	1000 operations minimum per IEC 512-5 for closed entry female contact. 500 operations per IEC 512-5 for Robi-D open entry design female contact.

