

SK10288

THIS DRAWING CONTAINS INFORMATION PROPRIETARY TO POSITRONIC AND ITS SUBSIDIARIES. POSITRONIC BELIEVES THE DATA ON THIS DRAWING TO BE RELIABLE. SINCE THE TECHNICAL INFORMATION IS GIVEN FREE OF CHARGE, THE USER EMPLOYS SUCH INFORMATION AT HIS OWN DISCRETION AND RISK. POSITRONIC ASSUMES NO RESPONSIBILITY FOR RESULTS OBTAINED OR DAMAGES INCURRED FROM USE OF SUCH INFORMATION IN WHOLE OR IN PART.

DATE	REV	REVISION RECORD	APP	DR	CK
1-26-09	NC	ECO 30525	RCW	YK	TK
4-27-10	A	ECO 32421	TK	BE	TK

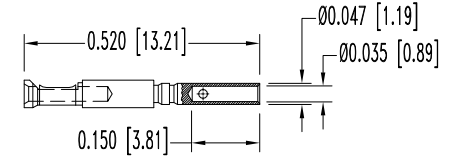
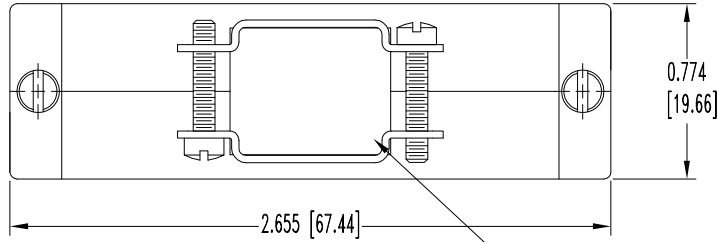

**78X FEMALE CONTACT  
ENLARGED**

0.230 [5.84] X 0.630 [16.00] MIN.  
0.650 [16.51] X 0.630 [16.00] MAX.  
CABLE CLAMP OPENING

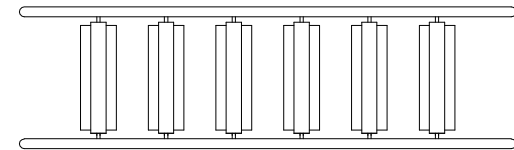

**INSERT TREE**

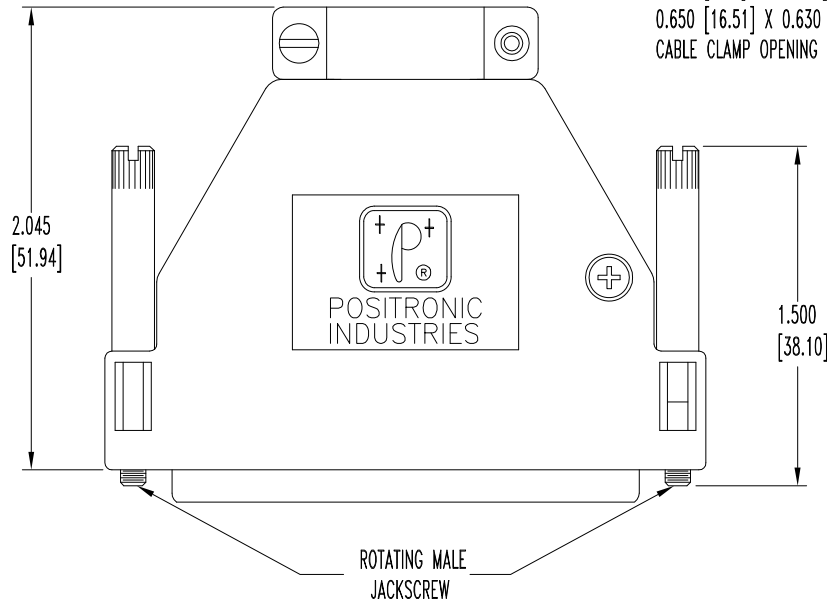

**NOTES:**

- MATERIALS AND FINISHES:**  
 INSULATOR: GLASS FILLED POLYESTER PER ASTM D5927, UL 94V-0, BLUE COLOR.  
 CONTACTS: BRASS, GOLD FLASH OVER NICKEL FINISH.  
 SHELLS: STEEL, ZINC PLATE WITH CHROMATE SEAL.  
 HOOD AND INSERT: COMPOSITE, CONDUCTIVE  
 VOLUME RESISTIVITY: (1.0 OHM.-cm MAX.)  
 ATTENUATION: 40+ DECIBELS.  
 CABLE CLAMPS: STEEL, NICKEL PLATE.  
 CABLE CLAMP SCREWS: BRASS, ZINC PLATE WITH CHROMATE SEAL.  
 COVER SCREWS: STAINLESS STEEL, PASSIVATED.  
 JACKSCREWS: STEEL, ZINC PLATE WITH CHROMATE SEAL.
- DETAILED PRODUCT, ELECTRICAL, AND MECHANICAL INFORMATION IS AVAILABLE IN THE LATEST HIGH DENSITY D-SUBMINIATURE PRODUCT PUBLICATION. VISIT [CONNECTPOSITRONIC.COM/PRODUCTS/59/HIGHDENSITYD-SUBMINIATURE](http://CONNECTPOSITRONIC.COM/PRODUCTS/59/HIGHDENSITYD-SUBMINIATURE) OR [CONNECTPOSITRONIC.COM](http://CONNECTPOSITRONIC.COM).
- DIMENSIONS ARE IN INCHES [MILLIMETERS].

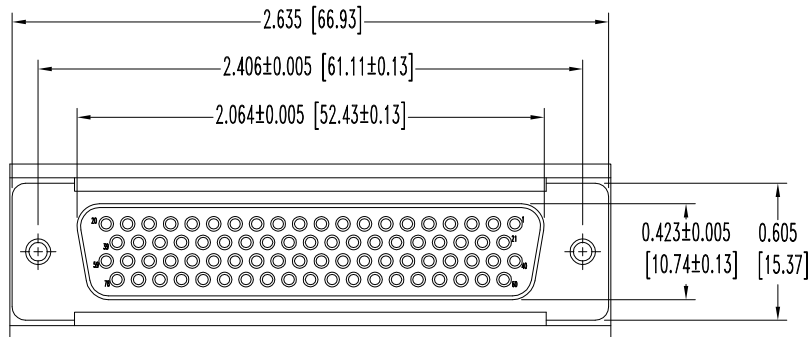

 <b>POSITRONIC INDUSTRIES INC.</b> www.connectpositronic.com		FSCM 28198	
		SCALE N.T.S.	DRAWN BY YK
DECIMAL TOL. ± 0.015 [0.38]	DD SERIES	APPROVED BY R WILLIAMS	
TITLE DD78S10Y00			
ANGULAR TOL. ± 5°	DATE 1-26-09	DRAWING NUMBER SK10288	REV. A