

POSITRONIC INDUSTRIES BELIEVES THE DATA ON THIS DRAWING TO BE RELIABLE, SINCE THE TECHNICAL INFORMATION IS GIVEN FREE OF CHARGE, THE USER EMPLOYS SUCH INFORMATION AT HIS OWN DISCRETION AND RISK. POSITRONIC INDUSTRIES ASSUMES NO RESPONSIBILITY FOR RESULTS OBTAINED OR DAMAGES INCURRED FROM USE OF SUCH INFORMATION IN WHOLE OR IN PART.

DATE	REV	REVISION RECORD	APP	DR	CK
1-25-07	NC	ECO 27383	RCW	YK	TK
4-13-10	A	ECO 32349	COLE	ME	SY

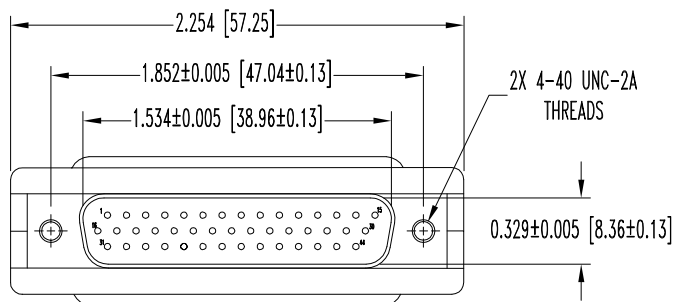

TYPICAL INSERT

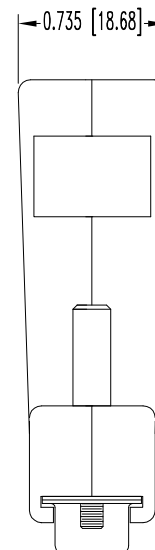
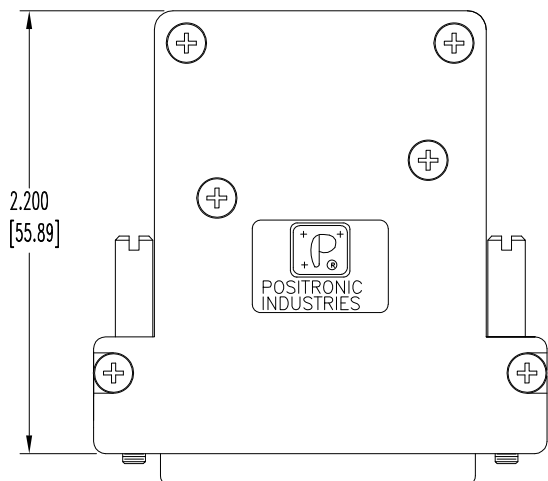
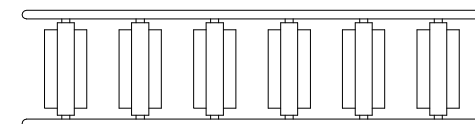

INSERT TREE ASSEMBLY

NOTES:

1. MATERIALS AND FINISHES:

INSULATOR: GLASS FILLED POLYESTER PER ASTM D5927, UL 94V-0, BLUE COLOR.  
 CONTACTS: PRECISION MACHINED HIGH TENSILE COPPER ALLOY, GOLS FLASH OVER NICKEL PLATE.  
 SHELLS: STAINLESS STEEL, PASSIVATED.  
 HOOD: COMPOSITE, CONDUCTIVE VOLUME RESISTIVITY (1.0 OHM-cm MAX.), UL94V-0. ATTENUATION: 40+ DECIBELS.  
 JACKSCREWS: STAINLESS STEEL, PASSIVATED.  
 SCREWS: STAINLESS STEEL, PASSIVATE.

2. DETAILED PRODUCT, ELECTRICAL, AND MECHANICAL INFORMATION IS AVAILABLE IN THE LATEST HIGH DENSITY D-SUB PRODUCT PUBLICATION. VISIT [CONNECTPOSITRONIC.COM/PRODUCTS/59/HIGHDENSITYD-SUBMINIATURE](http://CONNECTPOSITRONIC.COM/PRODUCTS/59/HIGHDENSITYD-SUBMINIATURE) OR [CONNECTPOSITRONIC.COM](http://CONNECTPOSITRONIC.COM).

3. DIMENSIONS ARE IN INCHES [MILLIMETERS].

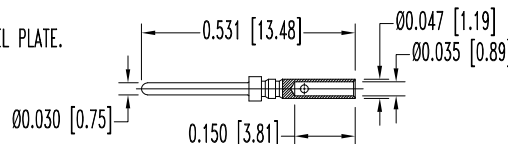

44X MALE CONTACT  
ENLARGED

		<b>POSITRONIC INDUSTRIES INC.</b> www.connectpositronic.com	
		DD SERIES	SCALE N.T.S.
DECIMAL TOL. ± 0.015 [0.38]	TITLE DD44M10Z0S		
ANGULAR TOL. ± 5°	DATE 1-25-07	DRAWING NUMBER SK8295	REV. A