

THIS DRAWING CONTAINS INFORMATION PROPRIETARY TO POSITRONIC INDUSTRIES INC. ANY REPRODUCTION OF THIS DRAWING WITHOUT THE WRITTEN PERMISSION OF POSITRONIC INDUSTRIES INC. IS STRICTLY PROHIBITED. THE USER EMPLOY'S SUCH INFORMATION AT HIS OWN DISCRETION. POSITRONIC INDUSTRIES INC. ASSUMES NO LIABILITY FOR RESULTS OBTAINED OR DAMAGES INCURRED FROM USE OF SUCH INFORMATION IN WHOLE OR IN PART.

SK15488

DATE	REV	REVISION RECORD	APP	DR	CK
10-21-13	NC	ECO 41117	COLB	BS	COLB

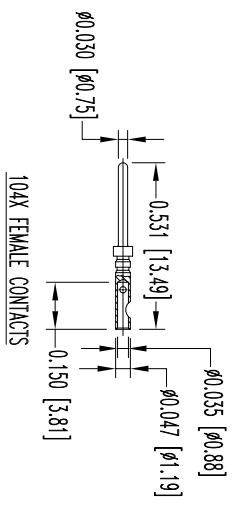
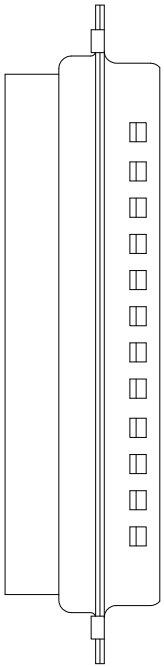
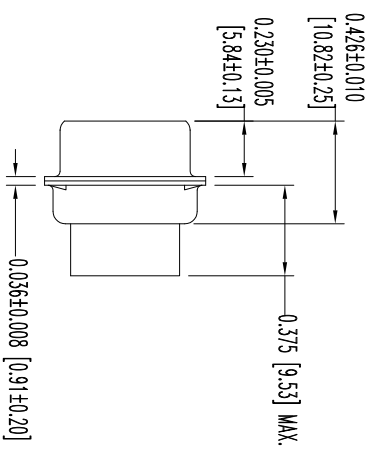
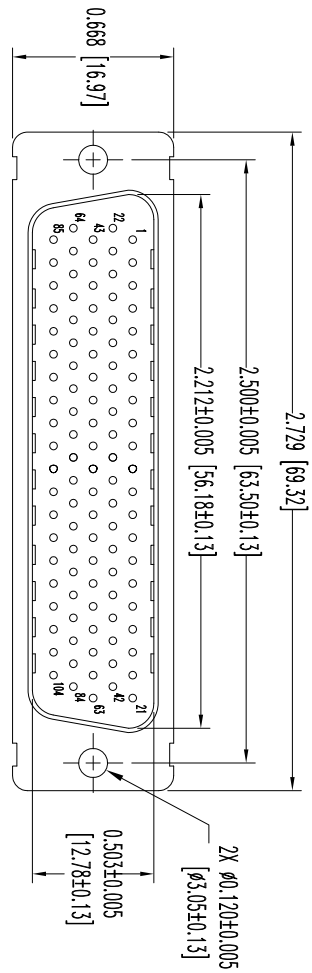

- NOTES:
1. MATERIALS AND FINISHES:  
INSULATOR: GLASS FILLED POLYESTER PER ASTM-D5927, UL 94V-0, COLOR: BLUE.  
CONTACTS: PRECISION MACHINED COPPER ALLOY, GOLD FLASH OVER NICKEL PLATE.  
SHELLS: DIMPLED STEEL WITH TIN PLATE.
  2. DETAILED PRODUCT, MECHANICAL, AND ELECTRICAL INFORMATION IS AVAILABLE IN THE LATEST HIGH DENSITY D-SUB PRODUCT PUBLICATION. VISIT [CONNECTPOSITRONIC.COM/PRODUCTS/59/HIGHDENSITY-D-SUBMINIATURE](http://CONNECTPOSITRONIC.COM/PRODUCTS/59/HIGHDENSITY-D-SUBMINIATURE) OR [CONNECTPOSITRONIC.COM](http://CONNECTPOSITRONIC.COM).
  3. CONNECTORS ARE ROHS COMPLIANT PER CURRENT DIRECTIVE.
  4. DIMENSIONS ARE IN INCHES [MILLIMETERS].

		<b>POSITRONIC INDUSTRIES INC.</b> <a href="http://www.connectpositronic.com">www.connectpositronic.com</a>		<b>FSCM 28198</b>	
		<b>DD SERIES</b>	<b>N.T.S.</b>	<b>DRAWN BY</b> <b>B SHELLBUDY</b>	<b>APPROVED BY</b> <b>COLB</b>
<b>DECIMAL TOL.</b> $\pm 0.015$ [0.38]	<b>ANGULAR TOL.</b> $\pm 5^\circ$	<b>TITLE</b> <b>DD104M0000Z/AA</b>		<b>DRAWING NUMBER</b> <b>SK15488</b>	<b>REV.</b> <b>NC</b>