

Description: LTE / WiFi / GNSS, Direct Mount

Series: DISC

PART NUMBER: DSC31111DM

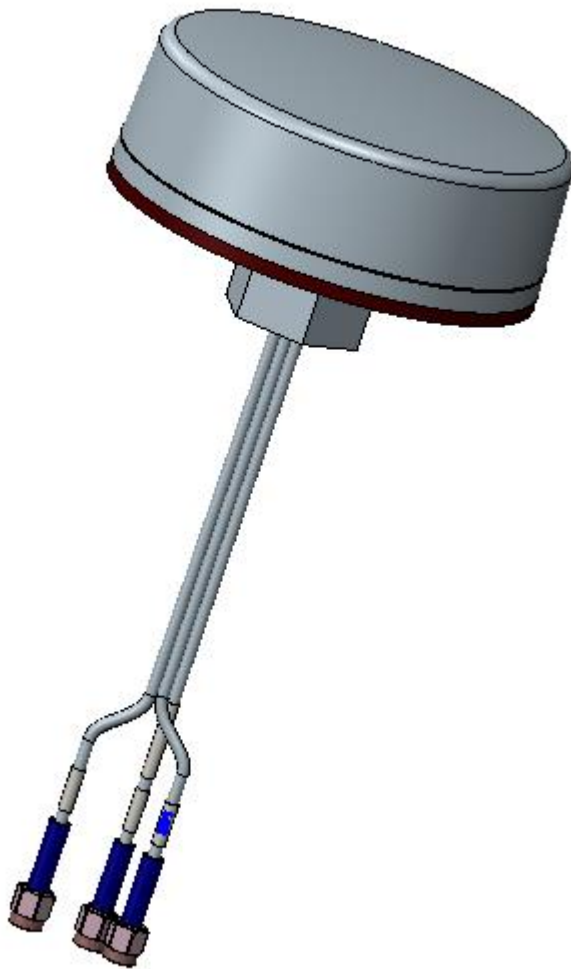

Features:

- 1x LTE 4G antenna:
 - 698-960/1427-2700MHz
- 1x WiFi Antenna:
 - 2400-2500/4900-6000MHz
- 1x Active GNSS antenna:
 - 1555-1610MHz
 - LNA Gain 30dB
 - Pre and post LNA filtering
- Diameter 100mm
- 3m feed cables and SMA Male connectors as standard
- IP67

Applications:

- 3-in-1 Combo Antenna
- 4G LTE, Cat M1 and Nb-IoT Devices
- WiFi
- Vehicular use
- Utility boxes
- Smart metering
- Navigation, Fleet Management, Tracking

All dimensions are in mm / inches

Issue: 2026

In the effort to improve our products, we reserve the right to make changes judged to be necessary.

CONFIDENTIAL AND PROPRIETARY INFORMATION

This document contains confidential and proprietary information of Pulse Electronics, Inc. (Pulse) and is protected by copyright, trade secret and other state and federal laws. Its receipt or possession does not convey any rights to reproduce, disclose its contents, or to manufacture, use or sell anything it may describe. Reproduction, disclosure or use without specific written authorization of Pulse is strictly forbidden.

For more information:

Pulse Worldwide Headquarters
15255 Innovation Drive #100
San Diego, CA 92128
USA
Tel: 1-858-674-8100

Pulse/Larsen Antennas
18110 SE 34th St Bldg 2 Suite 250
Vancouver, WA 98683
USA
Tel: 1-360-944-7551

Europe Headquarters
Pulse GmbH & Do, KG
Zeppelinstrasse 15
Herrenberg, Germany
Tel: 49 7032 7806 0

Pulse (Suzhou) Wireless Products Co, Inc.
99 Huo Ju Road(#29 Bldg,4th Phase
Suzhou New District
Jiangsu Province, Suzhou 215009 PR China
Tel: 86 512 6807 9998



Description: LTE / WiFi / GNSS, Direct Mount

Series: DISC

PART NUMBER: DSC31111DM

ELECTRICAL SPECIFICATIONS

Antenna Type	LTE and WiFi PIFA, GNSS ceramic patch
Frequency	LTE:698-960/1427-2700MHz WiFi: 2400-2500/4900-6000MHz GNSS: 1555-1610MHz
Nominal Impedance	50 Ω
Return Loss	-10dB
Radiation Pattern (LTE and WiFi)	Omni
(GNSS)	Directional
Gain	698-960 3.5dBi / 1427-2700 4.7dBi 2400-2500 4.7dBi / 4900-6000 6.5dBi
Gain (GNSS LNA)	30dB
Noise Figure (GNSS)	<2.4 dB
Input voltage (GNSS)	3.3-5 V DC
Current Draw (GNSS)	<6 mA
Efficiency(Min)	LTE 35%/ WIFI 60%
Polarization (LTE and WiFi)	Linear Vertical
Polarization (GNSS)	RHCP

Preliminary

Issue: 2026

In the effort to improve our products, we reserve the right to make changes judged to be necessary.

CONFIDENTIAL AND PROPRIETARY INFORMATION

This document contains confidential and proprietary information of Pulse Electronics, Inc. (Pulse) and is protected by copyright, trade secret and other state and federal laws. Its receipt or possession does not convey any rights to reproduce, disclose its contents, or to manufacture, use or sell anything it may describe. Reproduction, disclosure or use without specific written authorization of Pulse is strictly forbidden.



Description: LTE / WiFi / GNSS, Direct Mount

Series: DISC

PART NUMBER: DSC31111DM

MECHANICAL SPECIFICATIONS

Overall Length	Φ100*38mm
Weight	400g
Antenna Color / Material	Black/PC 943
Connector type	SMA Male
Cable type	RG174
Cable length	3048mm/10ft

ENVIRONMENTAL SPECIFICATIONS

Operating Temperature	-40 ~ +85° C
Storage Temperature	-40 ~ +85° C
Ingress Protection	IP67
RoHS Compliant	Yes

Description: LTE / WiFi / GNSS, Direct Mount

Series: DISC

PART NUMBER: DSC3111DM

MECHANICAL DRAWING

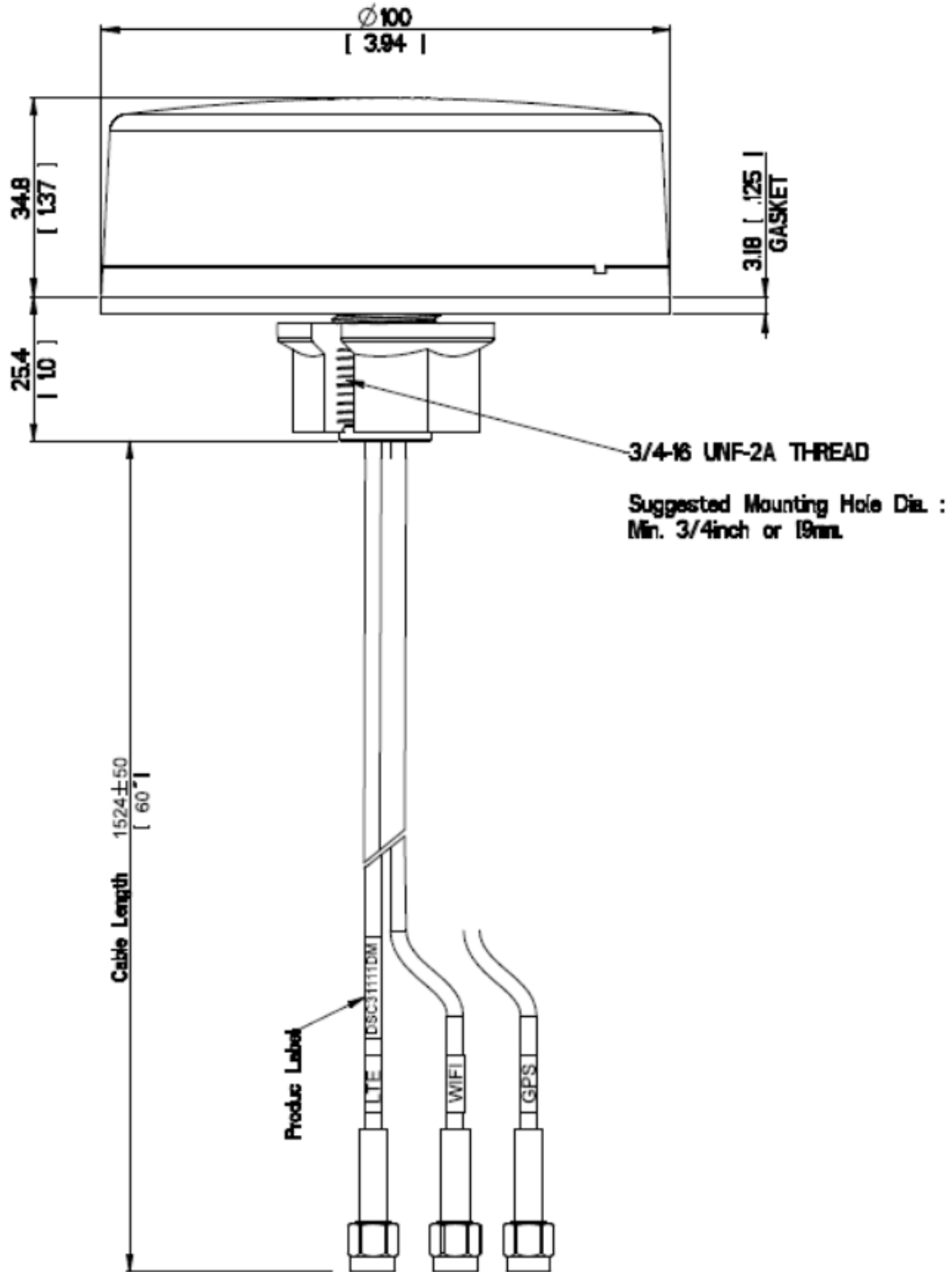

Unit: mm [inch]

Issue: 2026

In the effort to improve our products, we reserve the right to make changes judged to be necessary.

CONFIDENTIAL AND PROPRIETARY INFORMATION

This document contains confidential and proprietary information of Pulse Electronics, Inc. (Pulse) and is protected by copyright, trade secret and other state and federal laws. Its receipt or possession does not convey any rights to reproduce, disclose its contents, or to manufacture, use or sell anything it may describe. Reproduction, disclosure or use without specific written authorization of Pulse is strictly forbidden.

Description: LTE / WiFi / GNSS, Direct Mount

Series: DISC

PART NUMBER: DSC31111DM

TEST SETUP

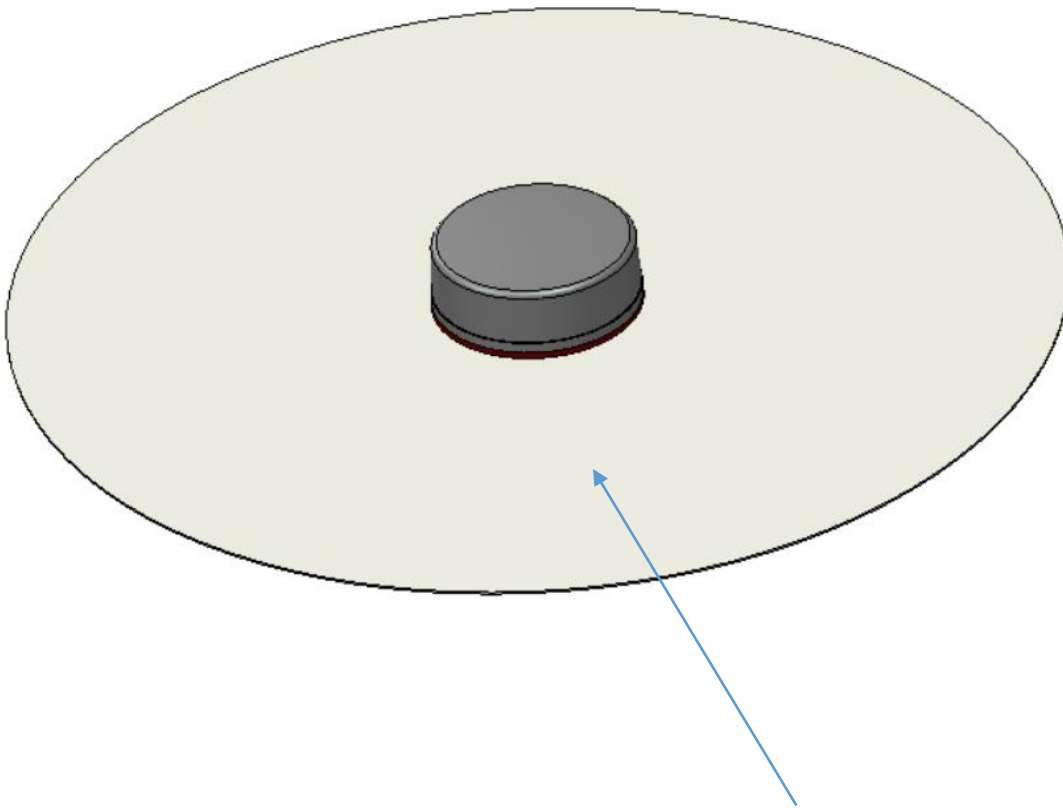

Diameter: 500 mm ground pane

Preliminary

Issue: 2026

In the effort to improve our products, we reserve the right to make changes judged to be necessary.

CONFIDENTIAL AND PROPRIETARY INFORMATION

This document contains confidential and proprietary information of Pulse Electronics, Inc. (Pulse) and is protected by copyright, trade secret and other state and federal laws. Its receipt or possession does not convey any rights to reproduce, disclose its contents, or to manufacture, use or sell anything it may describe. Reproduction, disclosure or use without specific written authorization of Pulse is strictly forbidden.

Description: LTE / WiFi / GNSS, Direct Mount

Series: DISC

PART NUMBER: DSC31111DM

CHARTS

Return Loss

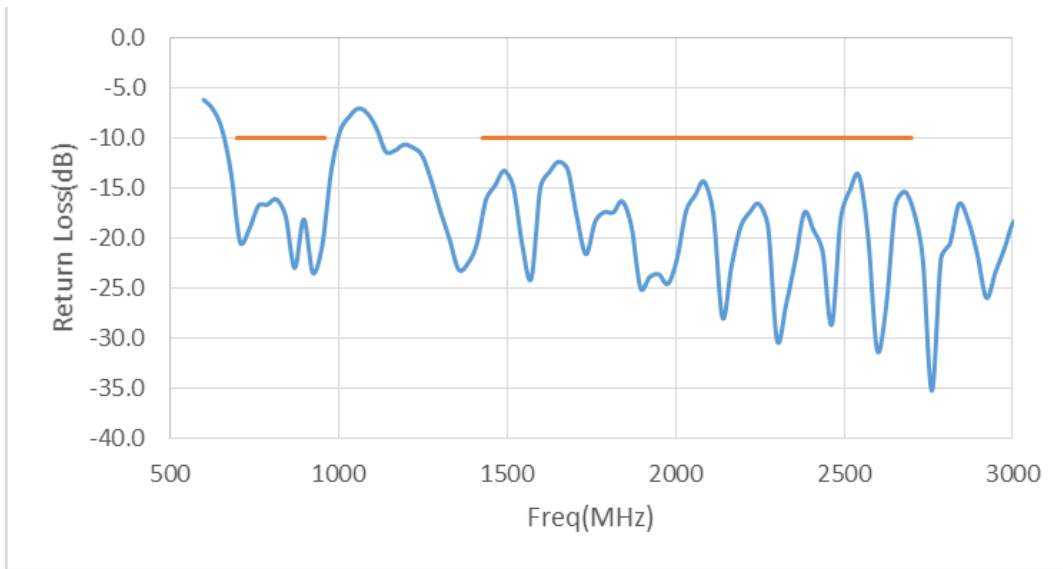

LTE

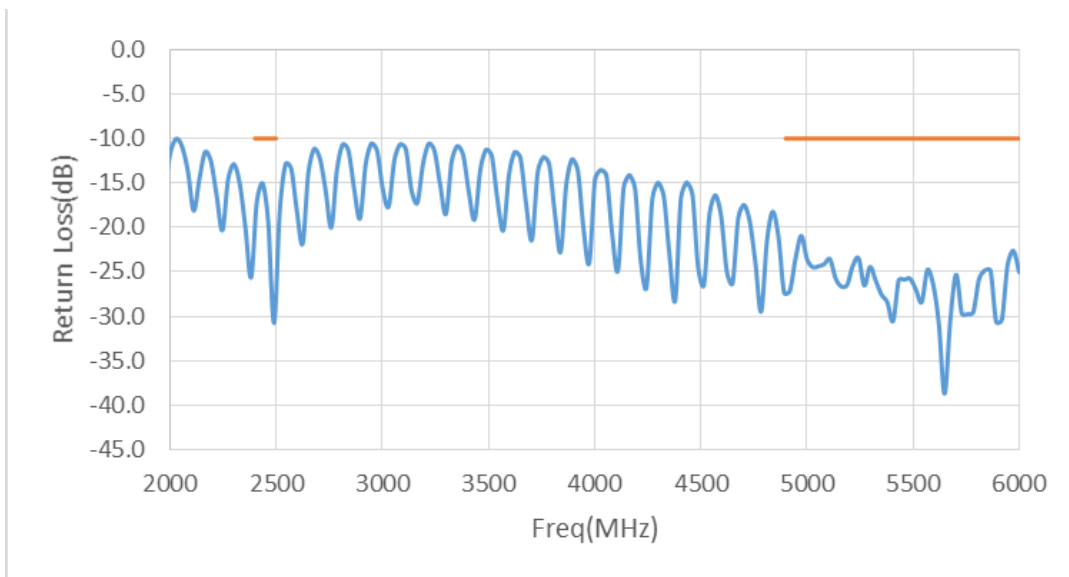

WiFi

All return loss data test with 3000mm length cable

Preliminary

Issue: 2026

In the effort to improve our products, we reserve the right to make changes judged to be necessary.

CONFIDENTIAL AND PROPRIETARY INFORMATION

This document contains confidential and proprietary information of Pulse Electronics, Inc. (Pulse) and is protected by copyright, trade secret and other state and federal laws. Its receipt or possession does not convey any rights to reproduce, disclose its contents, or to manufacture, use or sell anything it may describe. Reproduction, disclosure or use without specific written authorization of Pulse is strictly forbidden.



Description: LTE / WiFi / GNSS, Direct Mount

Series: DISC

PART NUMBER: DSC3111DM

CHARTS

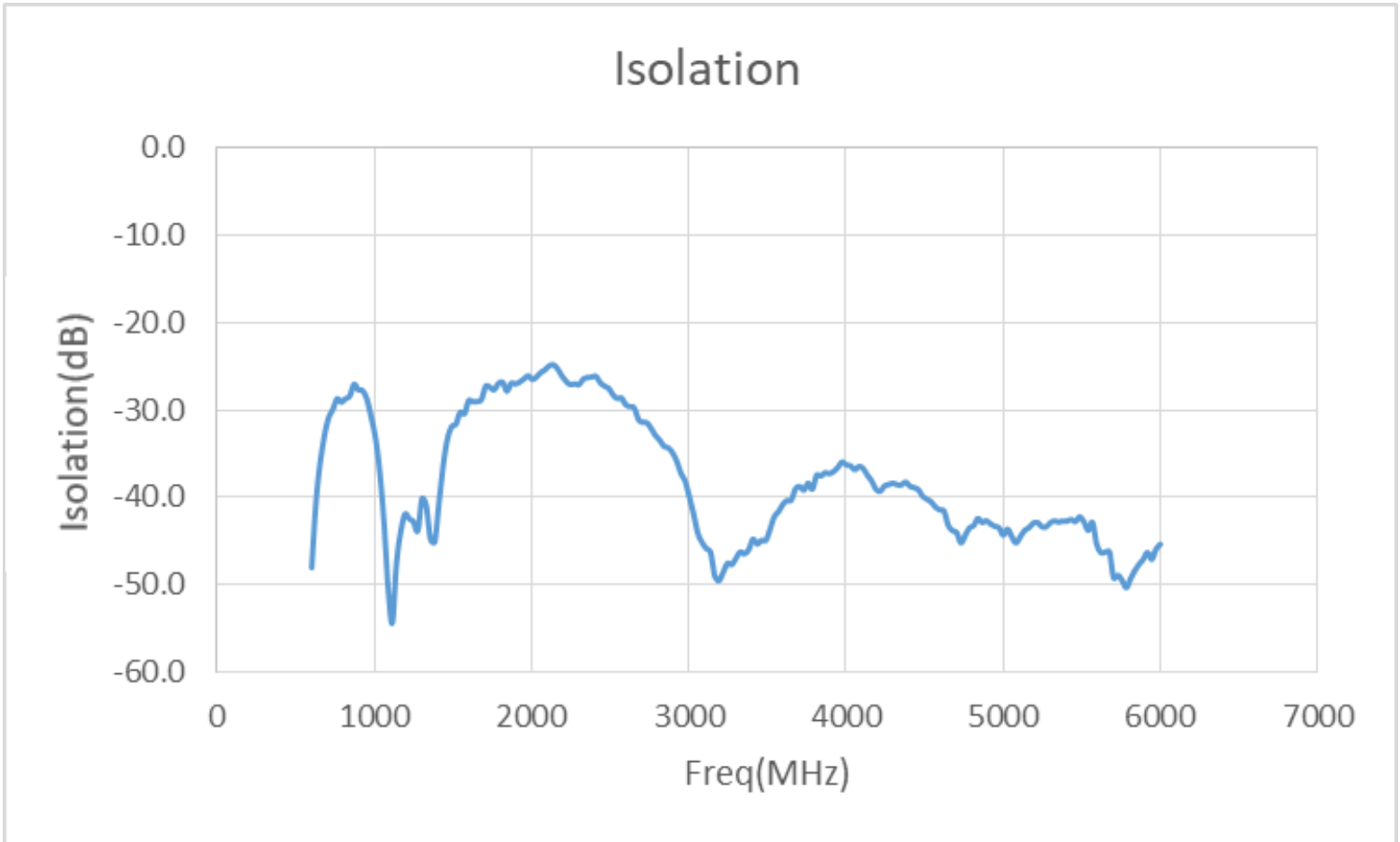

Isolation between LTE and WIFI

All return loss data test with 3000mm length cable

Preliminary

Issue: 2026

In the effort to improve our products, we reserve the right to make changes judged to be necessary.

CONFIDENTIAL AND PROPRIETARY INFORMATION

This document contains confidential and proprietary information of Pulse Electronics, Inc. (Pulse) and is protected by copyright, trade secret and other state and federal laws. Its receipt or possession does not convey any rights to reproduce, disclose its contents, or to manufacture, use or sell anything it may describe. Reproduction, disclosure or use without specific written authorization of Pulse is strictly forbidden.



Description: LTE / WiFi / GNSS, Direct Mount

Series: DISC

PART NUMBER: DSC31111DM

CHARTS

Gain(dBi) and Efficiency(%) (LTE)

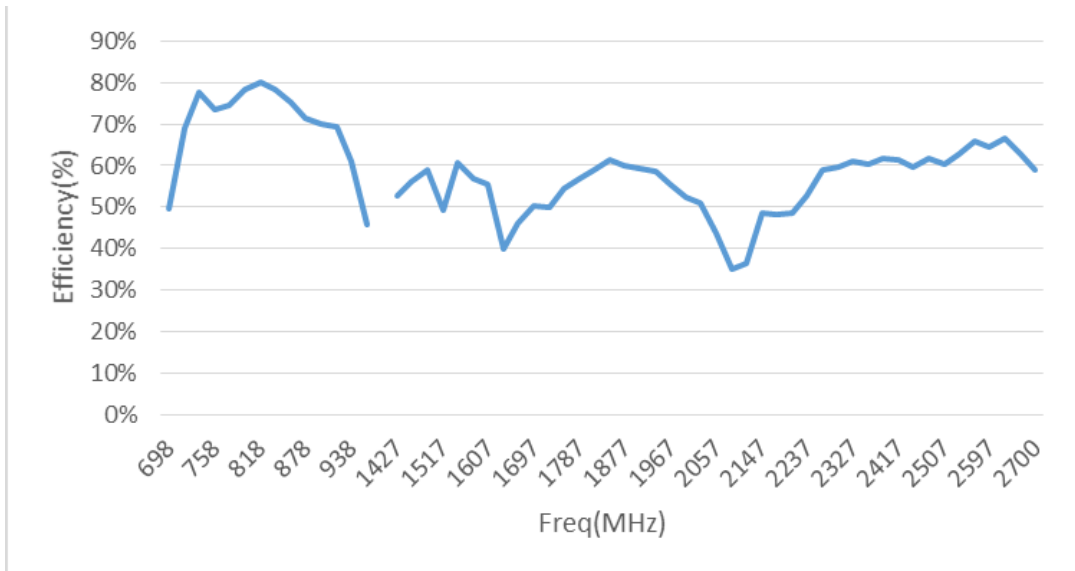
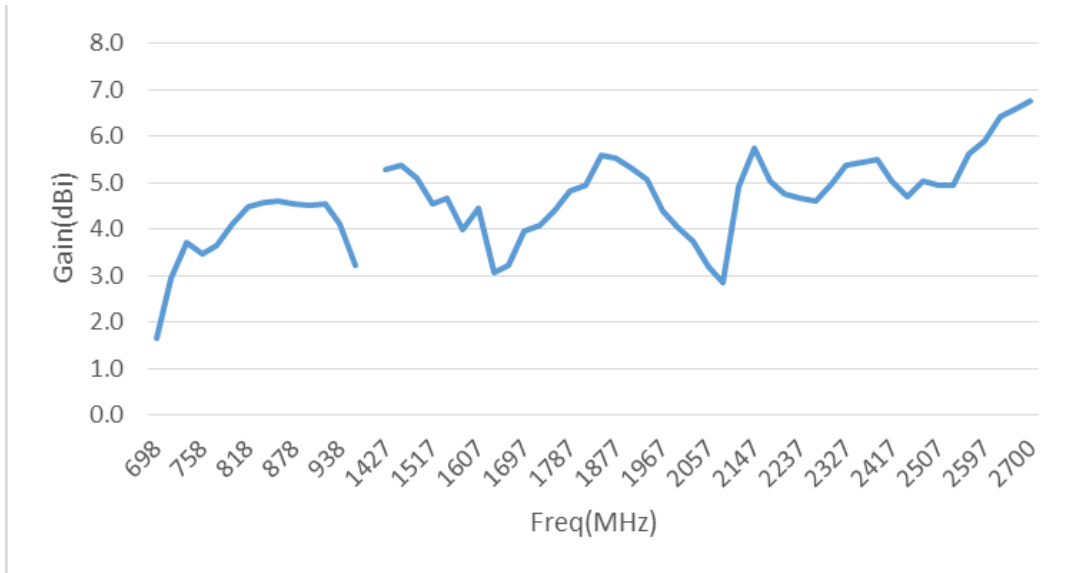

All gain and efficiency data test with 200mm length cable

Issue: 2026

In the effort to improve our products, we reserve the right to make changes judged to be necessary.

CONFIDENTIAL AND PROPRIETARY INFORMATION

This document contains confidential and proprietary information of Pulse Electronics, Inc. (Pulse) and is protected by copyright, trade secret and other state and federal laws. Its receipt or possession does not convey any rights to reproduce, disclose its contents, or to manufacture, use or sell anything it may describe. Reproduction, disclosure or use without specific written authorization of Pulse is strictly forbidden.

Preliminary



Description: LTE / WiFi / GNSS, Direct Mount

Series: DISC

PART NUMBER: DSC31111DM

CHARTS

Gain(dBi) and Efficiency(%) (WIFI)



All gain and efficiency data test with 200mm length cable

Preliminary

Issue: 2026

In the effort to improve our products, we reserve the right to make changes judged to be necessary.

CONFIDENTIAL AND PROPRIETARY INFORMATION

This document contains confidential and proprietary information of Pulse Electronics, Inc. (Pulse) and is protected by copyright, trade secret and other state and federal laws. Its receipt or possession does not convey any rights to reproduce, disclose its contents, or to manufacture, use or sell anything it may describe. Reproduction, disclosure or use without specific written authorization of Pulse is strictly forbidden.



Description: LTE / WiFi / GNSS, Direct Mount

Series: DISC

PART NUMBER: DSC31111DM

CHARTS

GNSS LNA performance

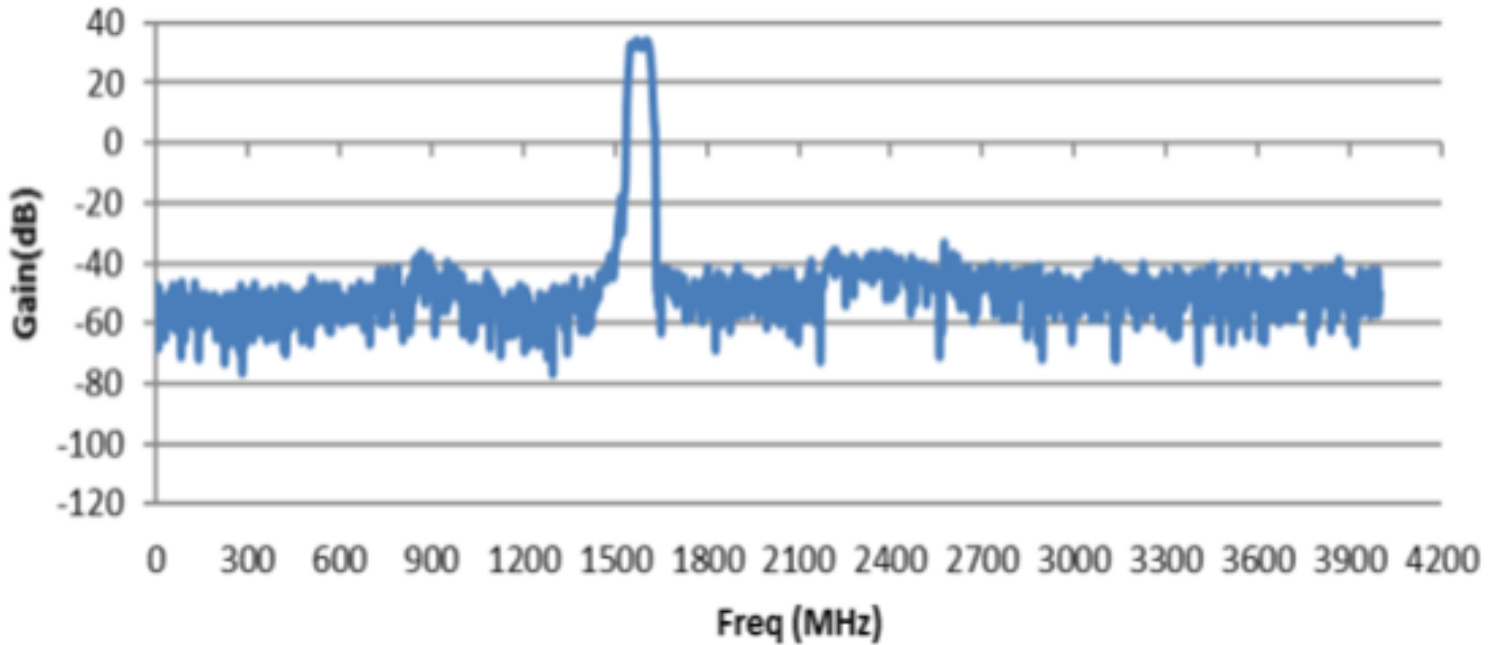

Preliminary

Issue: 2026

In the effort to improve our products, we reserve the right to make changes judged to be necessary.

CONFIDENTIAL AND PROPRIETARY INFORMATION

This document contains confidential and proprietary information of Pulse Electronics, Inc. (Pulse) and is protected by copyright, trade secret and other state and federal laws. Its receipt or possession does not convey any rights to reproduce, disclose its contents, or to manufacture, use or sell anything it may describe. Reproduction, disclosure or use without specific written authorization of Pulse is strictly forbidden.



Description: LTE / WiFi / GNSS, Direct Mount

Series: DISC

PART NUMBER: DSC31111DM

CHARTS

Radiation Pattern (LTE)

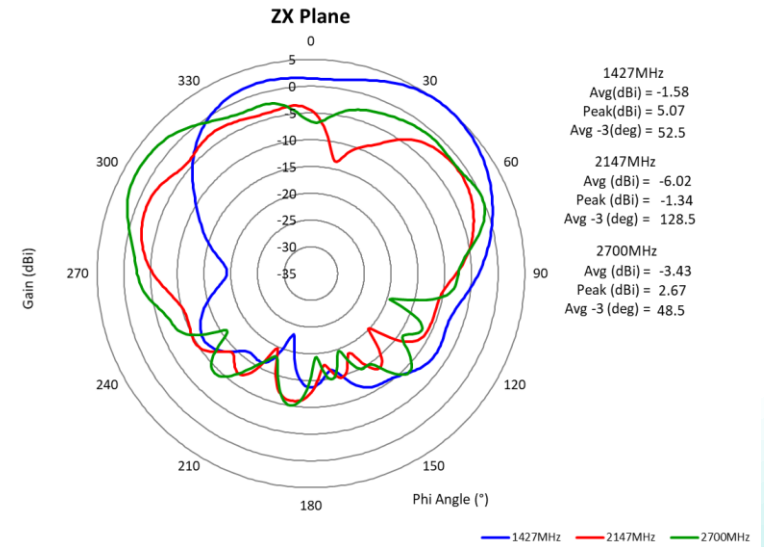
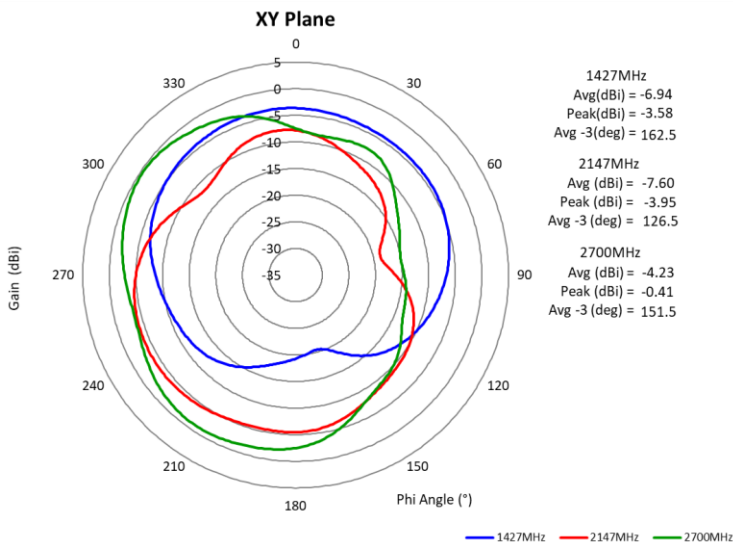
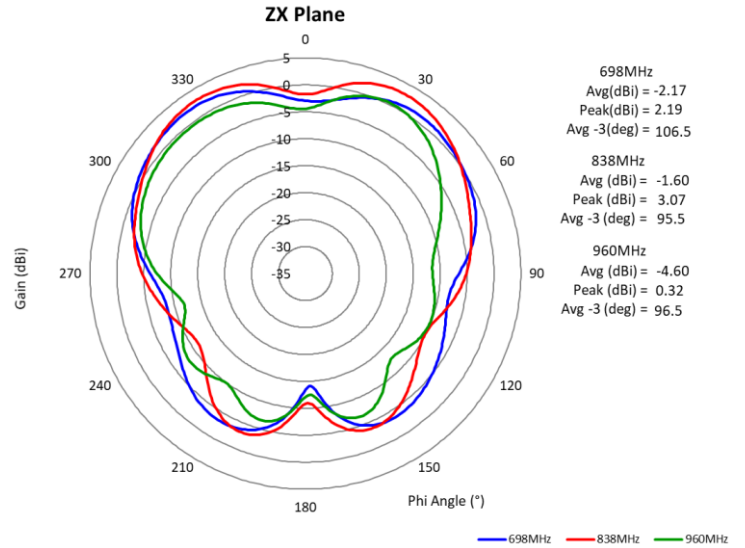
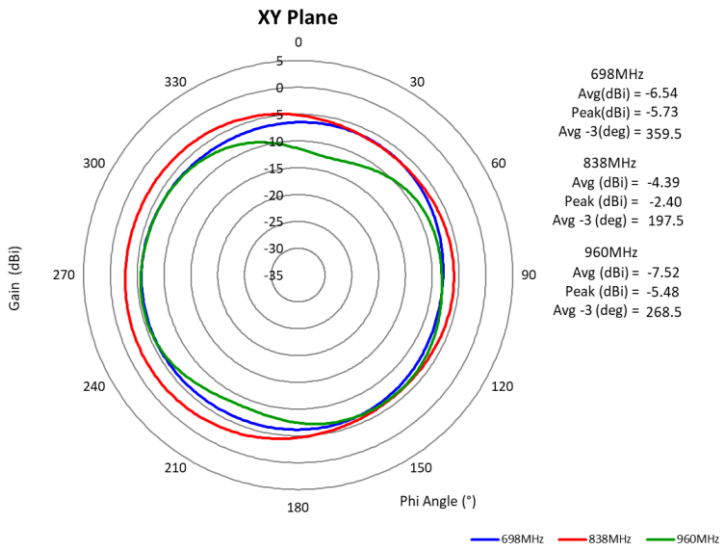

Preliminary

Issue: 2026

In the effort to improve our products, we reserve the right to make changes judged to be necessary.
CONFIDENTIAL AND PROPRIETARY INFORMATION

This document contains confidential and proprietary information of Pulse Electronics, Inc. (Pulse) and is protected by copyright, trade secret and other state and federal laws. Its receipt or possession does not convey any rights to reproduce, disclose its contents, or to manufacture, use or sell anything it may describe. Reproduction, disclosure or use without specific written authorization of Pulse is strictly forbidden.



Description: LTE / WiFi / GNSS, Direct Mount

Series: DISC

PART NUMBER: DSC31111DM

CHARTS

Radiation Pattern (WIFI)

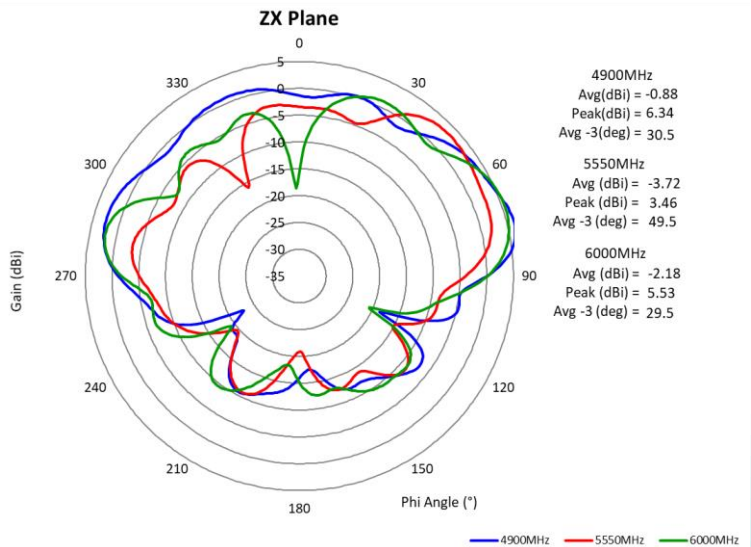
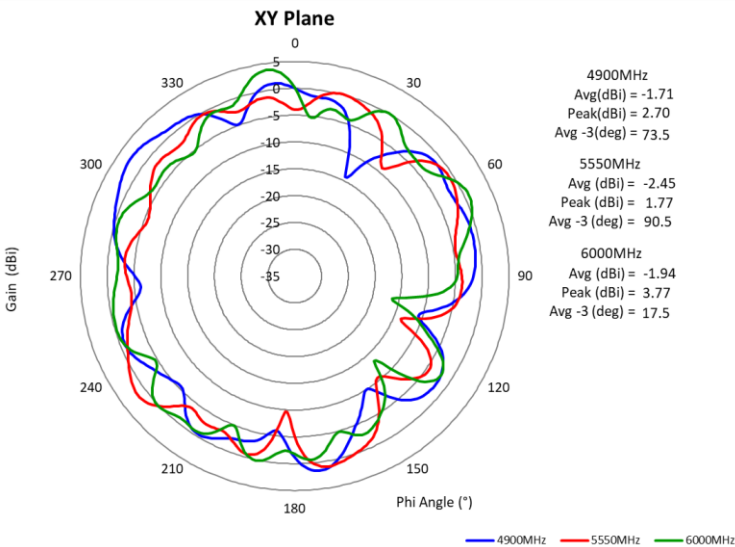
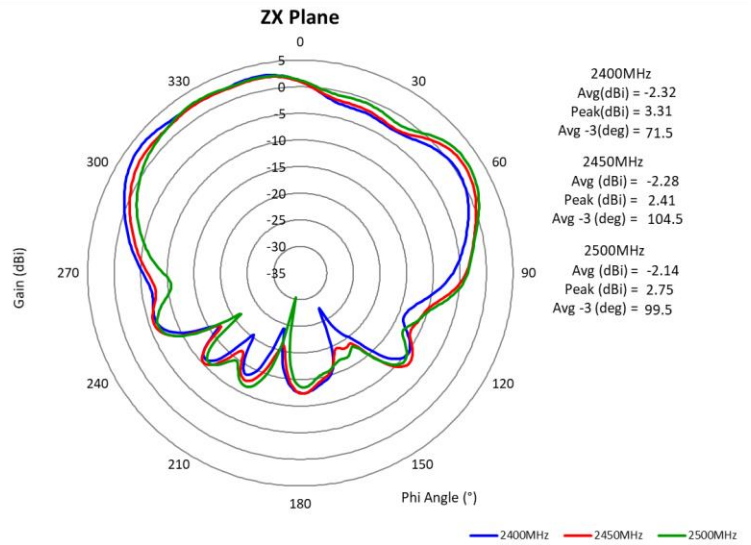
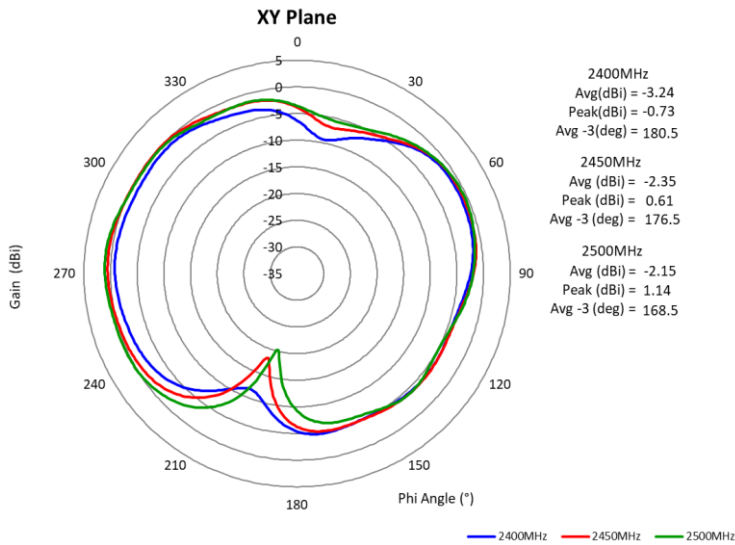

Preliminary

Issue: 2026

In the effort to improve our products, we reserve the right to make changes judged to be necessary.

CONFIDENTIAL AND PROPRIETARY INFORMATION

This document contains confidential and proprietary information of Pulse Electronics, Inc. (Pulse) and is protected by copyright, trade secret and other state and federal laws. Its receipt or possession does not convey any rights to reproduce, disclose its contents, or to manufacture, use or sell anything it may describe. Reproduction, disclosure or use without specific written authorization of Pulse is strictly forbidden.



Description: LTE / WiFi / GNSS, Direct Mount

Series: DISC

PART NUMBER: DSC31111DM

CHARTS

Radiation Pattern (GNSS)

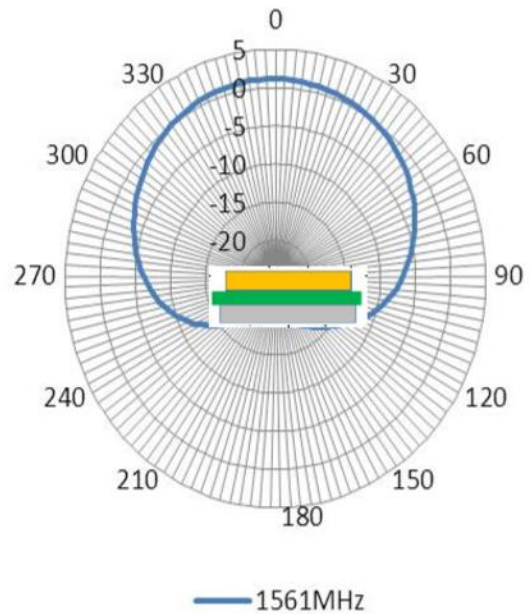
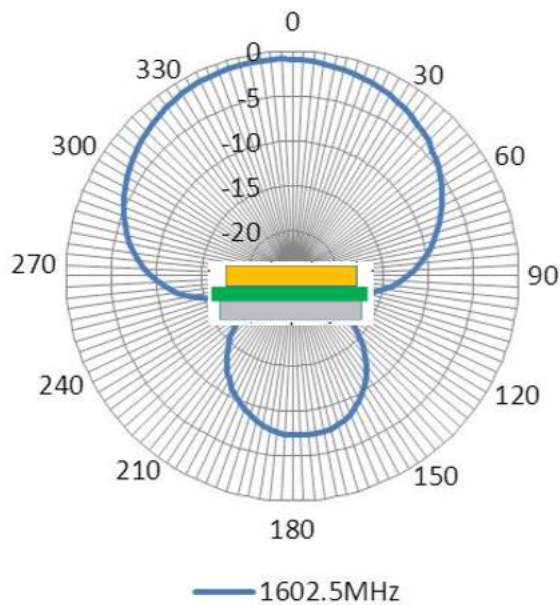
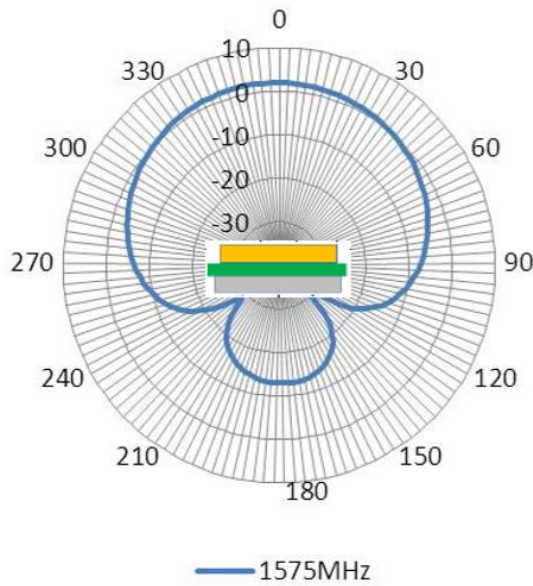

RHCP Radiation Pattern (70mm x 70mm ground plane)

Issue: 2026

In the effort to improve our products, we reserve the right to make changes judged to be necessary.

CONFIDENTIAL AND PROPRIETARY INFORMATION

This document contains confidential and proprietary information of Pulse Electronics, Inc. (Pulse) and is protected by copyright, trade secret and other state and federal laws. Its receipt or possession does not convey any rights to reproduce, disclose its contents, or to manufacture, use or sell anything it may describe. Reproduction, disclosure or use without specific written authorization of Pulse is strictly forbidden.

Preliminary

Description: LTE / WiFi / GNSS, Direct Mount

Series: DISC

PART NUMBER: DSC31111DM

PACKAGING

1 PCS/ PE Bag

24 PCS/ Box

Preliminary

Issue: 2026

In the effort to improve our products, we reserve the right to make changes judged to be necessary.

CONFIDENTIAL AND PROPRIETARY INFORMATION

This document contains confidential and proprietary information of Pulse Electronics, Inc. (Pulse) and is protected by copyright, trade secret and other state and federal laws. Its receipt or possession does not convey any rights to reproduce, disclose its contents, or to manufacture, use or sell anything it may describe. Reproduction, disclosure or use without specific written authorization of Pulse is strictly forbidden.