

## DIL - SOLDER TAIL AUTOMATIC INSERTION

Series **DIL - Solder tail automatic insertion**  
 110 2.54 mm, Solder tail automatic insertion

DIL sockets with ribbed insulator body and soft copper alloy contacts compatible with automatic insertion equipment.

### Technical specs.:

Insulator: Black glass filled polyester  
 PBT-GF30-FR  
 Flammability: UL 94V-O  
 Sleeve: Brass CuZn36Pb3 (C36000)  
 Contact : Clip (4 finger): Beryllium  
 copper (C17200)  
 Accepted pin Ø: 0.40 to 0.56 mm  
 Insertion Forces: 2 N typ.  
 Withdrawal Forces: 1 N typ.  
 (polished steel gauge Ø 0.43  
 mm)  
 Mechanical life: Min. 100 cycles  
 Rated current: 1 A  
 Contact resistance: Max. 10 mΩ  
 Dielectric strength: Min. 1000 V RMS

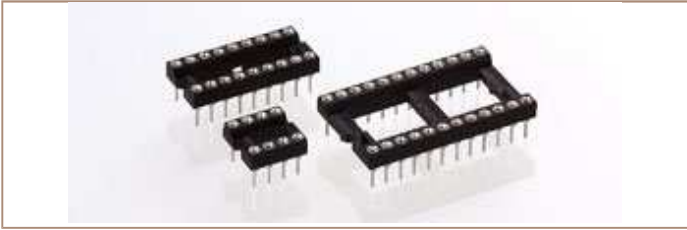

### Ordering information RoHS-compliant parts

PP Plating code	Sleeve	Clip
<b>87</b>	<b>Tin</b>	<b>Gold flash</b>
83	Tin	Gold 0.75 µm

Other pin count please consult

**General technical specs. ...**

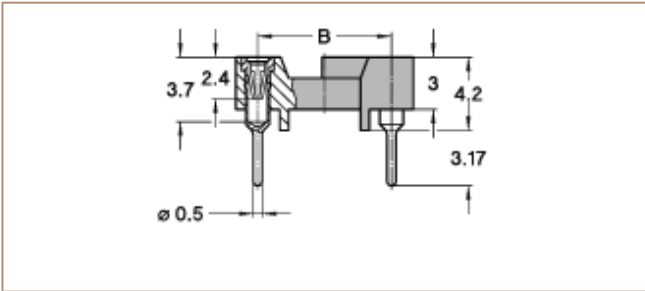

Poles	A	B	C	D	E	See	Order Codes
6	7.62						110-PP-306-41-605101
8	7.62						110-PP-308-41-605101
14	7.62						110-PP-314-41-605101
16	7.62						110-PP-316-41-605101
18	7.62						110-PP-318-41-605101
20	7.62						110-PP-320-41-605101
24	7.62						110-PP-324-41-605101
22	10.16						110-PP-422-41-605101
24	15.24						110-PP-624-41-605101
28	15.24						110-PP-628-41-605101
32	15.24						110-PP-632-41-605101
40	15.24						110-PP-640-41-605101