



### One-Hole, Single Piece, Straight Fixed Tongue Lug

For Use with Stranded Copper Code Conductors

Type CXS

- Made from a single piece of high strength electrolytic copper to provide premium electrical and mechanical performance
- Patented one piece design. Provides premium electrical and mechanical
- Wide wire range-taking capability minimizes inventory requirements
- Serrations incorporated in barrel of connector to provide premium wire pullout strength of wire termination
- Plated, fillister head, steel set screw provides high strength, durable electrical contact between conductor and connector
- cULus Listed for use for up to 600 V and temperature rated to 90 C where applicable

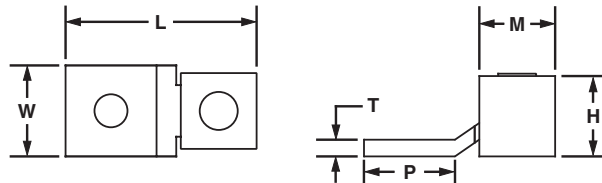

Part Number	Copper Conductor Size Range	Stud Hole Size (In.)	Figure Dimensions (In.)					Std. Pkg. Qty.
			L	W	H	T	M	
CXS35-36-C	14 AWG - 6 AWG	3/16	1.08	0.38	0.39	0.05	0.47	100
CXS70-14-C	14 AWG - 4 AWG	1/4	1.28	0.5	0.5	0.06	0.53	
CXS125-14-Q	4 AWG - 1/0 AWG	1/4	1.6	0.62	0.73	0.09	0.65	25
CXS125-56-Q	4 AWG - 1/0 AWG	5/16						



### One-Hole, Single Piece, Straight Fixed Tongue, Tin-Plated

For Use with Stranded Copper Code Conductors

Type CXS-T

- Made from a single piece of high strength electrolytic copper to provide premium electrical and mechanical performance
- Patented one piece design. Provides premium electrical and mechanical
- Wide wire range-taking capability minimizes inventory requirements
- Serrations incorporated in barrel of connector to provide premium wire pullout strength of wire termination
- Plated, fillister head, steel set screw provides high strength, durable electrical contact between conductor and connector
- cULus Listed for use for up to 600 V and temperature rated to 90°C where applicable
- Tin-plated to inhibit corrosion

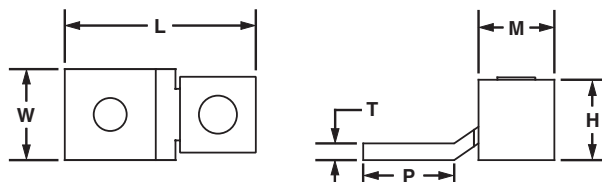

Part Number	Copper Conductor Size Range	Stud Hole Size (In.)	Figure Dimensions (In.)					Std. Pkg. Qty.
			L	W	H	T	M	
CXS35-36T-C	14 AWG - 6 AWG	3/16	1.08	0.38	0.39	0.05	0.47	100
CXS70-14-T-C	14 AWG - 4 AWG	1/4	1.28	0.5	0.5	0.06	0.53	100
CXS125-14T-Q	4 AWG - 1/0 AWG	1/4	1.6	0.62	0.73	0.09	0.65	25
CXS125-56T-Q	4 AWG - 1/0 AWG	5/16						

A

B1

B2

B3

C1

C2

C3

C4

D1

D2

D3

E1

E2

E3

E4

E5

F

G

H