

C-SCFI 1,5/2,8X0,5

Order No.: 3240048

<http://catalog.phoenixcontact.net/phoenix/treeViewClick.do?UID=3240048>Slip-on sleeve, red, 0.5 - 1.5 mm², 2.8 x 0.5**Commercial data**

EAN	 4 046356 452663
sales group	B281
Pack	100 Pcs.
Customs tariff	85369010
Gross weight in pieces	0.000655 KG
Net weight per piece	0.000655 KG
Catalog page information	Page 463 (C-5-2013)

Product notesWEEE/RoHS-compliant since:
09/23/2008

<http://www.download.phoenixcontact.com>
Please note that the data given here has been taken from the online catalog. For comprehensive information and data, please refer to the user documentation. The General Terms and Conditions of Use apply to Internet downloads.

Technical data**Dimensions**

Length (b)	18.5 mm
Width (a)	2.8 mm
Length of insulation sleeve (c)	10.5 mm
Inner dimension of the insulating collar (d)	4.1 mm
Material thickness (g)	0.25 mm

Ambient conditions

Ambient temperature (operation)	-20 °C ... 105 °C
---------------------------------	-------------------

General

Color	red
Stripping length	7 mm
Components	Halogen-free
Material	Brass

Certificates / Approvals

Certification

Certifications applied for:

Certification Ex:

Drawings

Dimensioned drawing

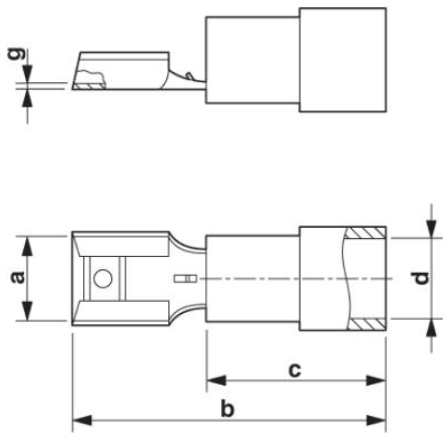

Address

PHOENIX CONTACT Deutschland GmbH
Flachmarktstr. 8
32825 Blomberg, Germany
Phone +49 5235 3 12000
Fax +49 5235 3 41200
<http://www.phoenixcontact.com>



© 2014 Phoenix Contact
Technical modifications reserved;