

PCB terminal block - SPT 16/ 1-V-10,0 GY - 1829276

Please be informed that the data shown in this PDF Document is generated from our Online Catalog. Please find the complete data in the user's documentation. Our General Terms of Use for Downloads are valid (<http://phoenixcontact.com/download>)



PCB terminal block, nominal current: 76 A, nom. voltage: 1000 V, pitch: 10 mm, number of positions: 1, connection method: Push-in spring connection, mounting: Wave soldering, color: gray

Your advantages

- Time saving push-in connection, tools not required
- Defined contact force ensures that contact remains stable over the long term
- Clamping space opened by means of fixed screwdriver enables convenient conductor connection
- Vertical connection enables multi-row arrangement on the PCB

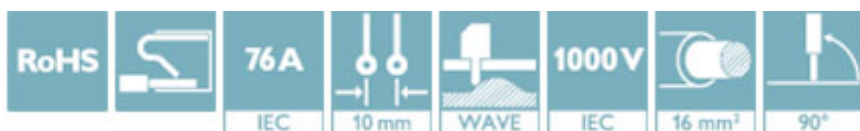

Key Commercial Data

| | |
|----------------------|---|
| Packing unit | 1 |
| GTIN |  4 046356 873260 |
| GTIN | 4046356873260 |
| Custom tariff number | 85369010 |

Technical data

Dimensions

| | |
|----------------|---------|
| Length [l] | 29 mm |
| Pitch | 10 mm |
| Width [w] | 11.8 mm |
| Height | 31.3 mm |
| Height [h] | 35.4 mm |
| Solder pin [P] | 4.1 mm |
| Pin spacing | 15 mm |
| Hole diameter | 1.7 mm |

General

| | |
|-----------------------------|-------------|
| Range of articles | SPT 16/..-V |
| Rated surge voltage (III/3) | 8 kV |

PCB terminal block - SPT 16/ 1-V-10,0 GY - 1829276

Technical data

General

| | |
|----------------------------------|--------------------|
| Rated surge voltage (III/2) | 8 kV |
| Rated surge voltage (II/2) | 6 kV |
| Rated voltage (III/3) | 1000 V |
| Rated voltage (III/2) | 1000 V |
| Rated voltage (II/2) | 1000 V |
| Connection in acc. with standard | EN-VDE |
| Nominal current I_N | 76 A |
| Nominal cross section | 16 mm ² |
| Stripping length | 18 mm |
| Number of positions | 1 |

Connection data

| | |
|---|----------------------|
| Conductor cross section AWG min. | 20 |
| Conductor cross section AWG max. | 4 |
| 2 conductors with same cross section, stranded, TWIN ferrules with plastic sleeve, min. | 0.75 mm ² |
| 2 conductors with same cross section, stranded, TWIN ferrules with plastic sleeve, max. | 4 mm ² |

Standards and Regulations

| | |
|----------------------------------|--------|
| Connection in acc. with standard | EN-VDE |
|----------------------------------|--------|

Environmental Product Compliance

| | |
|------------|---|
| China RoHS | Environmentally friendly use period: unlimited = EFUP-e |
| | No hazardous substances above threshold values |

Drawings

Drilling diagram

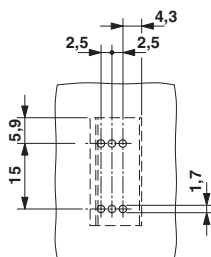

Dimensional drawing

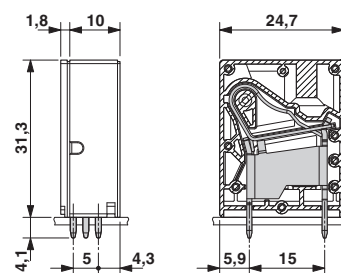

Classifications

eCl@ss

| | |
|------------|----------|
| eCl@ss 4.0 | 27141109 |
| eCl@ss 4.1 | 27141109 |
| eCl@ss 5.0 | 27141190 |

PCB terminal block - SPT 16/ 1-V-10,0 GY - 1829276

Classifications

eCl@ss

| | |
|------------|----------|
| eCl@ss 5.1 | 27261100 |
| eCl@ss 6.0 | 27261100 |
| eCl@ss 7.0 | 27440401 |
| eCl@ss 8.0 | 27440401 |
| eCl@ss 9.0 | 27440401 |

ETIM

| | |
|----------|----------|
| ETIM 4.0 | EC002643 |
| ETIM 5.0 | EC002643 |
| ETIM 6.0 | EC002643 |

UNSPSC

| | |
|---------------|----------|
| UNSPSC 6.01 | 30211801 |
| UNSPSC 7.0901 | 39121432 |
| UNSPSC 11 | 39121432 |
| UNSPSC 12.01 | 39121432 |
| UNSPSC 13.2 | 39121432 |

Approvals

Approvals

Approvals

IECEE CB Scheme / SEV / EAC / cULus Recognized

Ex Approvals

Approval details

| | | | |
|--------------------|---|---|---------|
| IECEE CB Scheme |  | http://www.iecee.org/ | CH-8077 |
| Nominal voltage UN | 1000 V | | |
| Nominal current IN | 76 A | | |

PCB terminal block - SPT 16/ 1-V-10,0 GY - 1829276

Approvals

| | | | |
|----------------------------|---|---|---------|
| SEV |  | https://www.electrosuisse.ch/de/meta/shop/produktezertifikate.html | IK-3431 |
| Nominal voltage UN | | 1000 V | |
| Nominal current IN | | 76 A | |
| mm ² /AWG/kcmil | | 16 | |

| | | |
|-----|---|---------|
| EAC |  | B.01742 |
|-----|---|---------|

| | | | |
|----------------------------|---|---|-----------------|
| cULus Recognized |  | http://database.ul.com/cgi-bin/XYV/template/LISEXT/1FRAME/index.htm | E60425-20061129 |
| | B | C | |
| Nominal voltage UN | 600 V | 600 V | |
| Nominal current IN | 66 A | 66 A | |
| mm ² /AWG/kcmil | 20-4 | 20-4 | |