

## RJ45 connector - CUC-STD-C1PGY-S/R4E8:1 - 1414382

Please be informed that the data shown in this PDF Document is generated from our Online Catalog. Please find the complete data in the user's documentation. Our General Terms of Use for Downloads are valid (<http://phoenixcontact.com/download>)



RJ45 connector, degree of protection: IP20, number of positions: 8, 1 Gbps, CAT6, material: PA, connection method: IDC connection technology, connection cross section: AWG 24- 27, cable outlet: straight, color: gray



### Key Commercial Data

Packing unit	1 pc
GTIN	
GTIN	4055626025339
Weight per Piece (excluding packing)	7.600 g
Custom tariff number	85366990
Country of origin	Taiwan

### Technical data

#### Mechanical characteristics

Number of positions	8
Connection profile	RJ45
Insertion/withdrawal cycles	≥ 750
Connection method	IDC connection technology
Type of contact	Crimp contacts
Conductor cross section	0.1 mm <sup>2</sup> ... 0.2 mm <sup>2</sup> (flexible)
Connection cross section AWG	24 ... 27 (flexible)
External cable diameter	7 mm
Cable outlet	straight
Color	gray
Degree of protection	IP20
No. of cable outlets	1

#### Ambient conditions

Ambient temperature (operation)	-25 °C ... 60 °C
---------------------------------	------------------

# RJ45 connector - CUC-STD-C1PGY-S/R4E8:1 - 1414382

## Technical data

### Material data

Flammability rating according to UL 94	V2
Housing material	PA
Contact carrier material	PC
Contact material	Phosphor bronze
Contact surface material	Gold

### Electrical characteristics

Number of positions	8
Nominal voltage $U_N$	72 V (DC)
Transmission characteristics (category)	CAT6
GRP transmission properties	CAT6 CAT6
Transmission speed	1 Gbps (250 MHz)
Rated current	1 A
Degree of pollution	2
Rated voltage (III/3)	72 V (DC)

### Standards and Regulations

Flammability rating according to UL 94	V2
--	----

### Environmental Product Compliance

China RoHS	Environmentally friendly use period: unlimited = EFUP-e
	No hazardous substances above threshold values

## Drawings

Dimensional drawing

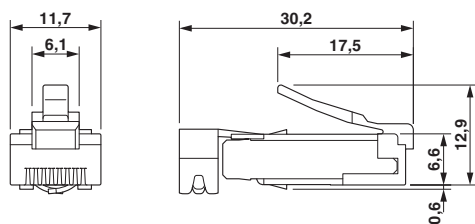

RJ45 male insert

Dimensional drawing

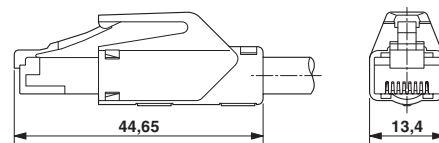

RJ45 connector, IP20

## Classifications

### eCl@ss

eCl@ss 5.1	27260700
eCl@ss 6.0	27260700
eCl@ss 7.0	27440101
eCl@ss 8.0	27440101
eCl@ss 9.0	27440101

# RJ45 connector - CUC-STD-C1PGY-S/R4E8:1 - 1414382

## Classifications

### ETIM

ETIM 5.0	EC002636
ETIM 6.0	EC002636

### UNSPSC

UNSPSC 13.2	39121409
-------------	----------

## Approvals

### Approvals

---

### Approvals

### EAC

---

### Ex Approvals

---

## Approval details

EAC		B.01742
-----	--	---------

## Accessories

### Accessories

### Crimping tool

Crimping pliers - VS-CT-RJ45-H - 1653265



Crimp tool, pliers with die, for RJ45 pin inserts VS-08-ST-H...-RJ45 and VS-08-RJ45-10G/C