

## Network cable - VS-M12FSBP-OE-936-2,0 - 1416578

Please be informed that the data shown in this PDF Document is generated from our Online Catalog. Please find the complete data in the user's documentation. Our General Terms of Use for Downloads are valid (<http://phoenixcontact.com/download>)



Assembled PROFINET cable, CAT5e, shielded, star quad, AWG 22 (7-wire), black, M12 flush-type socket, rear/screw mounting with M16 thread on free conductor end, length 2 m



### Key Commercial Data

Packing unit	1 pc
GTIN	 4 046356 479318
GTIN	4046356479318
Weight per Piece (excluding packing)	180.400 g
Custom tariff number	85444290
Country of origin	Germany

### Technical data

#### Ambient conditions

Degree of protection	IP67
----------------------	------

#### General data

Rated current at 40°C	4 A
Rated voltage	250 V
Number of positions	4
Overvoltage category	II
Degree of pollution	3
Alternative short product description	PROFINET cable
Contact material	CuZn
Contact carrier material	PA 6.6
Contact surface material	Ni/Au

#### Standards and Regulations

Flammability rating according to UL 94	V0
--	----

## Network cable - VS-M12FSBP-OE-936-2,0 - 1416578

### Technical data

#### Cable

Cable type	PROFINET railway applications
Cable type (abbreviation)	936
Signal type/category	PROFINET CAT5 (IEC 11801), 100 Mbps
Cable structure	1x4xAWG22/7; SF/TQ
Conductor cross section	4x 0.34 mm <sup>2</sup>
AWG signal line	22
Conductor structure signal line	7x 0.25 mm
Core diameter including insulation	1.95 mm
Wire colors	white-blue, orange-yellow
Overall twist	Star quad
Shielding	Plastic-coated aluminum foil, tinned copper braided shield
Optical shield covering	100 %
External sheath, color	black RAL 9005
Outer sheath thickness	≥ 0.8 mm
External cable diameter D	7.25 mm ±0,3 mm
Minimum bending radius, fixed installation	6 x D
Minimum bending radius, flexible installation	10 x D
Cable weight	81 g/m
Outer sheath, material	PE-X
Material conductor insulation	PE-X
Conductor material	silver-plated Cu litz wires
Conductor resistance	≤ 54.4 Ω/km
Working capacitance	≤ 65 pF (core-core) ≤ 100 pF (core-shield)
Wave impedance	100 Ω ±5 Ω (f = 100 MHz)
Near end crosstalk attenuation (NEXT)	80 dB (with 1 MHz) 76 dB (at 4 MHz) 67 dB (at 10 MHz) 60 dB (at 31.5 MHz) 56 dB (at 62.5 MHz) 53 dB (at 100 MHz)
Remote crosstalk attenuation (FEXT)	80 dB (with 1 MHz) 70 dB (at 4 MHz) 65 dB (at 10 MHz) 58 dB (at 31.5 MHz) 59 dB (at 62.5 MHz) 67 dB (at 100 MHz)
Attenuation	2 dB (with 1 MHz) 4 dB (at 4 MHz) 6.5 dB (at 10 MHz)

## Network cable - VS-M12FSBP-OE-936-2,0 - 1416578

### Technical data

#### Cable

	10.5 dB (at 31.5 MHz)
	14 dB (at 62.5 MHz)
	18 dB (at 100 MHz)
Return loss (RL)	35 dB (at 4 MHz)
	35 dB (at 10 MHz)
	35 dB (at 31.5 MHz)
	33 dB (at 62.5 MHz)
	33 dB (at 100 MHz)
Signal speed	66 c
Shield attenuation	40 dB (30 MHz ≤ f ≤ 100 MHz)
Coupling resistance	200.00 mΩ/m (f ≤ 30 MHz)
Nominal voltage, cable	300 V AC
Test voltage, cable	2000 V AC (50 Hz, 5 minutes)
Fire protection in rail vehicles	BS 6853 (Category Ia, Ib, II)
	GM/RT 2130 (Category Ia, Ib, II)
	EN 45545 (Risk level HL1 - HL3)
	DIN 5510 (Fire protection level 1, 2, 3, 4)
	NF F16-101 (Category A1, A2, B)
	NF F16-101 (Class C/F0)
	NFPA 130
	UNI CEI 11170 (Risk level LR1 - LR4)
Flame resistance	EN 60332-1-2
	EN 50266
	EN 60332-3-25
	NF C32-070, 2.1
	NF C32-070, 2.2
	UL 1685, 12 (FT4)
	in accordance with ISO 6722-1 5.22 (UN ECE-R 118.01)
Halogen-free	According to EN 50267-2-1
Resistance to oil	according to IRM 902, 72 h at 100 °C
Other resistance	Resistance to fuels according to IRM 903, 168 h at 70 °C
Concentration of fumes	BS 6853 D.8.7
	EN 61034-2
	UL 1685, 12 (FT4)
Fume corrosiveness	EN 50267-2-2
Fume toxicity	BS 6853 B.1
	EN 50305, 9.2
Ambient temperature (operation)	-50 °C ... 90 °C (cable, fixed installation)
	-40 °C ... 90 °C (cable, flexible installation)

#### Environmental Product Compliance

# Network cable - VS-M12FSBP-OE-936-2,0 - 1416578

## Technical data

### Environmental Product Compliance

REACH SVHC	Lead 7439-92-1
China RoHS	Environmentally Friendly Use Period = 50
	For details about hazardous substances go to tab "Downloads", Category "Manufacturer's declaration"

## Drawings

Dimensional drawing

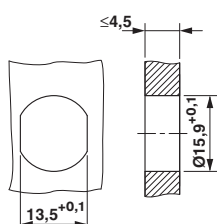

Schematic diagram

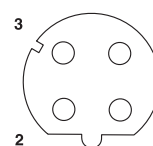

Housing cutout for M16 fastening thread, mounting panel with feed-through hole (alternatively with surface as protection against rotation)

Cable cross section



PROFINET railway applications [936]

Dimensional drawing

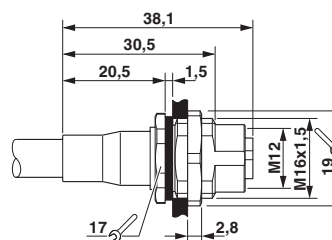

M12 flush-type connector

## Classifications

eCl@ss

eCl@ss 4.0	272607xx
eCl@ss 4.1	27260701
eCl@ss 5.0	27260701
eCl@ss 5.1	19030300
eCl@ss 6.0	27061800
eCl@ss 7.0	27060308
eCl@ss 8.0	27060308
eCl@ss 9.0	27060308

ETIM

ETIM 3.0	EC000830
----------	----------

# Network cable - VS-M12FSBP-OE-936-2,0 - 1416578

## Classifications

### ETIM

ETIM 4.0	EC002599
ETIM 5.0	EC002599

### UNSPSC

UNSPSC 6.01	26121616
UNSPSC 7.0901	26121616
UNSPSC 11	26121604
UNSPSC 12.01	31261501
UNSPSC 13.2	26121604

## Approvals

### Approvals

---

Approvals

EAC

---

Ex Approvals

---

### Approval details

EAC		B.00767
-----	---	---------