

Housing screw connection - SACC-FP-F-M12/PRESS SMD - 1412081

Please be informed that the data shown in this PDF Document is generated from our Online Catalog. Please find the complete data in the user's documentation. Our General Terms of Use for Downloads are valid (<http://phoenixcontact.com/download>)



Housing screw connection, socket, for the two-part M12 SMD connector, for press-in mounting.

Your advantages

- ✓ Reduced mounting costs thanks to two-piece device connector
- ✓ Easy device integration, thanks to mechanical port screw connections with press-in contour
- ✓ Efficient PCB assembly: two-piece connectors for SMT soldering

RoHS

Key Commercial Data

| | |
|--------------------------------------|---|
| Packing unit | 10 pc |
| Minimum order quantity | 10 pc |
| GTIN |  4 046356 992978 |
| GTIN | 4046356992978 |
| Weight per Piece (excluding packing) | 8.280 g |
| Custom tariff number | 74153300 |
| Country of origin | Germany |

Technical data

Ambient conditions

| | |
|---------------------------------|---|
| Ambient temperature (operation) | -25 °C ... 85 °C (Plug / socket) |
| | -40 °C ... 85 °C (without mechanical actuation) |
| Degree of protection | IP67 (correctly plugged in and locked) |

General

| | |
|-----------------------|--|
| Note | The electrical and mechanical data specified assume that the connector pair is correctly locked and mounted. If the connector is unlocked and if there is a danger of contamination, the connector must be sealed using a protective cap > IP54. Influences arising from litz wires, cables or PCB assembly must also be taken into consideration. |
| Standards/regulations | M12 connector IEC 61076-2-101 In line with |

Housing screw connection - SACC-FP-F-M12/PRESS SMD - 1412081

Technical data

General

| | |
|-----------------------------|----------------------------------|
| Insertion/withdrawal cycles | > 100 |
| Mounting type | Front mounting Press-in mounting |

Material

| | |
|------------------|--------------------------------------|
| Material, knurts | Nickel-plated brass |
| Material | Brass, nickel-plated |
| Sealing material | FKM (O-ring (pin connector pattern)) |

Cable

| | |
|--------------------------|--|
| Standards/specifications | M12 connector IEC 61076-2-101 In line with |
|--------------------------|--|

Standards and Regulations

| | |
|-----------------------|-----------------|
| Standard designation | M12 connector |
| Standards/regulations | IEC 61076-2-101 |

Environmental Product Compliance

| | |
|------------|---|
| REACH SVHC | Lead 7439-92-1 |
| China RoHS | Environmentally Friendly Use Period = 50 |
| | For details about hazardous substances go to tab "Downloads", Category "Manufacturer's declaration" |

Drawings

Dimensional drawing

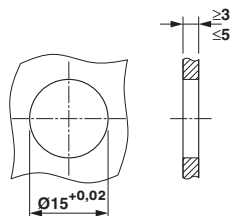

Dimensional drawing

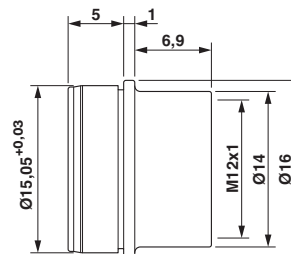

Housing bore holes

Classifications

eCl@ss

| | |
|------------|----------|
| eCl@ss 5.1 | 27379100 |
| eCl@ss 6.0 | 27379200 |
| eCl@ss 7.0 | 27379201 |
| eCl@ss 8.0 | 27379201 |
| eCl@ss 9.0 | 27379201 |

ETIM

| | |
|----------|----------|
| ETIM 5.0 | EC002498 |
| ETIM 6.0 | EC002498 |

Housing screw connection - SACC-FP-F-M12/PRESS SMD - 1412081

Classifications

UNSPSC

| | |
|-------------|----------|
| UNSPSC 13.2 | 39121421 |
|-------------|----------|

Approvals

Approvals

Approvals

EAC

Ex Approvals

Approval details

| | | |
|-----|---|---------|
| EAC |  | B.01742 |
|-----|---|---------|
