

## D-SUB EMC shroud - VS-15-A-EMV-S - 1688049

Please be informed that the data shown in this PDF Document is generated from our Online Catalog. Please find the complete data in the user's documentation. Our General Terms of Use for Downloads are valid (<http://phoenixcontact.com/download>)

D-SUB EMC shroud, shell size 2, shielded, for panel mounting frame VS-15...



### Key Commercial Data

Packing unit	5 pc
Minimum order quantity	5 pc
GTIN	 4 017918 182311
GTIN	4017918182311
Weight per Piece (excluding packing)	0.800 g
Custom tariff number	85389099
Country of origin	Germany

### Technical data

#### Mechanical characteristics

Insertion/withdrawal cycles	≥ 1000
Color	Bare metallic
Type	15
Size of housing	2

#### Ambient conditions

Ambient temperature (operation)	-40 °C ... 80 °C
---------------------------------	------------------

#### Material data

Housing material	Nickel silver
------------------	---------------

#### Electrical characteristics

Degree of pollution	2
---------------------	---

### Drawings

# D-SUB EMC shroud - VS-15-A-EMV-S - 1688049

Dimensional drawing

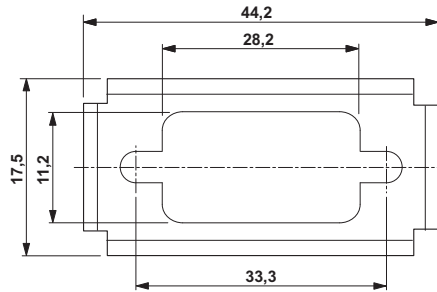

D-SUB EMC shroud

## Classifications

eCl@ss

eCl@ss 4.0	27140816
eCl@ss 4.1	27260701
eCl@ss 5.0	27260701
eCl@ss 5.1	27261200
eCl@ss 6.0	27261200
eCl@ss 7.0	27440201
eCl@ss 8.0	27440201
eCl@ss 9.0	27440201

ETIM

ETIM 2.0	EC000437
ETIM 3.0	EC000437
ETIM 4.0	EC000437
ETIM 5.0	EC002309
ETIM 6.0	EC002309

UNSPSC

UNSPSC 6.01	31261501
UNSPSC 7.0901	31261501
UNSPSC 11	31261501
UNSPSC 12.01	31261501
UNSPSC 13.2	31261501