

## Panel feed-through - SACC-E-M12MSB-5CON-M20/0,5 VA - 1452084

Please be informed that the data shown in this PDF Document is generated from our Online Catalog. Please find the complete data in the user's documentation. Our General Terms of Use for Downloads are valid (<http://phoenixcontact.com/download>)



Sensor/actuator panel-mount connector, 5-pos., M12, B-coded, front/screw mounting with M20 x 1.5 thread, with 0.5 m TPE litz wire, 5 x 0.34 mm<sup>2</sup>, stainless steel version

### Why buy this product

- Pre-assembled with litz wires for immediate use
- Customer-specific assemblies and litz wire lengths available
- Sealed on the litz wire side for optimum leak-tightness
- All standard pin assignments and codings for signal, data, and power transmission with a uniform design-in design
- For high transmission safety: shield connection to the housing with optional EMC nut

### Key Commercial Data

|                                      |               |
|--------------------------------------|---------------|
| Packing unit                         | 1 STK         |
| GTIN                                 |               |
| GTIN                                 | 4046356528733 |
| Weight per Piece (excluding packing) | 1.000 g       |
| Custom tariff number                 | 85444290      |
| Country of origin                    | Germany       |

### Technical data

#### Dimensions

|                 |       |
|-----------------|-------|
| Length of cable | 0.5 m |
|-----------------|-------|

#### Ambient conditions

|                                 |   |
|---------------------------------|---|
| Ambient temperature (operation) | -25 °C ... 85 °C (Plug / socket)                |
|                                 | -40 °C ... 85 °C (without mechanical actuation) |

# Panel feed-through - SACC-E-M12MSB-5CON-M20/0,5 VA - 1452084

## Technical data

### Ambient conditions

|                      |      |
|----------------------|------|
| Degree of protection | IP67 |
|----------------------|------|

### General

|                             |  |
|-----------------------------|--|
| Note                        | The electrical and mechanical data specified assume that the connector pair is correctly locked and mounted. If the connector is unlocked and if there is a danger of contamination, the connector must be sealed using a protective cap > IP54. Influences arising from litz wires, cables or PCB assembly must also be taken into consideration. |
| Rated current at 40°C       | 4 A  |
| Rated voltage               | 60 V   |
| Rated surge voltage         | 1.5 kV   |
| Number of positions         | 5  |
| Insulation resistance       | ≥ 100 MΩ   |
| Coding                      | B - inverse  |
| Standards/regulations       | M12 connector IEC 61076-2-101  |
| Status display              | No   |
| Overvoltage category        | II   |
| Degree of pollution         | 3  |
| Connection method           | Individual wires   |
| Insertion/withdrawal cycles | > 100  |
| Torque                      | 3 Nm ... 4 Nm (Installation-side)  |
| Mounting type               | Front mounting M20 x 1,5   |

### Material

|  |                 |
|--|-----------------|
| Flammability rating according to UL 94 | V0              |
| Contact material                       | CuZn            |
| Contact surface material               | Au              |
| Contact carrier material               | PA 6.6          |
| Material, knurls                       | Stainless steel |
| Sealing material                       | NBR             |

### Cable

|                                    |                                 |
|------------------------------------|---------------------------------|
| Cable type                         | TPE litz wire                   |
| Conductor cross section            | 0.34 mm <sup>2</sup>            |
| AWG signal line                    | 22                              |
| Conductor structure signal line    | 7x 0.25 mm                      |
| Core diameter including insulation | 1.2 mm ±0.07 mm                 |
| Thickness, insulation              | 0.21 mm                         |
| Wire colors                        | Brown, white, blue, black, gray |
| Material conductor insulation      | TPE                             |

# Panel feed-through - SACC-E-M12MSB-5CON-M20/0,5 VA - 1452084

## Technical data

### Cable

|                                 |   |
|---------------------------------|---|
| Conductor material              | Tin-plated Cu litz wires                        |
| Standards/specifications        | M12 connector IEC 61076-2-101                   |
| Insulation resistance           | $\geq 20 \text{ M}\Omega \cdot \text{km}$       |
| Conductor resistance            | $\leq 57.6 \text{ m}\Omega/\text{m}$            |
| Nominal voltage, cable          | 300 V   |
| Test voltage, cable             | 2000 V AC                                       |
| Ambient temperature (operation) | -40 °C ... 85 °C (cable, fixed installation)    |
|                                 | -25 °C ... 85 °C (cable, flexible installation) |

### Standards and Regulations

|  |                 |
|--|-----------------|
| Standard designation                   | M12 connector   |
| Standards/regulations                  | IEC 61076-2-101 |
| Flammability rating according to UL 94 | V0              |

### Environmental Product Compliance

|            |   |
|------------|---|
| China RoHS | Environmentally Friendly Use Period = 50  |
|            | For details about hazardous substances go to tab "Downloads", Category "Manufacturer's declaration" |

## Drawings

Dimensional drawing

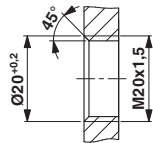

Housing cutout for M20 fastening thread, mounting panel with thread

Schematic diagram

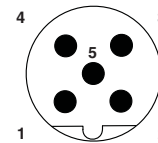

Pin assignment M12 male connector, 5-pos., B-coded, male side

Dimensional drawing

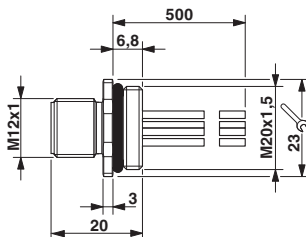

M12 flush-type plug

Circuit diagram



Contact assignment of the M12 plug and the M12 socket

# Panel feed-through - SACC-E-M12MSB-5CON-M20/0,5 VA - 1452084

## Classifications

### eCl@ss

|            |          |
|------------|----------|
| eCl@ss 4.0 | 27140815 |
| eCl@ss 4.1 | 27140815 |
| eCl@ss 5.0 | 27143423 |
| eCl@ss 5.1 | 27143400 |
| eCl@ss 6.0 | 27279200 |
| eCl@ss 7.0 | 27440103 |
| eCl@ss 8.0 | 27440103 |
| eCl@ss 9.0 | 27440102 |

### ETIM

|          |          |
|----------|----------|
| ETIM 2.0 | EC001297 |
| ETIM 3.0 | EC002061 |
| ETIM 4.0 | EC002061 |
| ETIM 5.0 | EC002061 |
| ETIM 6.0 | EC002061 |

### UNSPSC

|               |          |
|---------------|----------|
| UNSPSC 6.01   | 31251501 |
| UNSPSC 7.0901 | 31251501 |
| UNSPSC 11     | 31251501 |
| UNSPSC 12.01  | 31251501 |
| UNSPSC 13.2   | 39121413 |

## Approvals

### Approvals

---

#### Approvals

UL Recognized / cULus Recognized / EAC

---

#### Ex Approvals

---

### Approval details

# Panel feed-through - SACC-E-M12MSB-5CON-M20/0,5 VA - 1452084

## Approvals

|                            |  |   |               |
|----------------------------|--|---|---------------|
| UL Recognized              |  | <a href="http://database.ul.com/cgi-bin/XYV/template/LISEXT/1FRAME/index.htm">http://database.ul.com/cgi-bin/XYV/template/LISEXT/1FRAME/index.htm</a> | FILE E 118976 |
| Nominal voltage UN         |  | 60 V  |               |
| Nominal current IN         |  | 4 A   |               |
| mm <sup>2</sup> /AWG/kcmil |  | 22  |               |

|                            |  |   |                  |
|----------------------------|--|---|------------------|
| cULus Recognized           |  | <a href="http://database.ul.com/cgi-bin/XYV/template/LISEXT/1FRAME/index.htm">http://database.ul.com/cgi-bin/XYV/template/LISEXT/1FRAME/index.htm</a> | E221474-20140616 |
| Nominal voltage UN         |  | 60 V  |                  |
| Nominal current IN         |  | 4 A   |                  |
| mm <sup>2</sup> /AWG/kcmil |  | 22-20   |                  |

|     |  |         |
|-----|--|---------|
| EAC |  | B.00767 |
|-----|--|---------|

## Accessories

### Accessories

#### Protective cap

Sealing cap - PROT-M12 FS - 1560251



M12 sealing cap for unoccupied M12 plugs of the sensor/actuator cable, flush-type plugs and I/O devices in the field

Sealing cap - PROT-M12 FS-M - 1430488



M12 metal sealing cap for unoccupied M12 plugs of the sensor/actuator cable, flush-type plugs and I/O devices in the field

